

711-1230 to 711-1265
711-1265

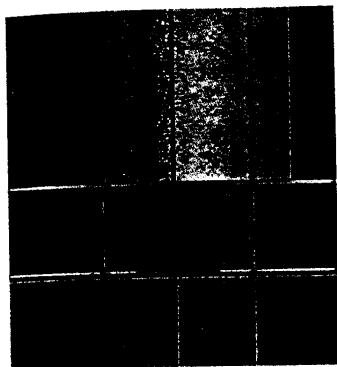

STABIFLEX

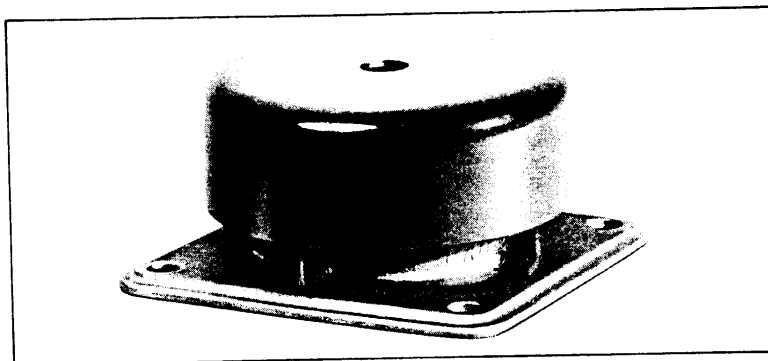

DESCRIPTION

The STABIFLEX mounting comprises a conical rubber section bonded between inner and outer metal parts.

- Centre axis with threaded hole.
- Square or diamond base with clearance holes.
- Bonded natural rubber, anti-slip bead.
- Cup to protect the rubber and distribute the load.

OPERATION

The design of the STABIFLEX mounting gives the following basic characteristics.

- Axial elasticity two to three times higher than radial elasticity.
- The rubber works in shear / compression
- Progressive buffer against shocks or accidental overload.
- Anti-slip (may be placed directly on the ground).

Advantages

- The machine may be placed (with its mountings) directly on the ground.
- Speed of fixing.
- Simple removal of the assembly.
- Rubber protected against harmful liquids.
- Extensive range: 3 hardnesses of rubber for 5 existing types, allowing the mounting to be optimised as function of the load and forcing frequency.
- May be used with an anti-rebound washer.

Recommendations

- In order not to affect the performance of the mounting system, all external connections must be flexible.
- STABIFLEX mountings must be fitted so that the vibration input is in the axial direction.

DIMENSIONS

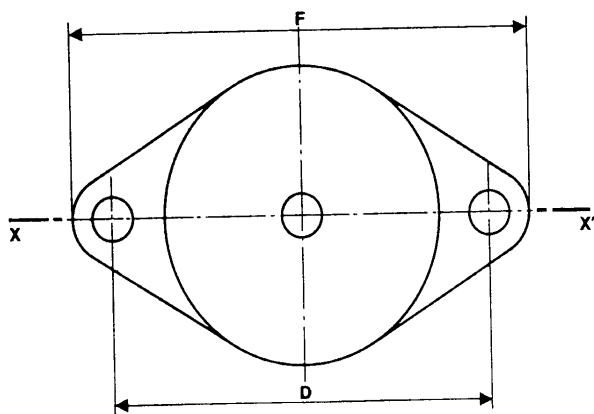
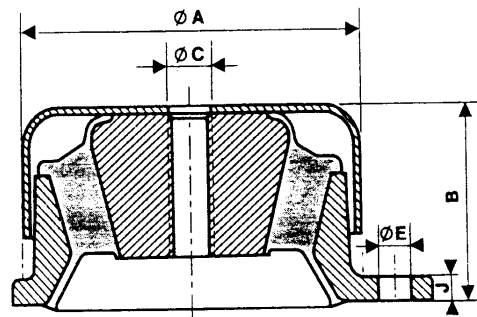
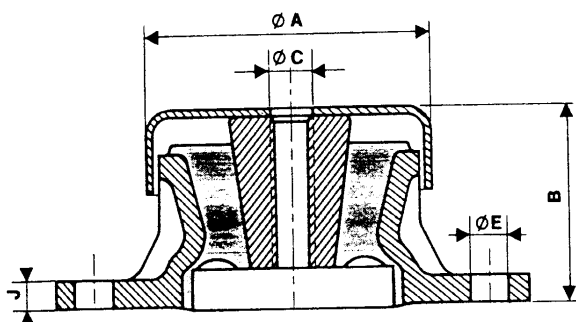

STABIFLEX - diamond base

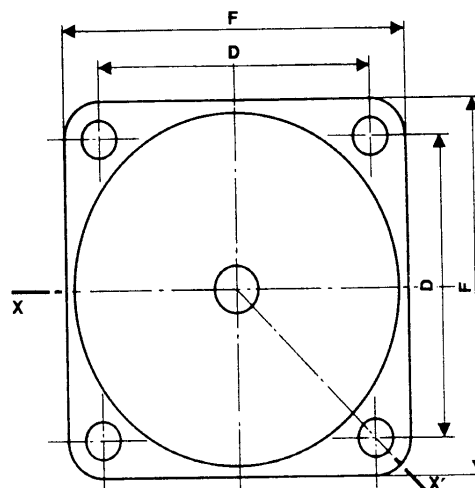

STABIFLEX - square base

TYPE	Reference	Hardness	$\varnothing A$ mm	B mm	$\varnothing C$ mm	D mm	E mm	F mm	J mm	Weight g
Diamond base	530 603	45.60.75	69	41	M 12	98	9	114	6	250
	530 613	45.60.75	84	51	M 12	115	11	137	7	450
Square base	530 622	45.60.75	100	52	M 12	90	11	114	7	1000
	530 642	45.60.75	133	71	M 16	114	13	144	9	2300
	530 652*	60.75	133	71	M 16	114	13	144	9	2700

* PART IDENTIFIED BY THE LETTER "R" (REINFORCED)

See current price list for availability of items.

OPERATING CHARACTERISTICS

Nominal static load daN	Deflection mm	Reference	Hardness
42	3,5	530 603	45
60	3	530 603	60
93	3,5	530 613	45
125	4	530 603	75
165	3,5	530 613	60
210	5	530 622	45
260	3	530 613	75

Nominal static load daN	Deflection mm	Reference	Hardness
275	4,5	530 622	60
380	3,5	530 622	75
450	8	530 642	45
700	8	530 642	60
1000	8	530 642	75
1300	8	530 652	60
1800	8	530 652	75

LOAD / DEFLECTION CURVES IN AXIAL COMPRESSION

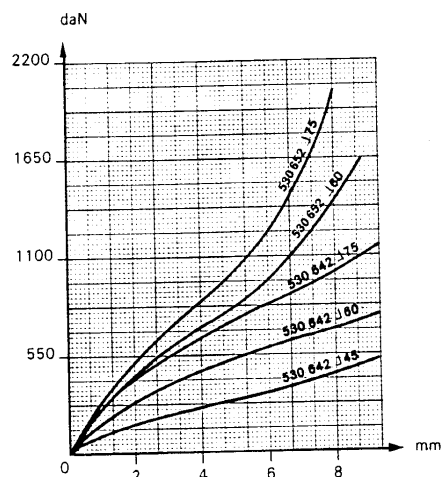
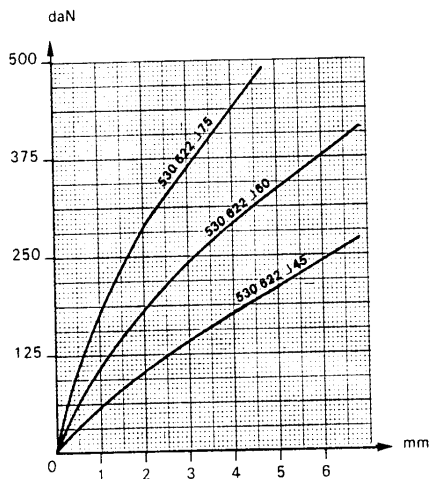
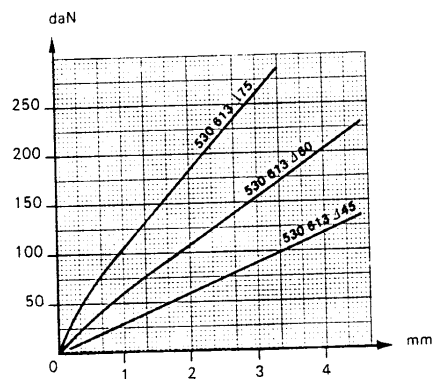
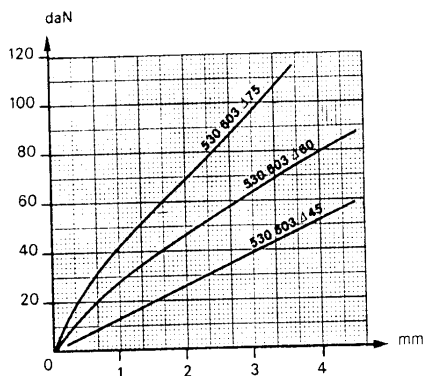

ASSEMBLY

• Standard fixing methods

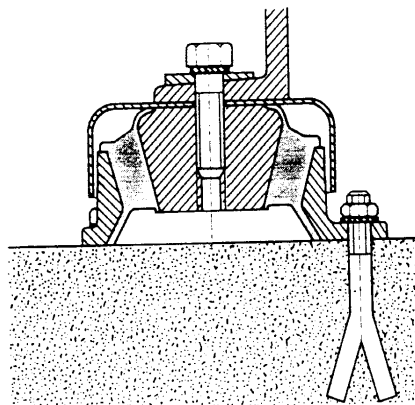
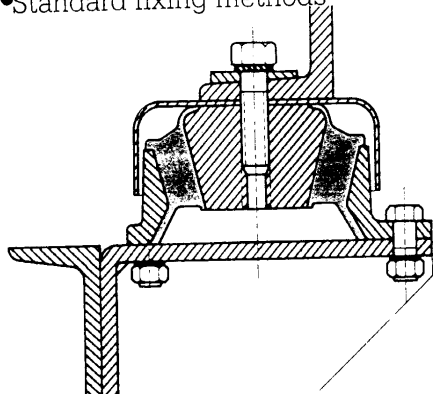

• Fixing with anti-rebound washer

- The anti-rebound washer (not supplied) is fixed to the lower side of the centre axis.
- In this case, do not forget to fit a spacer.

Spacer thickness required.

530603 h: 2 mm

530613 h: 4 mm

530622 h: 7 mm

530642 h: 14 mm

530652 h: 14 mm

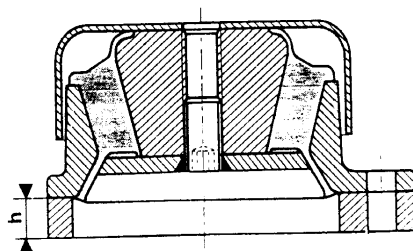

All our mountings are identified by conventional markings, either a paint spot or figures indicating the hardness: grey = hardness 45, green = hardness 60, blue = hardness 75.