

# 9 Amps

## AEH09R48N

### High Efficiency Half Brick

**Total Power:** 250W  
**Input Voltages:** 48V  
**No. of Outputs:** Single

[www.DataSheet4U.com](http://www.DataSheet4U.com)

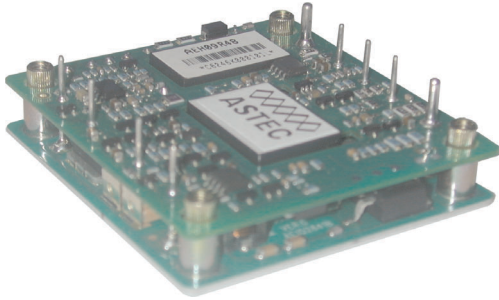

### Special Features

- High efficiency (91% Typical)
- Industry standard package  
2.4" x 2.28" x 0.5"
- Remote sense compensation
- Basic insulation
- No load requirement

### Environmental

Operating Ambient Temp: -40°C to +70°C  
 Overtemperature protection  
 MTBF: 2 million hours

### Safety

UL, CSA, TUV

### Electrical Specs

#### Input

Input Range 36 to 75 VDC  
 Input Surge 100V /100ms  
 Efficiency 91%@28V Typ

#### Output

Output Regulation  
(Line, load, temp) <0.5%  
 Ripple 200mV pp max  
 Noise 240mV pp max

Remote sense +/-10% of Vo  
 Transient Response 25% I<sub>nom</sub> step from 50%I<sub>nom</sub>.  
 3%Vo max, 500µs (di/dt =0.1A/µs)

Overvoltage Protection 32.2V to 39.2V (Latch)  
 Current Limit 9.9A to 12.6A (Auto-recovery)  
 Overtemperature Protection Auto-recovery  
 Switching Frequency 250kHz

#### Control

Voltage Adjust 80 to 110%  
 Enable Positive & negative enable options

#### Thermal Derating

The module can deliver up to full power at 50°C ambient, Vin: 48V, with 0.5m/sec forced air.

AMERICA

5810 Van Allen Way  
Carlsbad, CA 92008  
Telephone: 760-930-4600  
Facsimile: 760-930-0698

EUROPE

Astec House, Waterfront Business Park  
Merry Hill, Dudley  
West Midlands, DY5 1LX, UK  
Telephone: 44 (1384) 842-211  
Facsimile: 44 (1384) 843-355

ASIA

Units 2111-2116, Level 21  
Tower 1, Metroplaza  
223, Hing Fong Road  
Fwai Fong, New Territories  
Hong Kong  
Telephone: 852-2437-9662  
Facsimile: 852-2402-4426

## Ordering Information

Input Voltage	Output Voltage	Output Current	Efficiency	Model Number
48V	28V	9A	91% Typ	AEH09R48N

NOTES: "N" = Negative logic enable (without "N" = Positive logic enable)

## Pin Assignments

### Single Output

- +Vin
- CNT
- Case
- Vin
- +Vo
- + Sense
- Trim
- Sense
- Vo

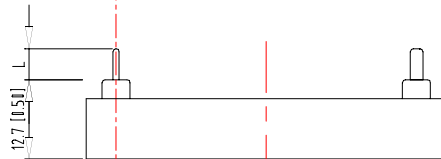
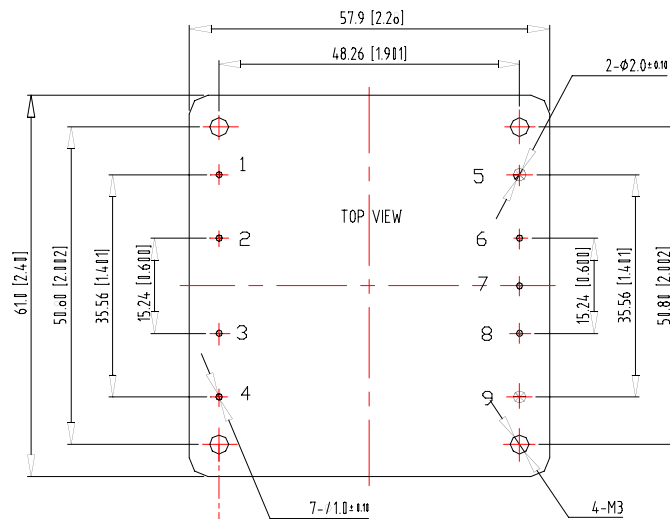

L: Pin length optional, dependent on the device code suffix. 6: 3.8mm, 8: 2.8mm, 7: 5.8mm. Default: 5mm.

TOLERANCES : X.Xmm=+/-0.5mm  
X.XXmm=+/-0.25mm

### Notes:

- All specifications subject to change without notice. Mechanical drawings are for reference only.
- Technical Reference Notes should be consulted for detailed information when available.