

Features

- Small size and light weight. Heavy contact load (30A).
- Contact arrangement Form A.
- Suitable for automobile and lamp accessories application.
- Insert mounting footprint.
- With metal frame.

Ordering Information

NVFS A 15 DC12V

1 2 3 4

1 Part number: NVFS

2 Contact arrangement: A:1A

3 Contact rating: 15:15A/14VDC; 30:30A/14VDC

4 Coil rated Voltage(V): DC: 6,12,24

Contact Data

Contact Arrangement 1A (SPSTNO)
 Contact Material Ag·SnO₂
 Contact Rating (resistive) 15A, 30A/14VDC

Max. Switching Power 420W
 Max. Switching Voltage 75VDC
 Contact Resistance or Voltage drop ≤50mΩ

Operation life | Electrical 10⁵
 | Mechanical 10⁷

Max. Switching Current:30A
 Item 3.12 of IEC255-7
 Item 3.30 of IEC255-7
 Item 3.31 of IEC255-7

Coil Parameter

Dash numbers	Coil voltage VDC		Coil resistance Ω±10%	Pickup voltage VDC(max) (65%of rated voltage)	release voltage VDC(min) (20% of rated voltage)	Coil power consumption W	Operate Time ms	Release Time ms
	Rated	Max.						
006-1800	6	7.8	20	3.9	1.2	1.8	≤7	≤5
012-1800	12	15.6	80	7.8	2.4			
024-1800	24	31.2	320	15.6	4.8			

CAUTION: 1.The use of any coil voltage less than the rated coil voltage will compromise the operation of the relay.
 2.Pickup and release voltage are for test purposes only and are not to be used as design criteria.

Solderability
 Ambient Temperature
 Relative Humidity
 Mass

200°C ± 2°C
 -40~85°C
 85% (at 40°C)
 32g

IEC68-2-26 Test Va method 1
 IEC68-2-3 Test Ca

Qualification inspection:

Perform the qualification test as specified in the table IV of IEC255-19-1 and minimum sample size 24.

Dimensions (Unit: mm)

Shrouded type with bracket

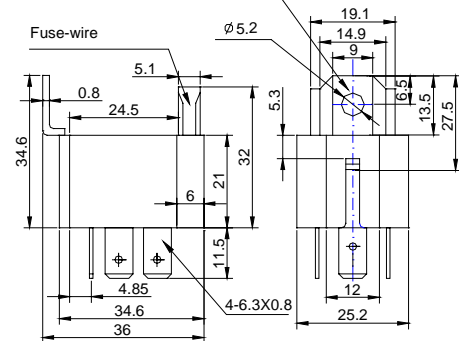

Dimensions

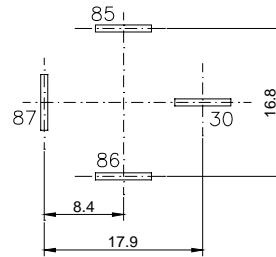

Mounting (Bottom views)

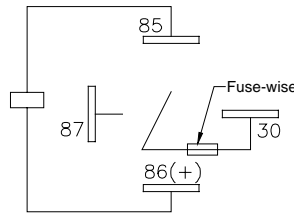

Wiring diagram (Bottom views)

mm	inch
0.8	0.031
4.85	0.191
5.1	0.201
5.2	0.205
5.3	0.209
6	0.236
6.3	0.248
6.5	0.256
8.4	0.331
9	0.354
11.5	0.453
12	0.472
13.5	0.531
14.9	0.587
16.8	0.661
17.9	0.705
19.1	0.752
21	0.827
24.5	0.965
25.2	0.992
27.5	1.083
32	1.260
34.6	1.362
36	1.417

NOTES 1).Dimensions are in millimeter.

2).Inch equivalents are given for general information only.