

PLEASE CHECK WWW.MOLEX.COM FOR LATEST PART INFORMATION

Part Number: [0192030034](#)
Status: **Active**
Description: Krimptite™ Temp-Term Ring Tongue Terminal for 18 to 22 AWG Wire, Stud Size 10

Documents:

[Drawing \(PDF\)](#) [RoHS Certificate of Compliance \(PDF\)](#)

Agency Certification

UL E32244

General

Product Family Ring and Spade Terminals
 Series [19203](#)
 Comments 1200° F (649°C)
 Crimp Quality Equipment Yes
 Mil-Spec N/A
 Product Name Krimptite™, Temp-Terms
 Type Ring

Physical

Barrel Type Closed
 Insulation None
 Material - Plating Mating Tin
 Packaging Type Bag
 Stud Size 10 (M5)
 Wire Size AWG 18, 20, 22
 Wire Size mm² 0.25 - 1.50

Material Info

Old Part Number AA-U-133-10

Reference - Drawing Numbers

Sales Drawing AACD10105

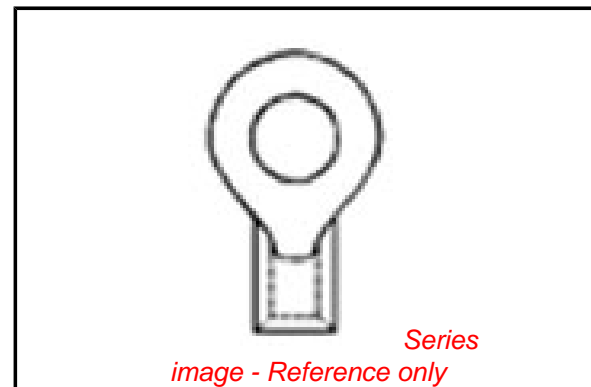

EU RoHS

**ELV and RoHS
Compliant**
REACH SVHC
 Not Reviewed
**Halogen-Free
Status**
Not Reviewed

China RoHS



**Need more information on product
environmental compliance?**

Email productcompliance@molex.com
 For a multiple part number RoHS Certificate of
 Compliance, [click here](#)

Please visit the [Contact Us](#) section for any
 non-product compliance questions.

Search Parts in this Series
[19203Series](#)

FILE NO.

AA-CD-101-05

- NOTES:**
 ① MAT'L: PURE NICKEL
 PLATING: NONE

STUD SIZES: ($\pm .005$)

- 02 = .094
- 04 = .119
- 06 = .146
- 08 = .173
- 10 = .198
- 14 = .265
- 56 = .328
- 38 = .390

ALL DIMENSIONS = $\frac{\text{INCHES}}{\text{MM}}$

WIRE SIZE: 22-18 AWG
 .25-1.5 MM²

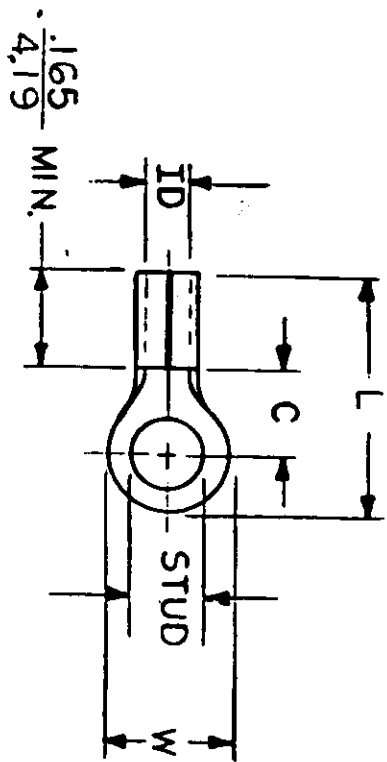

PART NUMBER	"W" ±.010	"C" MIN.	"L" MAX.	*ID MIN.	AVAILABLE STUD SIZES	STOCK THICKNESS
AA-U-133-	$\frac{.273}{6.93}$	$\frac{.240}{6.10}$	$\frac{.591}{15.01}$	$\frac{.062}{1.57}$	04, 06, 08, 10	$\frac{.028 \pm .001}{.71}$
	$\frac{.187}{4.75}$	$\frac{.173}{4.39}$	$\frac{.490}{12.45}$	$\frac{.054}{1.37}$	02, 04	$\frac{.031 \pm .001}{.79}$
DIMENSIONAL TOLERANCES UNLESS OTHERWISE SPECIFIED REFERENCE SCALE: NTS DATE: TITLE: TEMP-TERM (1200°) RING TONGUE TERMINAL KRIMPTITE 100-SERIES FRAC. DEC. ANG. CHKD. BY: APPR. BY: EMF 2-3-87 DWG. NO. A CUSTOMER DWG.						

