

**PLEASE CHECK WWW.MOLEX.COM FOR LATEST PART INFORMATION**

**Part Number:** [0357607300](#)  
**Status:** **Active**  
**Description:** Wire Splice, 10-12 AWG, Un-plated

**Documents:**

[Packaging Specification \(PDF\)](#)      [Product Specification PS-35760-003 \(PDF\)](#)  
[Drawing \(PDF\)](#)      [RoHS Certificate of Compliance \(PDF\)](#)

**General**

Product Family	Splices
Series	<a href="#">35760</a>
Crimp Quality Equipment	Yes
Mil-Spec	N/A
Product Name	N/A

**Physical**

Barrel Type	Open
Insulation	None
Material - Metal	Brass
Packaging Type	Reel
Temperature Range - Operating	-30°C to +105°C
Wire Insulation Diameter	3.5mm (.138")
Wire Size AWG	10, 12
Wire Size mm <sup>2</sup>	4.00 - 6.00

**Electrical**

Voltage - Maximum	200V AC (RMS)/DC
-------------------	------------------

**Material Info**

**Reference - Drawing Numbers**

Product Specification	PS-35760-003
Sales Drawing	SD-35760-003

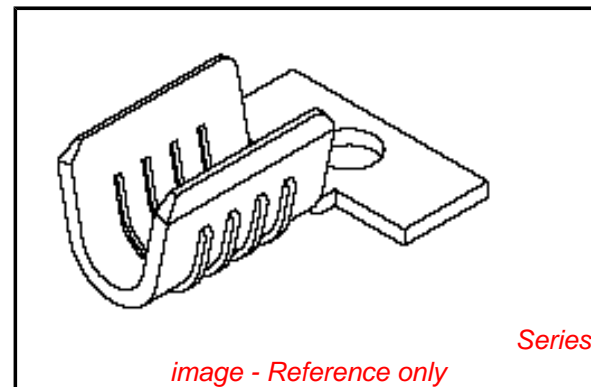

**EU RoHS**

**ELV and RoHS  
Compliant**  
**REACH SVHC  
Contains SVHC: No**  
**Halogen-Free  
Status**  
**Halogen-Free**

**China RoHS**



**Need more information on product  
environmental compliance?**

Email [productcompliance@molex.com](mailto:productcompliance@molex.com)  
For a multiple part number RoHS Certificate of Compliance, [click here](#)

Please visit the [Contact Us](#) section for any non-product compliance questions.

**Search Parts in this Series**  
[35760Series](#)

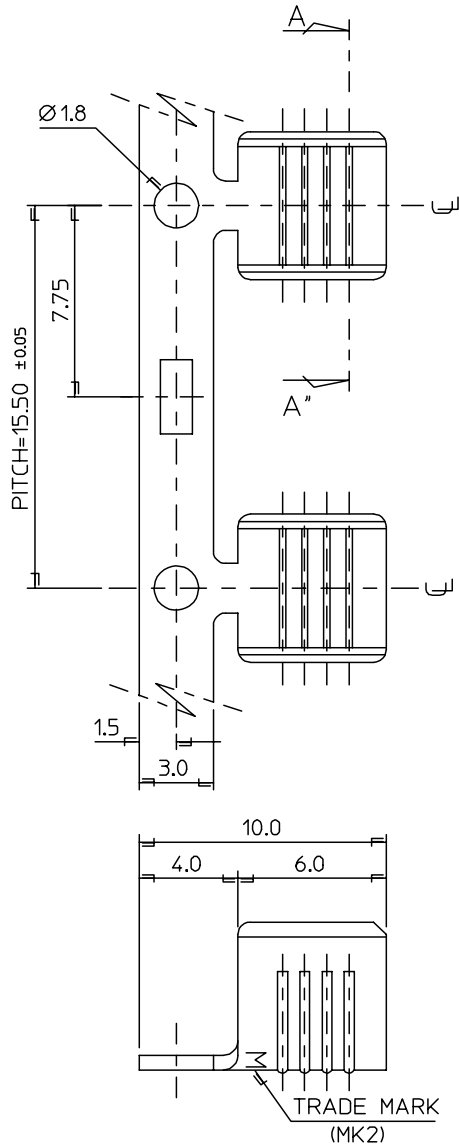

NOTES

1. MATERIAL : BRASS THICKNESS : 0.6mm
2. MATERIAL NO.

PART NO.	a	b	C	FINISH	WIRE RANGE	QUANTITY
35760-7300	6.0	6.0	R2.5	UNPLATED	4.0-6.0mm <sup>2</sup>	2,000/REEL
35760-7310				POST PLATED TIN		
35760-7500	5.4	5.2	R2.2	UNPLATED	2.5-4.0mm <sup>2</sup>	3,000/REEL
35760-7510				POST PLATED TIN		

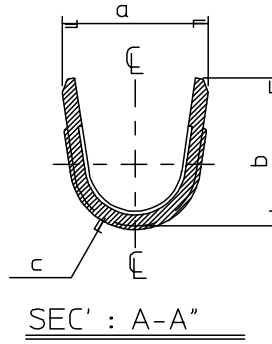

DO NOT SCALE DRAWING DIMENSION IN METRIC  
 PROJECT NO. SIMILAR ITEM DWG. NO. SD-35760-003

ADDITION OF OPTION EC NDKOR2006-0064 DRWNSY/PARK 05/12/16 CHK: BC.YOON 05/12/16 APPR: SH.CHOI 05/12/16	QUALITY SYMBOLS MAJOR CRITICAL	GENERAL TOLERANCES: (UNLESS SPECIFIED)		SCALE 5:1	DESIGN UNITS <input checked="" type="checkbox"/> mm <input type="checkbox"/> INCH	THIRD ANGLE PROJECTION	DIMENSIONS: <input type="checkbox"/> mm <input type="checkbox"/> INCH <input type="checkbox"/> mm <input checked="" type="checkbox"/> mm ONLY	SHT	REV
		4 PLACES ±0. ±.	3 PLACES ±0. ±.	2 PLACES ±0.20 ±.	1 PLACE ±0.30 ±.	ANGULAR: ± 0.15 °	DRAFT WHERE APPLICABLE MUST REMAIN WITHIN DIMENSIONS	THIS DRAWING CONTAINS INFORMATION THAT IS PROPRIETARY TO MOLEX INCORPORATED AND SHOULD NOT BE USED WITHOUT WRITTEN PERMISSION.	
DRAWN BY & DATE J.S.KANG 93/10/08		CHECKED BY & DATE B.K.CHOI 93/10/08		APPROVED BY & DATE C.W.LEE 93/10/08		TITLE: WIRE SPLICE(M)		REVISE ON CAD ONLY	
CAD FILENAME SD35760.DGN		MATERIAL NO. SEE TABLE		DRAWING NO. SD-35760-003		MOLEX MOLEX INCORPORATED		SHEET NO. 1 OF 1	