

460-3220 Swage mount .044 (1,14) diameter pin.

Recommended mounting hole.064(1,63) ±.002(0,05).

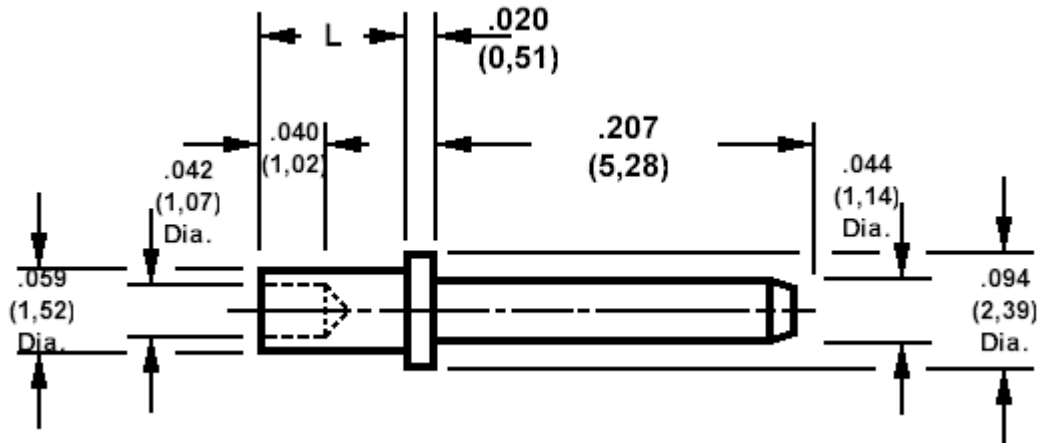

How to order code

460-3230-XX-YY-00

Basic Part No XX = L dimension, YY = Finish

See Tables below to complete part number

DIMENSIONS (XX)			
Basic Part Number	(XX)	L	For Board Thickness
460-3220	-01	.051 (1,30)	.031 (0,79)
	-02	.081 (2,08)	.061 (1,57)
	-03	.125 (3,18)	.094 (2,39)
	-04	.155 (3,96)	.125 (3,18)

MATERIALS				
		Finish (YY)		
Component	Material	(-03)	(-04)	(-05)
Pin	Brass	Gold over Nickel	Electro-tin	Electro Solder

SWAGE TOOLING	
Recommended Swaging Tools:-	Contact us for more tooling information
Anvil	435-6420-01-00-00
Punch	435-6657-01-00-00

Mechanical tolerance unless otherwise stated ±.005(0,13)