

SMD Power Inductor CDRH7D58R/A



Description

- Ferrite drum core construction.
- Magnetically shielded.
- L × W × H: 7.2 × 7.2 × 6.0 mm Max.
- Product weight: 1.0g(Ref.)
- Moisture Sensitivity Level: 1
- RoHS compliance.

Environmental Data

- Operating temperature range: -40°C~+125°C (excluding coil's self temperature rise)
- Storage temperature range: -40°C~+85°C
- Solder reflow temperature: 260 °C peak.

Packaging

- Carrier tape and reel packaging

Applications

- Automotive.

Dimension - [mm]

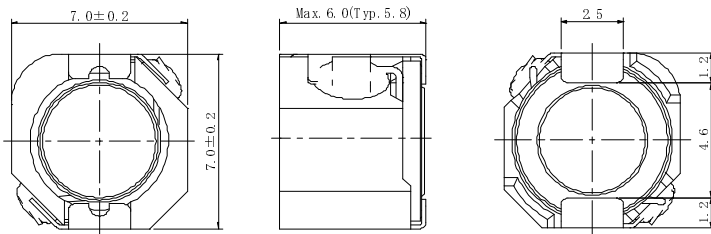

Land pattern and Schematics - [mm]

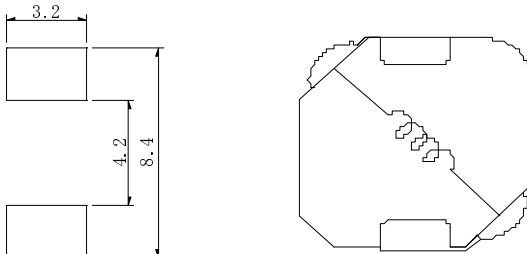

Electrical Characteristics

PART NO.	STAMP	INDUCTANCE [WITHIN]※1	D.C.R. (m Ω) [Max.](at 20°C) ※2	Rated Current(A) (at 125°C) ※3
CDRH7D58R/ANP-100MC	A	10 μH ± 20%	38(31)	1.82
CDRH7D58R/ANP-150MC	B	15 μH ± 20%	48(39)	1.53
CDRH7D58R/ANP-220MC	C	22 μH ± 20%	96(77)	1.28
CDRH7D58R/ANP-330MC	D	33 μH ± 20%	158(127)	1.08
CDRH7D58R/ANP-470MC	E	47 μH ± 20%	195(156)	0.86
CDRH7D58R/ANP-680MC	F	68 μH ± 20%	275(220)	0.73
CDRH7D58R/ANP-101MC	G	100 μH ± 20%	487(390)	0.58
CDRH7D58R/ANP-151MC	H	150 μH ± 20%	612(490)	0.47
CDRH7D58R/ANP-221MC	I	220 μH ± 20%	787(630)	0.38

※1 Measuring frequency inductance at 100kHz.

※2. Rated current: The DC current at which the inductance decreases to 65% of its nominal value or when Δt=30°C, whichever is lower (Ta=20°C).

SMD Power Inductor CDRH7D58R/A



Saturation Current & Temperature Rise Graph

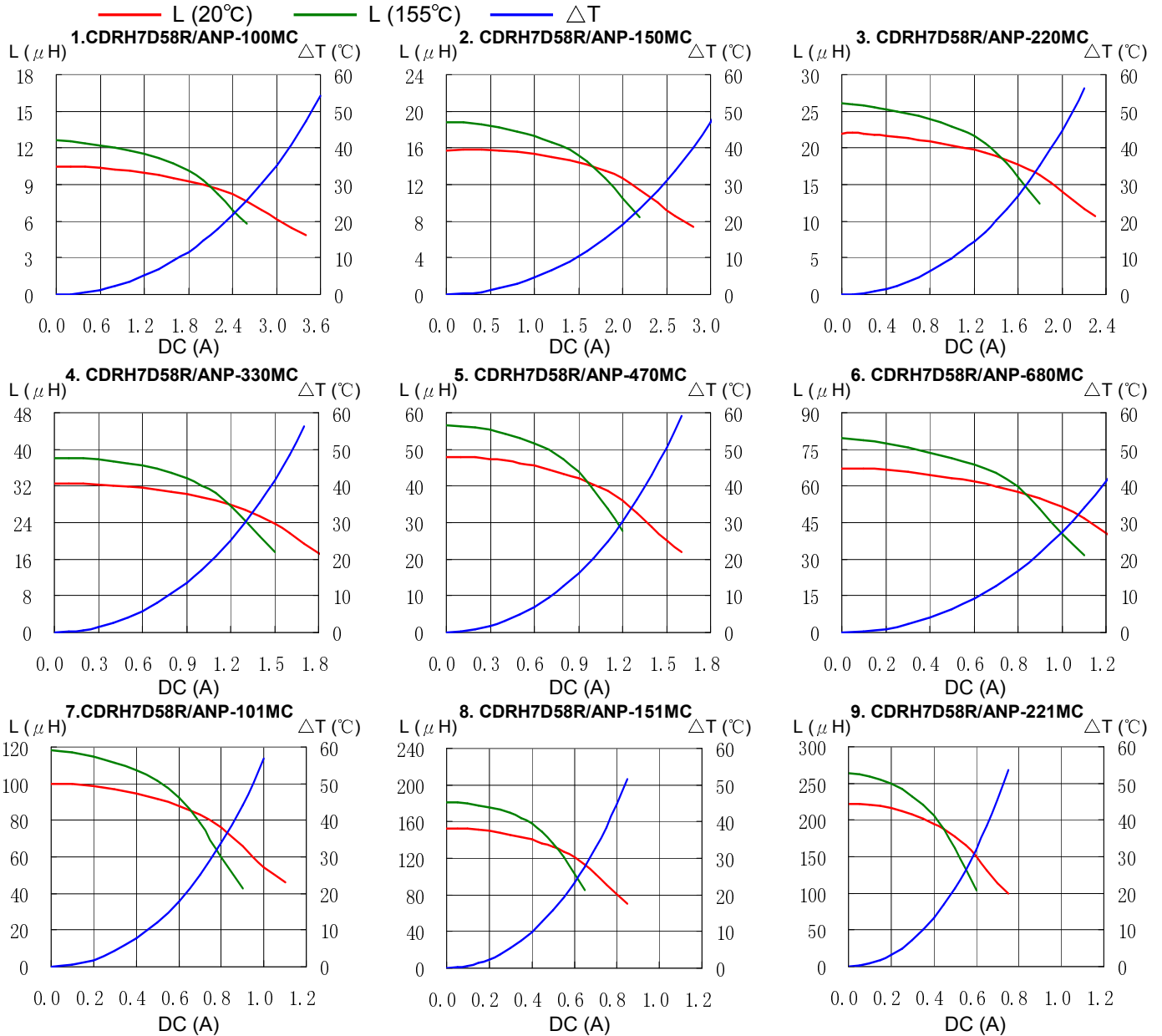

SMD Power Inductor CDRH7D58R/A



Solder Reflow Condition

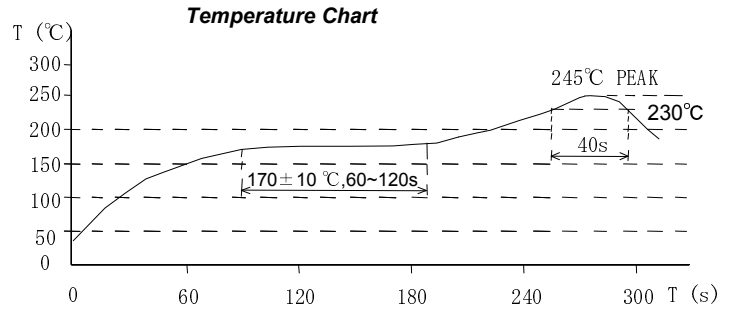
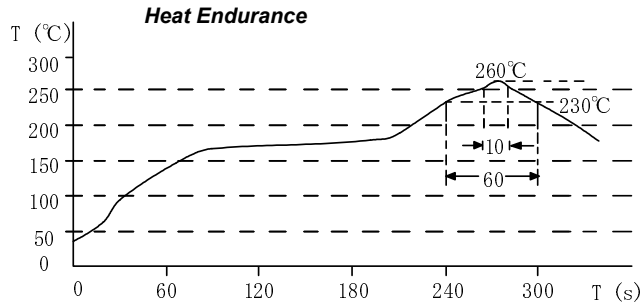

Please refer to the sales offices on our website - <http://www.sumida.com>

Hong Kong

Tel.+852-2880-6688
FAX.+852-2565-9600
sales@hk.sumida.com

Tokyo

Tel.+81-3-5202-7112
FAX.+81-3-5202-7105
sales@jp.sumida.com

Chicago

Tel.+1-847-545-6700
FAX. +1-847-545-6720
sales@us.sumida.com

Shanghai

Tel.+86-021-5836-3299
FAX.+86-021-5836-3266
shanghai.sales@cn.sumida.com

Seoul

Tel.+82-2-6237-0777
FAX.+82-2-6237-0778
sales@kr.sumida.com

Oberzell

Tel.+49-8591-937-0
FAX. +49-8591-937-103
contact@sumida-eu.com

Shenzhen

Tel.+86-755-8291-0228
FAX.+86-755-8291-0338
shenzhen.sales@cn.sumida.com

Singapore

Tel.+65-6296-3388
FAX.+65-6296-3390
sales@sg.sumida.com

Neumarkt

Tel.+49-9181-4509-110
FAX. +49-9181-4509-310
infocomp@eu.sumida.com

Taipei

Tel.+886-2-8751-2737
FAX.+886-2-8751-2738
sales@tw.sumida.com

San Jose

Tel.+1-408-3219660
FAX.+1-408-321-9308
sales@us.sumida.com