

Subminiature Right Angle LED Indicators

Technical Data

Option 010

Features

- Ideal for PC Board Status Indication
- Side Stackable on 2.54 mm (0.100 in.) Centers
- Available in Four Colors
- Housing Meets UL 94V-O Flammability Rating
- Additional Catalog Lamps Available as Options

Description

The Agilent Technologies series of Subminiature Right Angle Indicators are industry standard status indicators that incorporate tinted diffused LED lamps in black plastic housings. The 2.54 mm (0.100 in.) wide packages may be side stacked for maximum board space savings. The silver

plated leads are in line on 2.54 mm (0.100 in.) centers, a standard spacing that makes the PC board layout straight-forward. These products are designed to be used as back panel diagnostic indicators and logic status indicators on PC boards.

Package Dimensions

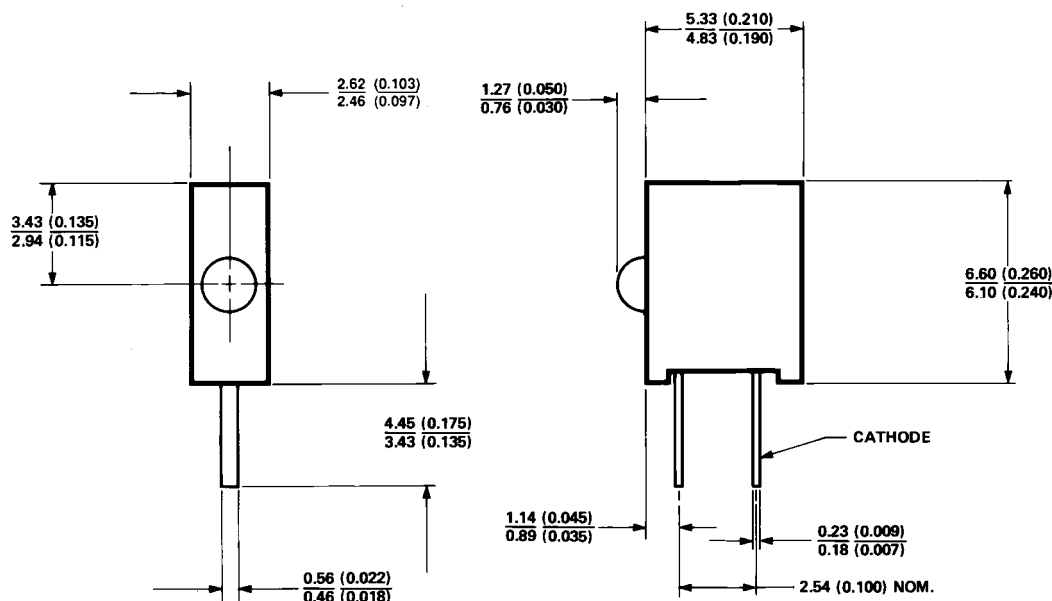

NOTE: ALL DIMENSIONS ARE IN MILLIMETRES (INCHES).

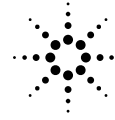

Agilent Technologies

Innovating the HP Way

Ordering Information

To order Subminiature Right Angle indicators, order the base part number and add the option code 010. Example: HLMP-6300 option 010. For price and delivery on Resistor Subminiature Right Angle Indicators and other subminiature LEDs not indicated above, please contact your nearest HP Components representative.

Absolute Maximum Ratings and Other Electrical/Optical Characteristics

The absolute maximum ratings and typical device characteristics are identical to those of the Subminiature lamps. For information about these characteristics, see the data sheets of the equivalent Subminiature lamp.

Note: Option 010 is not applicable for all AlInGaP devices.

www.semiconductor.agilent.com

Data subject to change.

Copyright © 1999 Agilent Technologies, Inc.

Obsoletes 5964-9421E

5968-0056E (11/99)