

**CMPZ4099  
THRU  
CMPZ4124**

**SURFACE MOUNT  
LOW NOISE SILICON ZENER DIODE  
6.8 VOLTS THRU 43 VOLTS  
350mW, 5% TOLERANCE**

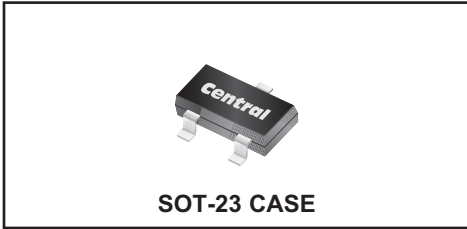

[www.centralemi.com](http://www.centralemi.com)



**DESCRIPTION:**

The CENTRAL SEMICONDUCTOR CMPZ4099 Series types are high quality silicon zener diodes designed for low leakage, low current and low noise applications.

**NOTE:** For lower voltage devices, see CMPZ4614 Series.

**MARKING CODE: CONSULT FACTORY**

**MAXIMUM RATINGS:** ( $T_A=25^\circ\text{C}$  unless otherwise noted)

Power Dissipation  
Operating and Storage Junction Temperature

**SYMBOL**

$P_D$  350  
 $T_J, T_{stg}$  -65 to +150

**UNITS**

mW  
 $^\circ\text{C}$

**ELECTRICAL CHARACTERISTICS:** ( $T_A=25^\circ\text{C}$  unless otherwise noted)  $V_F=1.0\text{V MAX @ } I_F=200\text{mA}$  (for all types)

TYPE	ZENER VOLTAGE			TEST CURRENT	MAXIMUM ZENER IMPEDANCE	MAXIMUM REVERSE LEAKAGE CURRENT		MAXIMUM ZENER CURRENT	MAXIMUM NOISE DENSITY
	$V_Z @ I_{ZT}$					$I_{ZT}$	$I_R @ V_R$		
	MIN V	NOM V	MAX V	$\mu\text{A}$	$\Omega$	$\mu\text{A}$	V	mA	$\mu\text{V}/\sqrt{\text{Hz}}$
CMPZ4099	6.460	6.8	7.140	250	200	10	5.2	35.0	40
CMPZ4100	7.125	7.5	7.865	250	200	10	5.7	31.8	40
CMPZ4101	7.790	8.2	8.610	250	200	1.0	6.3	29.0	40
CMPZ4102	8.265	8.7	9.135	250	200	1.0	6.7	27.4	40
CMPZ4103	8.645	9.1	9.555	250	200	1.0	7.0	26.2	40
CMPZ4104	9.500	10	10.50	250	200	1.0	7.6	24.8	40
CMPZ4105	10.45	11	11.55	250	200	0.05	8.5	21.6	40
CMPZ4106	11.40	12	12.60	250	200	0.05	9.2	20.4	40
CMPZ4107	12.35	13	13.65	250	200	0.05	9.9	19.0	40
CMPZ4108	13.30	14	14.70	250	200	0.05	10.7	17.5	40
CMPZ4109	14.25	15	15.75	250	100	0.05	11.4	16.3	40
CMPZ4110	15.20	16	16.80	250	100	0.05	12.2	15.4	40
CMPZ4111	16.15	17	17.85	250	100	0.05	13.0	14.5	40
CMPZ4112	17.10	18	18.90	250	100	0.05	13.7	13.2	40
CMPZ4113	18.05	19	19.95	250	150	0.05	14.5	12.5	40
CMPZ4114	19.00	20	21.00	250	150	0.01	15.2	11.9	40
CMPZ4115	20.90	22	23.10	250	150	0.01	16.8	10.8	40
CMPZ4116	22.80	24	25.20	250	150	0.01	18.3	9.9	40
CMPZ4117	23.75	25	26.25	250	150	0.01	19.0	9.5	40
CMPZ4118	25.65	27	28.35	250	150	0.01	20.5	8.8	40
CMPZ4119	26.60	28	29.40	250	200	0.01	21.3	8.5	40
CMPZ4120	28.50	30	31.50	250	200	0.01	22.8	7.9	40
CMPZ4121	31.35	33	34.65	250	200	0.01	25.1	7.2	40
CMPZ4122	34.20	36	37.80	250	200	0.01	27.4	6.6	40
CMPZ4123	37.05	39	40.95	250	200	0.01	29.7	6.1	40
CMPZ4124	40.85	43	45.15	250	250	0.01	32.7	5.5	40

R6 (3-February 2010)

**CMPZ4099**  
**THRU**  
**CMPZ4124**  
**SURFACE MOUNT**  
**LOW NOISE SILICON ZENER DIODE**  
**6.8 VOLTS THRU 43 VOLTS**  
**350mW, 5% TOLERANCE**



**SOT-23 CASE - MECHANICAL OUTLINE**

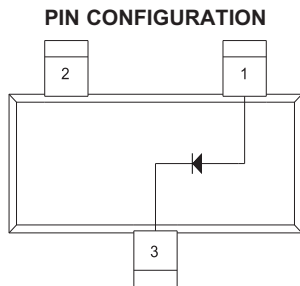
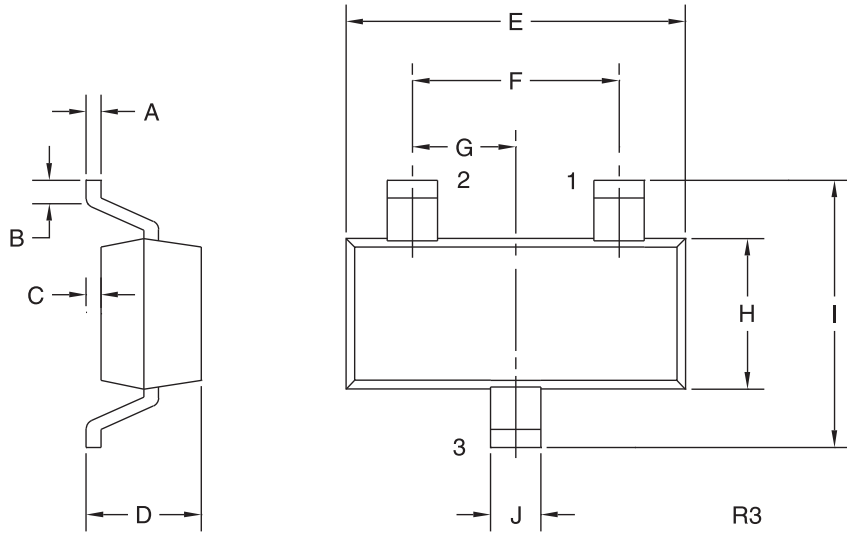

**LEAD CODE:**

- 1) Anode
- 2) No Connection
- 3) Cathode

**MARKING CODE:**  
**CONSULT FACTORY**

SYMBOL	INCHES		MILLIMETERS	
	MIN	MAX	MIN	MAX
A	0.003	0.007	0.08	0.18
B	0.006	-	0.15	-
C	-	0.005	-	0.13
D	0.035	0.043	0.89	1.09
E	0.110	0.120	2.80	3.05
F	0.075		1.90	
G	0.037		0.95	
H	0.047	0.055	1.19	1.40
I	0.083	0.098	2.10	2.49
J	0.014	0.020	0.35	0.50

SOT-23 (REV: R3)

R6 (3-February 2010)