



VRLA Rechargeable Battery

BP8-6V (BP8-6VFR)



FEATURES

- Maintenance free(no water topping-up required).
- No free acid(Non-spillable battery).
- Low self-discharge rate, lower than 3% capacity loss per month.
- Can be used in any orientation(excluding used inverted).

APPLICATION

- UPS
- Toy-Cars
- Emergency Lights



SPECIFICATIONS

Nominal Voltage	6 V
Nominal Capacity	8.0Ah @ 20 hour rate F.V.(1.75V/cell)
Approx. Weight	1550g(3.42lbs.)
Terminals	T1 (Faston Tab 187) T2 is optional
Internal Resistance	≤9mΩ (Fully Charged)
Max. Discharge Current	120 A (5 sec.)
Max. Charge Current	2.4 A
Operating Temperature Range	Charge : 0°C~40°C(32°F~104°F) Discharge : -20°C~50°C(-4°F~122°F) Storage. : -20°C~40°C(-4°F~104°F)
Container Material	ABS(UL94-HB, UL94-V0 is optional)

ISO 9001	
ISO14001	
UL	 MH19884
CE	 C4M20310-2474-E-16
<ul style="list-style-type: none"> ● IEC61056 ● JIS C 8702 ● GB/T 19639 	

DIMENSION(mm/inch)

OUTER DIMENSIONS

TERMINAL TYPE

Length

98±1.5 (3.86±0.06)

Width

56±1.5 (2.20±0.06)

Container Height

118±1.5 (4.65±0.06)

Total Height

118±1.5 (4.65±0.06)

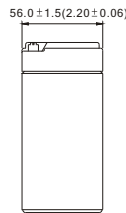
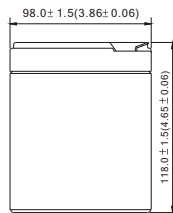
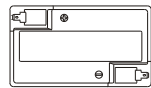

Terminal T1

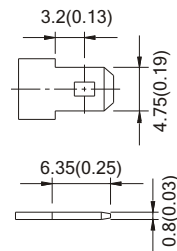

Terminal T2

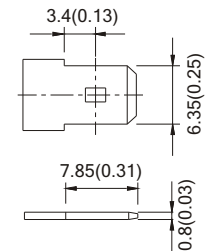

Constant power discharge characteristics at 25 °C/77 °F

Unit: W

Discharge Time F.V. (V/cell)	5 Min	10 Min	15 Min	30 Min	1 Hr	3 Hr	5 Hr	10 Hr	20 Hr
1.80V	144.6	106.5	85.3	50.8	29.1	11.66	8.04	4.49	2.36
1.75V	167.4	115.3	89.2	52.7	30.0	11.89	8.16	4.56	2.40
1.70V	177.9	119.5	92.0	53.9	30.5	12.00	8.20	4.58	2.41
1.65V	185.8	122.4	94.1	54.7	30.9	12.08	8.23	4.60	2.42
1.60V	192.0	124.8	96.0	55.2	31.2	12.16	8.26	4.60	2.42

Constant current discharge characteristics at 25 °C/77 °F

Unit: A

Discharge Time F.V. (V/cell)	5 Min	10 Min	15 Min	30 Min	1 Hr	3 Hr	5 Hr	10 Hr	20 Hr
1.80V	26.06	18.74	14.84	8.60	4.89	1.94	1.340	0.749	0.394
1.75V	30.71	20.31	15.52	8.93	5.04	1.98	1.360	0.760	0.400
1.70V	32.63	21.04	16.00	9.14	5.13	2.00	1.367	0.764	0.402
1.65V	34.10	21.54	16.37	9.26	5.19	2.01	1.372	0.766	0.403
1.60V	35.23	21.97	16.70	9.36	5.24	2.03	1.376	0.766	0.403

All data shall be changed without prior notice, BB reserves the right to explain and update the information contained hereinto.