

POSITRONIC ASIA PTE. LTD. BELIEVES THE DATA ON THE DRAWING TO BE RELIABLE. SINCE THE TECHNICAL INFORMATION IS GIVEN FREE OF CHARGE, THE USER EMPLOYS SUCH INFORMATION AT HIS OWN DISCRETION AND RISK. POSITRONIC ASIA PTE. LTD. ASSUMES NO RESPONSIBILITY FOR RESULTS OBTAINED OR DAMAGES INCURRED FROM USE OF SUCH INFORMATION IN WHOLE OR IN PART.

| DATE      | REV | REVISION RECORD | DRN | CKD | APP |
|-----------|-----|-----------------|-----|-----|-----|
| 24 SEP 08 | NC  | PA ECO 08207    | KA  | EH  | NK  |
| 05 Nov 08 | A   | PA ECO 08235    | LP  | EH  | KM  |

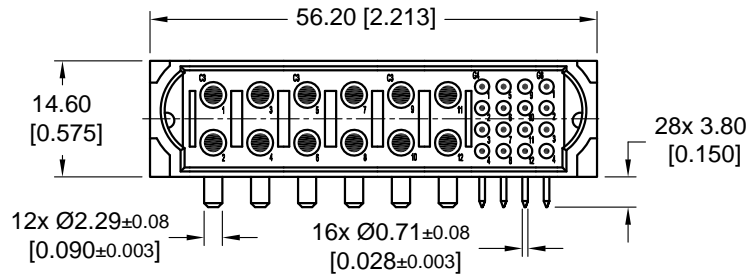

CONTACT HOLES PATTERN

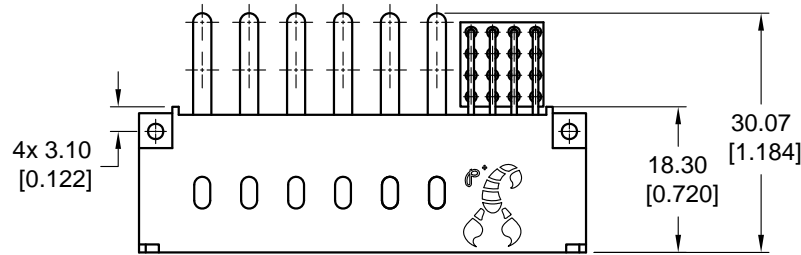
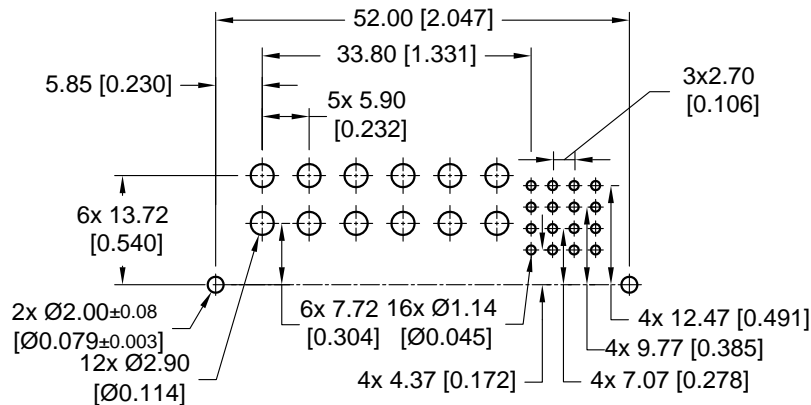

SIZE 12 CONTACTS

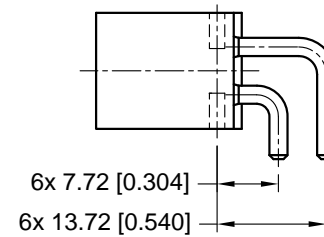

SIZE 22 CONTACTS

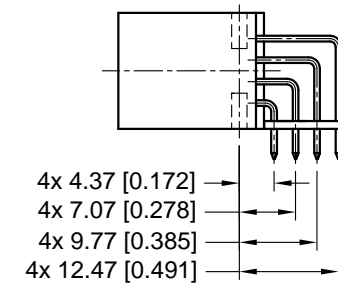

**NOTES:**

- MATERIALS AND FINISHES  
INSULATOR: GLASS-FILLED POLYESTER, UL 94V-0. COLOR: BLUE.  
CONTACTS: PRECISION MACHINED COPPER ALLOY WITH GOLD OVER NICKEL PLATE.

| DRAWING NO. | PART NUMBER       | REMARKS  |
|-------------|-------------------|--|
| ASK21701-1  | SP2YYYYKH4M009    | -  |
| ASK21701-2  | SP2YYYYKH4M009/AA | RoHS COMPLIANT PER RoHS DIRECTIVE 2002/95/EC OF 27 JAN 200 |



**POSITRONIC ASIA PTE. LTD**  
3014A UBI ROAD 1, #07-01. SINGAPORE 408703  
Tel: (65) 6842-1419 / Fax: (65) 6842-1421 / Email: singapore@connectpositronic.cc

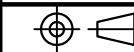

**GENERAL TOL.**  
LINEAR : ±0.38 [0.015]  
ANGULAR : ±5°

UNLESS OTHERWISE SPECIFIED, ALL DIMENSIONS ARE IN MILLIMETERS [INCHES]

| SERIES                                    | SCALE          | DRAWN        | CHECKED | APPROV |
|---|----------------|--------------|---------|--------|
| SP  | NTS            | KA           | EH      | NK     |
| TITLE SP2YYYYKH4M009<br>SP2YYYYKH4M009/AA |                |              |         |        |
| DATE                                      | DRAWING NUMBER | SHEET 1 OF 1 |         | REV.   |
| 24 SEP 08                                 | ASK21701-*     |              |         | A      |