

THIS DRAWING IS UNPUBLISHED. RELEASED FOR PUBLICATION
 © COPYRIGHT BY TYCO ELECTRONICS CORPORATION. ALL RIGHTS RESERVED.

| | | | | | | | |
|-----|------|-----------|-----|---------------|---------|-----|------|
| LOC | DIST | REVISIONS | | | | | |
| DW | — | P | LTR | DESCRIPTION | DATE | DWN | APVD |
| | | A | | ECR-07-028576 | 14DEC07 | AW | WK |

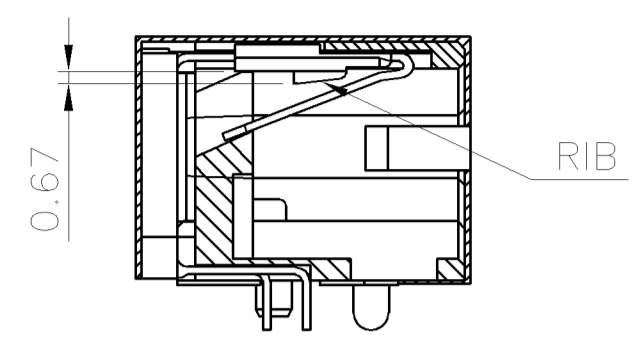

SECTION A-A

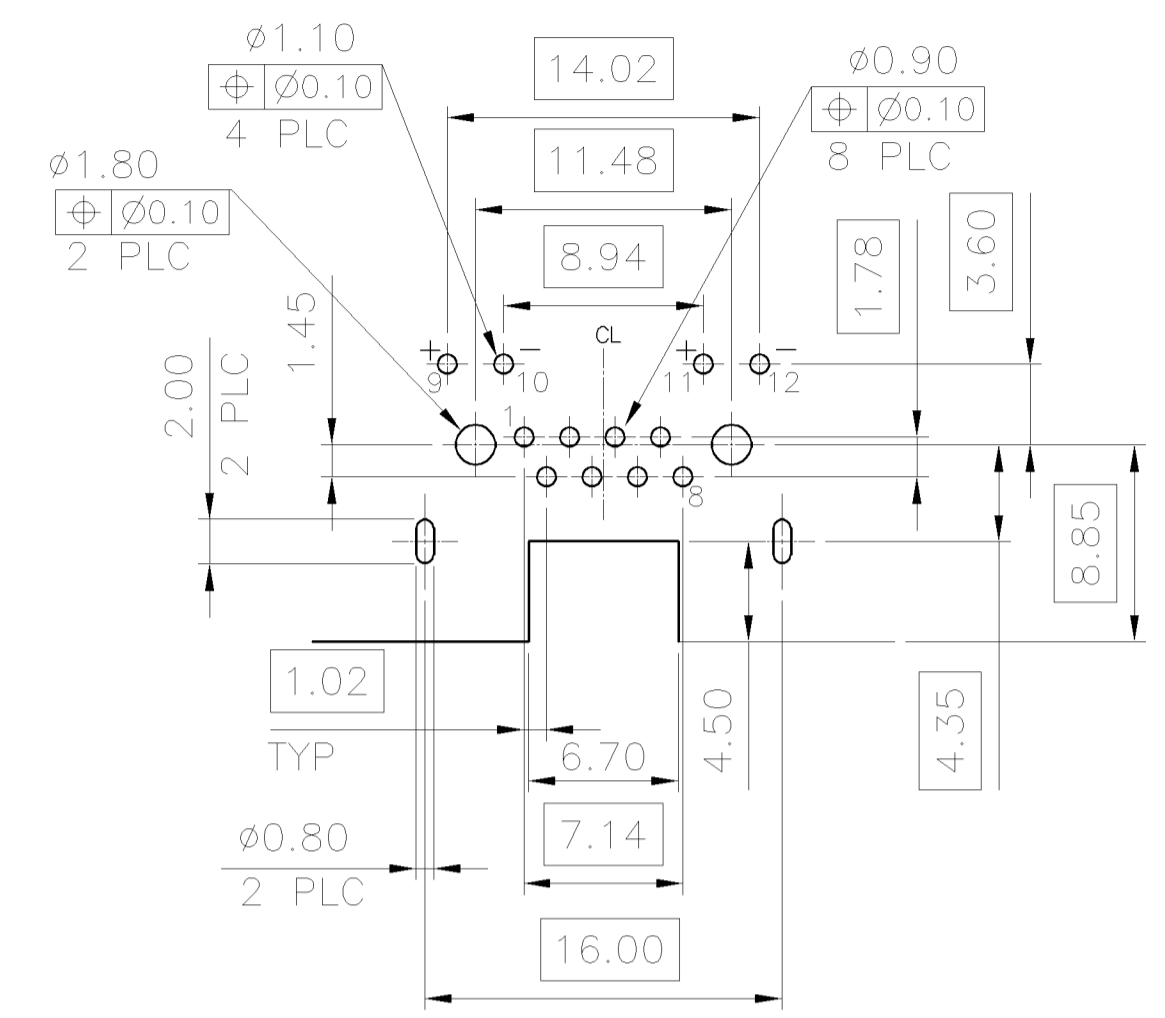
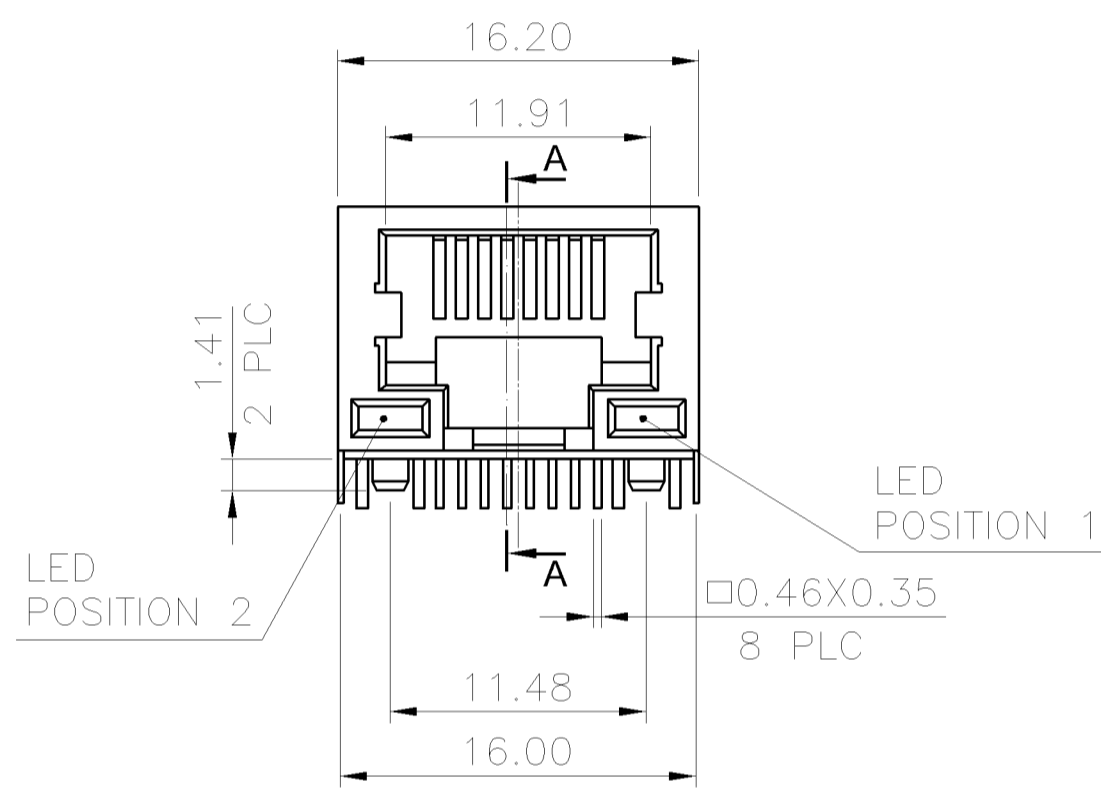
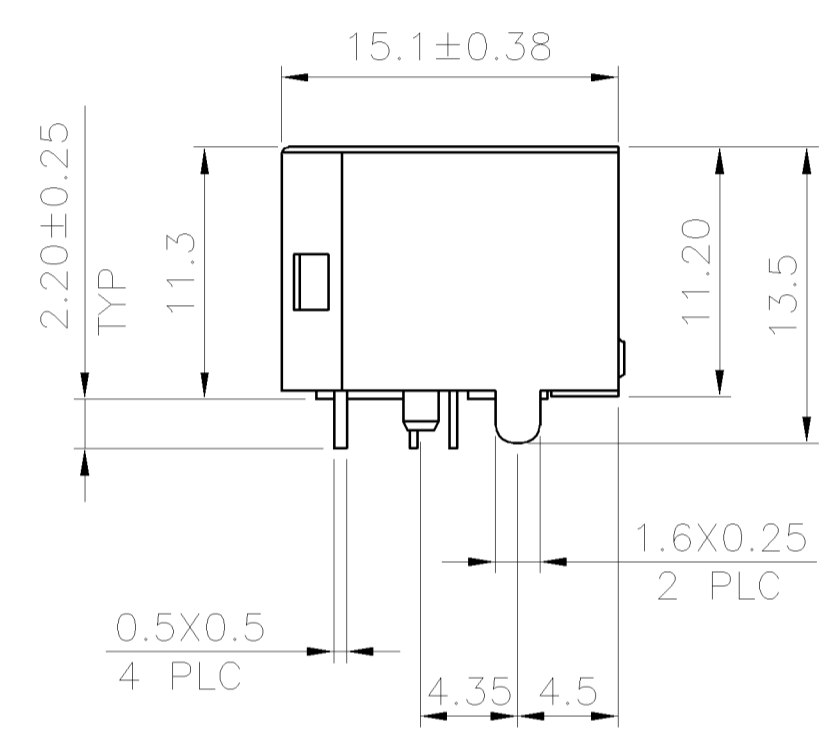
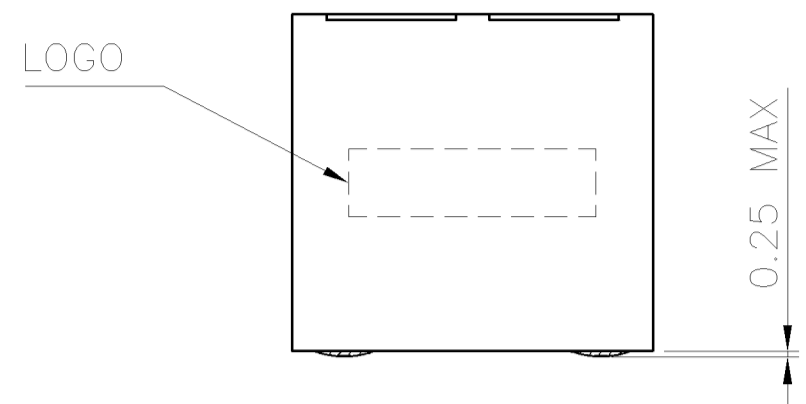

RECOMMENDED PCB LAYOUT (THICKNESS: 1.6mm)
 DIMENSION TOLERANCE: 1 PLC: ±0.1 2PLC: ±0.05

- NOTE:
- MATERIAL:
 HOUSING: PA46 WITH 30% GF, UL 94V-0, BLACK COLOR.
 CONTACTS: PHOSPHOR BRONZE.
 LED LIGHT: EPOXY RESIN.
 SHELL: BRASS.
 - FINISH:
 CONTACTS: (SEE TABLE) GOLD PLATED ON CONTACT AREA, GOLD FLASH ON SOLDER TAILS, WITH ENTIRE CONTACT UNDERPLATED 1.27µm [50µ"] MIN. NICKEL.
 LED: 1.65µm [65µ"] MIN. Ag PLATED.
 2.16µm [85µ"] MIN. TIN PLATED.
 FORWARD CURRENT: 20mA.
 FORWARD VOLTAGE: 2.2 VOLTS TYPICAL.
 SHELL: 0.50µm [20µ"] MIN. NICKEL PLATED.
 - LED MUST BE REFLOW COMPATIBLE TO FOLLOWING TEMPERATURE PROFILE (FOR 1 CYCLE): ABOVE 160°C FOR 120 SECONDS, PEAKING AT 220°C FOR 10 SECONDS.
 - LED DEFECT RATE IS 6000 PPM MAX. AFTER IR REFLOW PROCESS AS NOTE 3.
 - WAVE SOLDER CAPABLE TO 265°C PER TE SPEC. 109-202, CONDITION B.

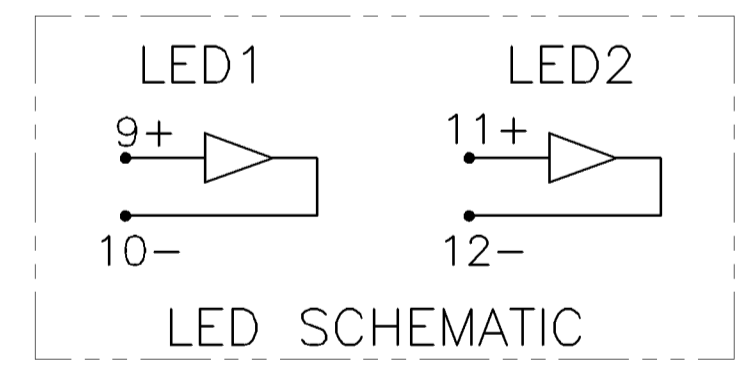
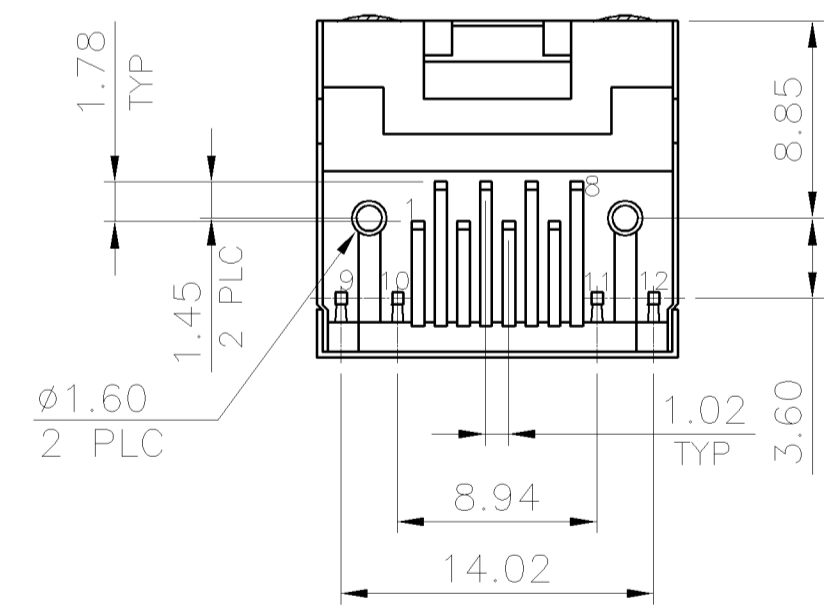

| | | | | |
|---------|------------|------------|---------------------|-------------|
| REEL | YELLOW | GREEN | 50µ" | 1-1734324-8 |
| | | | 30µ" | 1-1734324-7 |
| | | | 15µ" | 1-1734324-6 |
| | GREEN | YELLOW | 6µ" | 1-1734324-5 |
| | | | 50µ" | 1-1734324-4 |
| | | | 30µ" | 1-1734324-3 |
| TRAY | YELLOW | GREEN | 15µ" | 1-1734324-2 |
| | | | 6µ" | 1-1734324-1 |
| | | | 50µ" | 1734324-8 |
| | GREEN | YELLOW | 30µ" | 1734324-7 |
| | | | 15µ" | 1734324-6 |
| | | | 6µ" | 1734324-5 |
| PACKAGE | POSITION 2 | POSITION 1 | MIN. GOLD THICKNESS | PART NUMBER |

| | | | | | |
|--|--|---------------------------|-----------|---|--|
| THIS DRAWING IS A CONTROLLED DOCUMENT. | | DWN | 04MAR2008 | | Tyco Electronics Corporation Taipei, Taiwan |
| | | A. WU | | | |
| | | CHK | 04MAR2008 | | |
| | | S. HOU | | | |
| | | APVD | 04MAR2008 | | NAME |
| | | W. KODAMA | | MODULAR JACK, RJ45, 8P8C, WITH LED & SHIELD, DIP, REVERSE VERSION | |
| | | PRODUCT SPEC | | 108-57535 | |
| | | QUALIFICATION TEST REPORT | | 501-57628 | |
| | | WEIGHT | | 4.5 GRAMS | |
| | | CUSTOMER DRAWING | | A300779 C-1734324 | |
| | | SCALE | | — | |
| | | SHEET | | 1 OF 7 | |
| | | REV | | A | |

THIS DRAWING IS UNPUBLISHED. RELEASED FOR PUBLICATION
 © COPYRIGHT BY TYCO ELECTRONICS CORPORATION. ALL RIGHTS RESERVED.

| LOC | DIST | REVISIONS | | | | | |
|-----|------|-----------|-----|--------------|------|-----|------|
| DW | — | P | LTR | DESCRIPTION | DATE | DWN | APVD |
| | | | | SEE SHEET 1. | | | |

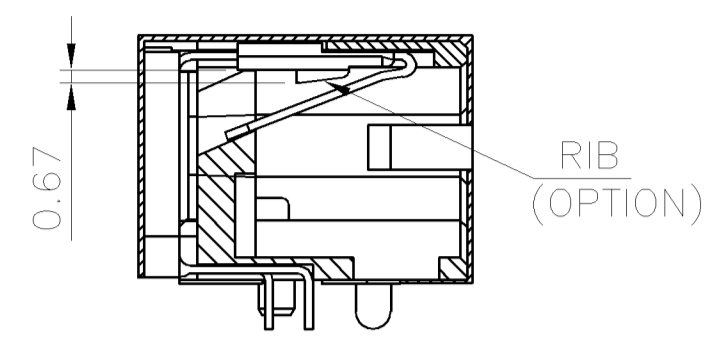

SECTION A-A

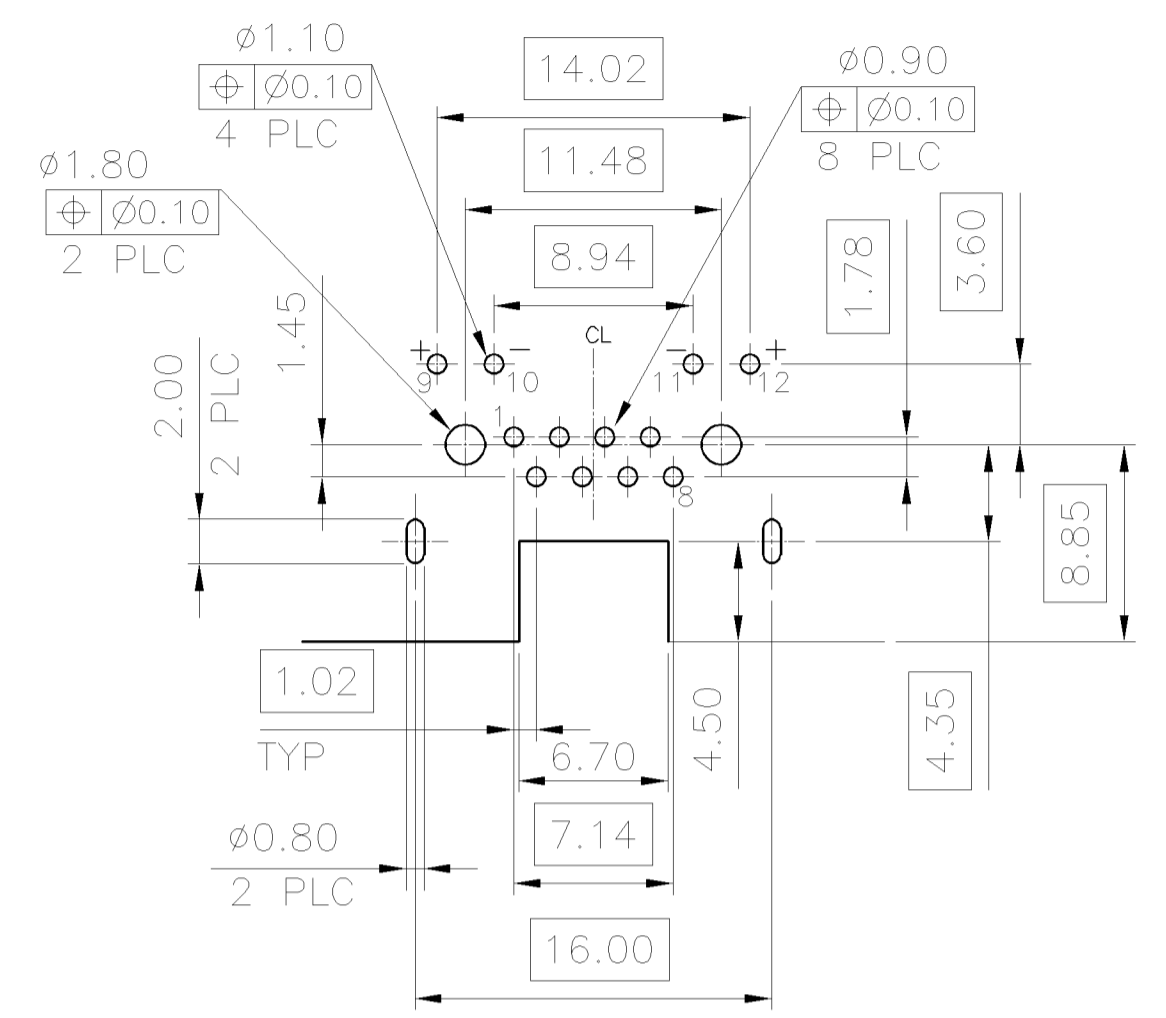
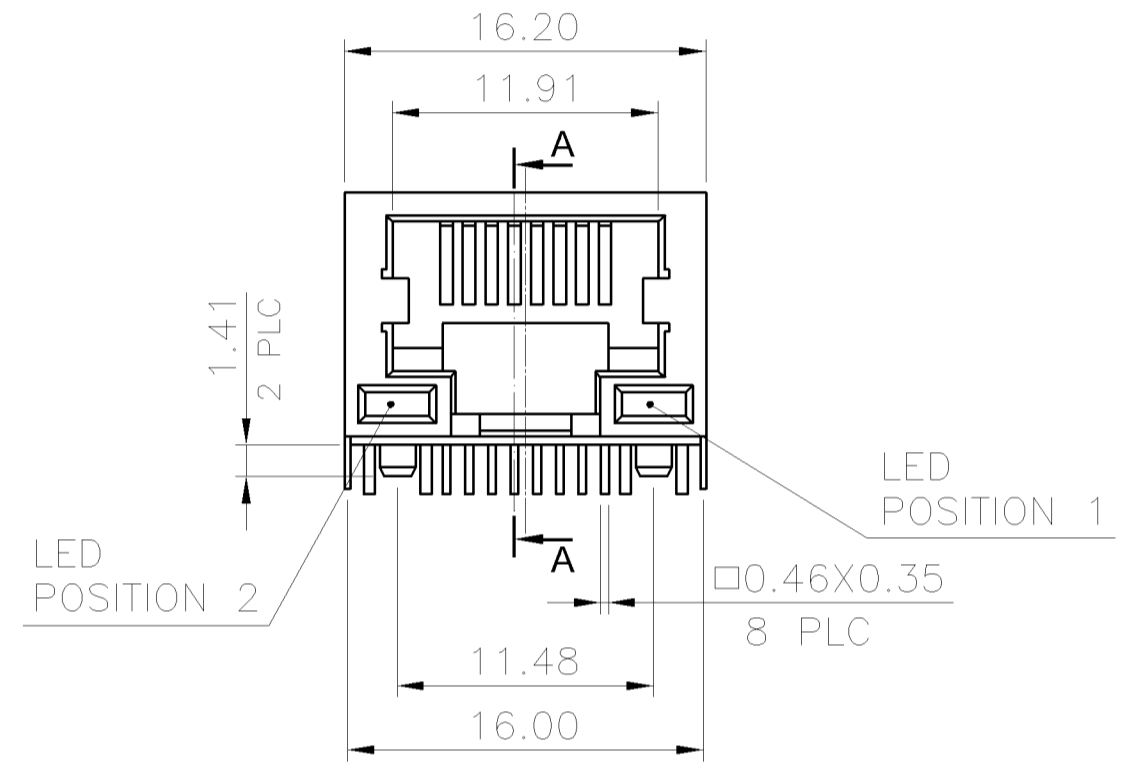
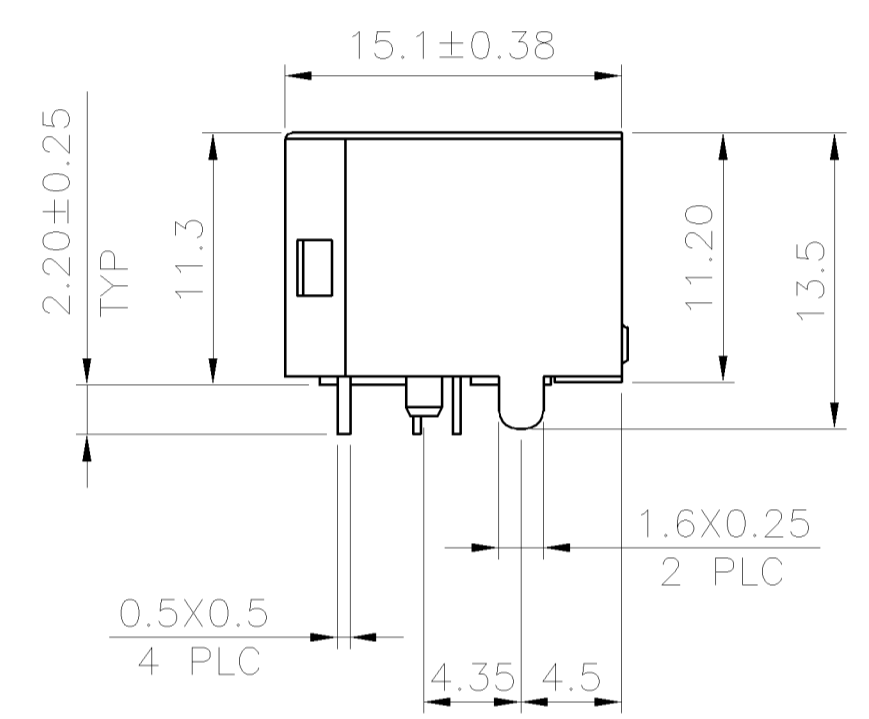
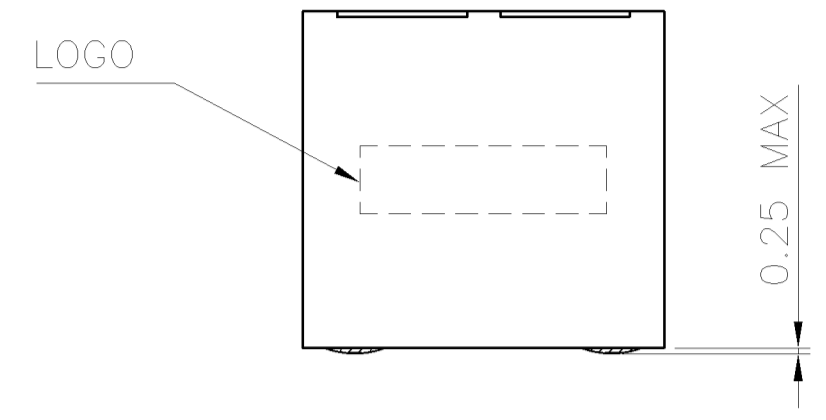

RECOMMENDED PCB LAYOUT (THICKNESS: 1.6mm)
 DIMENSION TOLERANCE: 1 PLC: ±0.1 2PLC: ±0.05)

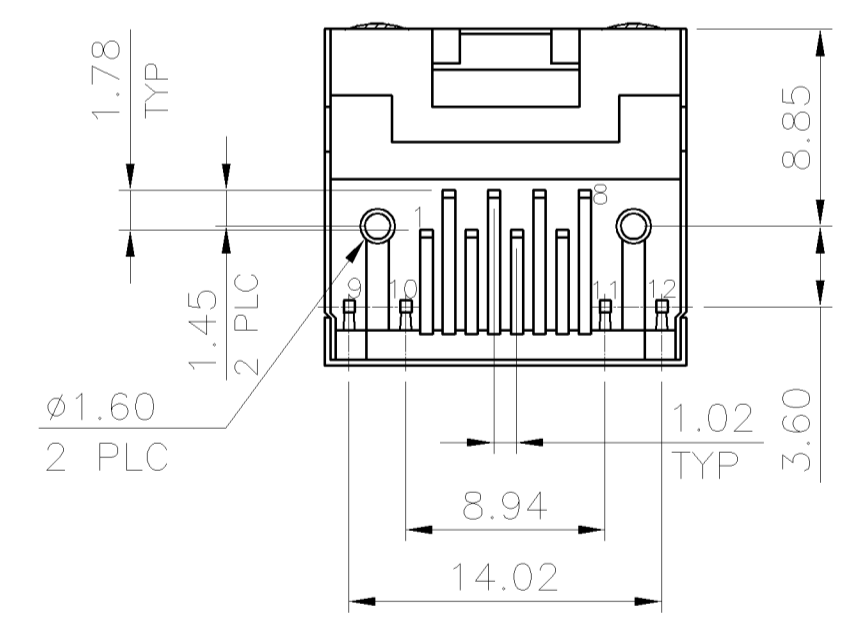
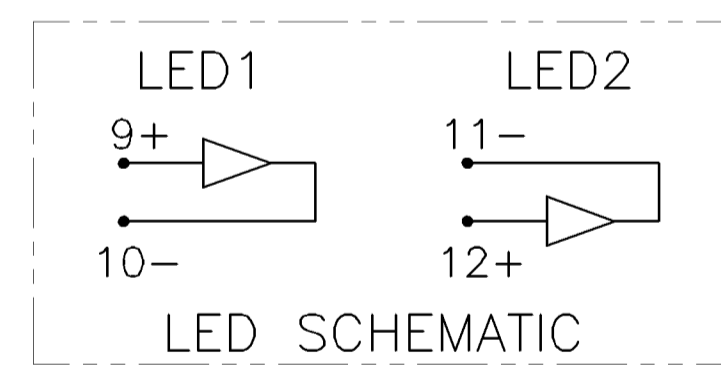

- NOTE:
- MATERIAL:
 HOUSING: PA46 WITH 30% GF, UL 94V-0, BLACK COLOR.
 CONTACTS: PHOSPHOR BRONZE.
 LED LIGHT: EPOXY RESIN.
 SHELL: BRASS.
 - FINISH:
 CONTACTS: (SEE TABLE) GOLD PLATED ON CONTACT AREA, GOLD FLASH ON SOLDER TAILS, WITH ENTIRE CONTACT UNDERPLATED 1.27µm [50µ"] MIN. NICKEL.
 LED: 1.65µm [65µ"] MIN. Ag PLATED.
 2.16µm [85µ"] MIN. TIN PLATED.
 FORWARD CURRENT: 20mA.
 FORWARD VOLTAGE: 2.2 VOLTS TYPICAL.
 SHELL: 0.50µm [20µ"] MIN. NICKEL PLATED.
 - LED MUST BE REFLOW COMPATIBLE TO FOLLOWING TEMPERATURE PROFILE (FOR 1 CYCLE): ABOVE 160°C FOR 120 SECONDS, PEAKING AT 220°C FOR 10 SECONDS.
 - LED DEFECT RATE IS 6000 PPM MAX. AFTER IR REFLOW PROCESS AS NOTE 3.
 - WAVE SOLDER CAPABLE TO 265°C PER TE SPEC. 109-202, CONDITION B.

| | | | | | | |
|-----|---------|------------|-----------------|---------------------|-------------|--|
| W/O | REEL | YELLOW | GREEN | 50µ" | 3-1734324-8 | |
| | | | GREEN | 30µ" | 3-1734324-7 | |
| | | | GREEN | 15µ" | 3-1734324-6 | |
| | | GREEN | YELLOW | 6µ" | 3-1734324-5 | |
| | | | YELLOW | 50µ" | 3-1734324-4 | |
| | | | YELLOW | 30µ" | 3-1734324-3 | |
| W/ | TRAY | YELLOW | GREEN | 15µ" | 3-1734324-2 | |
| | | | GREEN | 6µ" | 3-1734324-1 | |
| | | | GREEN | 50µ" | 2-1734324-8 | |
| | | GREEN | YELLOW | 30µ" | 2-1734324-7 | |
| | | | YELLOW | 15µ" | 2-1734324-6 | |
| | | | YELLOW | 6µ" | 2-1734324-5 | |
| RIB | PACKAGE | POSITION 2 | POSITION 1 | MIN. GOLD THICKNESS | PART NUMBER | |
| | | | INDICATOR COLOR | | | |
| | | | | | | |

| | | | | | |
|---|----------|--|-----------|---|--|
| THIS DRAWING IS A CONTROLLED DOCUMENT. | | DWN | 04MAR2008 | | Tyco Electronics Corporation Taipei, Taiwan |
| DIMENSIONS: MM | | CHK | 04MAR2008 | | |
| TOLERANCES UNLESS OTHERWISE SPECIFIED: | | APVD | 04MAR2008 | | |
| 0 PLC ± 0.50 1 PLC ± 0.38 2 PLC ± 0.25 3 PLC ± 0.10 4 PLC ± - ANGLES ± - | | NAME W. KODAMA PRODUCT SPEC 108-57535 QUALIFICATION TEST REPORT 501-57628 WEIGHT 4.5 GRAMS | | NAME MODULAR JACK, RJ45, 8P8C, WITH LED & SHIELD, DIP, REVERSE VERSION | |
| MATERIAL | SEE NOTE | FINISH | | SEE NOTE | SIZE A300779 |
| CUSTOMER DRAWING | | SCALE | | — | SHEET 2 OF 7 |
| | | REV | | A | RESTRICTED TO |

THIS DRAWING IS UNPUBLISHED. RELEASED FOR PUBLICATION
 © COPYRIGHT BY TYCO ELECTRONICS CORPORATION. ALL RIGHTS RESERVED.

| LOC | DIST | REVISIONS | | | | | |
|-----|------|-----------|-----|--------------|------|-----|------|
| DW | — | P | LTR | DESCRIPTION | DATE | DWN | APVD |
| | | | | SEE SHEET 1. | | | |

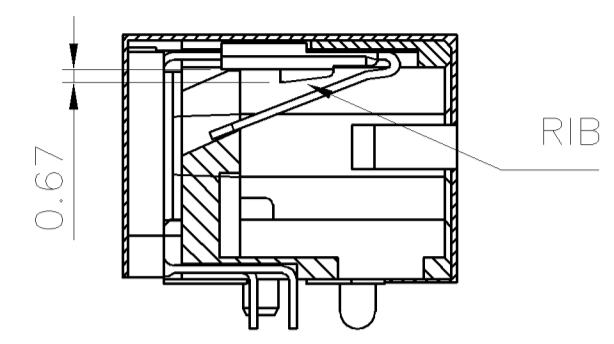

SECTION A-A

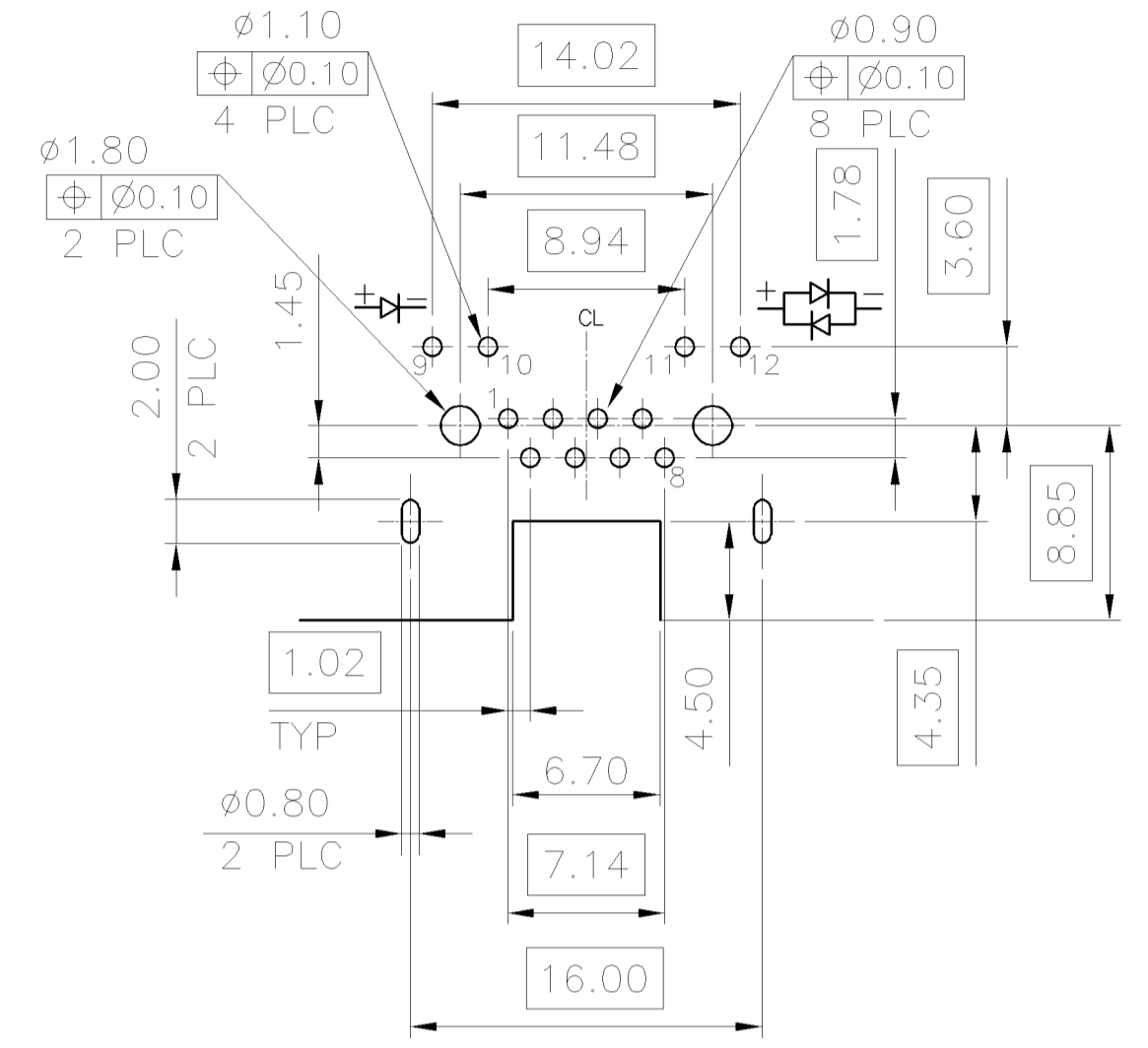
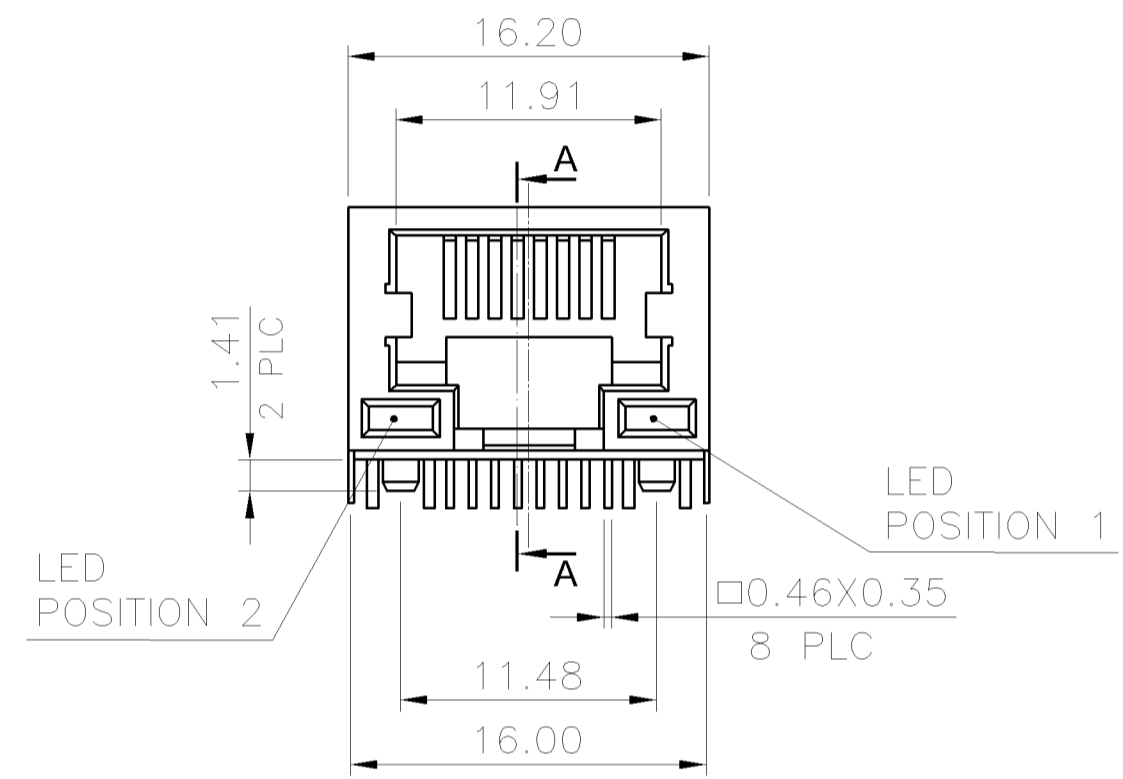
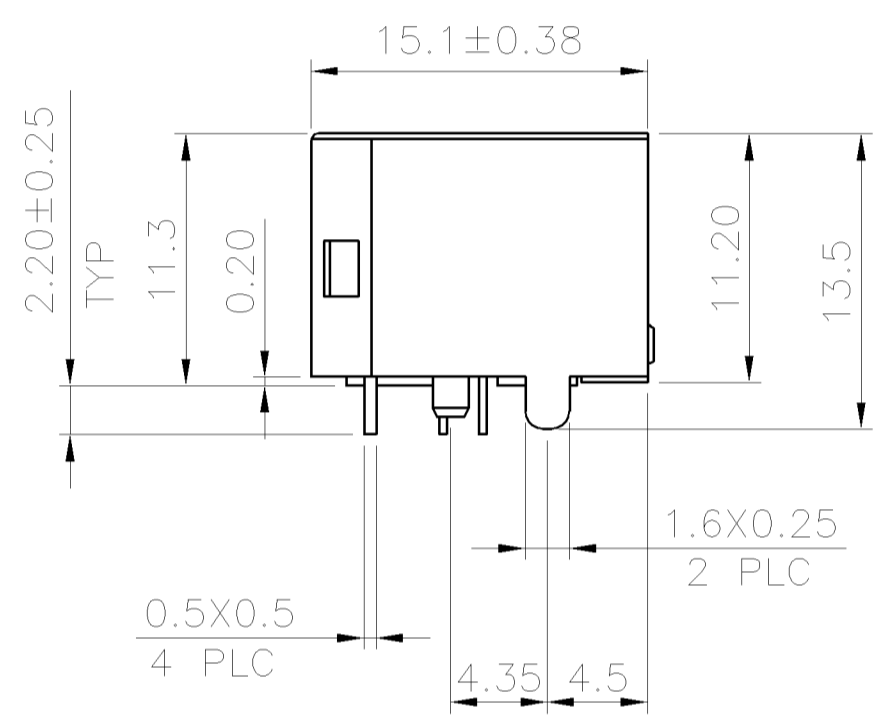
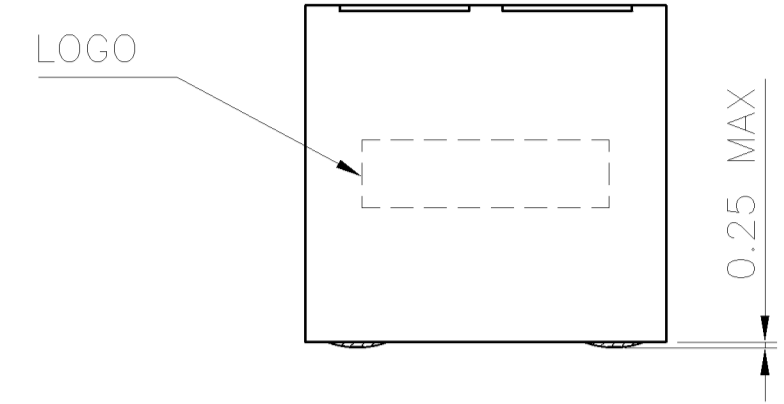

RECOMMENDED PCB LAYOUT (THICKNESS: 1.6mm)
 DIMENSION TOLERANCE: 1 PLC: ±0.1 2PLC: ±0.05

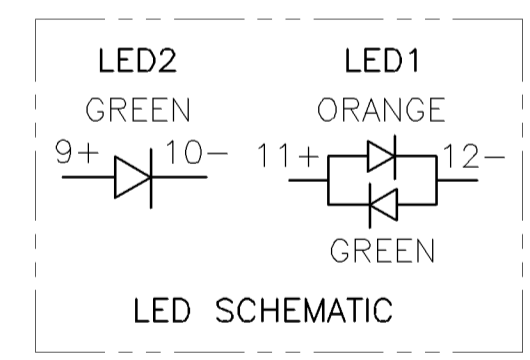
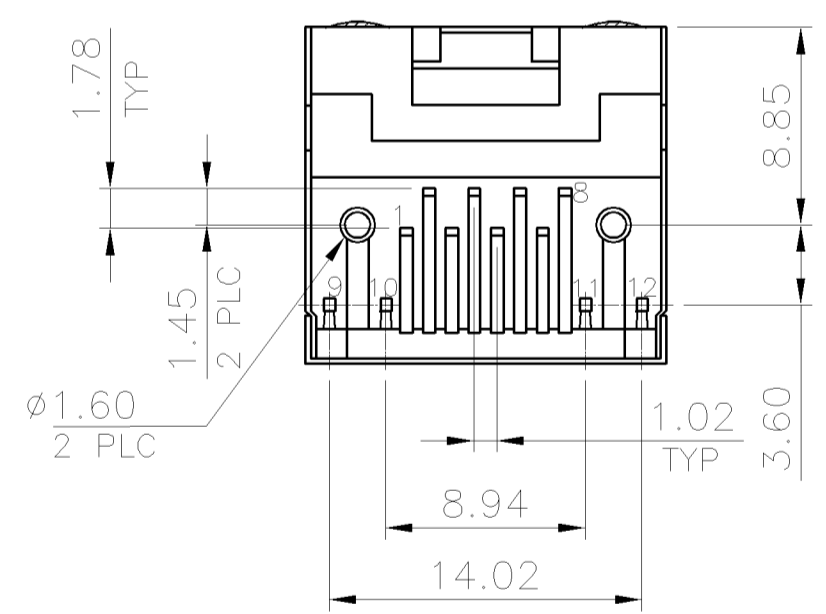

- NOTE:
- MATERIAL:
 HOUSING: PA46 WITH 30% GF, UL 94V-0, BLACK COLOR.
 CONTACTS: PHOSPHOR BRONZE.
 LED LIGHT: EPOXY RESIN.
 SHELL: BRASS.
 - FINISH:
 CONTACTS: (SEE TABLE) GOLD PLATED ON CONTACT AREA, GOLD FLASH ON SOLDER TAILS, WITH ENTIRE CONTACT UNDERPLATED 1.27µm [50µ"] MIN. NICKEL.
 LED: 1.65µm [65µ"] MIN. Ag PLATED.
 2.16µm [85µ"] MIN. TIN PLATED.
 FORWARD CURRENT: 20mA.
 FORWARD VOLTAGE: 2.2 VOLTS TYPICAL.
 SHELL: 0.50µm [20µ"] MIN. NICKEL PLATED.
 - LED MUST BE REFLOW COMPATIBLE TO FOLLOWING TEMPERATURE PROFILE (FOR 1 CYCLE): ABOVE 160°C FOR 120 SECONDS, PEAKING AT 220°C FOR 10 SECONDS.
 - LED DEFECT RATE IS 6000 PPM MAX. AFTER IR REFLOW PROCESS AS NOTE 3.
 - WAVE SOLDER CAPABLE TO 265°C PER TE SPEC. 109-202, CONDITION B.

| TRAY | GREEN | ORANGE & GREEN | 50µ" | 4-1734324-4 |
|---------|------------|----------------|---------------------|-------------|
| | | | 30µ" | 4-1734324-3 |
| | | | 15µ" | 4-1734324-2 |
| | | | 6µ" | 4-1734324-1 |
| PACKAGE | POSITION 2 | POSITION 1 | MIN. GOLD THICKNESS | PART NUMBER |
| | | | | |

| | | | | | |
|--|--|--------------------------------|--|---------------|------------|
| THIS DRAWING IS A CONTROLLED DOCUMENT. | | DWN A. WU 04MAR2008 | Tyco Electronics Corporation Tyco Electronics Corporation Taipei, Taiwan | | |
| DIMENSIONS: MM | | CHK S. HOU 04MAR2008 | NAME | | |
| TOLERANCES UNLESS OTHERWISE SPECIFIED: | | APVD W. KODAMA 04MAR2008 | MODULAR JACK, RJ45, 8P8C, WITH LED & SHIELD, DIP, REVERSE VERSION | | |
| 0 PLC ± 0.50 | | PRODUCT SPEC | SIZE | CAGE CODE | DRAWING NO |
| 1 PLC ± 0.38 | | 108-57535 | 501-57628 | A300779 | C-1734324 |
| 2 PLC ± 0.25 | | QUALIFICATION TEST REPORT | WEIGHT | RESTRICTED TO | |
| 3 PLC ± 0.10 | | 501-57628 | 4.5 GRAMS | | |
| 4 PLC ± - | | MATERIAL | CUSTOMER DRAWING | SCALE | SHEET |
| ANGLES ± - | | SEE NOTE | | - | 3 OF 7 |
| FINISH | | SEE NOTE | | REV | A |

THIS DRAWING IS UNPUBLISHED. RELEASED FOR PUBLICATION
 © COPYRIGHT BY TYCO ELECTRONICS CORPORATION. ALL RIGHTS RESERVED.

| LOC | DIST | REVISIONS | | | | | |
|-----|------|-----------|-----|--------------|------|-----|------|
| DW | — | P | LTR | DESCRIPTION | DATE | DWN | APVD |
| | | | | SEE SHEET 1. | | | |

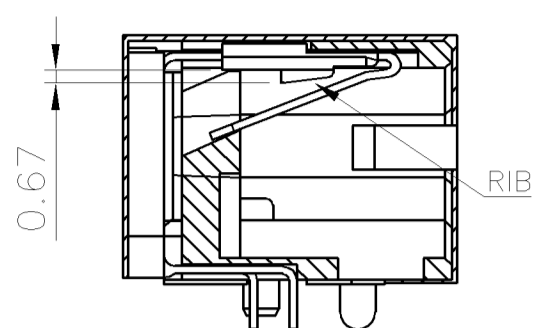

SECTION A-A

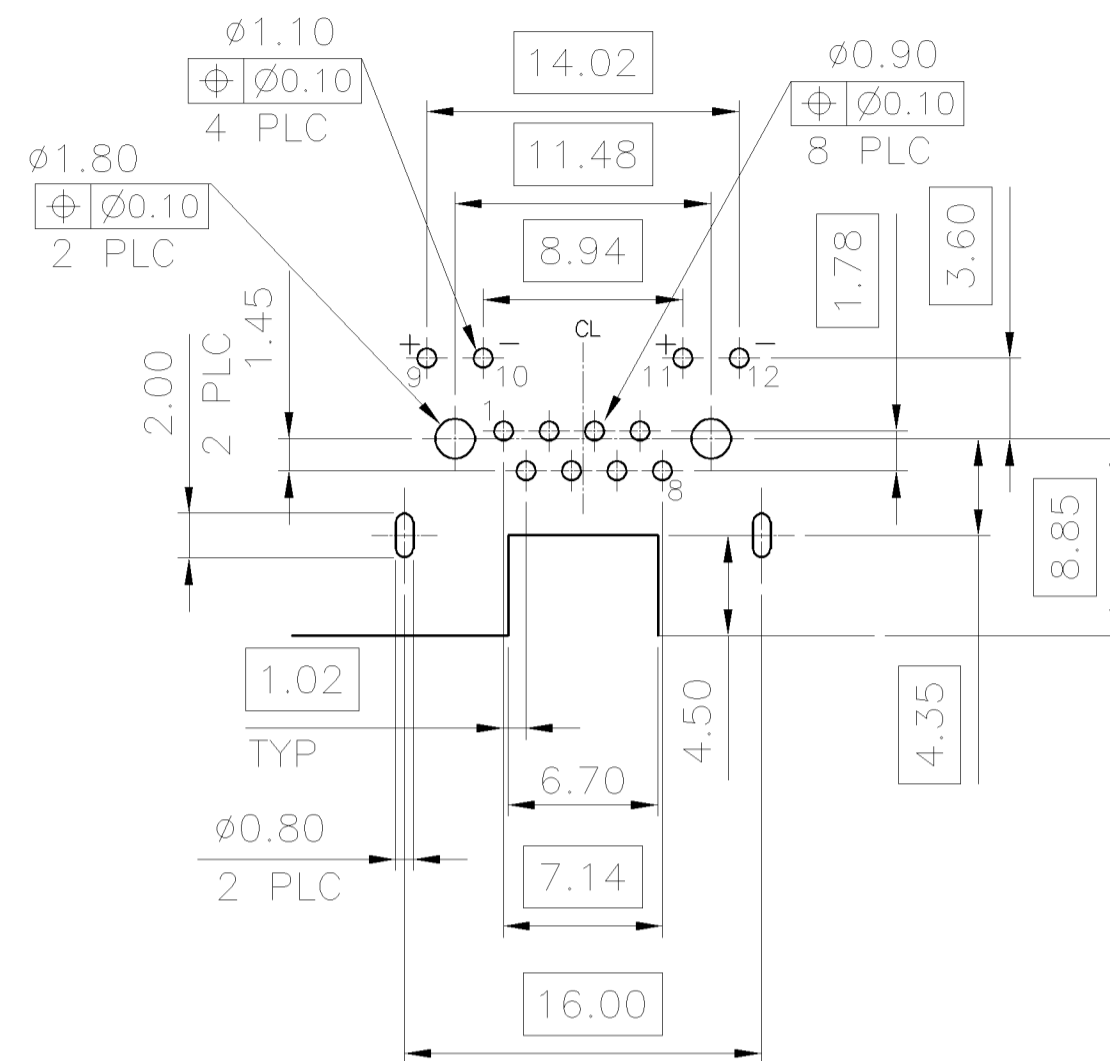
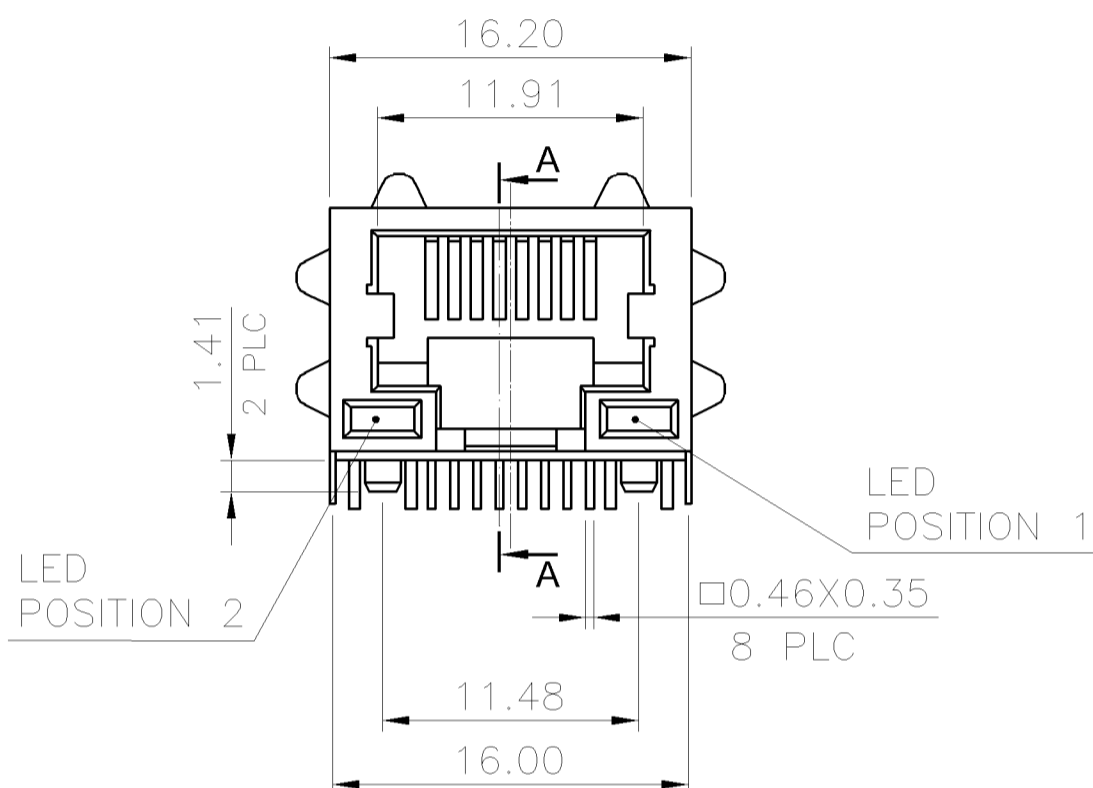
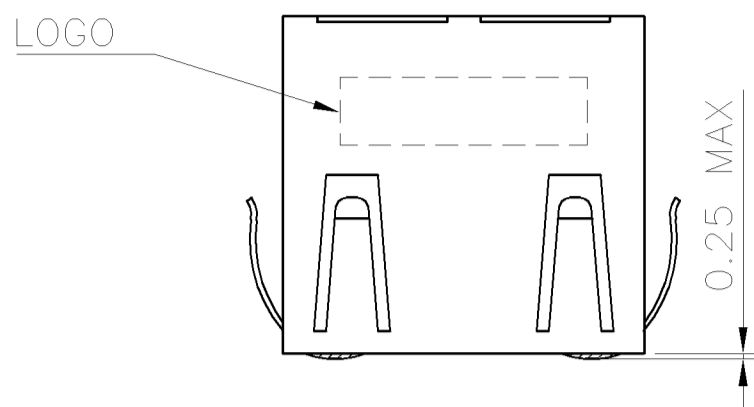
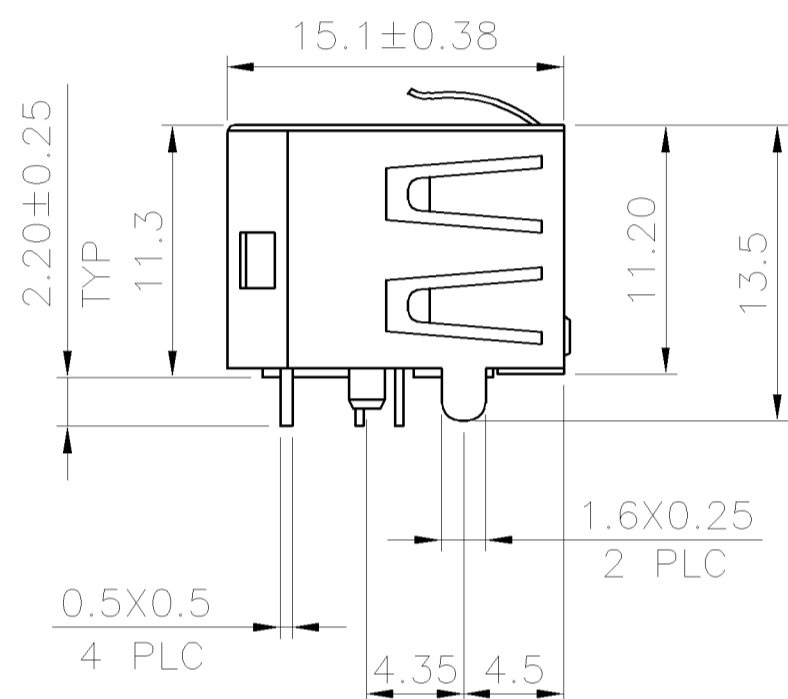

RECOMMENDED PCB LAYOUT (THICKNESS: 1.6mm)
 DIMENSION TOLERANCE: 1 PLC: ±0.1 2PLC: ±0.05

NOTE:

- MATERIAL:
 HOUSING: PA46 WITH 30% GF, UL 94V-0, BLACK COLOR.
 CONTACTS: PHOSPHOR BRONZE.
 LED LIGHT: EPOXY RESIN.
 SHELL: BRASS.
- FINISH:
 CONTACTS: (SEE TABLE) GOLD PLATED ON CONTACT AREA, GOLD FLASH ON SOLDER TAILS, WITH ENTIRE CONTACT UNDERPLATED 1.27µm [50µ"] MIN. NICKEL.
 LED: 1.65µm [65µ"] MIN. Ag PLATED.
 2.16µm [85µ"] MIN. TIN PLATED.
 FORWARD CURRENT: 20mA.
 FORWARD VOLTAGE: 2.2 VOLTS TYPICAL.
 SHELL: 0.50µm [20µ"] MIN. NICKEL PLATED.
- LED MUST BE REFLOW COMPATIBLE TO FOLLOWING TEMPERATURE PROFILE (FOR 1 CYCLE): ABOVE 160°C FOR 120 SECONDS, PEAKING AT 220°C FOR 10 SECONDS.
- LED DEFECT RATE IS 6000 PPM MAX. AFTER IR REFLOW PROCESS AS NOTE 3.
- WAVE SOLDER CAPABLE TO 265°C PER TE SPEC. 109-202, CONDITION B.

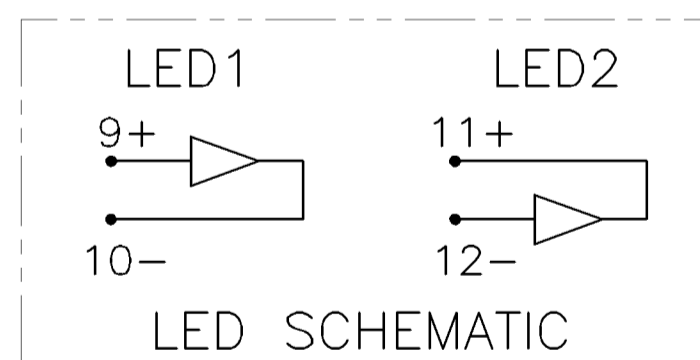
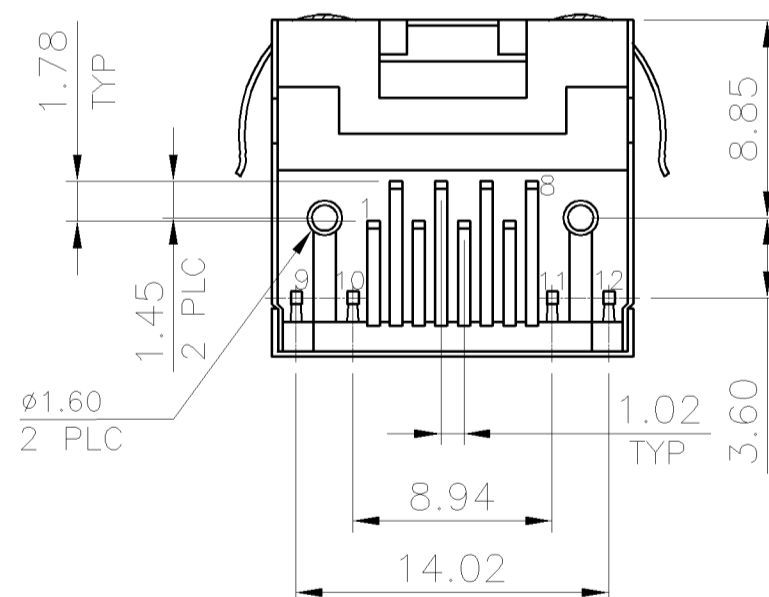

| | | | | |
|---------|-----------------|------------|---------------------|-------------|
| TRAY | YELLOW | GREEN | 50µ" | 5-1734324-8 |
| | | | 30µ" | 5-1734324-7 |
| | | | 15µ" | 5-1734324-6 |
| | GREEN | YELLOW | 6µ" | 5-1734324-5 |
| | | | 50µ" | 5-1734324-4 |
| | | | 30µ" | 5-1734324-3 |
| | | | 15µ" | 5-1734324-2 |
| | | | 6µ" | 5-1734324-1 |
| PACKAGE | POSITION 2 | POSITION 1 | MIN. GOLD THICKNESS | PART NUMBER |
| | INDICATOR COLOR | | | |

| | | | | | | |
|--|--|---------------------------|-----------|------------|--|---------------|
| THIS DRAWING IS A CONTROLLED DOCUMENT. | | DWN | 04MAR2008 | | Tyco Electronics Corporation Taipei, Taiwan | |
| | | A. WU | | | | |
| | | CHK | 04MAR2008 | | NAME MODULAR JACK, RJ45, 8P8C, WITH LED & SHIELD, DIP, REVERSE VERSION | |
| | | S. HOU | | | | |
| | | APVD | 04MAR2008 | | SIZE A300779 | |
| | | W. KODAMA | | | | |
| | | PRODUCT SPEC | | DRAWING NO | | RESTRICTED TO |
| | | 108-57535 | | C-1734324 | | |
| | | QUALIFICATION TEST REPORT | | CAGE CODE | | SCALE |
| | | 501-57628 | | — | | |
| | | WEIGHT | | SHEET | | REV |
| | | 4.5 GRAMS | | 4 OF 7 | | |
| MATERIAL | | FINISH | | SCALE | | SHEET |
| SEE NOTE | | SEE NOTE | | — | | |
| | | CUSTOMER DRAWING | | REV | | A |
| | | | | A | | |

THIS DRAWING IS UNPUBLISHED. RELEASED FOR PUBLICATION
 © COPYRIGHT BY TYCO ELECTRONICS CORPORATION. ALL RIGHTS RESERVED.

| | | | | |
|-----------|-----------|--------------|------|-------------|
| LOC DW | DIST - | REVISIONS | | |
| P | LTR | DESCRIPTION | DATE | DWN APVD |
| | | SEE SHEET 1. | | |

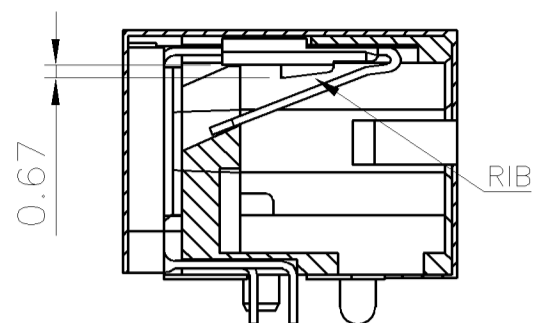

SECTION A-A

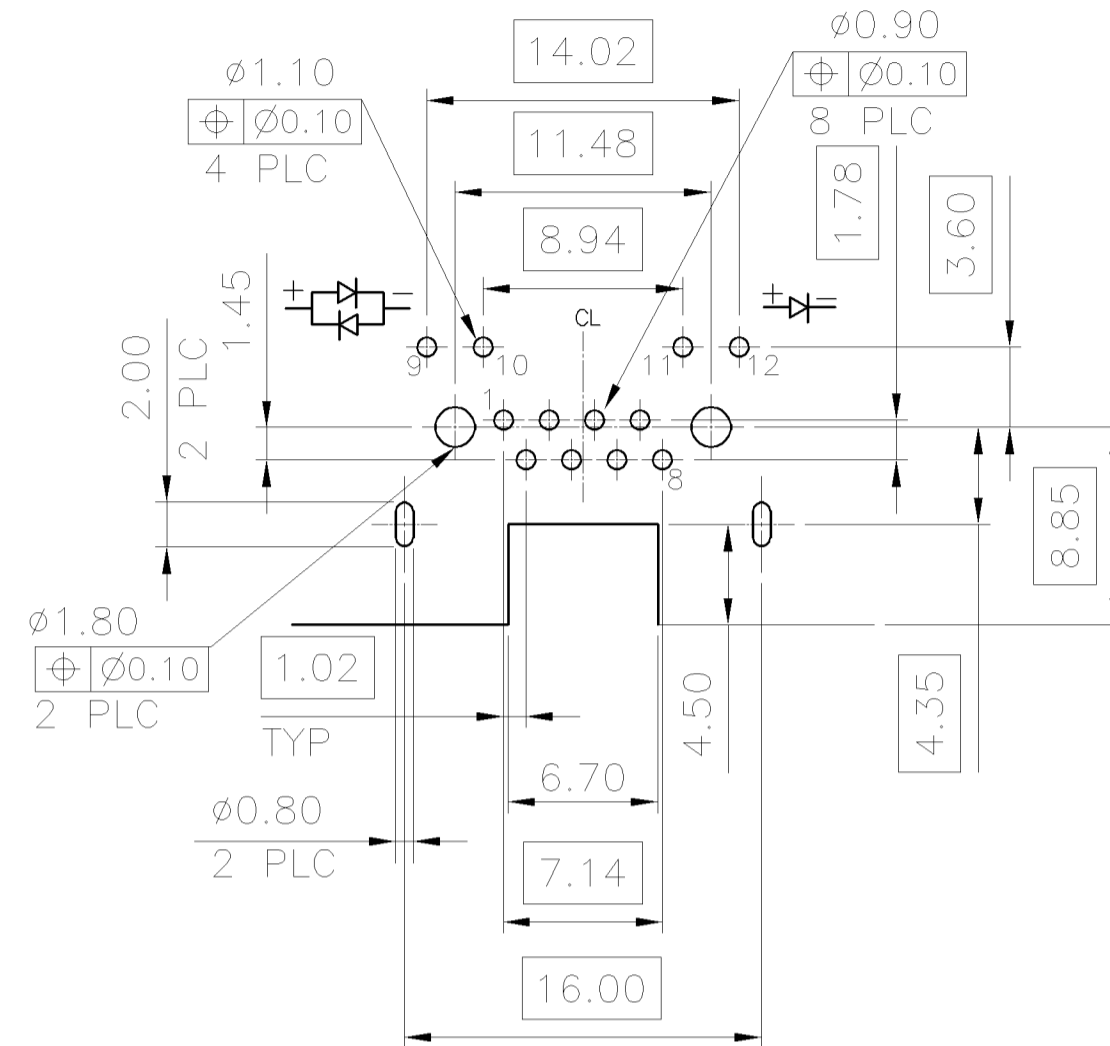
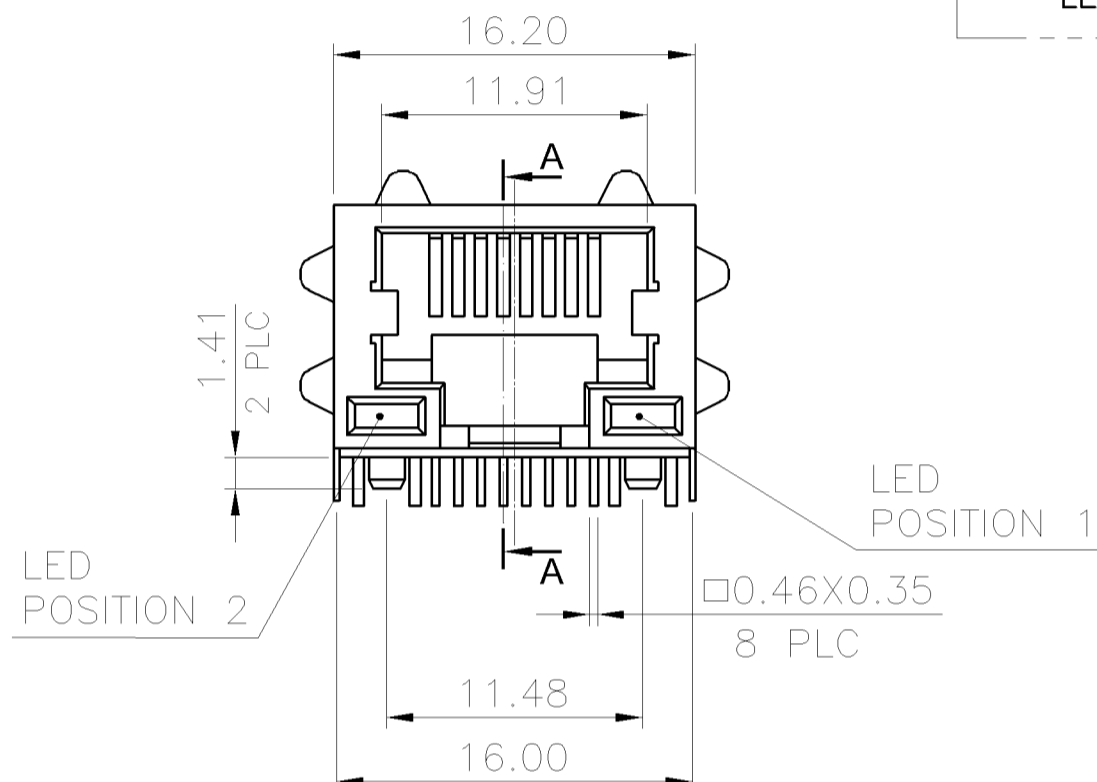
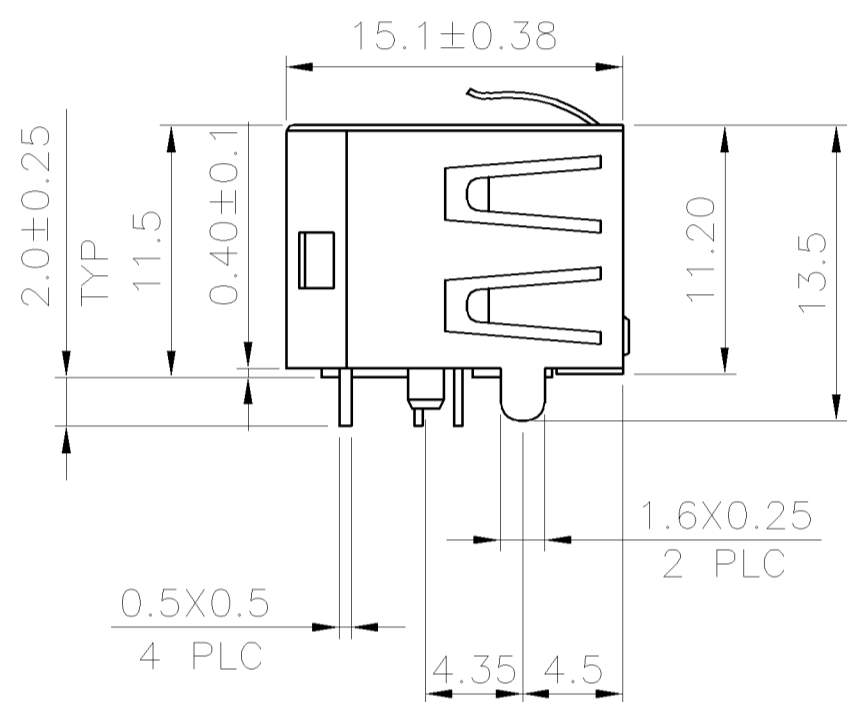
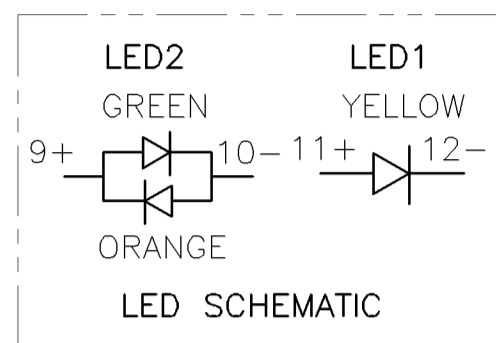
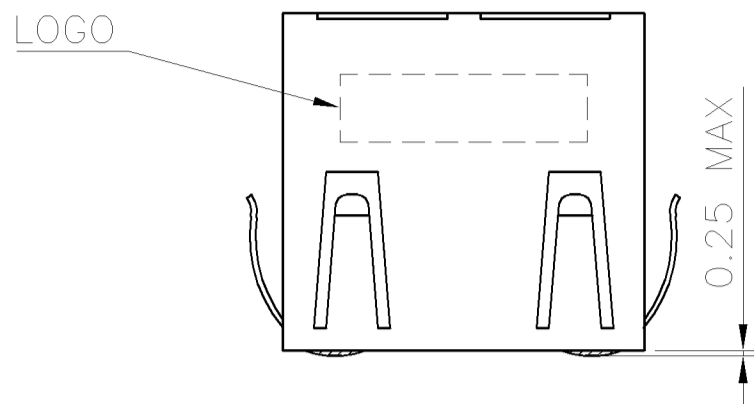

RECOMMENDED PCB LAYOUT (THICKNESS: 1.6mm)
 DIMENSION TOLERANCE: 1 PLC: ±0.1 2PLC: ±0.05

NOTE:

- MATERIAL:
HOUSING: PA9T WITH 30% GF, UL 94V-0, BLACK COLOR.
CONTACTS: PHOSPHOR BRONZE.
LED LIGHT: EPOXY RESIN.
SHELL: BRASS.
- FINISH:
CONTACTS: (SEE TABLE) GOLD PLATED ON CONTACT AREA, GOLD FLASH ON SOLDER TAILS, WITH ENTIRE CONTACT UNDERPLATED 1.27µm [50µ"] MIN. NICKEL.
LED: 1.65µm [65µ"] MIN. Ag PLATED.
2.16µm [85µ"] MIN. TIN PLATED.
FORWARD CURRENT: 20mA.
FORWARD VOLTAGE: 2.2 VOLTS TYPICAL.
SHELL: 0.50µm [20µ"] MIN. NICKEL PLATED.
- LED MUST BE REFLOW COMPATIBLE TO FOLLOWING TEMPERATURE PROFILE (FOR 1 CYCLE): ABOVE 160°C FOR 120 SECONDS, PEAKING AT 220°C FOR 10 SECONDS.
- LED DEFECT RATE IS 6000 PPM MAX. AFTER IR REFLOW PROCESS AS NOTE 3.
- REFLOW SOLDER CAPABLE TO 260°C PER TE SPEC. 109-201, CONDITION B.

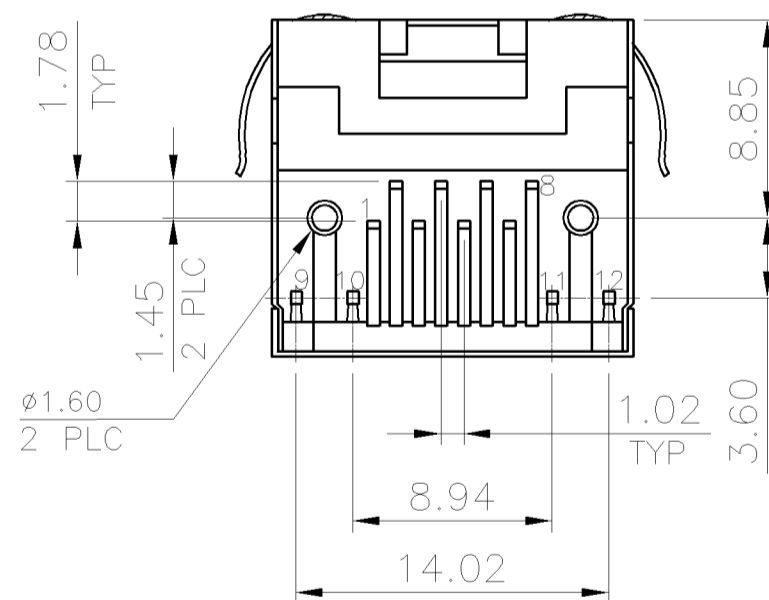

| | | | | |
|-------------|-----------------|------------|---------------------|-------------|
| TAPE & REEL | GREEN & ORANGE | YELLOW | 50µ" | 6-1734324-8 |
| | | | 30µ" | 6-1734324-7 |
| | | | 15µ" | 6-1734324-6 |
| | | | 6µ" | 6-1734324-5 |
| TRAY | GREEN & ORANGE | YELLOW | 50µ" | 6-1734324-4 |
| | | | 30µ" | 6-1734324-3 |
| | | | 15µ" | 6-1734324-2 |
| | | | 6µ" | 6-1734324-1 |
| PACKAGE | POSITION 2 | POSITION 1 | MIN. GOLD THICKNESS | PART NUMBER |
| | INDICATOR COLOR | | | |

| | | | | | | | | | | | | | | | | | |
|--|--------|--|--|-----------|------------|-------|--------|-------|--------|-------|-----|--------|-----|---------------------------|---|--|--|
| THIS DRAWING IS A CONTROLLED DOCUMENT. | | DWN A. WU 04MAR2008 | Tyco Electronics Corporation Taipei, Taiwan | | | | | | | | | | | | | | |
| DIMENSIONS: MM | | CHK S. HOU 04MAR2008 | | | | | | | | | | | | | | | |
| TOLERANCES UNLESS OTHERWISE SPECIFIED: | | APVD W. KODAMA 04MAR2008 | NAME | | | | | | | | | | | | | | |
| <table border="1"> <tr><td>0 PLC</td><td>± 0.50</td></tr> <tr><td>1 PLC</td><td>± 0.38</td></tr> <tr><td>2 PLC</td><td>± 0.25</td></tr> <tr><td>3 PLC</td><td>± 0.10</td></tr> <tr><td>4 PLC</td><td>± -</td></tr> <tr><td>ANGLES</td><td>± -</td></tr> </table> | | 0 PLC | ± 0.50 | 1 PLC | ± 0.38 | 2 PLC | ± 0.25 | 3 PLC | ± 0.10 | 4 PLC | ± - | ANGLES | ± - | PRODUCT SPEC 108-57535 | MODULAR JACK, RJ45, 8P8C, WITH LED & SHIELD, DIP, REVERSE VERSION | | |
| 0 PLC | ± 0.50 | | | | | | | | | | | | | | | | |
| 1 PLC | ± 0.38 | | | | | | | | | | | | | | | | |
| 2 PLC | ± 0.25 | | | | | | | | | | | | | | | | |
| 3 PLC | ± 0.10 | | | | | | | | | | | | | | | | |
| 4 PLC | ± - | | | | | | | | | | | | | | | | |
| ANGLES | ± - | | | | | | | | | | | | | | | | |
| MATERIAL SEE NOTE | | QUALIFICATION TEST REPORT 501-57628 | SIZE | CAGE CODE | DRAWING NO | | | | | | | | | | | | |
| FINISH SEE NOTE | | WEIGHT 4.5 GRAMS | A3 | 00779 | C-1734324 | | | | | | | | | | | | |
| CUSTOMER DRAWING | | | RESTRICTED TO | SCALE | SHEET | | | | | | | | | | | | |
| | | | - | - | 5 OF 7 | | | | | | | | | | | | |
| | | | | | REV A | | | | | | | | | | | | |

THIS DRAWING IS UNPUBLISHED.

RELEASED FOR PUBLICATION

ALL RIGHTS RESERVED.

© COPYRIGHT -

LOC
DW

DIST
-

REVISIONS

| P | LTR | DESCRIPTION | DATE | DWN | APVD |
|---|-----|--------------|------|-----|------|
| | | SEE SHEET 1. | | | |

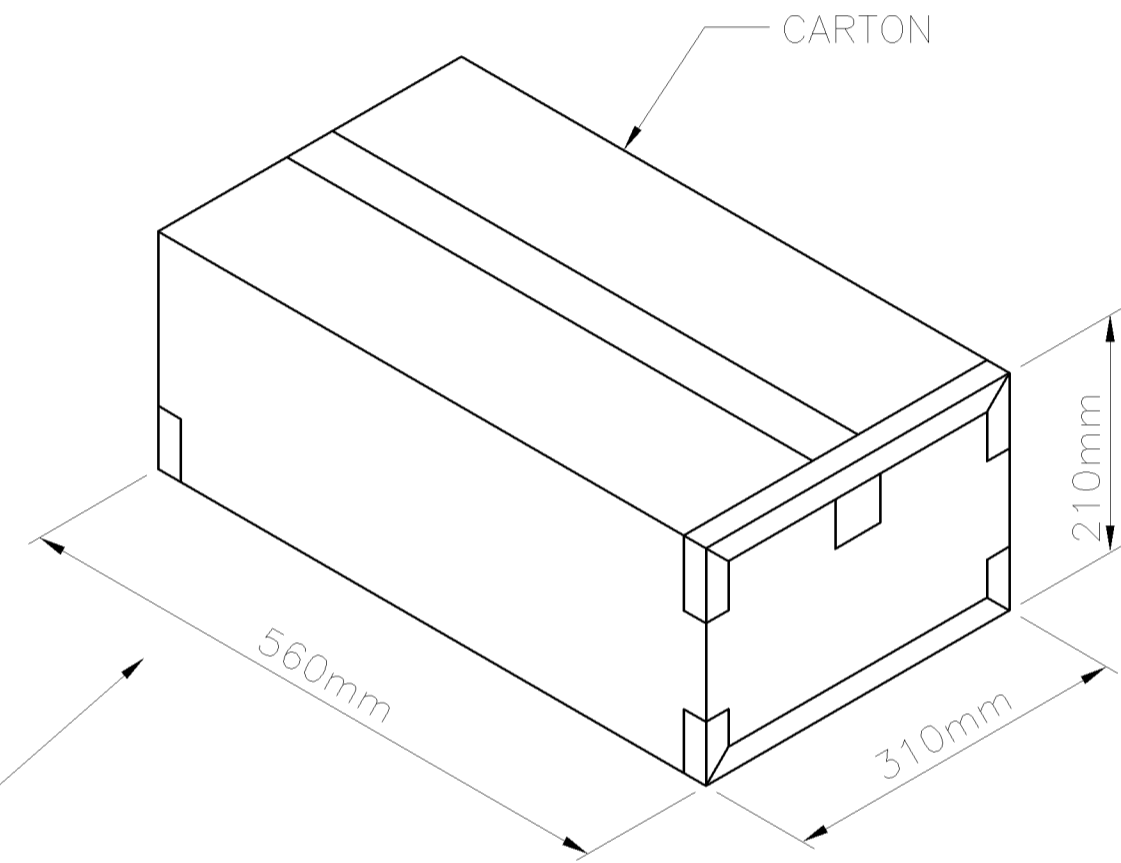
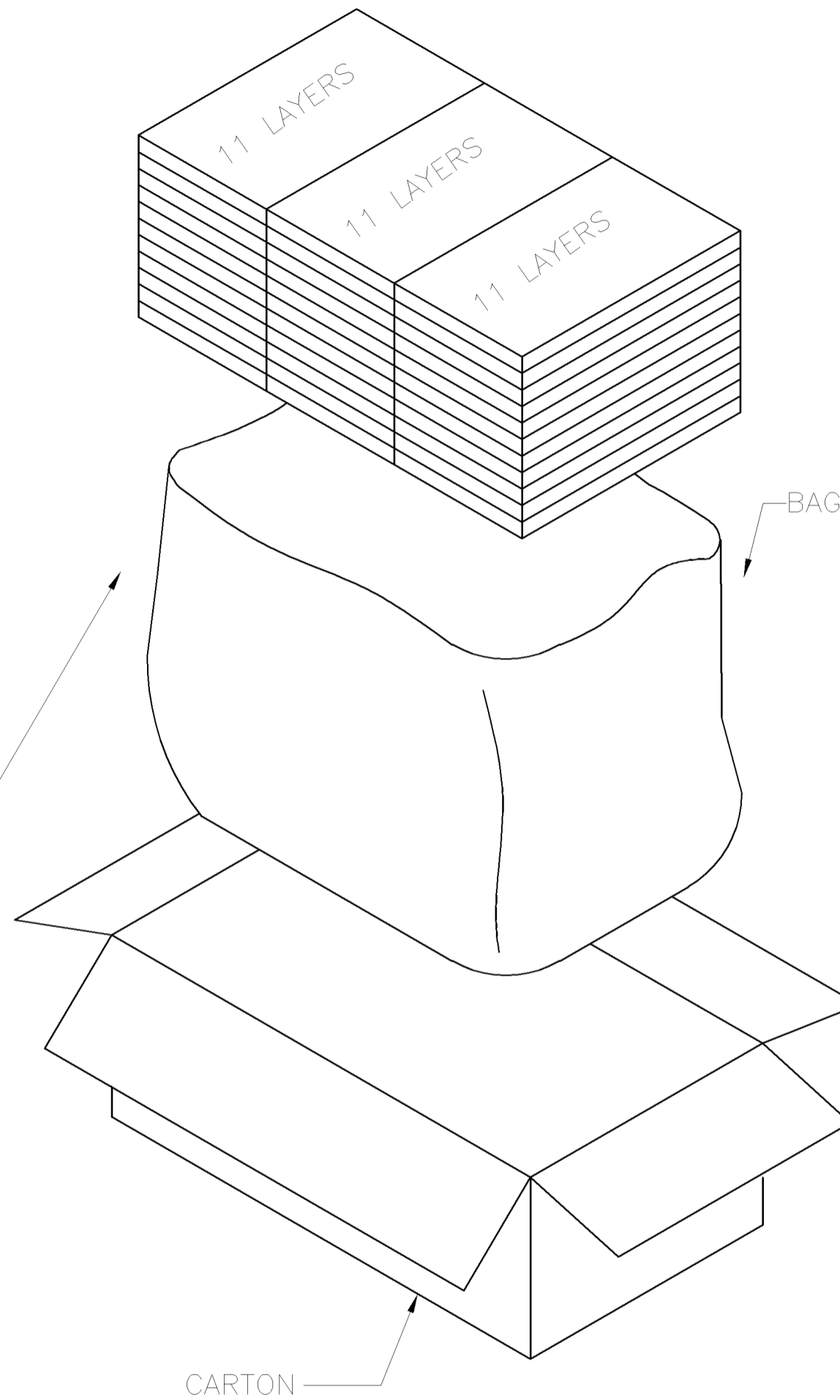
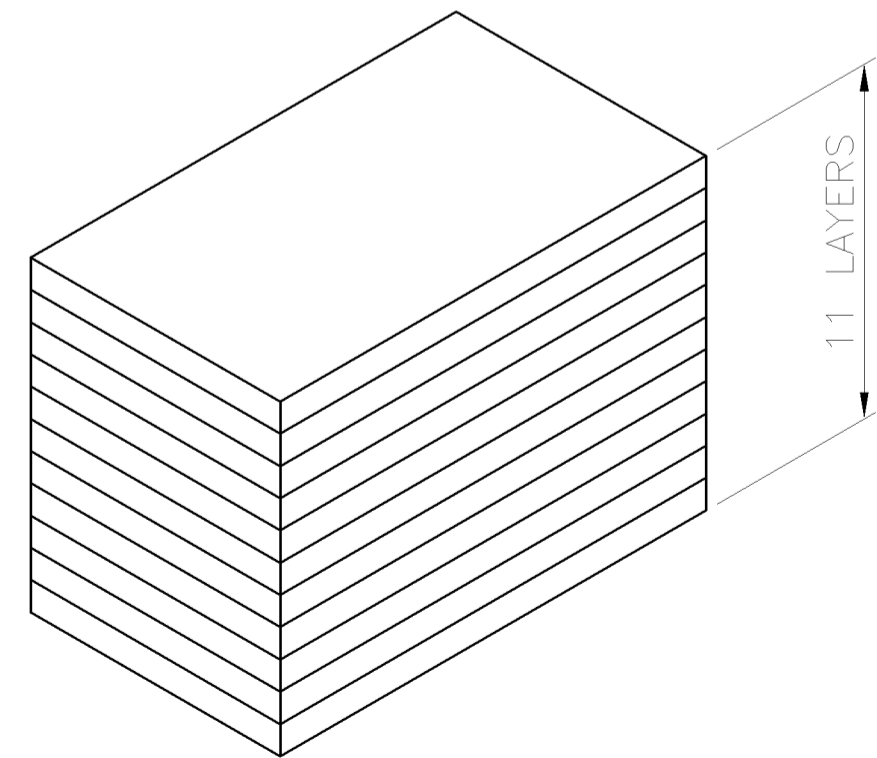
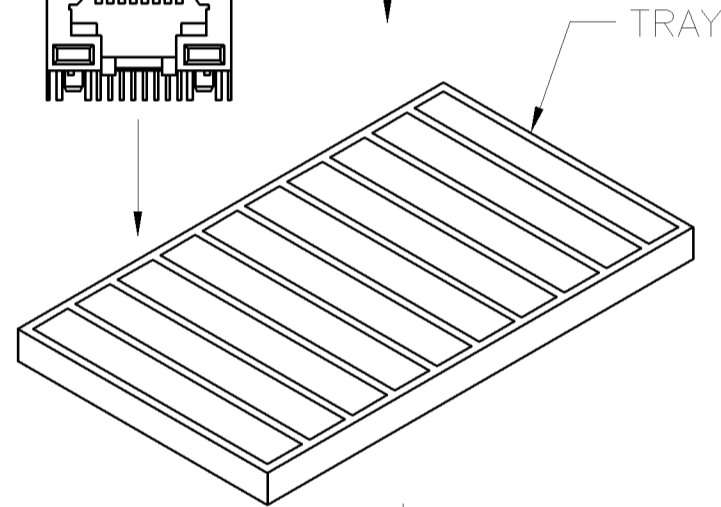
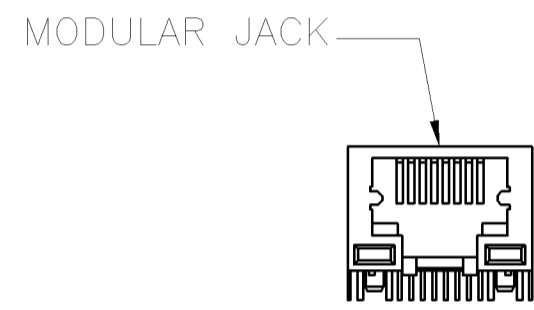
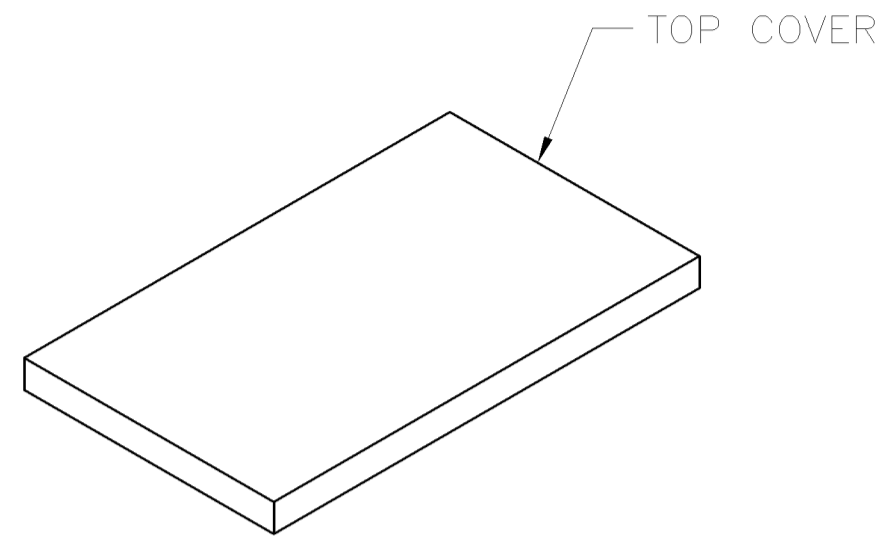

| 13 Kg | 12 Kg | 2640 | 80 | 5-1734324-X |
|--------------|------------|------------|----------|-------------|
| | | | | 6-1734324-X |
| 14.5 Kg | 13.5 Kg | 2970 | 90 | 4-1734324-X |
| | | | | 2-1734324-X |
| | | | | 1-1734324-X |
| | | | | 1734324-X |
| GROSS WEIGHT | NET WEIGHT | PCS/CARTON | PCS/TRAY | PART NUMBER |

| | | | | | |
|--|--|-------------------|-----------|--|--|
| THIS DRAWING IS A CONTROLLED DOCUMENT. | | DWN A. WU | 04MAR2008 | Tyco Electronics Corporation Taipei, Taiwan | |
| DIMENSIONS: MM | | CHK S. HOU | 04MAR2008 | NAME | |
| TOLERANCES UNLESS OTHERWISE SPECIFIED: | | APVD W. KODAMA | 04MAR2008 | MODULAR JACK, RJ45, 8P8C, WITH LED & SHIELD, DIP, REVERSE VERSION | |
| 0 PLC ± - | | PRODUCT SPEC | | SIZE | |
| 1 PLC ± - | | APPLICATION SPEC | | CAGE CODE | |
| 2 PLC ± - | | WEIGHT | | DRAWING NO | |
| 3 PLC ± - | | CUSTOMER DRAWING | | RESTRICTED TO | |
| 4 PLC ± - | | SCALE | | SHEET | |
| ANGLES ± - | | 6 OF 7 | | REV | |
| FINISH | | A300779 | | A | |
| MATERIAL | | G=1734324 | | | |

THIS DRAWING IS UNPUBLISHED. RELEASED FOR PUBLICATION
 © COPYRIGHT - ALL RIGHTS RESERVED.

| LOC | DIST | REVISIONS | | | | | |
|-----|------|-----------|-----|--------------|------|-----|------|
| DW | - | P | LTR | DESCRIPTION | DATE | DWN | APVD |
| | | | | SEE SHEET 1. | | | |

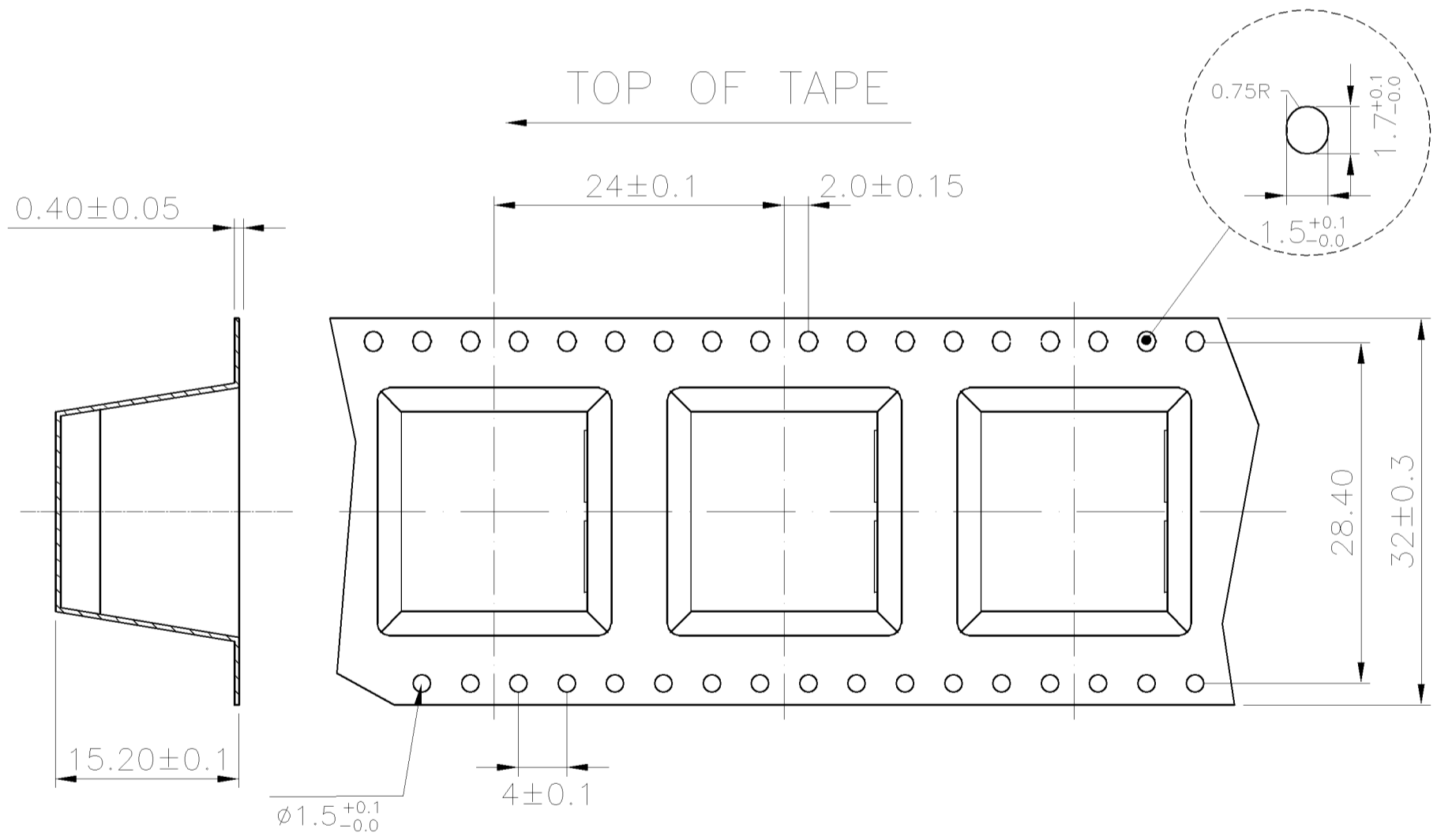
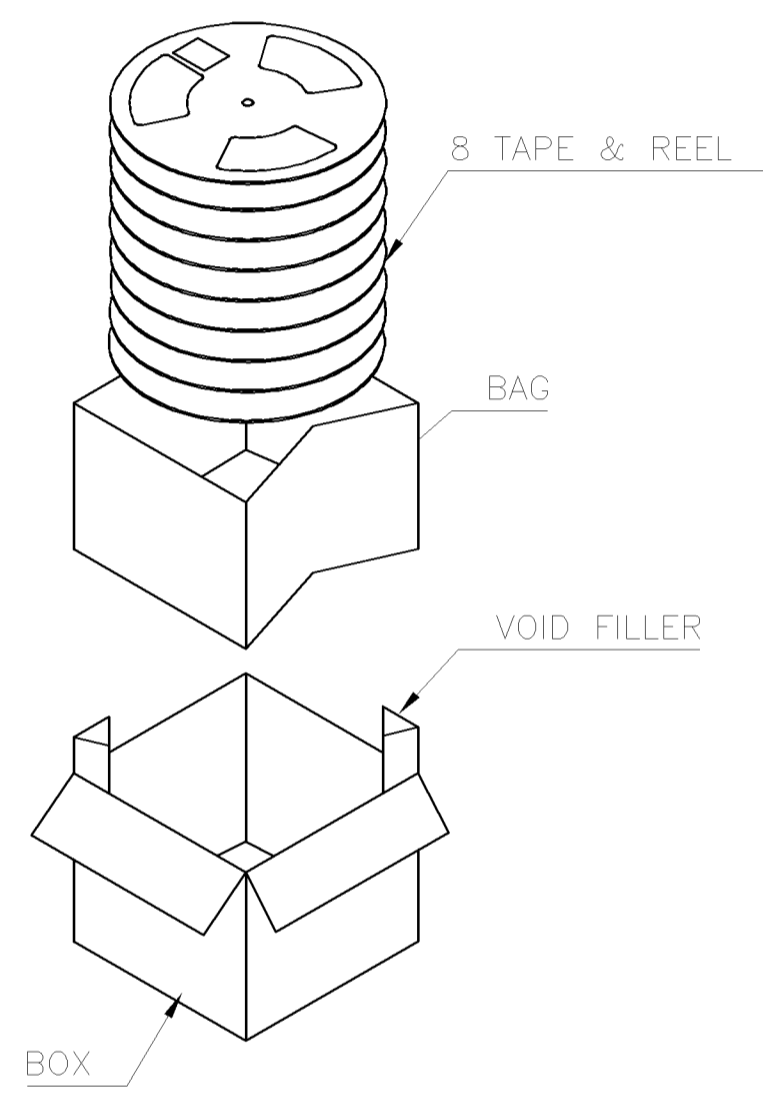
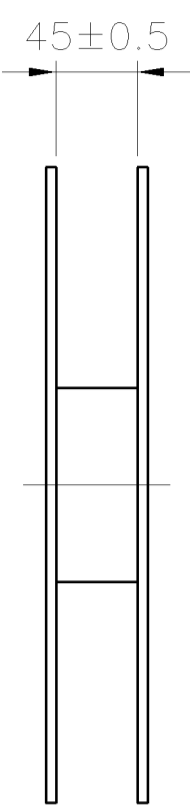
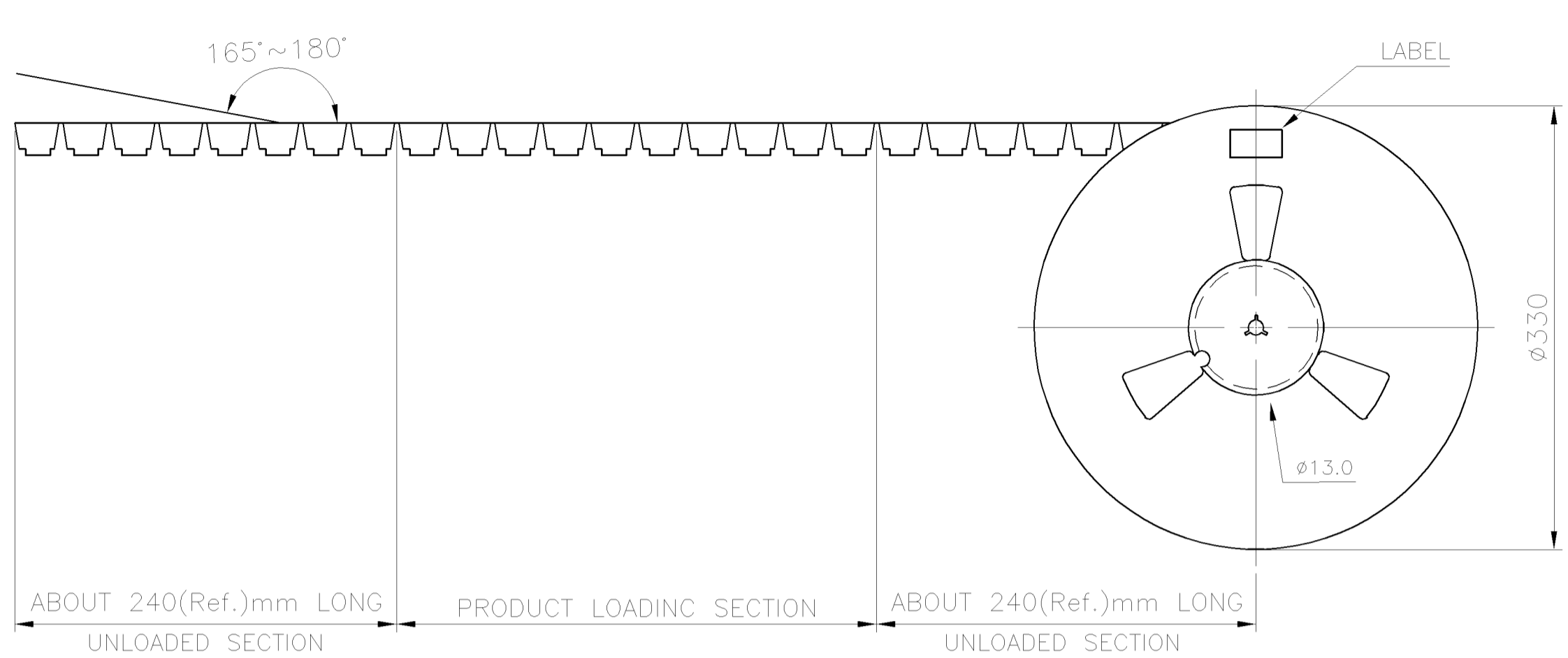

| 8.5 Kg | 6.5 Kg | 180 | 8 | 1440 PCS |
|--------------|------------|----------|-----------|----------|
| GROSS WEIGHT | NET WEIGHT | PCS/REEL | REELS/BOX | QUANTITY |

| | | | | | | | |
|--|--|------------------|-----------|------------|---|--|---------------|
| THIS DRAWING IS A CONTROLLED DOCUMENT. | | DWN | A. WU | 04MAR2008 | Tyco Electronics Corporation Taipei, Taiwan | | |
| DIMENSIONS: MM | | CHK | S. HOU | 04MAR2008 | | | |
| TOLERANCES UNLESS OTHERWISE SPECIFIED: | | APVD | W. KODAMA | 04MAR2008 | MODULAR JACK, RJ45, 8P8C, WITH LED & SHIELD, DIP, REVERSE VERSION | | |
| 0 PLC ± - | | PRODUCT SPEC | | SIZE | | | RESTRICTED TO |
| 1 PLC ± - | | APPLICATION SPEC | | CAGE CODE | | | - |
| 2 PLC ± - | | WEIGHT | | DRAWING NO | | | |
| 3 PLC ± - | | CUSTOMER DRAWING | | A300779 | | | - |
| 4 PLC ± - | | SCALE | | G=1734324 | | | |
| ANGLES ± - | | SHEET | | 7 OF 7 | | | - |
| FINISH | | REV | | A | | | |