

D38999/23

Jam Nut Mount Hermetic Receptacle

MIL-DTL-38999

Series III – Threaded Coupling

SHELL SIZE	SHELL SIZE CODE	P +.016/-0.004 [+0.4/-0.1]	S ±.016 [±0.4]	W +.012/-0.004 [+0.3/-0.1]	Z MAX
9	A	.555 [14.1]	1.063 [27.0]	.102 [2.6]	1.150 [29.2]
11	B	.555 [14.1]	1.252 [31.8]	.102 [2.6]	1.150 [29.2]
13	C	.563 [14.3]	1.374 [34.9]	.102 [2.6]	1.150 [29.2]
15	D	.563 [14.3]	1.500 [38.1]	.102 [2.6]	1.150 [29.2]
17	E	.563 [14.3]	1.626 [41.3]	.102 [2.6]	1.150 [29.2]
19	F	.563 [14.3]	1.811 [46.0]	.134 [3.4]	1.185 [30.1]
21	G	.563 [14.3]	1.937 [49.2]	.134 [3.4]	1.185 [30.1]
23	H	.563 [14.3]	2.063 [52.4]	.134 [3.4]	1.185 [30.1]
25	J	.563 [14.3]	2.189 [55.6]	.134 [3.4]	1.185 [30.1]

NOTES:

1. PANEL THICKNESS .126/.050 [3.20/1.58]
2. CONNECTOR CONTAINS REQUIRED FEATURES FOR PROPER FIT IN A TYPE "E" PANEL
3. FOR CONNECTOR COMPONENTS AND ACCESSORIES, SEE PAGE C-5

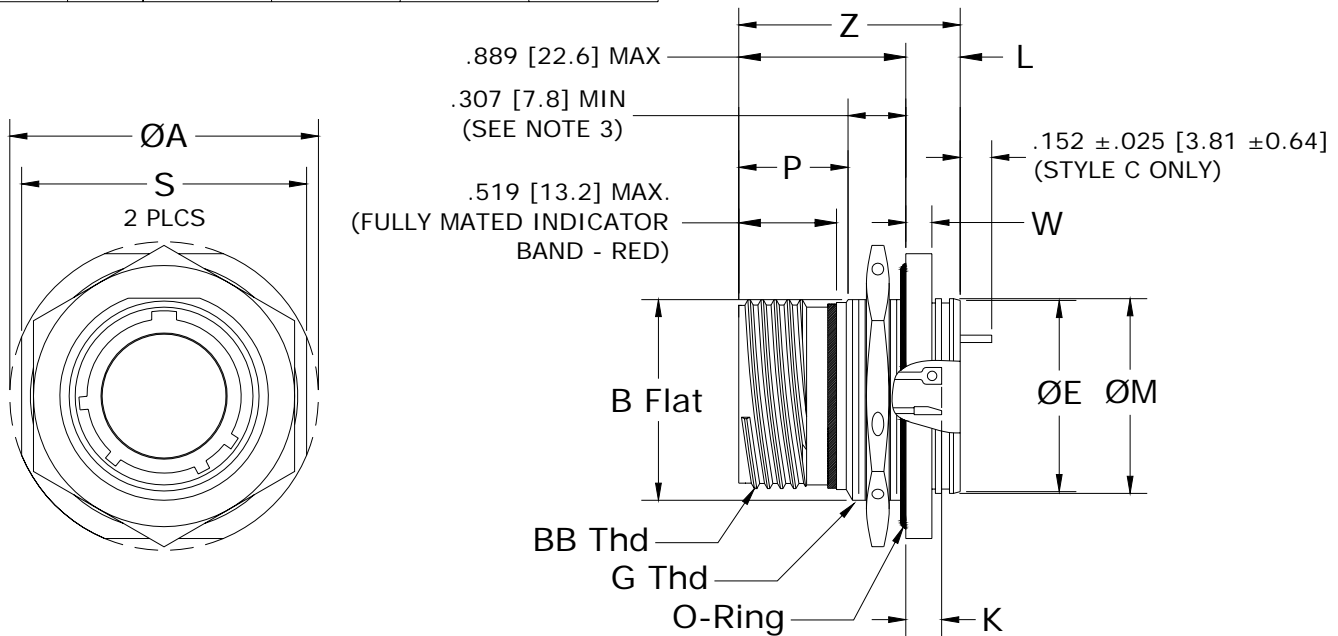

SHELL SIZE	SHELL SIZE CODE	ØA ±.011 [±0.3]	B Flat +.004/-0.006 [+0.10/-0.15]	BB Thd CLASS 2A 0.1P-0.3L-TS	ØE ±.011 [±0.3]	G Thd -6g 0.100R	K MAX		L MAX	ØM +.012/-0.000 [+0.3/-0.0]
							W/PINS	W/SOCKETS		
9	A	1.189 [30.2]	.651 [16.53]	.6250	.602 [15.3]	M17 x 1.0	.209 [5.3]	.232 [5.9]	.358 [9.1]	.642 [16.3]
11	B	1.374 [34.9]	.751 [19.07]	.7500	.724 [18.4]	M20 x 1.0	.209 [5.3]	.232 [5.9]	.358 [9.1]	.764 [19.4]
13	C	1.500 [38.1]	.938 [23.82]	.8750	.850 [21.6]	M25 x 1.0	.201 [5.1]	.224 [5.7]	.358 [9.1]	.894 [22.7]
15	D	1.626 [41.3]	1.062 [26.97]	1.0000	.976 [24.8]	M28 x 1.0	.201 [5.1]	.224 [5.7]	.358 [9.1]	1.020 [25.9]
17	E	1.752 [44.5]	1.187 [30.15]	1.1875	1.102 [28.0]	*M32 x 1.0	.201 [5.1]	.224 [5.7]	.358 [9.1]	1.142 [29.0]
19	F	1.937 [49.2]	1.312 [33.32]	1.2500	1.228 [31.2]	M35 x 1.0	.201 [5.1]	.224 [5.7]	.382 [9.7]	1.268 [32.2]
21	G	2.063 [52.4]	1.437 [36.50]	1.3750	1.350 [34.3]	M38 x 1.0	.201 [5.1]	.224 [5.7]	.382 [9.7]	1.394 [35.4]
23	H	2.189 [55.6]	1.562 [39.67]	1.5000	1.476 [37.5]	M41 x 1.0	.201 [5.1]	.224 [5.7]	.382 [9.7]	1.520 [38.6]
25	J	2.311 [58.7]	1.687 [42.85]	1.6250	1.602 [40.7]	M44 x 1.0	.201 [5.1]	.224 [5.7]	.382 [9.7]	1.642 [41.7]

* = MODIFIED MAJOR DIA. 1.258/1.252 [31.95/31.80]

DIMENSIONS ARE IN INCHES [MILLIMETERS]