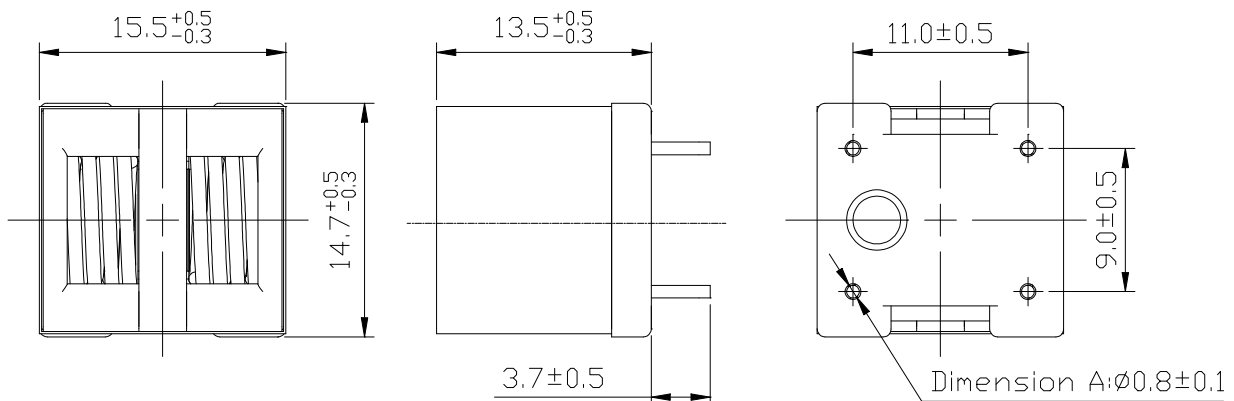
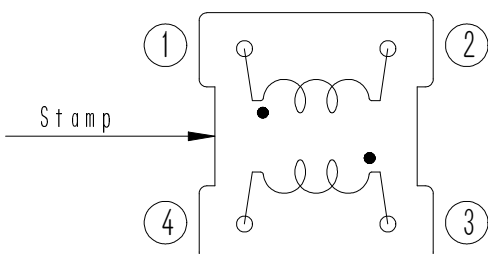

**Type: DEPI1615**
**◆ Product Description**

- 16.0×15.2mm Max.(L×W),14.0mm Max. Height.
- Inductance range: 5.0~30  $\mu$  H.
- Rated current range: 2.8~9.5A.
- In addition to the standard versions of inductors shown here, custom inductors are available to meet your exact requirements.

**◆ Feature**

- Mn-Zn core used, High DC saturation current. High efficiency, Low heat generation.
- L.P.F coils for Digital Amplifier in car audio, home theater and large LCD, etc.
- RoHS Compliance and Halogen free.

**◆ Dimensions (mm)**

**◆ Schematics (Bottom)**

**Type: DEPI1615**
**◆ Specification**

| Part Name       | Stamp | Inductance<br>( $\mu$ H)<br>(at 100kHz) |                  | D.C.R. ( $m\Omega$ )<br>Max. [TYP]<br>(at 20°C) |                  | Saturation<br>Current<br>(A) ※1 |          | Temperature<br>Rise Current<br>(A) ※2 |
|-----------------|-------|---|------------------|---|------------------|---------------------------------|----------|---------------------------------------|
|                 |       | (1-2)<br>Between                        | (3-4)<br>Between | (1-2)<br>Between                                | (3-4)<br>Between | at 20°C                         | at 105°C |                                       |
| DEPI1615NP-5R0N | 5R0N  | 5 $\pm$ 30%                             | 5 $\pm$ 30%      | 7.7(5.9)  | 7.7(5.9)         | 13                              | 10       | 9.5                                   |
| DEPI1615NP-100N | 100N  | 10 $\pm$ 30%                            | 10 $\pm$ 30%     | 10(7.6)   | 10(7.6)          | 9.6                             | 7.6      | 8.0                                   |
| DEPI1615NP-150N | 150N  | 15 $\pm$ 30%                            | 15 $\pm$ 30%     | 10(7.6)   | 10(7.6)          | 6.5                             | 5.0      | 8.0                                   |
| DEPI1615NP-220N | 220N  | 22 $\pm$ 30%                            | 22 $\pm$ 30%     | 10(7.6)   | 10(7.6)          | 4.2                             | 3.2      | 8.0                                   |
| DEPI1615NP-300N | 300N  | 30 $\pm$ 30%                            | 30 $\pm$ 30%     | 10(7.6)   | 10(7.6)          | 2.8                             | 2.1      | 8.0                                   |

※1. Saturation current: The DC current at which the inductance decreases to 75% of it's nominal value.

※2. Temperature rise current: The DC current at which the temperature rise is  $\Delta t=40^{\circ}\text{C}$ . ( $T_a=20^{\circ}\text{C}$ ).