

1		2		3		4		5		6		7		8	
REVISIONS															
ISS	ZONE	DESCRIPTION\PER REQUEST\DATE													

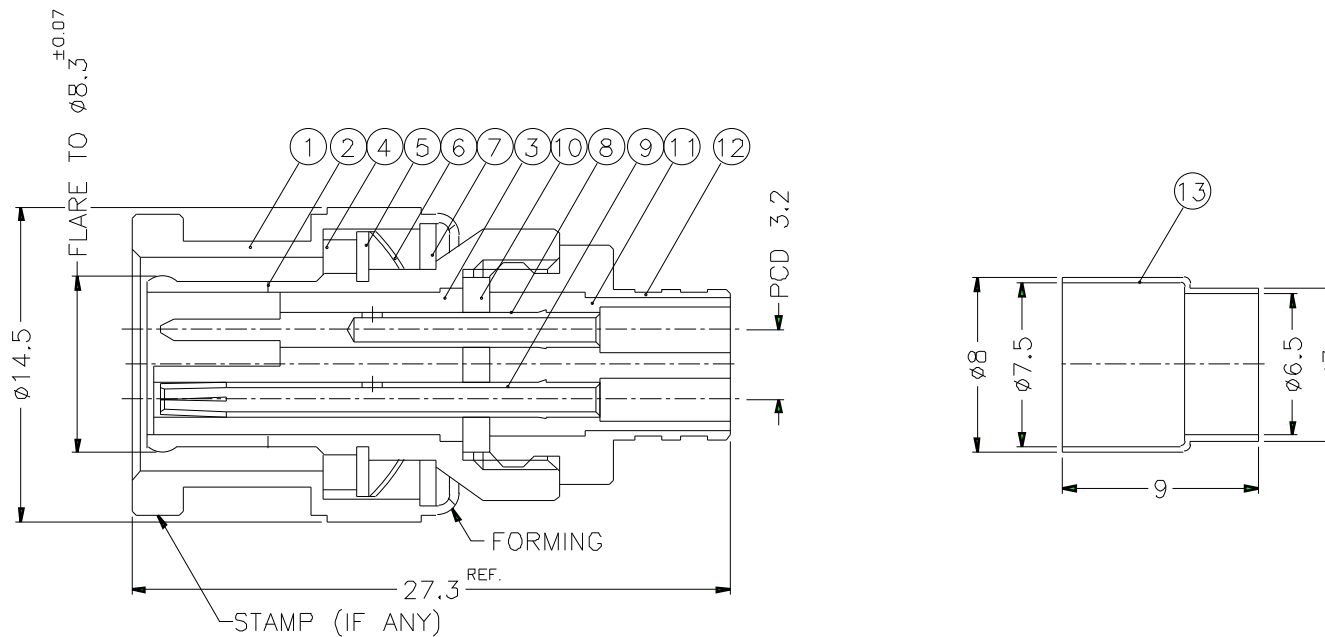

NOTES: FINISH (PLATING THICKNESS IN MICRO-INCHES)

1. BRASS PER QQ-B-626
2. BRASS PER QQ-B-613
3. NICKEL PL. 100 MIN. THICK OVER COPPER STRIKE
4. NICKEL PL. 200 MIN. THICK OVER COPPER STRIKE
5. PHOSPHOR BRONZE PER QQ-B-750
6. GOLD PL. 3 MIN. THICK OVER NICKEL PL. 100 MIN. THICK OVER COPPER STRIKE
7. JIS H 3260, C 3501

13	FERRULE	NOTE 7	NOTE 3	1	FR-8/75-7/65X9
12	BARREL	NOTE 1	NOTE 3	1	B5600-12-B
11	INSULATOR	PBT	WHITE	1	B5600-11-B
10	GASKET	RUBBER	RED	1	B5600-10
9	CONTACT PIN	NOTE 5	NOTE 6	1	B5600-9
8	CONTACT PIN	NOTE 1	NOTE 6	1	B5600-8
7	WASHER	NOTE 2	NOTE 3	1	WS-128/9X08
6	SPRING	SK5	NOTE 4	1	B50000-6
5	RETAINER RING	NOTE 1	NOTE 3	1	B50000-5
4	GASKET	RUBBER	RED	1	GS-115/8X15
3	INSULATOR	PBT	WHITE	1	B5600-3
2	BODY	NOTE 1	NOTE 3	1	B5600-2
1	SHELL	NOTE 1	NOTE 3	1	B50000-1-B
NO.	DESCRIPTION	MATERIAL	FINISH	Q'TY	DRAWING NO.

DIMENSIONS ARE IN MILLIMETERS				PART NO. TWB1111K1-NPB3G	
UNLESS OTHERWISE SPECIFIED TOLERANCES 0.5-6 = ±0.2 6-30 = ±0.4 30-120 = ±0.6 120-315 = ±1 315-1000 = ±1.6 1000-2000 = ±2.4				APPROVED	DATE 10-11-01'
				CHECKED	DATE 10-11-01'
				DRAWN	DATE 10-11-01'
				SCALE	3/1
ISSUE	A	FILE NO.			

<h1>Amphenol</h1>	
TITLE BNC TWIN PLUG	
DRAWING NO. KJ-TWB1111K1-NPB3G	
ITEM NO	

1		2		3		4		5		6		7		8	
---	--	---	--	---	--	---	--	---	--	---	--	---	--	---	--