

**DESIGNED & DIMENSIONED
IN MILLIMETERS [INCHES]**

RFXXX-XXXXX-XXXXXX-XXXX

CABLE CALL OUT

- 174: CCA-174 (RG-174 COAXIAL CABLE)
- 316: CCA-316 (RG-316 COAXIAL CABLE)

OVERALL CABLE LENGTH
MILLIMETERS OF CABLE
0100 MIN. (SEE NOTE 8 & 9)

END 2 PLATING OPTION

- 1: GOLD ALL COMPONENTS
- 2: GOLD / NICKEL COMBINATION
- 3: ALTERNATE GOLD / NICKEL
- * (LEAVE BLANK FOR -SING OR -XXXXX END 2 PREPARATION)

END 2 CONNECTOR OR PREPARATION

- 01SP: SMA-P-C-X-ST-CA1 (SEE SHEET 3)
- 01RP: SMA-P-C-X-RA-CA1 (SEE SHEET 3)
- 01BJ: SMA-J-C-X-ST-BH1 (SEE SHEET 3)
- 01BR: SMA-J-C-X-ST-BR1 (SEE SHEET 3)
- 02SJ: MCX-J-C-X-ST-CA1 (SEE SHEET 3)
- 02RP: MCX-P-C-XX-RA-CA1 (SEE SHEET 3)
- 02SP: MCX-P-C-XX-ST-CA1 (SEE SHEET 4)
- 03SP: MMCX-P-C-X-ST-CA1 (SEE SHEET 4)
- 03RP: MMCX-P-C-X-RA-CA1 (SEE SHEET 4)
- 04SP: BNC5-P-C-XX-ST-CA1 (SEE SHEET 4)
- 04BJ: BNC5-J-C-XX-ST-BH1 (SEE SHEET 4)
- 05SP: TNC-P-C-XX-ST-CA1 (SEE SHEET 4)
- 05BJ: TNC-J-C-XX-ST-BH1 (SEE SHEET 5)
- 06BJ: NTPE-J-C-XX-ST-BH1 (SEE SHEET 5)
- 07SP: SMB5-P-C-XX-ST-CA1 (SEE SHEET 5)
- 07RP: SMB5-P-C-XX-RA-CA1 (SEE SHEET 5)
- 07BJ: SMB5-J-C-X-ST-BH1 (SEE SHEET 5)
- 13GP: GRF1-P-C-X-ST-CA1 (316 OPTION ONLY) (SEE SHEET 5)
- 13GJ: GRF1-J-C-X-ST-CA1 (316 OPTION ONLY) (SEE SHEET 6)
- 01SB: SMA-J-C-X-ST-SB1 (SEE SHEET 6)
- 01SR: SMA-J-C-X-ST-SR1 (SEE SHEET 6)
- SING: SINGLE ENDED (ONE END ONLY, SEE NOTE 11)
- XXXXX: STRIPPED AND TINNED (THIS END ONLY-SEE NOTES 11-15 & SHEET 6, FIG. 3)

END 1 PLATING OPTION

- 1: GOLD ALL COMPONENTS
- 2: GOLD / NICKEL COMBINATION
- 3: ALTERNATE GOLD / NICKEL
- (SEE SHEET 3 FOR PLATING SPECIFICS)

FIG. 2
CABLE STRIPPING DIMENSIONS
PER CONFIGURATIONS
(SEE TABLE 1) (SEE NOTES 12,13,14,15)

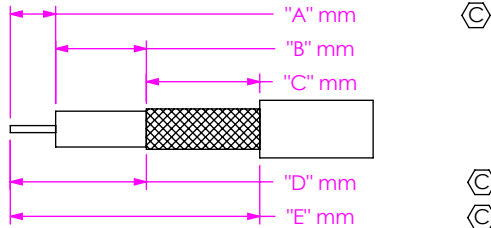

DO NOT
SCALE FROM
THIS PRINT

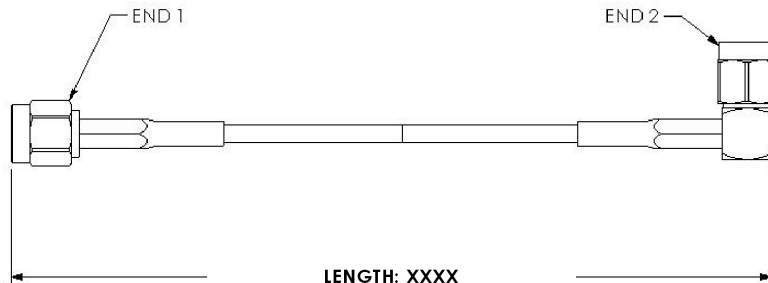

FIG. 1
RFXXX-01SPX-OTRPX-XXXX SHOWN

NOTES:

1. (C) REPRESENTS A CRITICAL DIMENSION.
2. CABLE CUT LENGTH:
= (LENGTH: XXXX) - (SUBTRACTOR FOR END 1) - (SUBTRACTOR FOR END 2).
(SEE TABLE 1 FOR SUBTRACTORS)
3. ASSEMBLY TO BE 100% TESTED FOR OPENS & SHORTS.
4. ASSEMBLY TO BE 100% HI-POT TESTED PER TABLE 1.
5. AFTER FINAL ELECTRICAL TESTS, LABEL EACH CABLE ASSEMBLY WITH 1 LABEL -ET
6. CRITICALS ON CONNECTOR PRINTS TO BE CHECKED IN PROCESS.
7. FINISHED ASSEMBLIES TO BE PACKAGED PER PACKAGING STANDARD CO-HD-WI-3033-M.
-LOCK WASHERS, NUTS, AND GASKETS TO BE SHIPPED UNASSEMBLED.
8. CABLE STOCKED IN INCHES, 1 INCH = 25.4 MILLIMETERS.
9. CABLE LENGTHS LONGER THAN 1000 MILLIMETERS ARE NOT SUPPORTED BY S.I. TEST DATA.
10. MINIMUM BEND RADIUS FOR RG174 = 25.4 [1.00]
RG316 = 12.7 [.50]
11. FOR SING ENDED OR STRIPPED AND TINNED ASSEMBLIES: MAKE A DOUBLE ENDED ASSEMBLY AT TWICE THE CABLE LENGTH AND TEST BEFORE CUTTING ASSEMBLY IN HALF.
12. DIM "A", "B", AND "C" HAVE A MINIMUM VALUE OF 0.0mm & A MAXIMUM VALUE OF 9.9mm.
13. PRODUCTION OF STRIP AND TIN FOR CENTER DIELECTIC USE: A.
14. PRODUCTION OF STRIP AND TIN FOR SHIELD USE: D=A+B.
15. PRODUCTION OF STRIP AND TIN FOR JACKET USE: E=A+B+C.
16. FOR -RA TO -RA, CONNECTORS SHOULD BOTH BE ORIENTED UP. (SEE SHEET 6, FIG. 4)

DO NOT LEAVE ANY SPACE BLANK,
EACH MUST CONTAIN A
NUMERIC CHARACTER 0 THRU 9.

(SEE FIG. 2) "C" FORMAT: X.X mm
(SEE FIG. 2) "B" FORMAT: X.X mm
(SEE FIG. 2) "A" FORMAT: X.X mm

**THIS PRODUCT MANUFACTURED
WITH LEAD-FREE PROCESSING**

F:\DWG\MISC\mktg\RFXXX-XXXXX-XXXXXX-XXXX-MKT.SLDDRW

UNLESS OTHERWISE SPECIFIED, DIMENSIONS ARE IN MILLIMETERS [INCHES]. TOLERANCES ARE:	PROPRIETARY NOTE THIS DOCUMENT CONTAINS INFORMATION CONFIDENTIAL AND PROPRIETARY TO SAMTEC, INC. AND SHALL NOT BE REPRODUCED OR TRANSFERRED TO OTHER DOCUMENTS OR DISCLOSED TO OTHERS OR USED FOR ANY PURPOSE OTHER THAN THAT WHICH IT WAS OBTAINED WITHOUT THE EXPRESSED WRITTEN CONSENT OF SAMTEC, INC.
DECIMALS	ANGLES
.X: ±0.3 [0.1]	2°
.XX: ±0.13 [0.05]	
.XXX: ±0.051 [0.020]	

MATERIAL: DO NOT SCALE DRAWING SHEET SCALE: 2:1
SEE END 1 AND END 2 ASSEMBLY PRINTS

DESCRIPTION: RF316 OR RF-174 CABLE ASSEMBLY
DWG. NO. RFXXX-XXXXX-XXXXXX-XXXX
BY: TIM P. DATE: 5/3/2005 SHEET: 1 OF 6

TABLE 1

CABLE STRIPPING DIMENSIONS			CABLE CUT LGTH	HI-POT	
STYLE	"A"	"D"	"E"	"SUBTRACTOR"	DCV
-01SPX	2.5 [0.10]	4.3 [0.17]	10.0 [0.39]	5.7 [0.22]	1000
-01RPX	1.6 [0.06]	4.9 [0.19]	10.4 [0.41]	2.7 [0.11]	1000
-01BJX	2.8 [0.11]	7.1 [0.28]	12.8 [0.50]	9.0 [0.35]	1000
-01BRX	2.6 [0.10]	7.1 [0.28]	12.2 [0.48]	9.4 [0.37]	1000
-02SJX	2.6 [0.10]	5.0 [0.20]	10.1 [0.40]	6.2 [0.24]	1000
-02RPX	1.4 [0.06]	3.5 [0.14]	7.9 [0.31]	1.7 [0.07]	1000
-02SPX	2.4 [0.09]	3.8 [0.15]	8.5 [0.33]	7.4 [0.29]	1000
-03SPX	2.0 [0.08]	3.9 [0.15]	9.2 [0.36]	4.2 [0.17]	1000
-03RPX	1.2 [0.05]	2.7 [0.11]	8.0 [0.31]	1.4 [0.06]	1000
-04SPX	3.1 [0.12]	7.7 [0.30]	15.9 [0.63]	9.0 [0.35]	1000
-04BJX	4.3 [0.17]	9.4 [0.37]	19.1 [0.75]	13.4 [0.53]	1000
-05SPX	5.1 [0.20]	8.6 [0.34]	17.4 [0.69]	9.3 [0.37]	1000
-05BJX	4.3 [0.17]	9.2 [0.36]	17.5 [0.69]	13.4 [0.53]	1000
-06BJX	4.8 [0.19]	13.0 [0.51]	19.6 [0.77]	17.0 [0.67]	1000
-07SPX	1.8 [0.07]	3.9 [0.15]	9.6 [0.38]	7.7 [0.30]	1000
-07RPX	1.4 [0.06]	4.3 [0.17]	9.5 [0.37]	2.8 [0.11]	1000
-07BJX	2.3 [0.09]	5.3 [0.21]	9.8 [0.39]	8.4 [0.33]	1000
-13GPX	1.9 [0.07]	4.6 [0.18]	9.6 [0.38]	5.1 [0.20]	1000
-13GJX	2.2 [0.09]	4.8 [0.19]	9.3 [0.37]	4.2 [0.16]	1000
-01SBX	2.8 [0.11]	7.1 [0.28]	12.8 [0.50]	9.0 [0.35]	1000
-01SRX	2.5 [0.10]	6.7 [0.26]	12.4 [0.49]	9.4 [0.37]	1000
-SING	-	-	-	0.00 [0.00]	1000
-XXXXXX	-	-	-	0.00 [0.00]	1000

TABLE 2: FINAL ASSEMBLY LENGTH TOLERANCE

LENGTH	TOLERANCE
0100-0200 [3.92-7.87]	+3.0 [.12]/-0.0 [.00]
0200-0500 [7.87-19.69]	+5.0 [.20]/-0.0 [.00]
0500-1100 [19.69-43.30]	+10.0 [.40]/-0.0 [.00]
>1100 [43.30]	± 1%

F:\DWG\MISC\Mktg\RFXXX-XXXX-XXXXXX-XXXX-MKT.SLDDRW

PROPRIETARY NOTE

THIS DOCUMENT CONTAINS INFORMATION CONFIDENTIAL AND PROPRIETARY TO SAMTEC, INC. AND SHALL NOT BE REPRODUCED OR TRANSFERRED TO OTHER DOCUMENTS OR DISCLOSED TO OTHERS OR USED FOR ANY PURPOSE OTHER THAN THAT WHICH IT WAS OBTAINED WITHOUT THE EXPRESSED WRITTEN CONSENT OF SAMTEC, INC.

DO NOT SCALE DRAWING

SHEET SCALE: 1:1



520 PARK EAST BLVD, NEW ALBANY, IN 47150
 PHONE: 812-944-6733 FAX: 812-948-5047
 e-Mail: info@SAMTEC.com code: 55322

DESCRIPTION:
 RF316 OR RF-174 CABLE ASSEMBLY

DWG. NO.
RFXXX-XXXX-XXXXXX-XXXX

BY: TIM P. 5/3/2005 SHEET 2 OF 6

-01SP
(STRAIGHT PLUG)

(USE DRAWING No. SMA-P-C-X-ST-CA1
FOR ASSEMBLY INSTRUCTIONS)

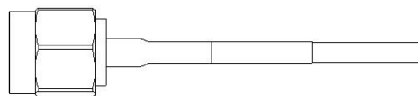

PLATING
1: 30µ" MIN. GOLD CENTER CONTACT
3µ" MIN. GOLD OUTER CONTACT
3µ" MIN. GOLD REMAINING METAL PARTS
(END CONNECTOR P/N: SMA-P-C-H-ST-CA1)

NOTE: ALL CRITICAL DIMENSIONS ON SMA-P-C-X-ST-CA1
THAT APPLY MUST BE VERIFIED.

-01RP
(RIGHT ANGLE PLUG)

(USE DRAWING No. SMA-P-C-X-RA-CA1
FOR ASSEMBLY INSTRUCTIONS)

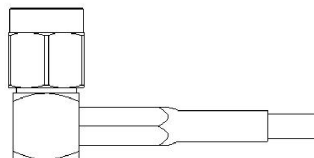

PLATING
1: 30µ" MIN. GOLD CENTER CONTACT
3µ" MIN. GOLD OUTER CONTACT
3µ" MIN. GOLD REMAINING METAL PARTS
(END CONNECTOR P/N: SMA-P-C-H-RA-CA1)

NOTE: ALL CRITICAL DIMENSIONS ON SMA-P-C-X-RA-CA1
THAT APPLY MUST BE VERIFIED.

-01BJ
(STRAIGHT BULKHEAD JACK)

(USE DRAWING No. SMA-J-C-X-ST-BH1
FOR ASSEMBLY INSTRUCTIONS)

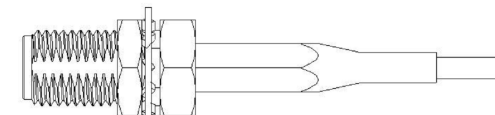

PLATING
1: 30µ" MIN. GOLD CENTER CONTACT
3µ" MIN. GOLD OUTER CONTACT
3µ" MIN. GOLD REMAINING METAL PARTS
(END CONNECTOR P/N: SMA-J-C-H-ST-BH1)

NOTE: ALL CRITICAL DIMENSIONS ON SMA-J-C-X-ST-BH1
THAT APPLY MUST BE VERIFIED.

-01BR (REVERSED POLARITY)
(STRAIGHT BULKHEAD JACK)

(USE DRAWING No. SMA-J-C-X-ST-BR1
FOR ASSEMBLY INSTRUCTIONS)

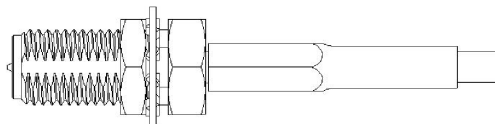

PLATING
1: 30µ" MIN. GOLD CENTER CONTACT
3µ" MIN. GOLD OUTER CONTACT
3µ" MIN. GOLD REMAINING METAL PARTS
(END CONNECTOR P/N: SMA-J-C-H-ST-BR1)

NOTE: ALL CRITICAL DIMENSIONS ON SMA-J-C-X-ST-BR1
THAT APPLY MUST BE VERIFIED.

-02SJ
(STRAIGHT JACK)

(USE DRAWING No. MCX-J-C-X-ST-CA1
FOR ASSEMBLY INSTRUCTIONS)

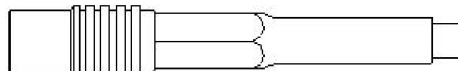

PLATING
1: 30µ" MIN. GOLD CENTER CONTACT
3µ" MIN. GOLD OUTER CONTACT
3µ" MIN. GOLD REMAINING METAL PARTS
(END CONNECTOR P/N: MCX-J-C-X-ST-CA1)

NOTE: ALL CRITICAL DIMENSIONS ON MCX-J-C-X-ST-CA1
THAT APPLY MUST BE VERIFIED.

-02RP
(RIGHT ANGLE PLUG)

(USE DRAWING No. MCX-P-C-XX-RA-CA1
FOR ASSEMBLY INSTRUCTIONS)

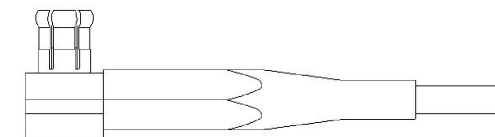

PLATING OPTIONS
1: 30µ" MIN. GOLD CENTER CONTACT
3µ" MIN. GOLD OUTER CONTACT
3µ" MIN. GOLD REMAINING METAL PARTS
(END CONNECTOR P/N: MCX-P-C-H-RA-CA1)

2: 30µ" MIN. GOLD CENTER CONTACT
3µ" MIN. GOLD OUTER CONTACT
100µ" MIN. NICKEL REMAINING METAL PARTS
(END CONNECTOR P/N: MCX-P-C-HN-RA-CA1)

NOTE: ALL CRITICAL DIMENSIONS ON MCX-P-C-XX-RA-CA1
THAT APPLY MUST BE VERIFIED.

F:\DWG\MISC\Mktg\RFXXX-XXXX-XXXX-XXXX-MKT.SLDDRW

PROPRIETARY NOTE

THIS DOCUMENT CONTAINS INFORMATION
CONFIDENTIAL AND PROPRIETARY TO
SAMTEC, INC. AND SHALL NOT BE REPRODUCED
OR TRANSFERRED TO OTHER DOCUMENTS OR
DISCLOSED TO OTHERS OR USED FOR ANY
PURPOSE OTHER THAN THAT WHICH IT WAS
OBTAINED WITHOUT THE EXPRESSED WRITTEN
CONSENT OF SAMTEC, INC.

DO NOT SCALE DRAWING

SHEET SCALE: 1:1



520 PARK EAST BLVD, NEW ALBANY, IN 47150
PHONE: 812-944-6733 FAX: 812-948-5047
e-Mail: info@SAMTEC.com code: 53322

DESCRIPTION:
RF316 OR RF-174 CABLE ASSEMBLY

DWG. NO.
RFXXX-XXXX-XXXX-XXXX

BY: TIM P. 5/3/2005 SHEET 3 OF 6

-02SP
(STRAIGHT PLUG)

(USE DRAWING No. MCX-P-C-XX-ST-CA1 FOR ASSEMBLY INSTRUCTIONS)

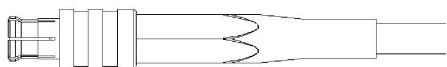

PLATING OPTIONS

1: 30µ" MIN. GOLD CENTER CONTACT
3µ" MIN. GOLD OUTER CONTACT
3µ" MIN. GOLD REMAINING METAL PARTS
(END CONNECTOR P/N: MCX-P-C-H-ST-CA1)

2: 30µ" MIN. GOLD CENTER CONTACT
3µ" MIN. GOLD OUTER CONTACT
100µ" MIN. NICKEL REMAINING METAL PARTS
(END CONNECTOR P/N: MCX-P-C-HN-ST-CA1)

NOTE: ALL CRITICAL DIMENSIONS ON MCX-P-C-XX-ST-CA1 THAT APPLY MUST BE VERIFIED.

-03SP
(STRAIGHT PLUG)

(USE DRAWING No. MMCX-P-C-X-ST-CA2 FOR ASSEMBLY INSTRUCTIONS)



PLATING OPTIONS

1: 30µ" MIN. GOLD CENTER CONTACT
3µ" MIN. GOLD OUTER CONTACT
3µ" MIN. GOLD REMAINING METAL PARTS
(END CONNECTOR P/N: MMCX-P-C-H-ST-CA2)

2: 30µ" MIN. GOLD CENTER CONTACT
3µ" MIN. GOLD OUTER CONTACT
100µ" MIN. NICKEL REMAINING METAL PARTS
(END CONNECTOR P/N: MMCX-P-C-HN-ST-CA2)

NOTE: ALL CRITICAL DIMENSIONS ON MMCX-P-C-X-ST-CA2 THAT APPLY MUST BE VERIFIED.

-03RP
(RIGHT ANGLE PLUG)

(USE DRAWING No. MMCX-P-C-X-RA-CA1 FOR ASSEMBLY INSTRUCTIONS)



PLATING

1: 30µ" MIN. GOLD CENTER CONTACT
3µ" MIN. GOLD OUTER CONTACT
3µ" MIN. GOLD REMAINING METAL PARTS
(END CONNECTOR P/N: MMCX-P-C-H-RA-CA1)

NOTE: ALL CRITICAL DIMENSIONS ON MMCX-P-C-X-RA-CA1 THAT APPLY MUST BE VERIFIED.

-04SP
(STRAIGHT PLUG)

(USE DRAWING No. BNC5-P-C-XX-ST-CA1 FOR ASSEMBLY INSTRUCTIONS)

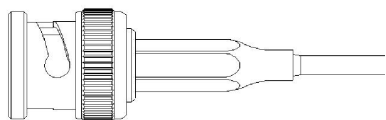

PLATING OPTIONS

2: 30µ" MIN. GOLD CENTER CONTACT
100µ" MIN. NICKEL OUTER CONTACT
100µ" MIN. NICKEL REMAINING METAL PARTS
(END CONNECTOR P/N: BNC5-P-C-HN-ST-CA1)

3: 10µ" MIN. GOLD CENTER CONTACT
100µ" MIN. NICKEL OUTER CONTACT
100µ" MIN. NICKEL REMAINING METAL PARTS
(END CONNECTOR P/N: BNC5-P-C-MN-ST-CA1)

NOTE: ALL CRITICAL DIMENSIONS ON BNC5-P-C-XX-ST-CA1 THAT APPLY MUST BE VERIFIED.

-04BJ
(STRAIGHT BULKHEAD JACK)

(USE DRAWING No. BNC5-J-C-XX-ST-BH1 FOR ASSEMBLY INSTRUCTIONS)

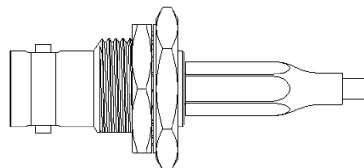

PLATING OPTIONS

2: 30µ" MIN. GOLD CENTER CONTACT
100µ" MIN. NICKEL OUTER CONTACT
100µ" MIN. NICKEL REMAINING METAL PARTS
(END CONNECTOR P/N: BNC5-J-C-HN-ST-BH1)

3: 10µ" MIN. GOLD CENTER CONTACT
100µ" MIN. NICKEL OUTER CONTACT
100µ" MIN. NICKEL REMAINING METAL PARTS
(END CONNECTOR P/N: BNC5-J-C-MN-ST-BH1)

NOTE: ALL CRITICAL DIMENSIONS ON BNC5-J-C-XX-ST-BH1 THAT APPLY MUST BE VERIFIED.

-05SP
(STRAIGHT PLUG)

(USE DRAWING No. TNC-P-C-XX-ST-CA1 FOR ASSEMBLY INSTRUCTIONS)

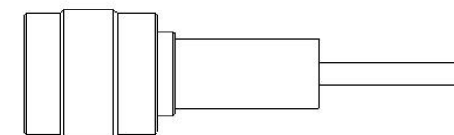

PLATING

3: 10µ" MIN. GOLD CENTER CONTACT
100µ" MIN. NICKEL OUTER CONTACT
100µ" MIN. NICKEL REMAINING METAL PARTS
(END CONNECTOR P/N: TNC-P-C-MN-ST-CA1)

NOTE: ALL CRITICAL DIMENSIONS ON TNC-P-C-XX-ST-CA1 THAT APPLY MUST BE VERIFIED.

F:\DWG\MISC\Mktg\RFXXX-XXXX-XXXX-XXXX-MKT.SLDDRW

PROPRIETARY NOTE

THIS DOCUMENT CONTAINS INFORMATION CONFIDENTIAL AND PROPRIETARY TO SAMTEC, INC. AND SHALL NOT BE REPRODUCED OR TRANSFERRED TO OTHER DOCUMENTS OR DISCLOSED TO OTHERS OR USED FOR ANY PURPOSE OTHER THAN THAT WHICH IT WAS OBTAINED WITHOUT THE EXPRESSED WRITTEN CONSENT OF SAMTEC, INC.

DO NOT SCALE DRAWING

SHEET SCALE: 1:1



520 PARK EAST BLVD, NEW ALBANY, IN 47150
PHONE: 812-944-6733 FAX: 812-948-5047
e-Mail: info@SAMTEC.com code: 55322

DESCRIPTION:
RF316 OR RF-174 CABLE ASSEMBLY

DWG. NO.
RFXXX-XXXXX-XXXXXX-XXXX

BY: TIM P. 5/3/2005 SHEET 4 OF 6

-05BJ
(STRAIGHT BULKHEAD JACK)

(USE DRAWING No. TNC-J-C-XX-ST-BH1
FOR ASSEMBLY INSTRUCTIONS)

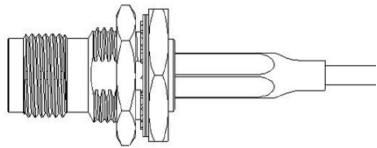

PLATING OPTIONS

2: 30µ" MIN. GOLD CENTER CONTACT
100µ" MIN. NICKEL OUTER CONTACT
100µ" MIN. NICKEL REMAINING METAL PARTS
(END CONNECTOR P/N: TNC-J-C-HN-ST-BH1)

3: 10µ" MIN. GOLD CENTER CONTACT
100µ" MIN. NICKEL OUTER CONTACT
100µ" MIN. NICKEL REMAINING METAL PARTS
(END CONNECTOR P/N: TNC-J-C-MN-ST-BH1)

NOTE: ALL CRITICAL DIMENSIONS ON TNC-J-C-XX-ST-BH1
THAT APPLY MUST BE VERIFIED.

-06BJ
(STRAIGHT BULKHEAD JACK)

(USE DRAWING No. NTPE-J-C-XX-ST-BH1
FOR ASSEMBLY INSTRUCTIONS)

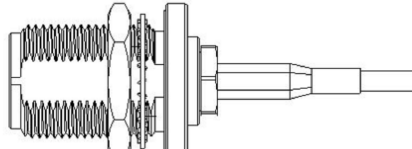

PLATING OPTIONS

2: 30µ" MIN. GOLD CENTER CONTACT
100µ" MIN. NICKEL OUTER CONTACT
100µ" MIN. NICKEL REMAINING METAL PARTS
(END CONNECTOR P/N: NTPE-J-C-HN-ST-BH1)

3: 10µ" MIN. GOLD CENTER CONTACT
100µ" MIN. NICKEL OUTER CONTACT
100µ" MIN. NICKEL REMAINING METAL PARTS
(END CONNECTOR P/N: NTPE-J-C-MN-ST-BH1)

NOTE: ALL CRITICAL DIMENSIONS ON NTPE-J-C-XX-ST-BH1
THAT APPLY MUST BE VERIFIED.

-07SP
(STRAIGHT PLUG)

(USE DRAWING No. SMB5-P-C-XX-ST-CA1
FOR ASSEMBLY INSTRUCTIONS)

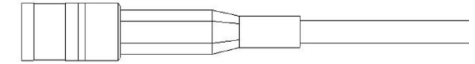

PLATING OPTIONS

1: 30µ" MIN. GOLD CENTER CONTACT
3µ" MIN. GOLD OUTER CONTACT
3µ" MIN. GOLD REMAINING METAL PARTS
(END CONNECTOR P/N: SMB5-P-C-H-ST-CA1)

2: 30µ" MIN. GOLD CENTER CONTACT
3µ" MIN. GOLD OUTER CONTACT
100µ" MIN. NICKEL REMAINING METAL PARTS
(END CONNECTOR P/N: SMB5-P-C-HN-ST-CA1)

NOTE: ALL CRITICAL DIMENSIONS ON SMB5-P-C-XX-ST-CA1
THAT APPLY MUST BE VERIFIED.

-07RP
(RIGHT ANGLE PLUG)

(USE DRAWING No. SMB5-P-C-XX-RA-CA1
FOR ASSEMBLY INSTRUCTIONS)

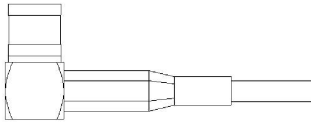

PLATING OPTIONS

1: 30µ" MIN. GOLD CENTER CONTACT
3µ" MIN. GOLD OUTER CONTACT
3µ" MIN. GOLD REMAINING METAL PARTS
(END CONNECTOR P/N: SMB5-P-C-H-RA-CA1)

2: 30µ" MIN. GOLD CENTER CONTACT
3µ" MIN. GOLD OUTER CONTACT
100µ" MIN. NICKEL REMAINING METAL PARTS
(END CONNECTOR P/N: SMB5-P-C-HN-RA-CA1)

NOTE: ALL CRITICAL DIMENSIONS ON SMB5-P-C-XX-RA-CA1
THAT APPLY MUST BE VERIFIED.

-07BJ
(STRAIGHT BULKHEAD JACK)

(USE DRAWING No. SMB5-J-C-X-ST-BH1
FOR ASSEMBLY INSTRUCTIONS)

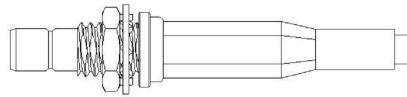

PLATING

1: 30µ" MIN. GOLD CENTER CONTACT
3µ" MIN. GOLD OUTER CONTACT
3µ" MIN. GOLD REMAINING METAL PARTS
(END CONNECTOR P/N: SMB5-J-C-H-ST-BH1)

NOTE: ALL CRITICAL DIMENSIONS ON SMB5-J-C-X-ST-BH1
THAT APPLY MUST BE VERIFIED.

-13GP
(STRAIGHT PLUG)

(USE DRAWING No. GRF1-P-C-X-ST-CA1
FOR ASSEMBLY INSTRUCTIONS)
(316 OPTION ONLY)

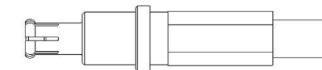

PLATING

1: 30µ" MIN. GOLD CENTER CONTACT
10µ" MIN. GOLD OUTER CONTACT
3µ" MIN. GOLD REMAINING METAL PARTS
(END CONNECTOR P/N: GRF1-P-C-H-ST-CA1)

NOTE: ALL CRITICAL DIMENSIONS ON GRF1-P-C-X-ST-CA1
THAT APPLY MUST BE VERIFIED.

F:\DWG\MISC\Mktg\RFXXX-XXXX-XXXX-XXXX-MKT.SLDDRW

PROPRIETARY NOTE

THIS DOCUMENT CONTAINS INFORMATION
CONFIDENTIAL AND PROPRIETARY TO
SAMTEC, INC. AND SHALL NOT BE REPRODUCED
OR TRANSFERRED TO OTHER DOCUMENTS OR
DISCLOSED TO OTHERS OR USED FOR ANY
PURPOSE OTHER THAN THAT WHICH IT WAS
OBTAINED WITHOUT THE EXPRESSED WRITTEN
CONSENT OF SAMTEC, INC.

DO NOT SCALE DRAWING

SHEET SCALE: 1:1



520 PARK EAST BLVD, NEW ALBANY, IN 47150
PHONE: 812-944-6733 FAX: 812-948-5047
e-Mail: info@SAMTEC.com code: 55322

DESCRIPTION:
RF316 OR RF-174 CABLE ASSEMBLY

DWG. NO.
RFXXX-XXXX-XXXX-XXXX

BY: TIM P. 5/3/2005 SHEET 5 OF 6

-13GJ
(STRAIGHT JACK)

(USE DRAWING No. GRF1-J-C-X-ST-CA1
FOR ASSEMBLY INSTRUCTIONS)
(316 OPTION ONLY)

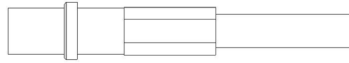

PLATING
T: 30µ" MIN. GOLD CENTER CONTACT
10µ" MIN. GOLD OUTER CONTACT
3µ" MIN. GOLD REMAINING METAL PARTS
(END CONNECTOR P/N: GRF1-J-C-H-ST-CA1)

NOTE: ALL CRITICAL DIMENSIONS ON GRF1-J-C-X-ST-CA1
THAT APPLY MUST BE VERIFIED.

-01SB
(SEALED STRAIGHT BULKHEAD JACK)

(USE DRAWING No. SMA-J-C-X-ST-SB1
FOR ASSEMBLY INSTRUCTIONS)

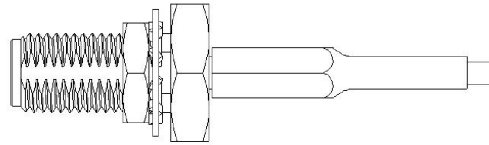

PLATING
T: 30µ" MIN. GOLD CENTER CONTACT
3µ" MIN. GOLD OUTER CONTACT
3µ" MIN. GOLD REMAINING METAL PARTS
(END CONNECTOR P/N: SMA-J-C-H-ST-SB1)

NOTE: ALL CRITICAL DIMENSIONS ON SMA-J-C-X-ST-SB1
THAT APPLY MUST BE VERIFIED.

-01SR (REVERSED POLARITY)
(SEALED STRAIGHT BULKHEAD JACK)

(USE DRAWING No. SMA-J-C-X-ST-SR1
FOR ASSEMBLY INSTRUCTIONS)

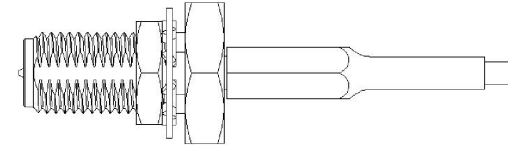

PLATING
T: 30µ" MIN. GOLD CENTER CONTACT
3µ" MIN. GOLD OUTER CONTACT
3µ" MIN. GOLD REMAINING METAL PARTS
(END CONNECTOR P/N: SMA-J-C-H-ST-SR1)

NOTE: ALL CRITICAL DIMENSIONS ON SMA-J-C-X-ST-SR1
THAT APPLY MUST BE VERIFIED.

FIG. 3
RFXXX-04BJX-T02148-XXXX SHOWN

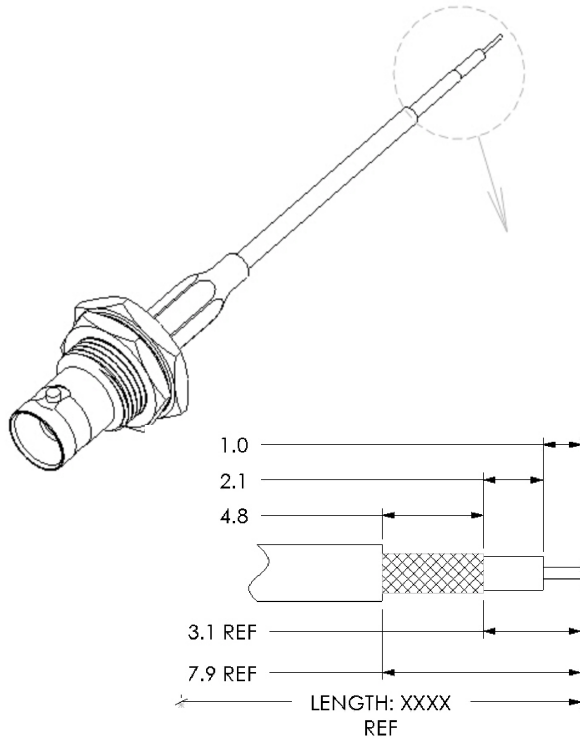
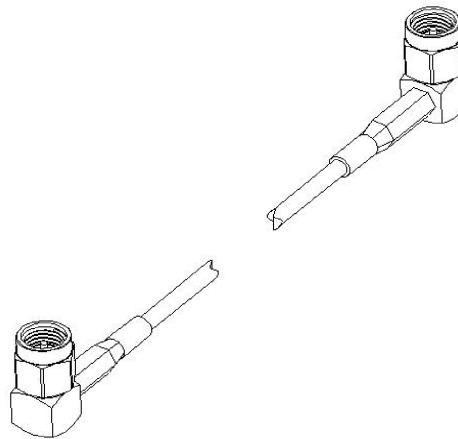

FIG. 4
RF316-01RPX-01RPX-XXXX SHOWN
(SEE NOTE 16)



F:\DWG\MISC\mktg\RFXXX-XXXX-XXXX-XXXX-MKT.SLDDRW

PROPRIETARY NOTE
THIS DOCUMENT CONTAINS INFORMATION
CONFIDENTIAL AND PROPRIETARY TO
SAMTEC, INC. AND SHALL NOT BE REPRODUCED
OR TRANSFERRED TO OTHER DOCUMENTS OR
DISCLOSED TO OTHERS OR USED FOR ANY
PURPOSE OTHER THAN THAT WHICH IT WAS
OBTAINED WITHOUT THE EXPRESSED WRITTEN
CONSENT OF SAMTEC, INC.

DO NOT SCALE DRAWING

SHEET SCALE: 1:1



520 PARK EAST BLVD, NEW ALBANY, IN 47150
PHONE: 812-944-6733 FAX: 812-948-5047
e-Mail: info@SAMTEC.com code: 55322

DESCRIPTION:
RF316 OR RF-174 CABLE ASSEMBLY

DWG. NO.
RFXXX-XXXXX-XXXXXX-XXXX

BY: TIM P. 5/3/2005 SHEET 6 OF 6