

HIGH DENSITY Pin Grid Array Sockets

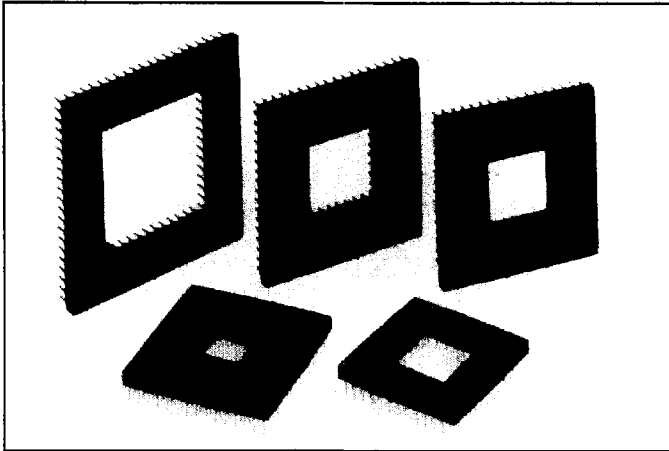

PGA SERIES



- High temp molded insulator body
- Stand-offs available to eliminate intermittent solder connections
- Precision screw machine sockets for high reliability
- Available with solder, wire wrap and press tails
- Available with "Ultra Low Force" 6-finger contact (US lead style only)

Grid Size	Dimension A
8 x 8	.800" (20.32)
9 x 9	.900" (22.86)
10 x 10	1.000" (25.40)
11 x 11	1.100" (27.94)
12 x 12	1.200" (30.48)
13 x 13	1.300" (33.02)
14 x 14	1.400" (35.56)
15 x 15	1.500" (38.10)
16 x 16	1.600" (40.64)
17 x 17	1.700" (43.18)
18 x 18	1.800" (45.72)
19 x 19	1.900" (48.26)
20 x 20	2.000" (50.80)
21 x 21	2.100" (53.34)

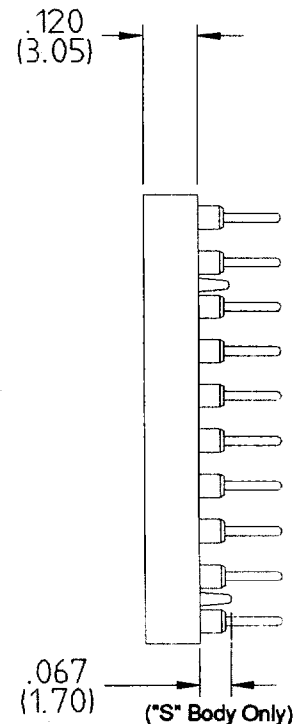
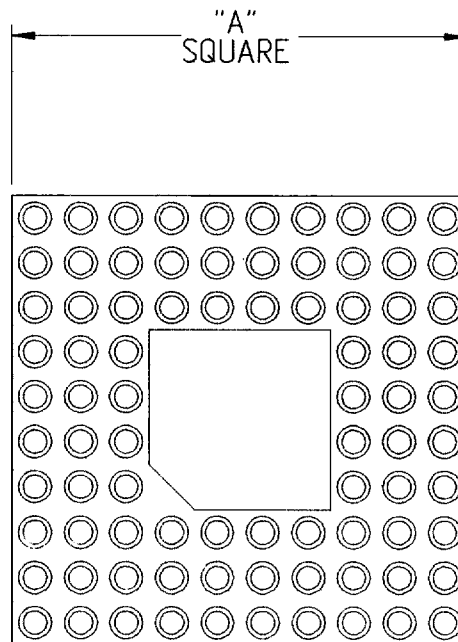

Materials:

Body: High temp, black polyester, glass-filled
Contacts: Beryllium Copper
Shell: Half Hard Brass

Acceptable Pin Sizes:

Diameter: .016" - .021" (.41 - .53)
Length:
S, US, SL, E275 & E350: .110" - .150" (2.79 - 3.81)
WB: .110" - .165" (2.79 - 4.19)

Mounting Information:

Solder Tail & Wire
Wrap: = .040" ± .002" (1.01 ± .05) PCB

Agency Approvals: #E73746

Performance Characteristics:

Low Force (All Lead Styles Except US)
Insertion Force: 3 ounces* max per contact
Withdrawal Force: .7 ounce* min per contact
Ultra Low Force (US Lead Style)
Insertion Force: 1.7 ounces* max per contact
Withdrawal Force: .35 ounce* min per contact
 *using .018" diameter pin

Capacitance: 1 picofarad maximum
Insulation Resistance: 5000 megohms minimum
Dielectric Withstanding Voltage: 1000 volts AC
Current Rating: 1 Ampere
Flammability: UL 94V-0
Temperature Range: -65°C to + 125°C

Plating Description:

Suffix: TG = 10 μinch (.254 μm) minimum Gold on contact area.
 200 μinch (5.08 μm) minimum Tin/Lead on terminal area.
TG30 = 30 μinch (.762 μm) minimum Gold on contact area.
 200 μinch (5.08 μm) minimum Tin/Lead on terminal area.
TT = 150 μinch (3.81 μm) minimum Tin/Lead on contact area.
 200 μinch (5.08 μm) minimum Tin/Lead on terminal area.

All options include an Underplate of 50 μinch (1.27 μm) minimum Nickel.

How To Order PGA Series

PGA — 132 A H 3 — X — XX

Number of Contacts
(See pages 57-60)

Loading Pattern Code
(See pages 57-60)

Body Specification:

H = High Temp

S = High Temp with Stand-offs

M = Standard Polyester

(8x8, 9x9 & 10x10 Full Grid)

Plating Code: Specify
TG, TG30, TT

Lead Style

Lead Style

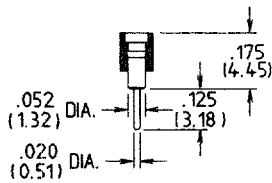

S, US*

*Ultra Low Force
US = TG30 Plating

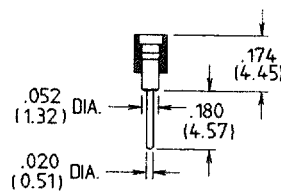

SL

TG or TG30
Plating Only

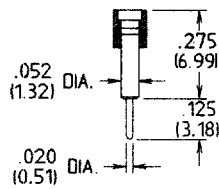

E275

TG Plating Only

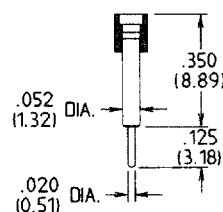

E350

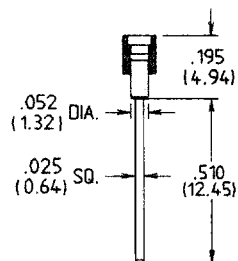

WB

Wire Wrap
TG Plating Only