

# SMD Power Inductor



6.6 x 4.45 x 2.92mm

ASPI - 0603T



**RoHS**  
Compliant

## FEATURES:

- Very small foot print, low profile in space conscious applications
- Flat-top for pick & place
- Supper low resistance with high current rating

## APPLICATIONS:

- Ideal for Palm-Top and Laptop
- DC to DC converters
- PDA's flash memory
- Step-up, step-down converters

## ELECTRICAL SPECIFICATIONS:

Abrakon P/N: **ASPI-0603T**

ABRACON P/N	IND. ( $\mu$ H)	DCR ( $\Omega$ Max.)	$I_{SAT}$ DC (A)	$I_{RMS}$ (A)	SRF Typ (MHz)
ASPI-0603T-1R0M/K	1.0	0.050	2.90	2.9	130
ASPI-0603T-1R5M/K	1.5	0.065	2.60	2.8	115
ASPI-0603T-2R2M/K	2.2	0.075	2.30	2.4	90
ASPI-0603T-3R3M/K	3.3	0.055	2.00	1.6	70
ASPI-0603T-4R7M/K	4.7	0.11	1.50	1.5	50
ASPI-0603T-6R8M/K	6.8	0.14	1.20	1.4	45
ASPI-0603T-100M/K	10	0.16	1.10	1.1	35
ASPI-0603T-150M/K	15	0.25	0.90	1.2	30
ASPI-0603T-220M/K	22	0.37	0.70	0.8	20
ASPI-0603T-330M/K	33	0.51	0.58	0.6	15
ASPI-0603T-470M/K	47	0.65	0.50	0.5	14
ASPI-0603T-680M/K	68	0.87	0.40	0.4	11
ASPI-0603T-101M/K	100	1.30	0.31	0.3	9
ASPI-0603T-151M/K	150	2.00	0.27	0.25	6
ASPI-0603T-221M/K	220	3.11	0.22	0.20	5.5
ASPI-0603T-331M/K	330	3.80	0.18	0.16	5
ASPI-0603T-471M/K	470	5.06	0.16	0.15	4
ASPI-0603T-681M/K	680	9.20	0.14	0.12	3
ASPI-0603T-102M/K	1000	13.8	0.10	0.07	2

## NOTE

Tolerance: K=10%, M=20%

Testing Conditions: 100KHz, 0.1V<sub>RMS</sub>

Marking: Color code

Ind. drop = 10% typ. at  $I_{SAT}$  DC

$\Delta T = 15^{\circ}C$  temperature rise max at  $I_{RMS}$

Add -T for Tape and Reel

Operating Temperature:  $-40^{\circ}C$  to  $+85^{\circ}C$

RoHS Compliance product, effective Date Code 0523.

Label on reel and box

## OUTLINE DRAWING:

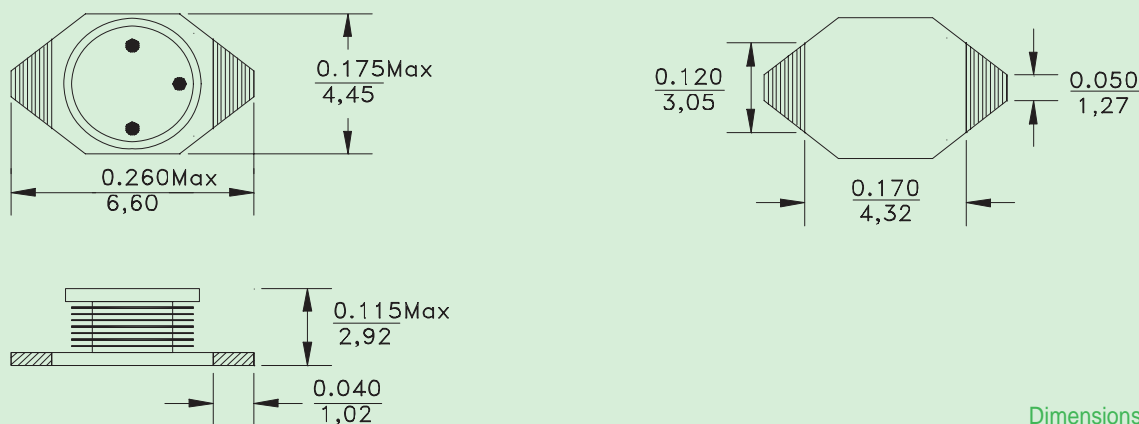

Dimensions: Inches  
(mm)

