

A

A

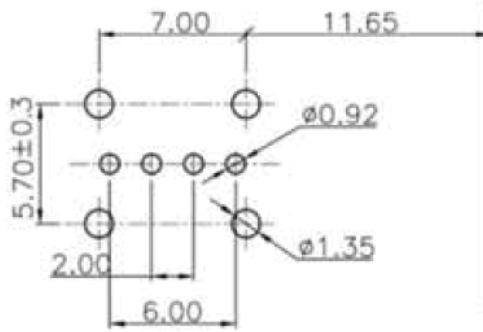
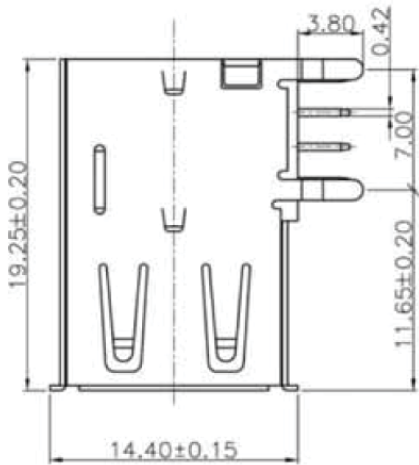

RECOMMENDED PCB LAYOUT

Materials:

- Housing: Thermoplastic (PA6T)
- Color: Black/White/Brown/Beige
- Contact: Phosphor Bronze
- Front Shell: Brass
- Back Shell: Steel
- Contact Plating: Gold
- 1μ"/3μ"/5μ"/10μ"/15μ"/30μ"
- Shell Plating: Nickel

B

B

C

C

D

D

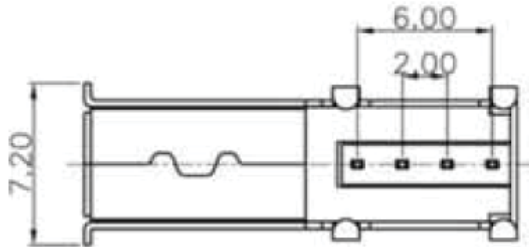
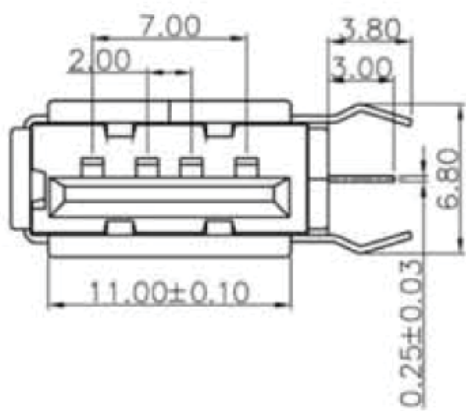

Electrical:

- Voltage Rating: 30V
- Current Rating: 1.5A
- Contact Resistance Terminal: 30MΩ Max.
- Dielectric withstanding voltage: 750V AC
- Insulation resistance: 1,000MΩ Min.
- Temperature Range: -55°C ~ +85°C

E

E

F

F

Scale	1:1						Name	Item No. A-USB-A-E-R
TOLERANCE					Drawn	10.19.11	Chappell	
X.X	±0.40				Approved			Title
X.XX	±0.25							USB 1.1, A version, Horizontal DIP Type
X.XXX	±0.15							Drawing No.
Angle	±3°							
								rev00
								Replace
								Sheet

G

G

H

H

