



TAI-SAW TECHNOLOGY CO., LTD.

No. 3, Industrial 2nd Rd., Ping-Chen Industrial District,
Taoyuan, 324, Taiwan, R.O.C.

TEL: 886-3-4690038 FAX: 886-3-4697532

E-mail: tstsales@mail.taisaw.com Web: www.taisaw.com

Approval Sheet For Product Specification

Issued Date:

Product Name: SAW Filter 1220 MHz

TST Parts No.:TA0194A

Customer Parts No.:_____

Company:_____
Division:_____
Approved by :_____
Date:_____

Checked by:_____ Andy Lee

Approval by:_____ Francis Chen

Date:_____ 2005/2/18



TAI-SAW TECHNOLOGY CO., LTD.

No. 3, Industrial 2nd Rd., Ping-Chen Industrial District,
Taoyuan, 324, Taiwan, R.O.C.

TEL: 886-3-4690038 FAX: 886-3-4697532

E-mail: tstsales@mail.taisaw.com Web: www.taisaw.com

SAW Filter 1220 MHz SMD 3.8X3.8mm

MODEL NO.: TA0194A

REV. NO.5

A. MAXIMUM RATING:

1. Operating Temperature: -40°C ~ +85°C
2. Storage Temperature: -40°C ~ +85°C

RoHS Compliant
Lead free
Lead-free soldering

B. Characteristics :

Balanced to Balanced operation

Terminating source impedance : $Z_s = 200 \Omega$

Terminating load impedance : $Z_L = 200 \Omega$

Characteristics	Value			Note
	Min.	Typ.	Max.	
Center frequency F_C MHz	-	1220	-	-
Insertion loss(1216~1224 MHz) I.L. dB	-	3.7	4.8	-
Ripple (1216~1224MHz) dB	-	0.8	1.5	-
Attenuation:(Reference level from 0 dB)				
1)500.. F_C -93 MHz dB	50	60	-	-
2) F_C -93... F_C -85 MHz dB	46	53	-	-
3) F_C -85... F_C -68 MHz dB	46	53	-	-
5) F_C -88 MHz dB	50	55	-	-
6) F_C -72 MHz dB	48	65	-	-
7) F_C -44 MHz dB	50	54	-	-
8) F_C -36 MHz dB	46	62	-	-
9) F_C +70...2000 MHz dB	50	61	-	-
Group delay ripple(p-p) (1216~1224MHz) nS	-	40	-	-

C. Measurement Circuit:

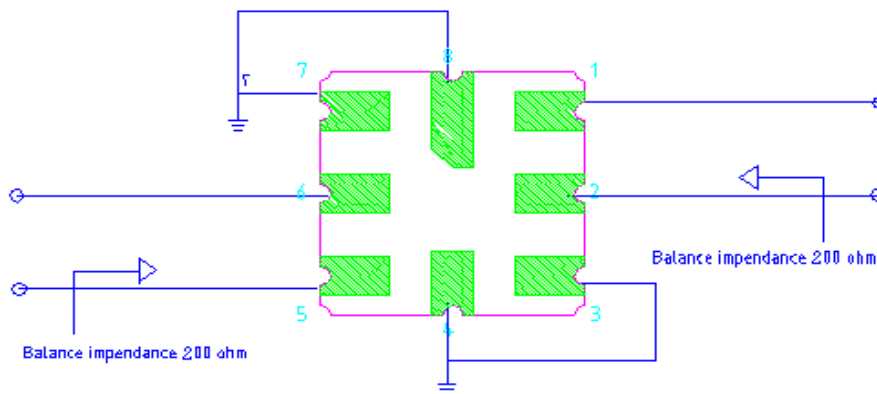

D. Frequency Characteristics :

1. Sdd21 Response

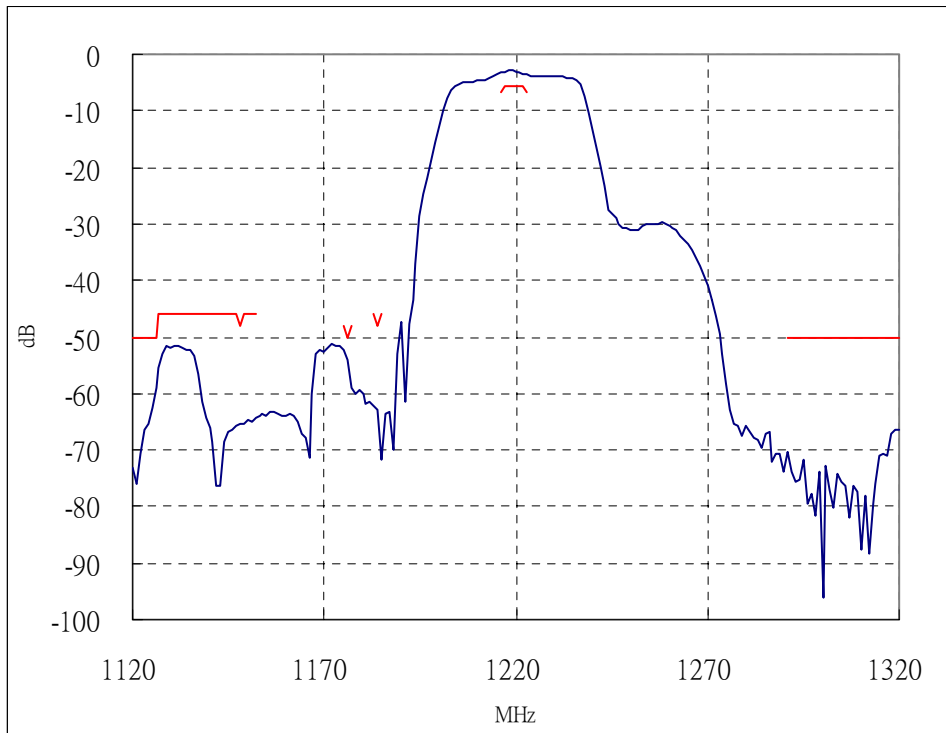

2. Sdd21 Response (Inband)

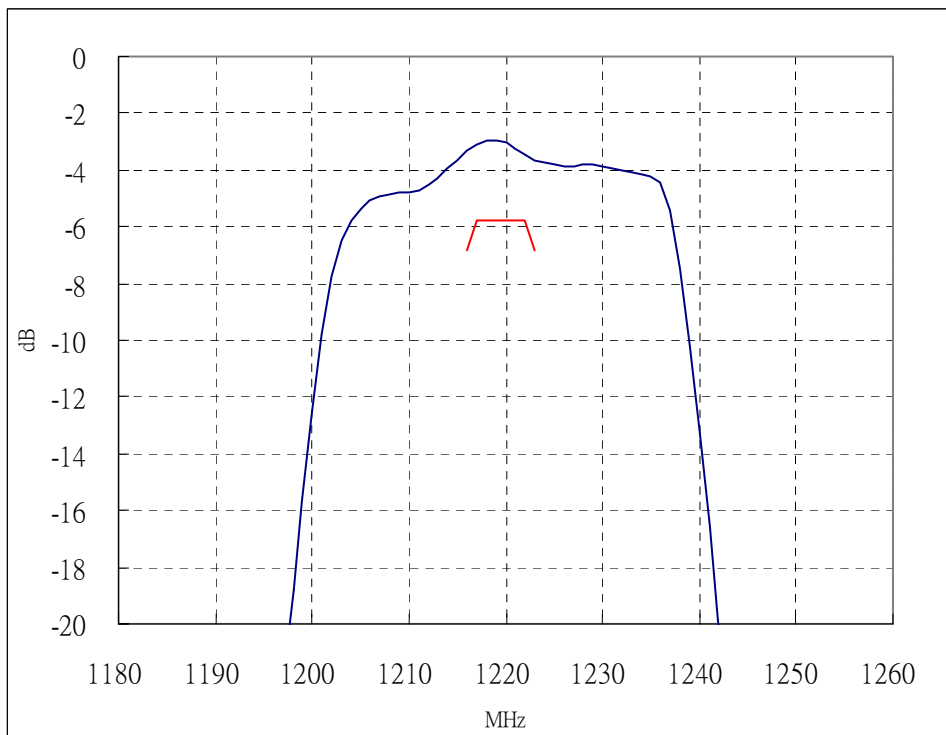

3. Sdd21 Response (wideband)

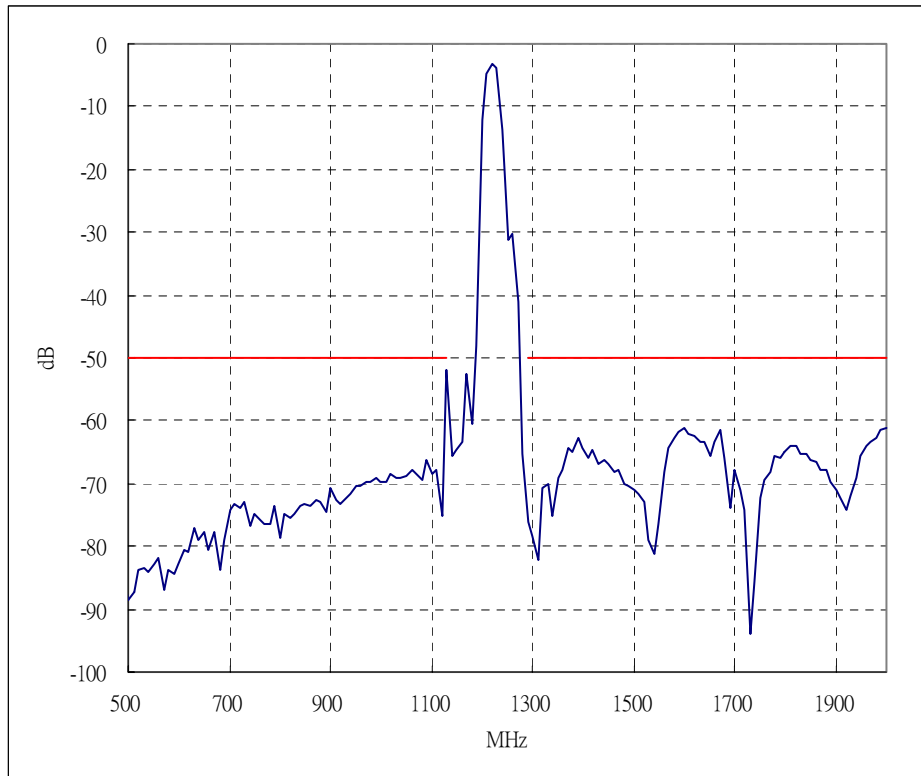

E. Outline Drawing:

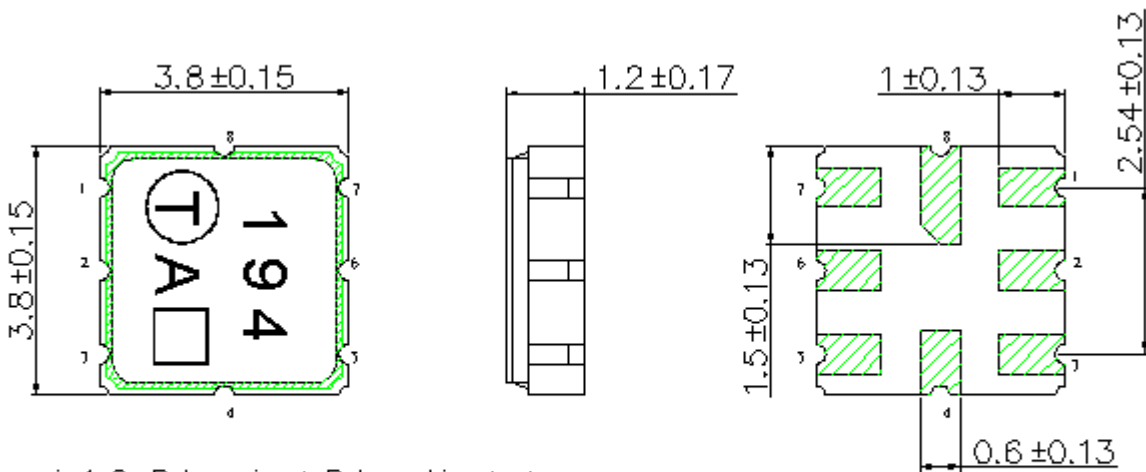

pin 1, 2 : Balance input, Balanced input return
 pin 5, 6 : Balanced output, Blanced output return
 pin 3,4,7,8 : To be Ground
 □ : Date code
 Unit: mm

F. PACKING:

1. REEL DIMENSION

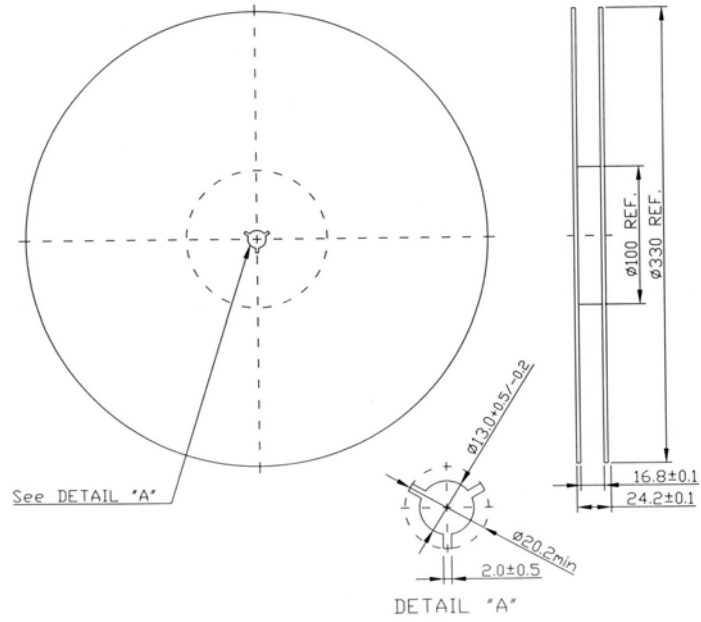

2. TAPE DIMENSION

