

SHELL	A±0.38	B±0.12	C±0.10	D±0.25	E±0.07	G±0.25
09	30.81	24.99	16.96	16.79	10.96	5.90
15	39.14	33.32	25.18	25.12	19.18	5.90
25	53.03	47.04	39.12	38.84	33.12	5.70

Core range			
SHELL	TIN LEAD P/N	LEAD FREE P/N	DESIGNATIONS
09	D09P24A4GV00	D09P24A4GV00LF	HEADER 9 CTS STRAIGHT -SOLDER TO BOARD-PCB HARPOON-SCREWLOCK UNC 4.40-ELEC.CONTIN.-PERFORM. LEVEL PL3
15	D15P24A4GV00	D15P24A4GV00LF	HEADER 15 CTS STRAIGHT-SOLDER TO BOARD-PCB HARPOON-SCREWLOCK UNC 4.40-ELEC.CONTIN.-PERFORM. LEVEL PL3
25	D25P24A4GV00	D25P24A4GV00LF	HEADER 25 CTS STRAIGHT-SOLDER TO BOARD-PCB HARPOON-SCREWLOCK UNC 4.40-ELEC.CONTIN.-PERFORM. LEVEL PL3

PC card drilling dimensions(after plating)  
(thickness 1.60±0.20mm)

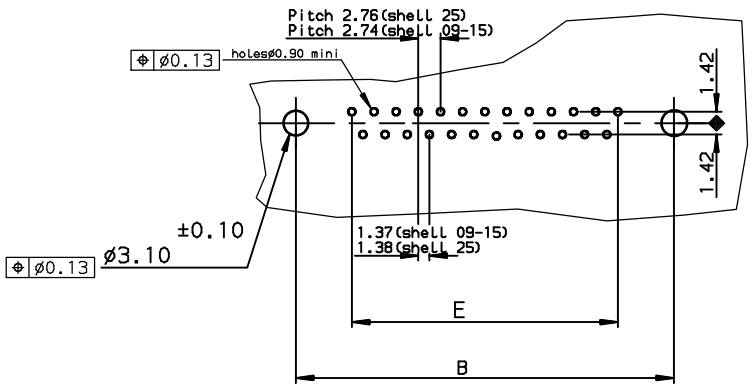

**GENERAL CHARACTERISTICS AND ROHS INFORMATIONS:**  
SEE DRAWING C01-8646-0000

European Views

www.fciconnect.com		surface ISO 1302 ✓	tolerance std ISO 406 ISO 1101	projection mm
TOLERANCES UNLESS OTHERWISE SPECIFIED				
Dr	JARRY	1995/08/11	0.x ±0.1	size A3
Eng	PESSON	1995/08/11	0.xx ±0.1	Scale 2
Chr	LEGARE	1995/08/11	0.xxx ±0.1	ECN LS06-0097
Appr	LEGARE	1995/08/11	Product family D-SUB	Spec ref -
			<b>HDR DELTA D STD EUROPE</b> straight, solder type for PCB 1.6mm catalog no -	
			sig no <b>C01-8646-100-1</b>	Rev. <b>F</b>
			CUSTOMER	sheet 1 of 1

rev	ecn no	dr	date
D	-	SBA	2003/04/16
E	LS05-0056	LGO	2005/07/07
F	LS06-0097	LGO	2006/07/29
-	-	-	-
-	-	-	-
-	-	-	-

REV F - 2006-04-17

Copyright FCI.