

1. Material:

Insulator: PBT+30%G.F UL 94V-0
 Contact: Brass
 Shell: SPCC
 Contact: 5µ Gold Contact Plating

2. Mechanical:

Mating: 35N max.
 Withdrawal Force: 10N min.
 Durability: 1500 cycles min.

3. Electrical:

Current-max[amps]: 1.5A
 Voltage-max[volts]: 30V
 Withstanding Voltage: 500V AC.
 Contact Resistance [ohms]: 30m ΩM+5A35B
 Insulation Resistance [ohms]: 1000M ΩM+5A35B

4. Plating:

Contacts: Tin Over Nickel Plated.
 Shell: Nickel Over all Plating

5. Environmental:

Temperature Range: -55°C to +85°C

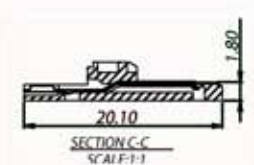
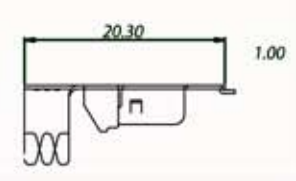
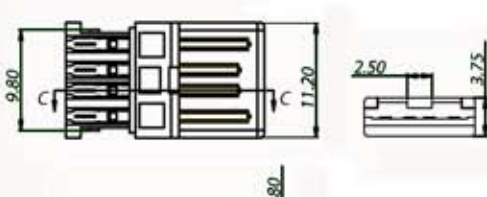
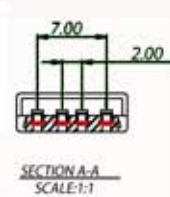
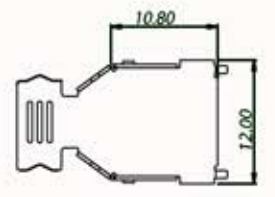
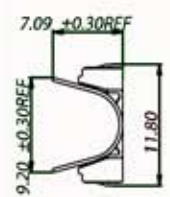

Scale	1:1						Name	Item No.
TOLERANCE					Drawn	4/10/12	Miller	A-USBPA-R
X.X	±0.40				Approved	4/10/12	Warner	
X.XX	±0.25							
X.XXX	±0.15							
Angle	±3°							
								Drawing No.
								Replace
								Sheet
		Modification	Date	Name				



rev00

A

B

C

D

E

F

Assembly Process:
Scale 1:1

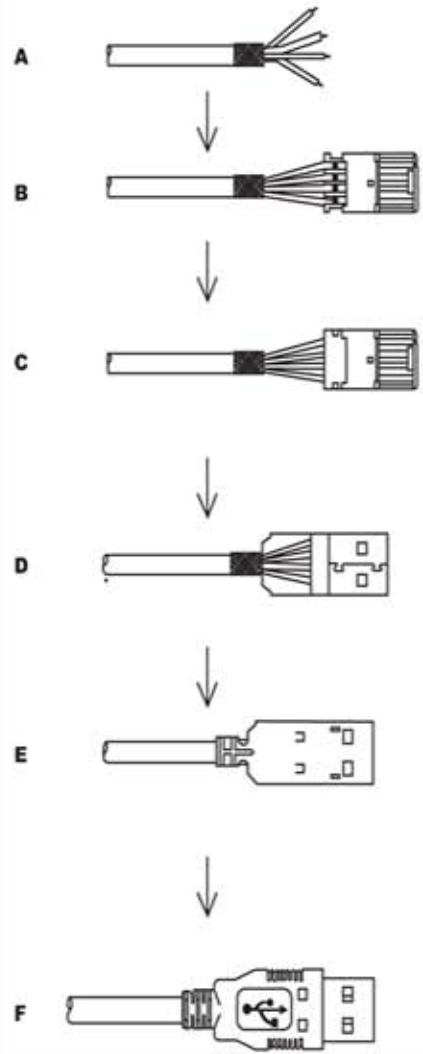

A

B

C

D

E

F



Scale	1:1							Name	Item No.
TOLERANCE						Drawn		Miller	
X.X	±0.40					Approved		Warner	Title
X.XX	±0.25								
X.XXX	±0.15								Drawing No.
Angle	±3°								rev00
									Sheet
			Modification	Date	Name				

G

H

H