

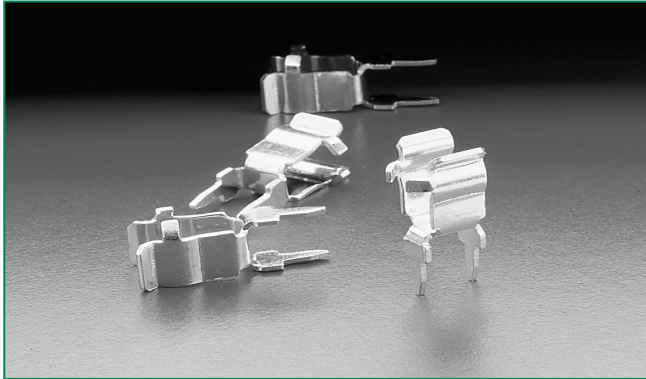

RoHS **Pb** **100/445/030/520 Series, P.C. Board Type for 5mm Diameter Fuses**



Product Characteristics

	100 054/056 series	100 020 series	445/030/520 series
Compatible Fuse Size	5mm Diameter Fuses		
Current Level	10 Amp max	20 Amp max	10 Amp max

Agency Approval

Agency	Agency File Number			
	100 054/056 series	445/030 series	100 020 series	520 series
	NA		E14721	

Product Dimensions

Mounting Dimensions for 100 Series

Fuse Size	A Dim.
5mm x 20 mm	20.5 (.807")
5mm x 25 mm	25.5 (1.004")
5mm x 30 mm	31.0 (1.220")

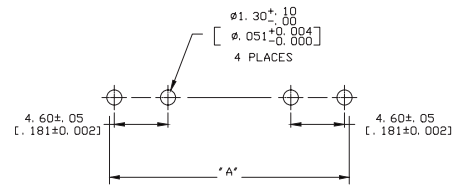
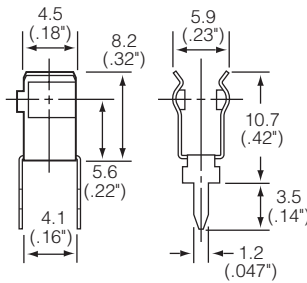

RECOMMENDED MOUNTING PATTERN

Mounting Dimensions for 445/030/520 Series

Table 1	A Dim.
5mm x 20 mm	20.5 (.807")
5mm x 25 mm	25.5 (1.004")
5mm x 30 mm	31.0 (1.220")

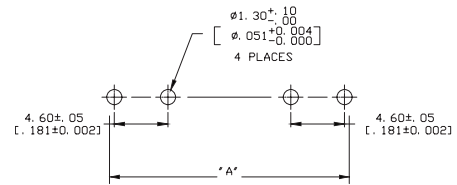
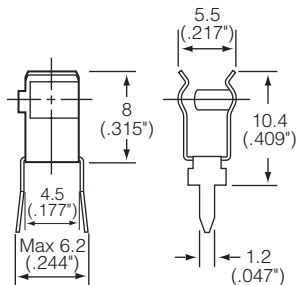

RECOMMENDED MOUNTING PATTERN

Ordering Information

Ordering PN*	Catalog No.	Clip Material	Plating	Style	Packaging Available
0100 0054	100 054	Spring Brass	Silver-plated	Ear	Z
0100 0056	100 056	Spring Brass	Tin-plated	Ear	Z
0100 0020	100 020	Phosphor Bronze	Tin-plated	Ear	Z
0445 0001	445 001	Spring Brass	Tin-plated	Ear	M or N
0030 0210	030 210	Spring Brass	Nickel-plated	Ear	M or N
0520 0001	520 001	Spring Brass	Silver-plated	Ear	M or N

Add Suffix to the Ordering PN for Packaging

"M" = std. package 1000 pcs per pack
 "Z" = for bulk package