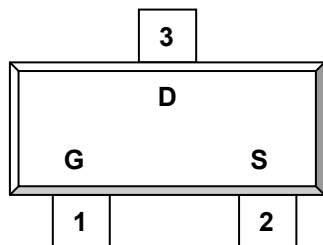

**DESCRIPTION**

ST2306SRG is the N-Channel logic enhancement mode power field effect transistor which is produced using high cell density, DMOS trench technology. This high density process is especially tailored to minimize on-state resistance. These devices are particularly suited for low voltage application such as cellular phone and notebook computer power management, other battery powered circuits, and low in-line power loss are required. The product is in a very small outline surface mount package.

**PIN CONFIGURATION  
SOT-23**

1.Gate 2.Source 3.Drain

**FEATURE**

- 30V/3.2A,  $R_{DS(ON)} = 45\text{m-ohm}$  (Typ.) @VGS = 10.0V
- 30V/2.0A,  $R_{DS(ON)} = 62\text{m-ohm}$  @VGS = 4.5V
- 30V/1.5A,  $R_{DS(ON)} = 92\text{ m-ohm}$  @VGS = 2.5V
- Super high density cell design for extremely low  $R_{DS(ON)}$
- Exceptional on-resistance and maximum DC current capability
- SOT-23 package design

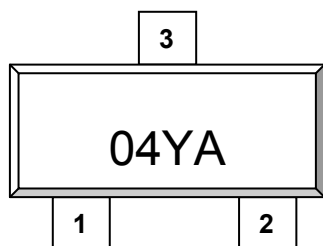
**PART MARKING  
SOT-23**

Y: Year Code A: Process Code

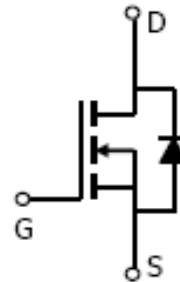
**ORDERING INFORMATION**

Part Number	Package	Part Marking
ST2306SRG	SOT-23	04YA

※ Process Code : A ~ Z ; a ~ z



**ST2306SRG** 

N Channel Enhancement Mode MOSFET

3.2A

**ABSOLUTE MAXIMUM RATINGS** (Ta = 25°C Unless otherwise noted )

Parameter	Symbol	Typical	Unit
Drain-Source Voltage	V <sub>DSS</sub>	30	V
Gate-Source Voltage	V <sub>GSS</sub>	±20	V
Continuous Drain Current (T <sub>J</sub> =150°C)	I <sub>D</sub>	T <sub>A</sub> =25°C 3.2	A
		T <sub>A</sub> =70°C 2.6	
Pulsed Drain Current	I <sub>DM</sub>	10	A
Continuous Source Current (Diode Conduction)	I <sub>S</sub>	1.20	A
Power Dissipation	P <sub>D</sub>	T <sub>A</sub> =25°C 1.20	W
		T <sub>A</sub> =70°C 0.8	
Operation Junction Temperature	T <sub>J</sub>	150	°C
Storage Temperature Range	T <sub>STG</sub>	-55/150	°C
Thermal Resistance-Junction to Ambient	R <sub>θJA</sub>	100	°C/W

**ELECTRICAL CHARACTERISTICS** ( Ta = 25°C Unless otherwise noted )

Parameter	Symbol	Condition	Min	Typ	Max	Unit
<b>Static</b>						
Drain-Source Breakdown Voltage	$V_{(BR)DSS}$	$V_{GS}=0V, I_D=250\mu A$	30			V
Gate Threshold Voltage	$V_{GS(th)}$	$V_{DS}=V_{GS}, I_D=250\mu A$	1.0		3.0	V
Gate Leakage Current	$I_{GSS}$	$V_{DS}=0V, V_{GS}=\pm 20V$			$\pm 100$	nA
Zero Gate Voltage Drain Current	$I_{DSS}$	$V_{DS}=30V, V_{GS}=1.0V$			1	uA
		$V_{DS}=30V, V_{GS}=0V$ $T_J=55^\circ C$			10	
Drain-source On-Resistance	$R_{DS(on)}$	$V_{GS}=10V, I_D=3.2A$ $V_{GS}=4.5V, I_D=2.0A$ $V_{GS}=2.5V, I_D=1.5A$		0.045 0.062 0.092	0.052 0.067 0.100	$\Omega$
Forward Transconductance	$g_{fs}$	$V_{DS}=4.5V, I_D=2.5V$		4.6		S
Diode Forward Voltage	$V_{SD}$	$I_S=1.25A, V_{GS}=0V$			1.2	V
<b>Dynamic</b>						
Total Gate Charge	$Q_g$	$V_{DS}=15V$ $V_{GS}=10V$ $I_D=2.5A$		4.5	10	nC
Gate-Source Charge	$Q_{gs}$			0.8		
Gate-Drain Charge	$Q_{gd}$			1.0		
Input Capacitance	$C_{iss}$	$V_{DS}=15V$ $V_{GS}=0V$ $F=1MHz$		240		pF
Output Capacitance	$C_{oss}$			110		
Reverse Transfer Capacitance	$C_{rss}$			17		
Turn-On Time	$t_{d(on)}$ $t_r$	$V_{DD}=15V$ $R_L=15\Omega$ $I_D=1.0A$ $V_{GEN}=10V$ $R_G=6\Omega$		8.0	20	nS
				12	30	
Turn-Off Time	$t_{d(off)}$ $t_f$			17	35	
				8.0	20	

**TYPICAL CHARACTERISTICS** (25°C Unless noted)

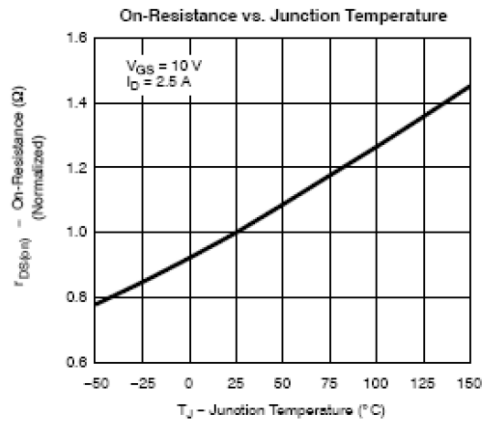
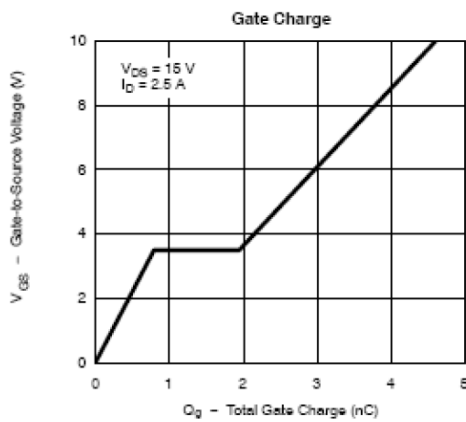
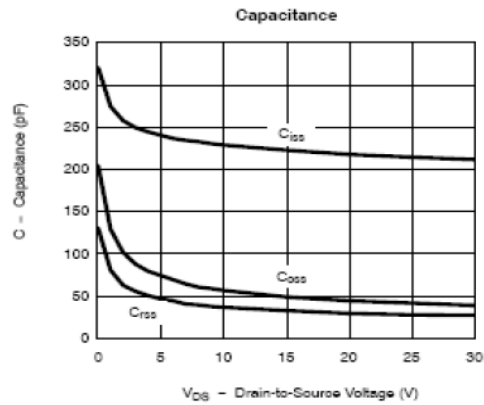
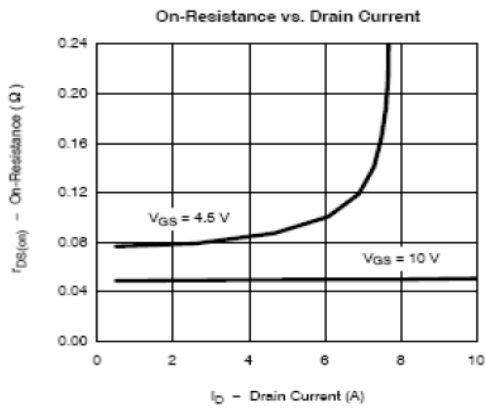
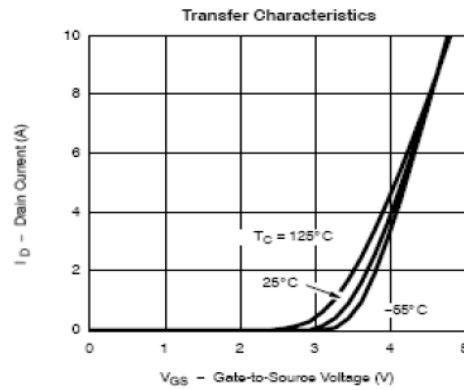
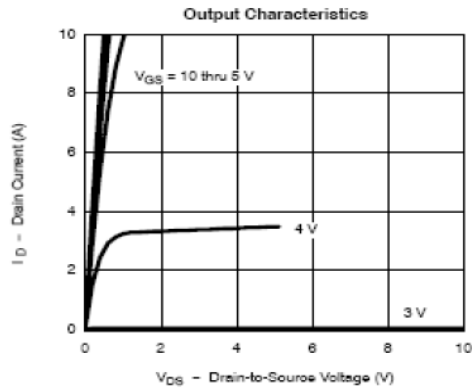

**TYPICAL CHARACTERISTICS** (25°C Unless noted)

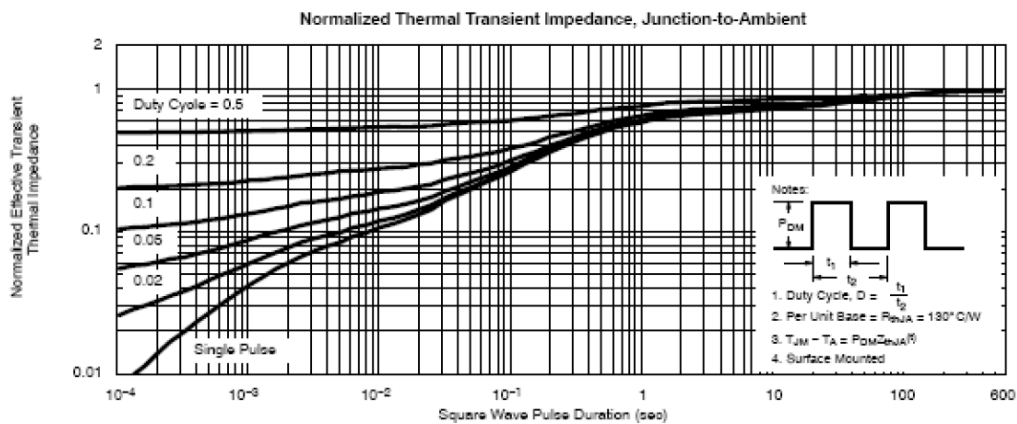
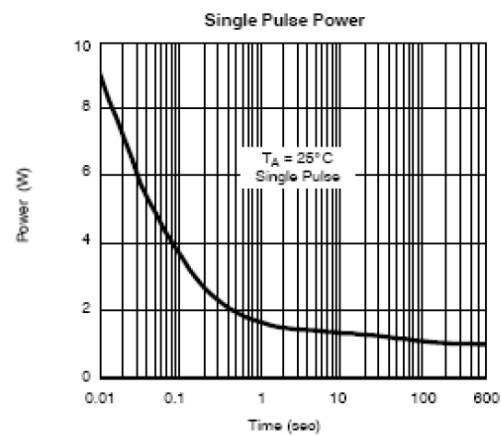
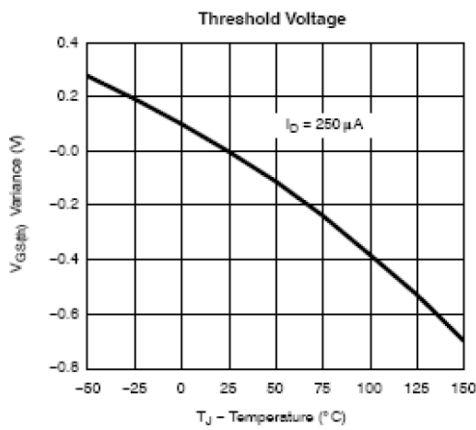
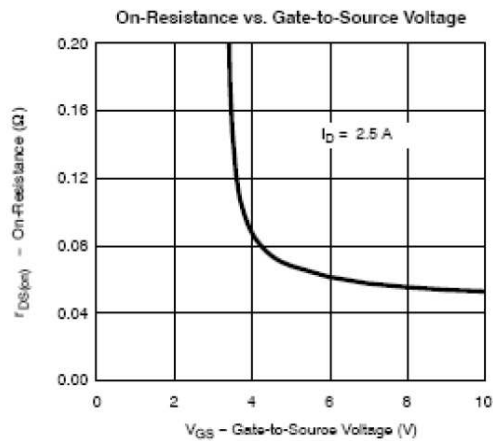
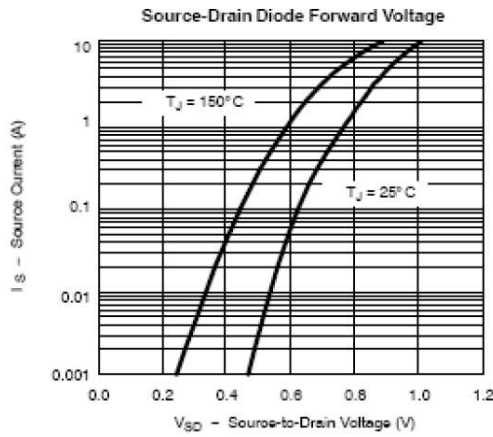

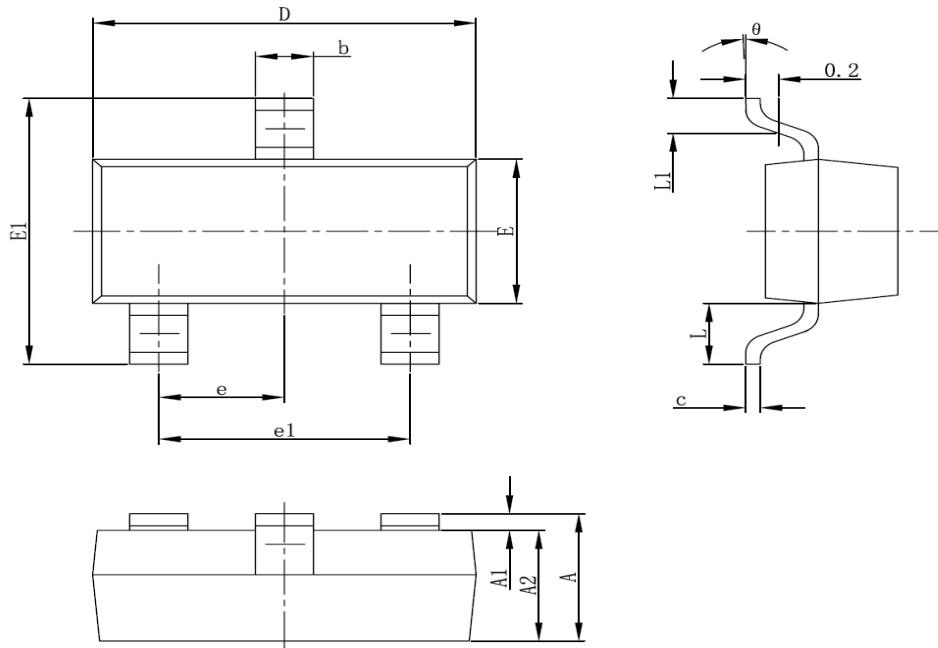
**SOT-23 PACKAGE OUTLINE**

Symbol	Dimensions In Millimeters		Dimensions In Inches	
	Min	Max	Min	Max
A	0.900	1.100	0.035	0.043
A1	0.000	0.100	0.000	0.004
A2	0.900	1.000	0.035	0.039
b	0.300	0.500	0.012	0.020
c	0.080	0.150	0.003	0.006
D	2.800	3.000	0.110	0.118
E	1.200	1.400	0.047	0.055
E1	2.250	2.550	0.089	0.100
e	0.950TYP		0.037TYP	
e1	1.800	2.000	0.071	0.079
L	0.550REF		0.022REF	
L1	0.300	0.500	0.012	0.020
θ	0°	8°	0°	8°