

# ROCKER SWITCHES

## SERIES RA1066

### RA 1066

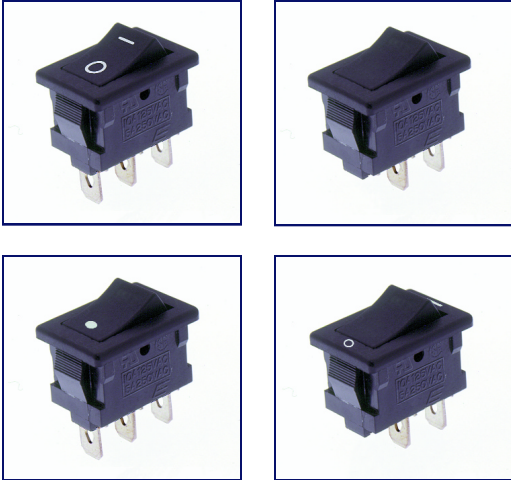

#### SPECIFICATIONS

**CONTACT RESISTANCE:** 100m max.

**DIELECTRIC STRENGTH:** AC2000V for 1 minute

**LIFE EXPECTANCY:** Electrical/10,000 cycle (R-L o a d )  
Mechanical/25,000 cycle

**RATING:** 10A 125VAC/5A 250VAC

**OPERATING FORCE:** 400±200gf

**SAFETY STANDARD APPROVAL:** UL (JRA), CSA, VDE, NEMKO,  
SEMKO, FIMKO, DEMKO

#### MATERIALS

**CONTACTS:** Silver plated copper alloy



### HOW TO ORDER

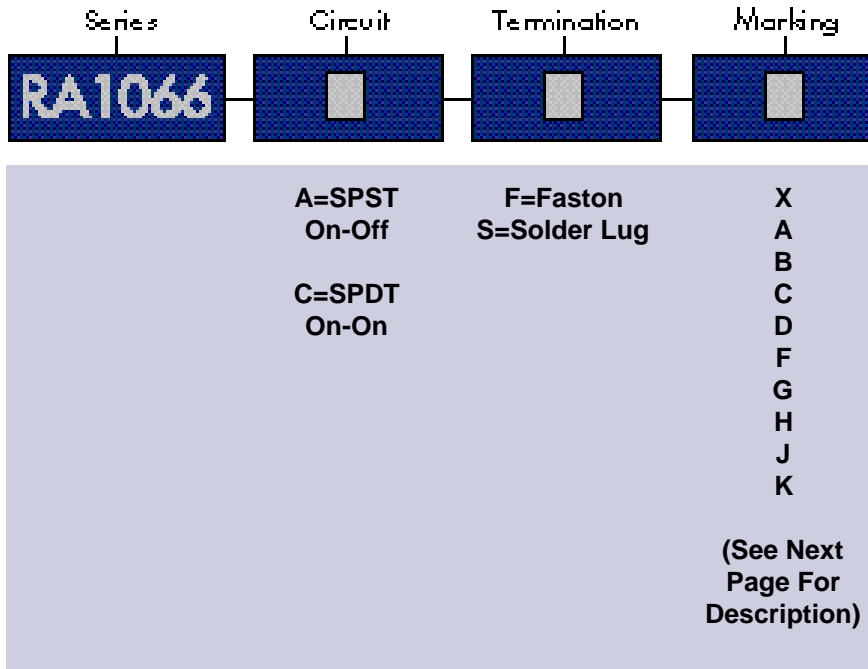

#### Example:

RA1066 → A → F → H

SPECIFICATIONS SUBJECT TO CHANGE WITHOUT NOTICE.

### A SPST

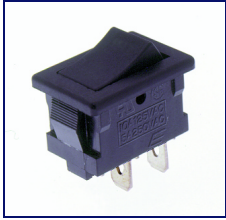

Circuit Code	POS 1	POS 2
A	ON	OFF
Term. Comm.	2-1	OPEN

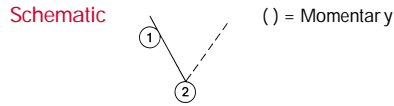

### C SPDT

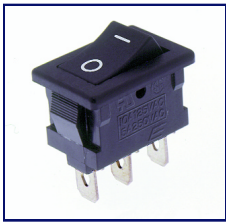

Circuit Code	POS 1	POS 2
C	ON	ON
Term. Comm.	2-1	2-3

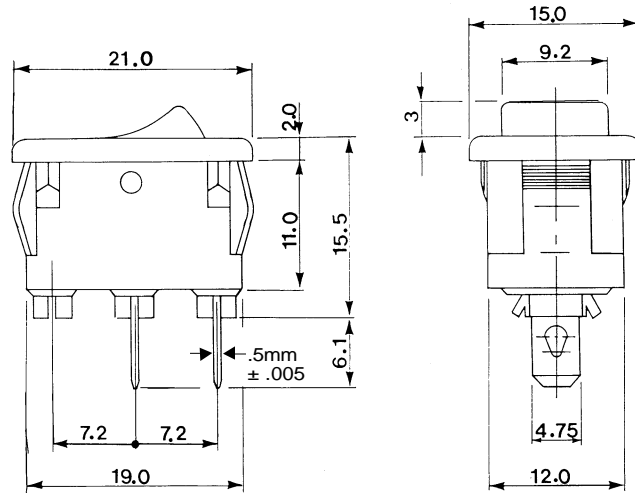
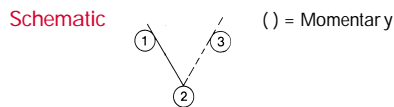

All dimensions in mm.

### PANEL MOUNTING

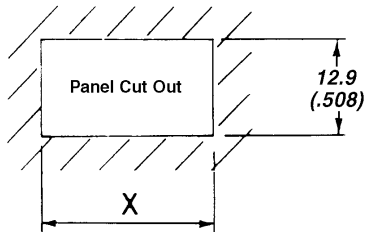

Panel Thickness	'X' Dim.
.75 - 1.25 (.030)-(.049)	19.2 (.756)
1.25 - 2.00 (.049)-(.079)	19.4 (.764)

### TERMINATION OPTIONS

#### F Faston

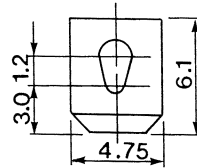

#### S Solder Lug

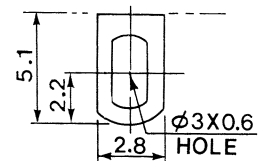

0.508 (.020) THK terminals designed for Quick Connect connectors available from AMP Industries, Harrisburg, PA 17105. (Or equivalent).

(F) Termination Rating:  
10A, 125VAC

(S) Termination Rating:  
5A, 250V AC

### MARKING OPTIONS

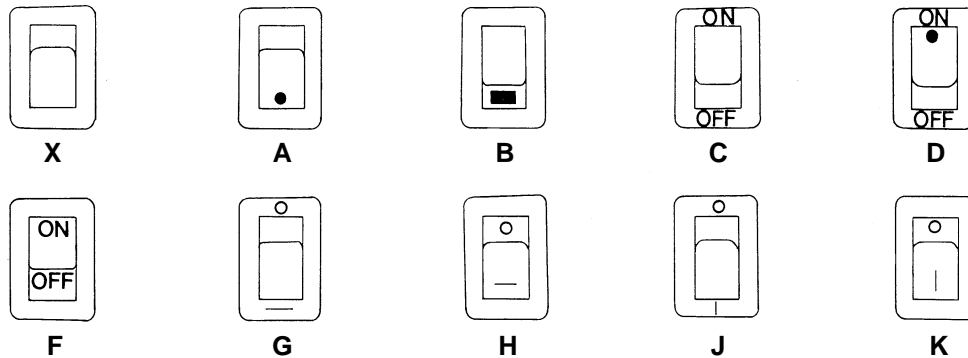

SPECIFICATIONS SUBJECT TO CHANGE WITHOUT NOTICE.