

### 1. CONFIGURATION & DIMENSIONS :

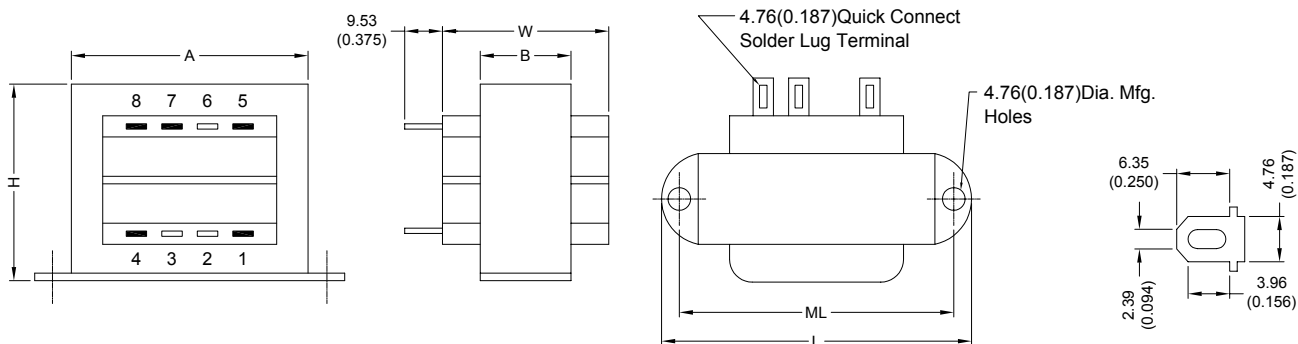

UNIT : mm (inch)

SIZE	VA	L	W	H	A	B	ML	gram
5	12	71.45 (2.813)	38.10 (1.500)	41.28 (1.625)	49.23 (1.938)	24.61 (0.969)	60.33 (2.375)	317.51

### 2. SCHEMATIC :

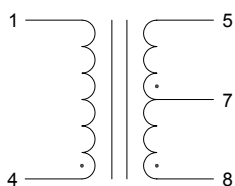

" . " indicates polarity

### 3. ELECTRICAL CHARACTERISTICS (@ 25°C) :

- |                                      |                              |
|--------------------------------------|------------------------------|
| a. Primary Voltage                   | AC 115 V 60 Hz .             |
| b. No Load Primary Current           | Less Than 20mA .             |
| c. Secondary Voltage (±5%)           |                              |
| Pin 5-8 C.T. Pin 7                   | AC 24.00 V .                 |
| d. Secondary Load Current            | 0.60A .                      |
| e. Full Load Primary Current         | Less Than 180mA .            |
| f. Full Load Secondary Voltage (±5%) | 20.00V .                     |
| Pin 5-8 C.T. Pin 7                   |                              |
| g. DC Resistance                     |                              |
| Pin 1-2                              | Primary = 71.10 Ohm .        |
| Pin 5-7                              | Secondary-1 = 1.38 Ohm .     |
| Pin 7-8                              | Secondary-2 = 1.57 Ohm .     |
| h. Insulation Resistance             | DC 500V 100Meg Ohm Of More . |
| i. Withstand Voltage (Hi-Pot)        | AC 2500V 60Hz 1 Minutes .    |
| j. Temperature Rise                  | Less Than 60 Deg C .         |
| k. Core Size                         | EI-48 x 20.80 m/m .          |

#### l. Turns & Wire Gauge

- |           |           |           |                |         |
|-----------|-----------|-----------|----------------|---------|
| Primary   | Pin 1-4   | 4027      | Turns Diameter | 0.18 mm |
| Secondary | Pin 5-7-8 | 0-107-214 | Turns Diameter | 0.40 mm |



**RoHS Compliant**

NOTE : Specifications subject to change without notice. Please check our website for latest information.

25.02.2008



**SUPERWORLD ELECTRONICS (S) PTE LTD**

PG. 1