

REV	DESCRIPTION	BY	DATE	APPD
B	ECR 7733	JEM	7/17/02	JEM

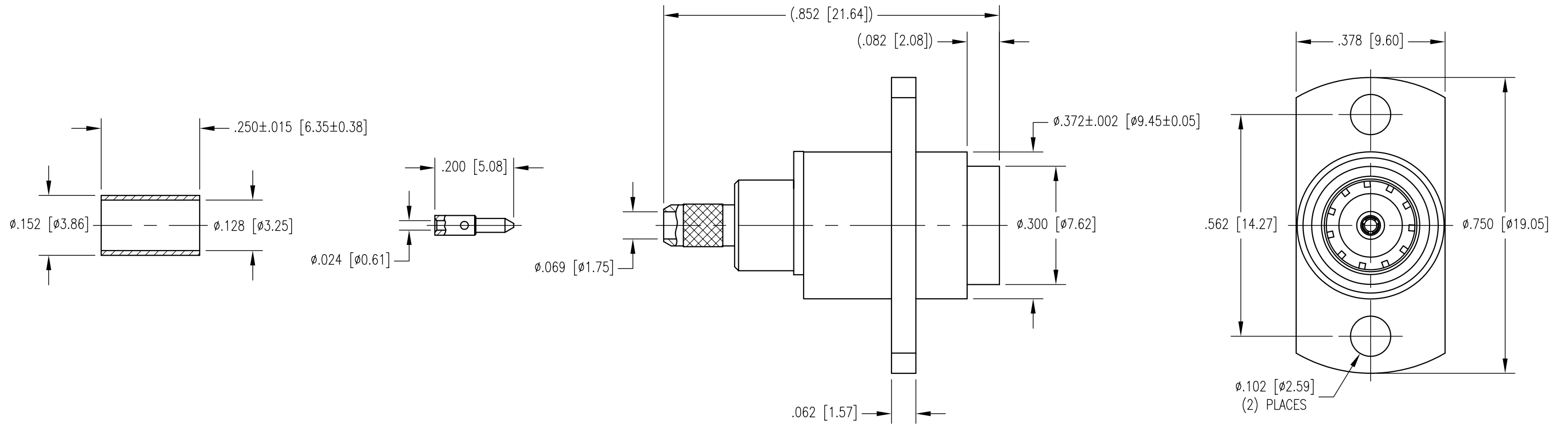

- NOTES:
- MATERIALS:  
 CENTER AND OUTER CONTACTS: COPPER ALLOY  
 SPRING: MUSIC WIRE PER ASTM A228  
 INSULATOR: TEFLON PER ASTM D1710  
 C-RING: SPRING STEEL  
 ALL OTHER METAL PARTS: BRASS PER ASTM B16
  - FINISH:  
 CONTACTS AND SHROUD: .000030 MIN. GOLD PER MIL-G-45204 OVER  
 .000050 MIN. NICKEL PER QQ-N-290  
 BODY: .000015 MIN. GOLD PER MIL-G-45204 OVER  
 .000050 MIN. NICKEL PER QQ-N-290  
 SPRING: UNPLATED  
 ALL OTHER METAL PARTS: .000005 MIN. GOLD PER MIL-G-45204 OVER  
 .000050 MIN. NICKEL PER QQ-N-290
  - FOR USE WITH RG-316 CABLE OR EQUIVALENT.
  - FOR CABLING PROCEDURES USE CAP 9-11 WITH TRIMMING DIMENSIONS SHOWN.
  - CRIMP FERRULE USING .128 HEX DIE.

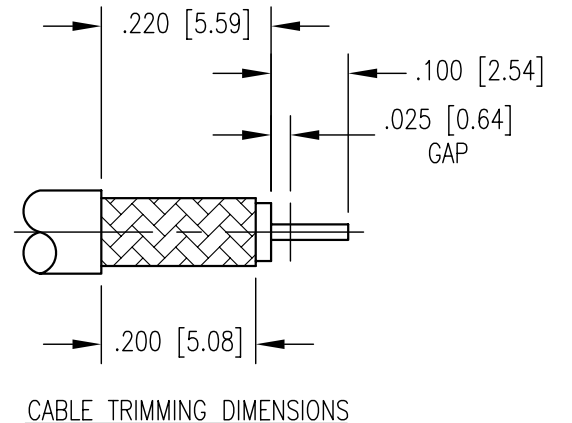

PER ASME Y14.5M-1994 UNLESS OTHERWISE SPECIFIED: DIMENSIONS ARE IN INCHES TOLERANCES: DECIMALS .xx ± .01 [0.254] .xxx ± .005 [0.127] ANGLES ± 2° SCALE: 4:1		<b>NORTHROP GRUMMAN</b> Winchester Electronics 62 Barnes Industrial Road North Wallingford, CT 06492	
<b>CUSTOMER DRAWING</b>		TITLE <b>BMA 2-HOLE FLANGE MOUNT                  FLOATING RECEPTACLE</b>	
DRAWN JED	DATE 8/26/02	CHECKED JWH	DATE 9/17/02
APPROVED JEM	DATE 9/13/02	APPROVED KJT	DATE 9/17/02
<b>B</b> 361-994-0630H		SHT. 1 OF 1	REV. B