

**PLEASE CHECK WWW.MOLEX.COM FOR LATEST PART INFORMATION**

**Part Number:** [0442624436](#)  
**Status:** **Active**  
**Description:** 9.14mm (.360") Pitch Crimp Terminal, Power Contact, Tin (Sn), All Over Nickel (Ni) with Select Gold, 14-16 AWG

**Documents:**

[Drawing \(PDF\)](#) [RoHS Certificate of Compliance \(PDF\)](#)

**General**

|                         |                       |
|-------------------------|-----------------------|
| Product Family          | Crimp Terminals       |
| Series                  | <a href="#">44262</a> |
| Crimp Quality Equipment | Yes                   |
| Product Name            | N/A                   |

**Physical**

|                                |                              |
|--------------------------------|------------------------------|
| Durability (mating cycles max) | 500                          |
| Gender                         | Female                       |
| Material - Metal               | High Performance Alloy (HPA) |
| Material - Plating Mating      | Tin                          |
| Packaging Type                 | Reel                         |
| Termination Interface: Style   | Crimp or Compression         |
| Wire Insulation Diameter       | 1.52-3.30mm (.060-.130")     |
| Wire Size AWG                  | 14, 16                       |
| Wire Size mm <sup>2</sup>      | N/A                          |

**Electrical**

|                               |         |
|-------------------------------|---------|
| Current - Maximum per Contact | 20A     |
| Voltage - Maximum             | 600V AC |

**Material Info**

**Reference - Drawing Numbers**

|               |              |
|---------------|--------------|
| Sales Drawing | SD-44262-100 |
|---------------|--------------|

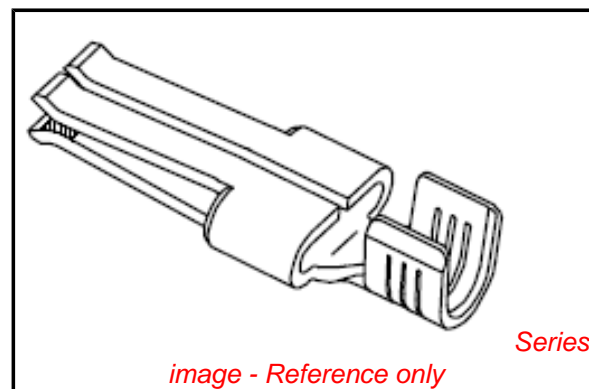

**EU RoHS**

**ELV and RoHS Compliant**  
**REACH SVHC Contains SVHC: No**  
**Halogen-Free Status**  
**Not Reviewed**

**China RoHS**



**Need more information on product environmental compliance?**

Email [productcompliance@molex.com](mailto:productcompliance@molex.com)  
 For a multiple part number RoHS Certificate of Compliance, [click here](#)

Please visit the [Contact Us](#) section for any non-product compliance questions.

**Search Parts in this Series**

[44262Series](#)

**Use With**

[638326100 Crimp Applicator](#)

**Application Tooling | FAQ**

*Tooling specifications and manuals are found by selecting the products below. Crimp Height Specifications are then contained in the Application Tooling Specification document.*

**Global**

| Description   | Product #                  |
|---|----------------------------|
| Hand Crimp Tool for 14-18 AWG Male and Female Power Contact Terminals | <a href="#">0638195500</a> |
| Mini-Mac™ Applicator  | <a href="#">0638326100</a> |

**PLEASE CHECK [WWW.MOLEX.COM](http://WWW.MOLEX.COM) FOR LATEST PART INFORMATION**

| PART NUMBER | PLATING   | RECOMMENDED WIRE SIZE   | DIM 'A' HEIGHT        | DIM 'B' WIDTH         | DIM 'C' GAP | DIM 'D' TIPS     | RECOMMENDED CRIMP APPLICATOR | MATING CONTACT  | PACKAGE SIZE        |
|-------------|---|-------------------------|-----------------------|-----------------------|-------------|------------------|------------------------------|---|---------------------|
| 44262-4304  | 80-160µ * TIN OVER<br>50µ * NICKEL OVERALL                                  | 8 AWG<br>(2) 12 AWG     | 7.42±0.5<br>.292±.020 | 5.84±0.5<br>.230±.020 |             |                  |                              |   | 1800 PARTS/<br>REEL |
| 44262-4334  | 30µ * GOLD STRIPE OVER<br>50µ * NICKEL OVERALL WITH<br>80-130µ * SELECT TIN |                         |                       |                       |             |                  | 63832-6300                   |   |                     |
| 44262-4302  | 80-160µ * TIN OVER<br>50µ * NICKEL OVERALL                                  | 10-12 AWG<br>(2) 14 AWG | 5.97±0.5<br>.235±.020 | 5.33±0.5<br>.210±.020 | 0.10/.004   | 2.54/.100<br>REF | 63832-6000                   | 44262-6***<br>SEE MOLEX<br>DRAWING<br>SD-44262-026<br>OR<br>WITH BLADES<br>0.64/.025 THICK X<br>6.10/.240 MM WIDE | 2500 PARTS/<br>REEL |
| 44262-4332  | 30µ * GOLD STRIPE OVER<br>50µ * NICKEL OVERALL WITH<br>80-130µ * SELECT TIN |                         |                       |                       |             |                  |                              |   |                     |
| 44262-4306  | 80-160µ * TIN OVER<br>50µ * NICKEL OVERALL                                  | 14-16 AWG<br>(2) 16 AWG | 5.20±0.5<br>.205±.020 | 5.33±0.5<br>.210±.020 |             |                  | 63832-6100                   |   |                     |
| 44262-4336  | 30µ * GOLD STRIPE OVER<br>50µ * NICKEL OVERALL WITH<br>80-130µ * SELECT TIN | (2) 18 AWG              |                       |                       |             |                  |                              |   |                     |
| 44262-4404  | 80-160µ * TIN OVER<br>50µ * NICKEL OVERALL                                  | 8 AWG<br>(2) 12 AWG     | 7.42±0.5<br>.292±.020 | 5.84±0.5<br>.230±.020 |             |                  |                              |   | 1800 PARTS/<br>REEL |
| 44262-4434  | 30µ * GOLD STRIPE OVER<br>50µ * NICKEL OVERALL WITH<br>80-130µ * SELECT TIN |                         |                       |                       |             |                  | 63832-6300                   |   |                     |
| 44262-4402  | 80-160µ * TIN OVER<br>50µ * NICKEL OVERALL                                  | 10-12 AWG<br>(2) 14 AWG | 5.97±0.5<br>.235±.020 | 5.33±0.5<br>.210±.020 | 0.64/.025   | 3.07/.121<br>REF | 63832-6000                   | FOR USE<br>WITH BLADES<br>1.27/.050 THICK X<br>6.10/.240 MM WIDE  | 2500 PARTS/<br>REEL |
| 44262-4432  | 30µ * GOLD STRIPE OVER<br>50µ * NICKEL OVERALL WITH<br>80-130µ * SELECT TIN |                         |                       |                       |             |                  |                              |   |                     |
| 44262-4406  | 80-160µ * TIN OVER<br>50µ * NICKEL OVERALL                                  | 14-16 AWG<br>(2) 16 AWG | 5.20±0.5<br>.205±.020 | 5.33±0.5<br>.210±.020 |             |                  | 63832-6100                   |   |                     |
| 44262-4436  | 30µ * GOLD STRIPE OVER<br>50µ * NICKEL OVERALL WITH<br>80-130µ * SELECT TIN | (2) 18 AWG              |                       |                       |             |                  |                              |   |                     |
| 44262-4504  | 80-160µ * TIN OVER<br>50µ * NICKEL OVERALL                                  | 8 AWG<br>(2) 12 AWG     | 7.42±0.5<br>.292±.020 | 5.84±0.5<br>.230±.020 |             |                  |                              |   | 1800 PARTS/<br>REEL |
| 44262-4534  | 30µ * GOLD STRIPE OVER<br>50µ * NICKEL OVERALL WITH<br>80-130µ * SELECT TIN |                         |                       |                       |             |                  | 63832-6300                   |   |                     |
| 44262-4502  | 80-160µ * TIN OVER<br>50µ * NICKEL OVERALL                                  | 10-12 AWG<br>(2) 14 AWG | 5.97±0.5<br>.235±.020 | 5.33±0.5<br>.210±.020 | 0.30/.012   | 2.74/.108<br>REF | 63832-6000                   | FOR USE<br>WITH BLADES<br>0.81/.032 THICK X<br>6.10/.240 MM WIDE<br>RECOMMENDED FOR<br>6 CIRCUITS AND ABOVE       | 2500 PARTS/<br>REEL |
| 44262-4532  | 30µ * GOLD STRIPE OVER<br>50µ * NICKEL OVERALL WITH<br>80-130µ * SELECT TIN |                         |                       |                       |             |                  |                              |   |                     |
| 44262-4506  | 80-160µ * TIN OVER<br>50µ * NICKEL OVERALL                                  | 14-16 AWG<br>(2) 16 AWG | 5.20±0.5<br>.205±.020 | 5.33±0.5<br>.210±.020 |             |                  | 63832-6100                   |   |                     |
| 44262-4536  | 30µ * GOLD STRIPE OVER<br>50µ * NICKEL OVERALL WITH<br>80-130µ * SELECT TIN | (2) 18 AWG              |                       |                       |             |                  |                              |   |                     |
| 44262-4604  | 80-160µ * TIN OVER<br>50µ * NICKEL OVERALL                                  | 8 AWG<br>(2) 12 AWG     | 7.42±0.5<br>.292±.020 | 5.84±0.5<br>.230±.020 |             |                  |                              |   | 1800 PARTS/<br>REEL |
| 44262-4634  | 30µ * GOLD STRIPE OVER<br>50µ * NICKEL OVERALL WITH<br>80-130µ * SELECT TIN |                         |                       |                       |             |                  | 63832-6300                   |   |                     |
| 44262-4602  | 80-160µ * TIN OVER<br>50µ * NICKEL OVERALL                                  | 10-12 AWG<br>(2) 14 AWG | 5.97±0.5<br>.235±.020 | 5.33±0.5<br>.210±.020 | 0.89/.035   | 3.33/.131<br>REF | 63832-6000                   | FOR USE<br>WITH BLADES<br>1.27/.050 THICK X<br>6.10/.240 MM WIDE<br>RECOMMENDED FOR<br>6 CIRCUITS AND ABOVE       | 2500 PARTS/<br>REEL |
| 44262-4632  | 30µ * GOLD STRIPE OVER<br>50µ * NICKEL OVERALL WITH<br>80-130µ * SELECT TIN |                         |                       |                       |             |                  |                              |   |                     |
| 44262-4606  | 80-160µ * TIN OVER<br>50µ * NICKEL OVERALL                                  | 14-16 AWG<br>(2) 16 AWG | 5.20±0.5<br>.205±.020 | 5.33±0.5<br>.210±.020 |             |                  | 63832-6100                   |   |                     |
| 44262-4636  | 30µ * GOLD STRIPE OVER<br>50µ * NICKEL OVERALL WITH<br>80-130µ * SELECT TIN | (2) 18 AWG              |                       |                       |             |                  |                              |   |                     |

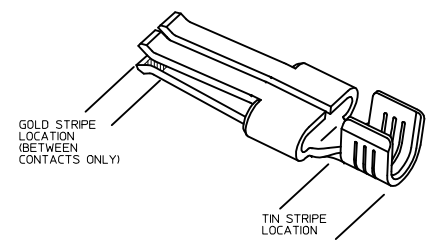

- NOTES:
1. MATERIAL: COPPER ALLOY .032 IN THICK
  2. FINISH: PER MOLEX PLATING SPECIFICATION ES-88 - SEE CHART
  3. FOR CRIMP APPLICATOR SEE CHART
  4. FOR CRIMP TOOLING CONTACT MOLEX OR VISIT THE MOLEX WEBSITE AT: WWW.MOLEX.COM
  5. STANDARD PACKAGE SIZE: SEE CHART
  6. SEE PRODUCT SPECIFICATION: PS-44262-001 FOR MORE INFORMATION
  7. PARTS ARE RoHS COMPLIANT
  8. FOR MATING CONTACT: SEE CHART
  9. FOR CRIMP SET UP INFORMATION SEE MOLEX APPLICATION SPECIFICATION DOCUMENT:  
8 AWG - ATS-638326300  
10/12 AWG - ATS-638326000  
14/16 AWG - ATS-638326100

|  |                 |  |   |              |                                     |                        |  |
|--|-----------------|--|---|--------------|-------------------------------------|------------------------|--|
| <b>REV DESCRIPTIONS IN CHART</b><br>DEC NO: UCP2009-1020<br>2008/11/04<br>DWN:MDATA<br>2008/11/04<br>CHKD:<br>2008/11/04<br>APPR:APATEL<br>2008/11/04<br>REV | QUALITY SYMBOLS | GENERAL TOLERANCES (UNLESS SPECIFIED)                | DIMENSION STYLE   | SCALE        | DESIGN UNITS                        | THIRD ANGLE PROJECTION |  |
|  | ▽=0             | 4 PLACES ±.005 ±.005                                 | MM/IN   | 1:1          | INCH                                | ☉                      |  |
|  | ▽=0             | 3 PLACES ±.010 ±.010                                 |   |              |                                     |                        |  |
|  | ▽=0             | 2 PLACES ±.025 ±.010                                 |   |              |                                     |                        |  |
|  |                 | 1 PLACE ±.025 ±.005                                  |   |              |                                     |                        |  |
|  |                 | ANGULAR ±1/2°  |   |              |                                     |                        |  |
|  |                 | DRAFT WHERE APPLICABLE MUST REMAIN WITHIN DIMENSIONS |   |              |                                     |                        |  |
|  |                 |  | DRAWN BY  | DATE         | TITLE                               |                        |  |
|  |                 |  | BKOSTIC   | 2006/11/13   | TERMINAL - RECEPTACLE POWER CONTACT |                        |  |
|  |                 |  | CHECKED BY  | DATE         |                                     |                        |  |
|  |                 |  | BKOSTIC   | 2006/11/13   |                                     |                        |  |
|  |                 |  | APPROVED BY   | DATE         |                                     |                        |  |
|  |                 |  | APATEL  | 2006/11/14   |                                     |                        |  |
|  |                 |  | MATERIAL NO.  | DOCUMENT NO. |                                     |                        |  |
|  |                 |  | SEE CHART   | SD-44262-100 |                                     |                        |  |
|  |                 |  | SIZE  |              | SHEET NO.                           |                        |  |
|  |                 |  | D   |              | 1 OF 2                              |                        |  |
|  |                 |  | THIS DRAWING CONTAINS INFORMATION THAT IS PROPRIETARY TO MOLEX INCORPORATED AND SHOULD NOT BE USED WITHOUT WRITTEN PERMISSION |              |                                     |                        |  |

20 19 18 17 16 15 14 13 12 11 10 9 8 7 6 5 4 3 2 1

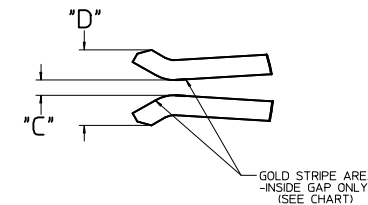
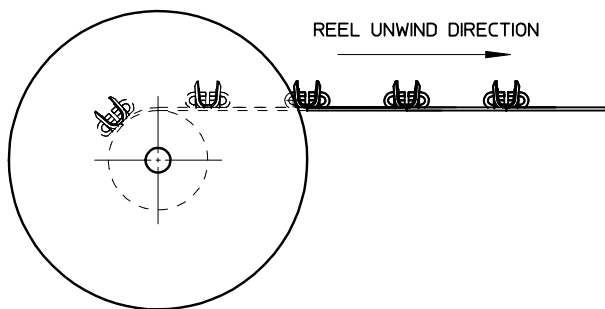
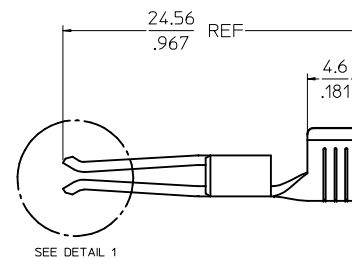
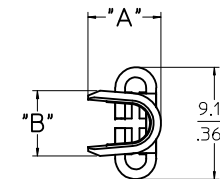
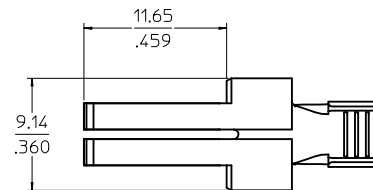
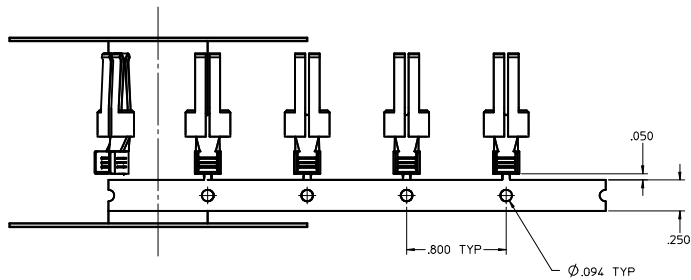

DETAIL 1  
SCALE 10:1

|   |  |  |  |  |  |  |   |  |
|---|--|--|--|--|--|--|---|--|
| <b>SEE SHEET 1</b><br>IEC NO: UCP2009-1020<br>DRAWN DATA 2008/11/04<br>CHKD: 2008/11/04<br>APPR: APATEL 2008/11/04<br>REV DESCRIPTION | QUALITY SYMBOLS<br>▽=0<br>▽=0<br>▽=0                 |  | GENERAL TOLERANCES (UNLESS SPECIFIED)<br>mm INCH<br>4 PLACES ± --- ± ---<br>3 PLACES ± --- ± .010<br>2 PLACES ± 0.25 ± .010<br>1 PLACE ± 0.25 ± ---<br>ANGULAR ±1/2° |  | DIMENSION STYLE<br>MM/IN<br>DRAWN BY BKOSTIC DATE 2006/11/13<br>CHECKED BY DATE 2006/11/13<br>APPROVED BY APATEL DATE 2006/11/14 |  | SCALE 5:1<br>DESIGN UNITS INCH<br>THIRD ANGLE PROJECTION  |  |
|   | DRAFT WHERE APPLICABLE MUST REMAIN WITHIN DIMENSIONS |  |  |  | MATERIAL NO. SEE CHART<br>SIZE D   |  | TITLE<br>TERMINAL - RECEPTACLE POWER CONTACT  |  |
|   | MOLEX INCORPORATED                                   |  |  |  |  |  | SHEET NO. 2 OF 2  |  |
|   | DOCUMENT NO. SD-44262-100                            |  |  |  |  |  | THIS DRAWING CONTAINS INFORMATION THAT IS PROPRIETARY TO MOLEX INCORPORATED AND SHOULD NOT BE USED WITHOUT WRITTEN PERMISSION |  |

19 18 17 16 15 14 13 12 11 10 9 8 7 6 5 4 3 2 1