

Model(型號): **ROTARY POTENTIOMETER-----R10N11D01**

► Download PDF file



Features:(特點):

Small size
high dependability
resistance up to 15gf:cm

Applications(作用):

Remote control circuit

Dimensions(規格圖):

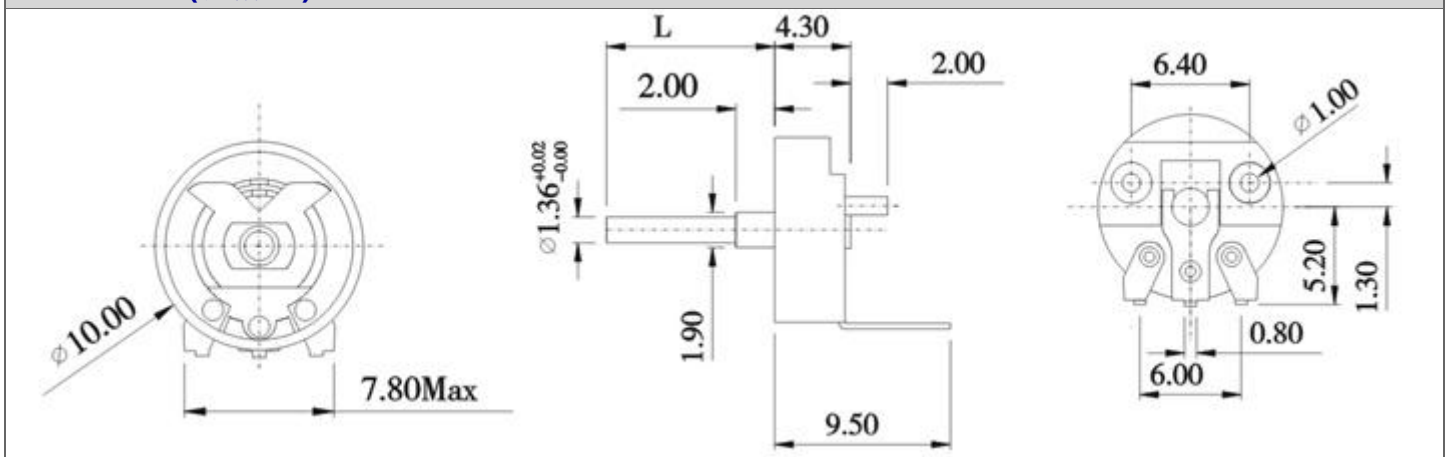

Specifications(規格)

Electrical Characteristics [電氣性能]

| | |
|--------------------------------------|--|
| Total resistance [全阻抗值] | 100Ω - 1MΩ |
| Total resistance tolerance [全阻抗值容許差] | ±20% |
| Ratings power(w) [額定功率] | Linear Taper B : 0.07W , Other Tarpers :0.03W . |
| Resistance taper [阻抗變化特性] | A,B, *C,D,W |
| Residual resistance [殘留阻值] | 20Ω Max |
| Sliding noise [滑動雜音] | 100mV Max. |
| Gang error [連動誤差] | R ≤ 1KΩ,30dB~0dB ±3dB Max ; R>1KΩ,40dB~0dB ±3dB Max . |
| Insulation resistance [絕緣阻抗] | 100MΩ Min. at DC 100V. |
| Withstanding voltage [耐電壓] | 1 minute at AC 250V |
| Max. operating voltage [最高使用電壓] | Linear Taper B : AC100V , Other Tarpers : AC70V . |

Mechanical Characteristics [機械性能]

| | |
|----------------------------------|----------------------|
| Operation torque [回轉力矩] | 10~40gf . cm |
| Rotation stopper strength [止動強度] | 0.6Kgf . cm Min. |
| Total rotational angle [回轉角度] | 200 ±10° |
| Knob push-pull strength [推拉強度] | Push 1.0kgf. cm Max. |

Endurance Characteristics [耐久性能]

| | |
|------------------------|------------------------|
| Rotational life [回轉壽命] | More than10,000 cycles |
|------------------------|------------------------|