

DASH NO. M CODE MADE FROM

REVISIONS

| ISSUE | CHANGES                                |
|-------|--|
| 1     | CN 29221 C<br>REDRAWN<br>EAJ 10 SEP 87 |

879-2-1

GSD

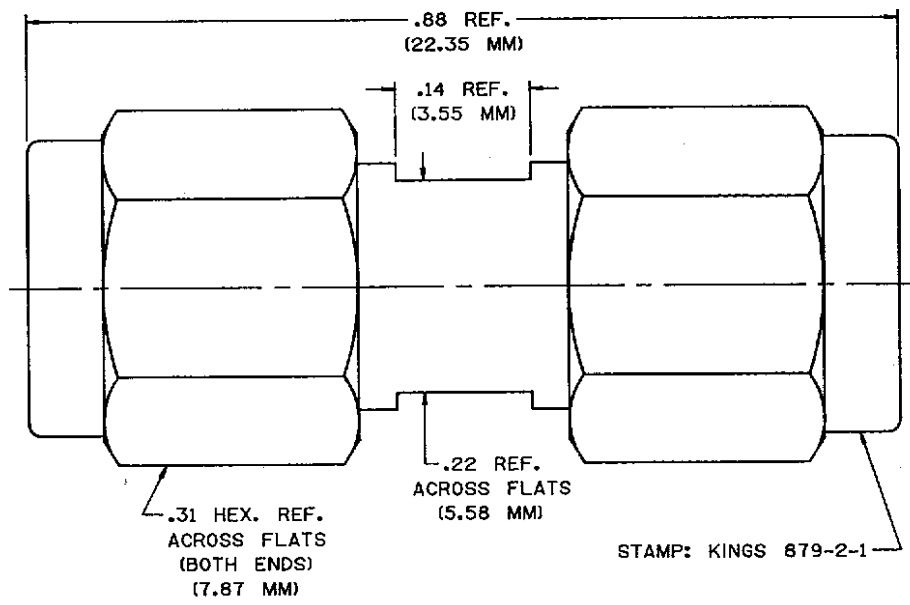

NOTES:

- MATERIALS:  
INSULATOR: TEFLON, L-P-403  
GASKET: SILICONE RUBBER, ZZ-R-765  
CENTER CONTACT: BRASS, QQ-B-626  
C-RING: BERYLLIUM COPPER, QQ-C-530  
ALL OTHER METAL PARTS:  
STAINLESS STEEL, 303
- FINISHES:  
CENTER CONTACT } GOLD PLATE PER  
BODY } MIL-G-45204  
COUPLING NUT }
- ELECTRICAL CHARACTERISTICS:  
NOMINAL IMPEDANCE: 50 OHMS  
FREQUENCY RANGE: 0 TO 12.4 GHZ  
DIELECTRIC WITHSTANDING VOLTAGE:  
1000 VOLTS RMS 60 HZ AT SEA LEVEL

SCALE: 8:1

APPROX. SURFACE AREA

USED ON:

REF:

DISC NO. FA35 FILE NO. FA0235.SD

SMA ADAPTER (M-M)

DRAWN EAJ DATE 10SEP87

APPR. GA DATE 16SEP87

APPR. W DATE 9/21/87

**KINGS**  
ELECTRONICS CO., INC.  
TUCKAHOE, NEW YORK 10701

GSD

879-2-1

UNLESS OTHERWISE SPECIFIED:  
1. TOLERANCES: FRACTIONS ± 2 PLACE DECIMALS ± .010  
3 PLACE DECIMALS ± .004 ANGLES ± 0°30'  
T.I.R. CONCENTRICITY OF ANY 2 DIAMETERS MAY NOT EXCEED HALF THE SUM OF THEIR TOLERANCES.

2. REMOVE ALL BURRS, BREAK ALL SHARP EDGES .005 MAX.  
3. NO FILLETS PERMITTED.  
4. SURFACE ROUGHNESS 83 MICROINCHES RMS MAX.  
6. ALL DIMENSIONS PRIOR TO PLATING  
6. ALL PLATING IN ACCORDANCE WITH KER 10004