



- 16 Pin SMD Line Interface Filter Module
- Cw/w: 30pF Max 100KHz, 0.1V
- LL: 0.10μH Max @ 100KHz, 0.1V
- Primary Pins: 9-11, 1-3
- Operating Temp: -40°C to +85°C
- Telecom, WAN Applications



Electrical Specifications @ 25°C

Part Number	OCL(mH Min) @ 10KHz, 0.1V	Turns Ratio chip: cable (±5%)	DCR (Max)	Isolation HI-POT (Vrms)
	With 8mA DC Bias			
ATSC-1603I	1.00	(1-3):(16-14)=1CT:2.4CT (6-8):(11-9)=1CT:1CT	1.4 Ω	1500

All specifications subject to change without notice.

MECHANICAL

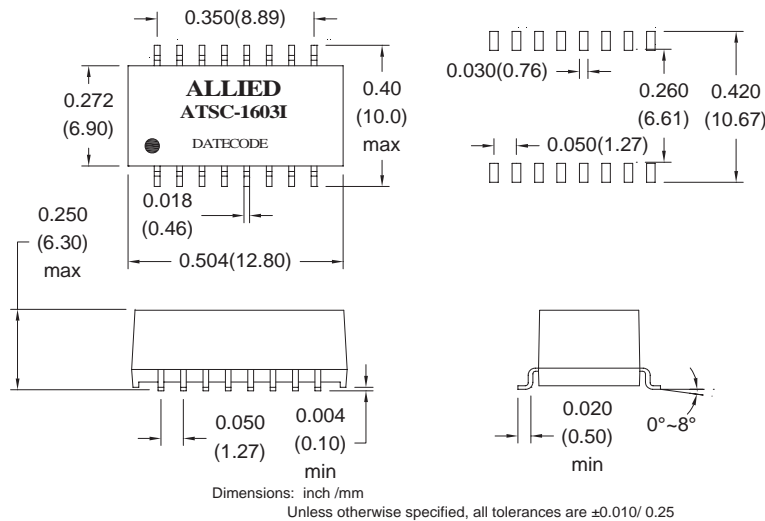

SCHEMATICS

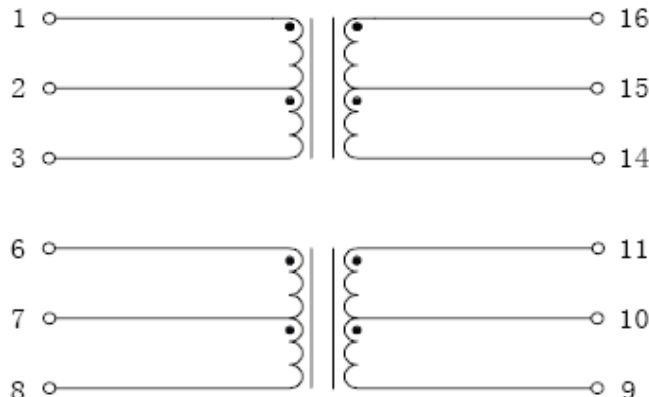



Packaging Specifications

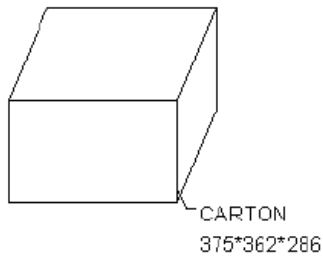
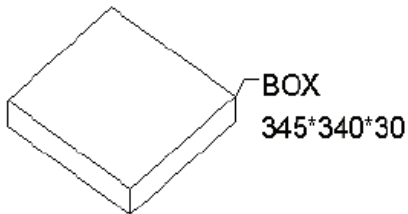
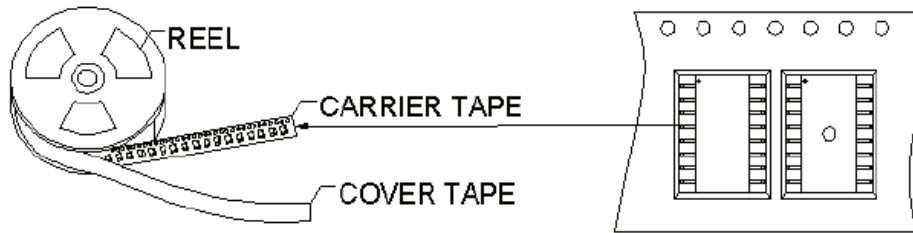

0.6g/pcs	750pcs/Reel
3.6kg	750pcs/Box
6.9kg	6000pcs/CARTON

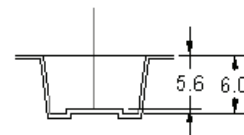
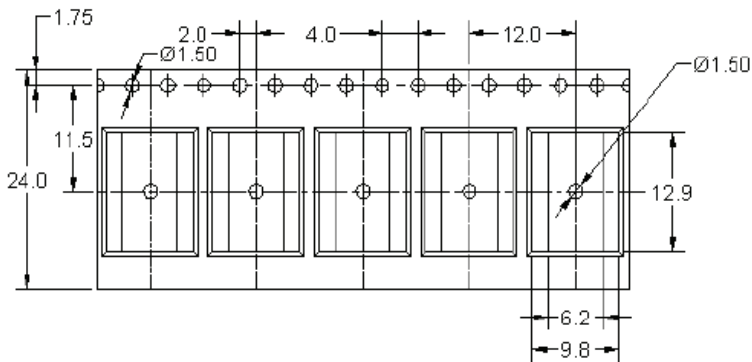

unit:mm