

| | | |
|----------|--------|-----------|
| DASH NO. | M CODE | MADE FROM |
|----------|--------|-----------|

GSD

M39012/29-0503

REVISIONS

| ISSUE | CHANGES | |
|-------|---------|---------------------|
| 8 | CN LNM | 32302 A 06/20/90 |

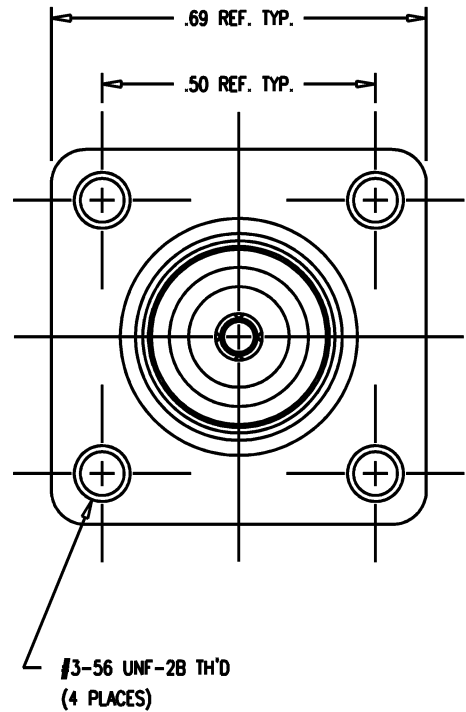
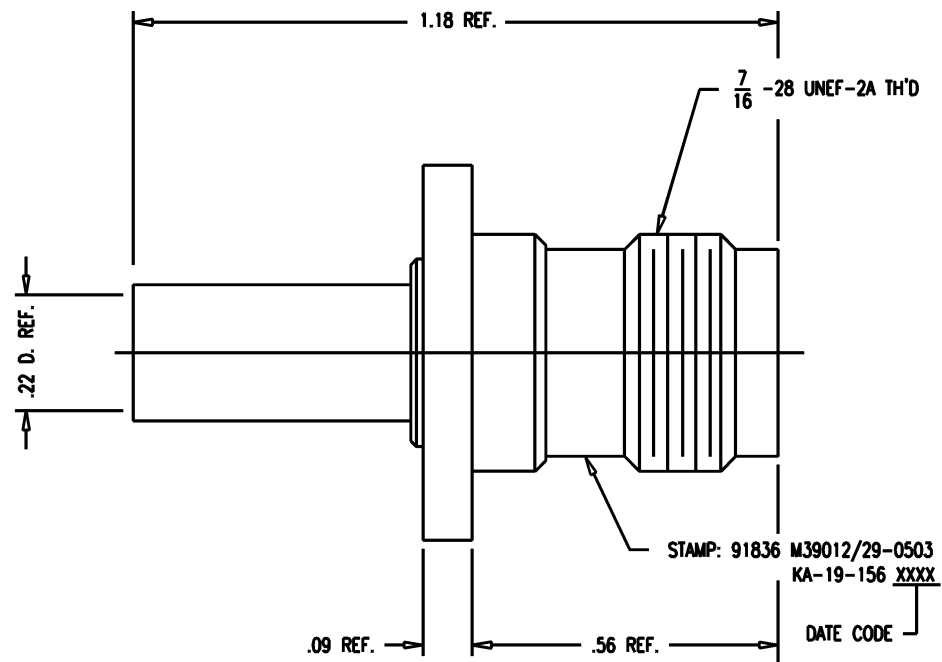

- NOTES:**
- FOR USE WITH RG-142, 223 & 400/U CABLE.
 - FOR CABLING INSTRUCTIONS SEE CP-465.
 - FOR CABLE TRIMMING USE KTJ-113 & KTD-166.
 - FOR CRIMPING USE DIE KTH-2001.
 - INTERFACE PER MIL-STD-348, FIG. 313-2.
 - CENTER CONTACT TO BE SUPPLIED UNASSEMBLED.
 - MATERIALS:
INSULATOR: TEFLON, ASTM-D-1457
CENTER CONTACT: BER. COPPER, ASTM-B-196
ALL OTHER METAL PARTS: BRASS, QQ-B-626
 - FINISHES:
CENTER CONTACT: HARD GOLD PLATE PER MIL-G-45204
ALL OTHER METAL PARTS: SILVER PLATE PER QQ-S-365
 - ELECTRICAL CHARACTERISTICS:
NOMINAL IMPEDANCE: 50 OHMS
WORKING VOLTAGE: 500 VRMS
FREQUENCY RANGE: DC TO 11 GHz.

| | |
|---|---------------|
| SCALE 4:1 | |
| APPROX SURFACE AREA | |
| KA-19-156 | |
| USED ON | |
| REF: | |
| JACK, PANEL, TNC | |
| DRAWN KH | DATE 01/21/94 |
| DESIGN MJB | DATE 01/21/94 |
| APPR. | DATE |
| KINGS ELECTRONICS CO., INC. TUCKAHOE, NEW YORK 10707 | |
| M39012/29-0503 | |

KAM3424

GSD