

LPA 2/2...24

45°

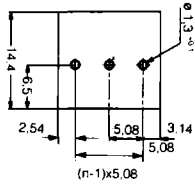
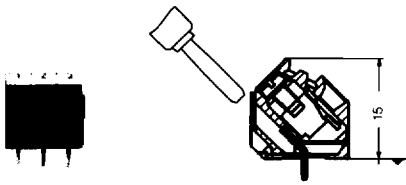

Pitch 5.08 mm

LPA TOP 1/2...3

90°

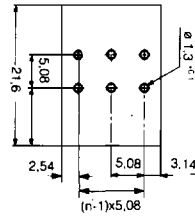
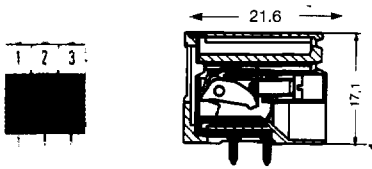

Pitch 5.08 mm

LPK 1M/3...16

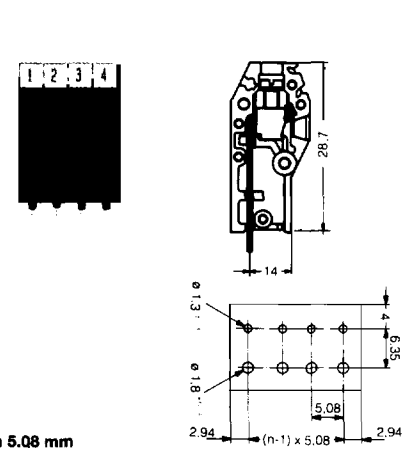

Pitch 5.08 mm

Poles	Type	Cat. No.
2	LPA 2/5.08/2 OG	150626
3	LPA 2/5.08/3 OG	150646
4	LPA 2/5.08/4 OG	157216
5	LPA 2/5.08/5 OG	157217
6	LPA 2/5.08/6 OG	157218
7	LPA 2/5.08/7 OG	157219
8	LPA 2/5.08/8 OG	157220
9	LPA 2/5.08/9 OG	156926
10	LPA 2/5.08/10 OG	157221
11	LPA 2/5.08/11 OG	157828
12	LPA 2/5.08/12 OG	157222
13	LPA 2/5.08/13 OG	157829
14	LPA 2/5.08/14 OG	157830
15	LPA 2/5.08/15 OG	157831
16	LPA 2/5.08/16 OG	156927
17	LPA 2/5.08/17 OG	157832
18	LPA 2/5.08/18 OG	156928
19	LPA 2/5.08/19 OG	157833
20	LPA 2/5.08/20 OG	156929
21	LPA 2/5.08/21 OG	156930
22	LPA 2/5.08/22 OG	157834
23	LPA 2/5.08/23 OG	156931
24	LPA 2/5.08/24 OG	157835

Poles	Type	Cat. No.
2	LPA TOP 1/90/2 OG	153546
3	LPA TOP 1/90/3 OG	153556

Poles	Type	Cat. No.
3	LPK 1M3 OG	160808
4	LPK 1M4 OG	160809
10	LPK 1M10 OG	160810
16	LPK 1M16 OG	160811

LPA TOP 1/2...3

180°

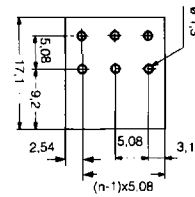
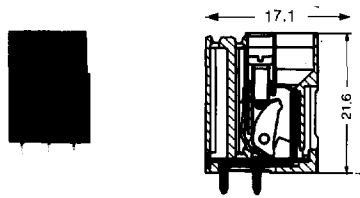

Pitch 5.08 mm

Poles	Type	Cat. No.
2	LPA TOP 1/180/2 OG	153506
3	LPA TOP 1/180/3 OG	153516

Notes: Standard pin length is 4.50 mm. Other pin lengths are available on request.
See pages 6/21-24 for marking materials and other accessories.