

Features

- 8 contact chambers taking the Han-E® power contacts
- Space-saving and compact design
- Leading protective ground
- Crimp terminal with standard Han-E® contacts
- Use of standard tools
- Insert is suitable for the hoods and housings of the series Han Q 8/0®
- The contacts can be removed with the aid of a removal tool from the termination side
- DESINA** conform product 

Current carrying capacity

The current carrying capacity is limited by maximum temperature of materials for inserts and contacts including terminals. The current capacity-curve is valid for continuous, not interrupted current-loaded contacts of connectors when simultaneous power on all contacts is given, without exceeding the maximum temperature.

Control and test procedures according to DIN IEC 60 512-3.

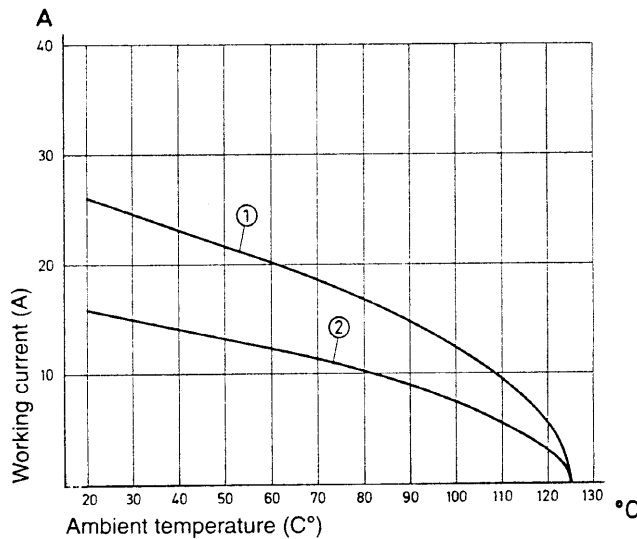

Control and test procedures according to DIN IEC 512-3

Wire gauge: ① 2.5 mm²

② 1.5 mm²

Technical characteristics

Specifications

DIN VDE 0627
DIN VDE 0110

Inserts

Number of contacts	8 + PE
Working current	16 A
Working voltage	500 V
Test voltage	3 kV
Pollution degree	3 (C)
Material	Polycarbonate
Insulation resistance	≥ 10 ¹⁰ Ω
Temperature range	- 40 °C ... + 125 °C
Flammability acc. to UL 94	V 0
Mechanical working life - mating cycles	> 500

Contacts

Material	Copper alloy
Surface	3 µm Ag - hard-silver plated 2 µm Au over 3 µm Ni - hard-gold plated
Contact resistance	< 1 mΩ
Crimp terminal	0.5 - 2.5 mm ² partly loaded up to 4 mm ² is possible
- mm ²	20 - 14
- AWG	

Hoods / Housings

Material	Polycarbonate
Colour	RAL 9005
Sealing	NBR
Temperature range	- 40 °C ... + 125 °C
Flammability acc. to UL 94	V 0
Material of locking lever	Polyamide
Degree of protection acc. to DIN 40 050 in locked position	IP 65
Cable gland (order separately)	Pg 16

Accessories

Crimping tools

chapter 12

Han® Q 8/0



Number of contacts

8 +

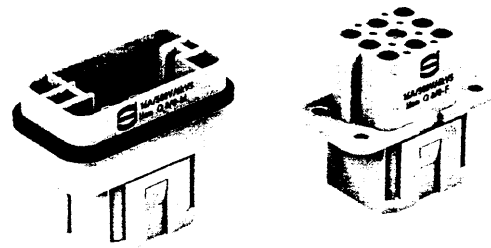

Inserts

Identification	Part No.		Drawing	Dimensions in mm
	Male insert (M)	Female insert (F)		
Crimp terminal Order crimp contacts separately				

09 12 003 3001

09 12 008 3101

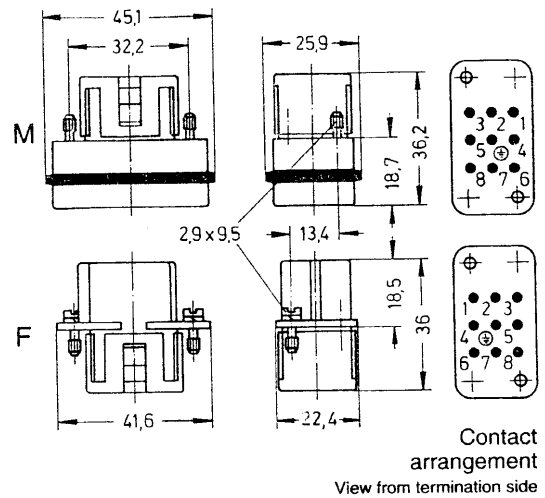

Identification	Wire gauge (mm ²)	Part No.		Drawing	Dimensions in mm
		Male contacts	Female contacts		
Crimp contacts	0.5	09 33 000 6121	09 33 000 6220		
Power contacts	0.75	09 33 000 6114	09 33 000 6214		
silver plated	1.0	09 33 000 6105	09 33 000 6205		
	1.5	09 33 000 6104	09 33 000 6204		
	2.5	09 33 000 6102	09 33 000 6202		
	4.0	09 33 000 6107	09 33 000 6207		
gold plated	0.5	09 33 000 6122	09 33 000 6222		
	0.75	09 33 000 6115	09 33 000 6215		
	1.0	09 33 000 6118	09 33 000 6218		
	1.5	09 33 000 6116	09 33 000 6216		
	2.5	09 33 000 6123	09 33 000 6223		
Relay contact silver plated	4.0	09 33 000 6119	09 33 000 6221		
	0.75-1	09 33 000 6109			
	1.5	09 33 000 6110			
	2.5	09 33 000 6111			

Crimp contact identification

Identification	Wire gauge		Stripping length
	mm ²	AWG	
no groove	0.5 mm ²	AWG 20	7.5 mm
1 groove*	0.75 mm ²	AWG 18	7.5 mm
1 groove	1 mm ²	AWG 18	7.5 mm
2 grooves	1.5 mm ²	AWG 16	7.5 mm
3 grooves	2.5 mm ²	AWG 14	7.5 mm
no groove	4.0 mm ²	AWG 12	7.5 mm

* on the back crimp collar

Han Drive

Stock items in bold type

Identification Part No. Pg Drawing Dimensions in mm

Housing

Cable gland
order separately



09 12 008 0527

16

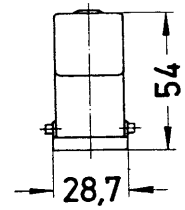
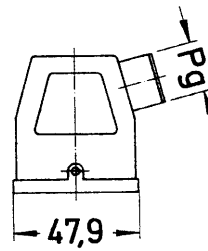

Hood

Cable sealing

Thrust bolt
and insert

09 00 000 5059

16

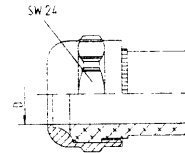

Colour	SW	Cable	
		min.	max.
white	24	11.5	15.5

Identification

Part No.

Drawing

Dimensions in mm

Man
Drive

Housing
bulkhead mounting



09 12 008 0327

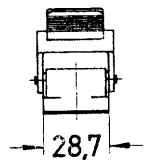
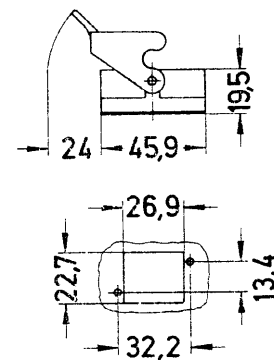

Housing

Protection covers



for
male insert
without sealing

09 12 008 5407

for
female insert
with sealing

09 12 008 5408

