

REVISION RECORD				
REV	ECD	DESCRIPTION	DRFT	CHKD
△		增加插孔	SYZ	
△		增加插孔	WLD	

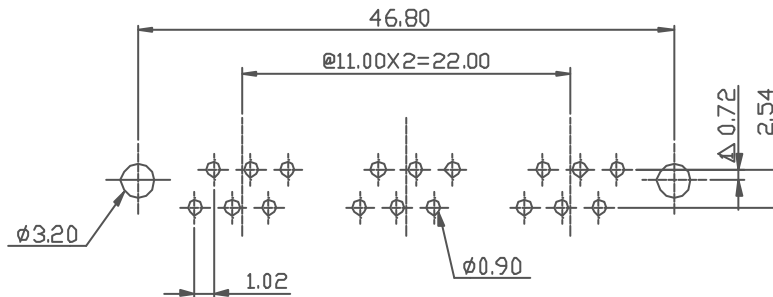
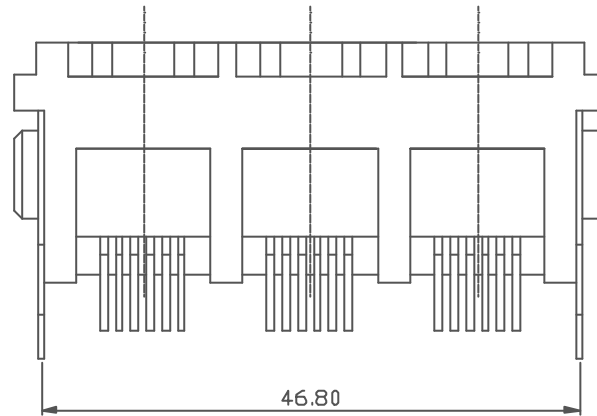
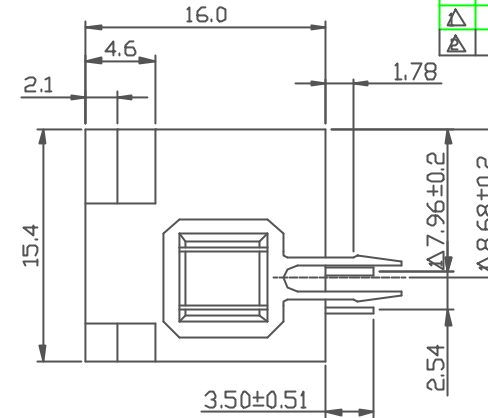
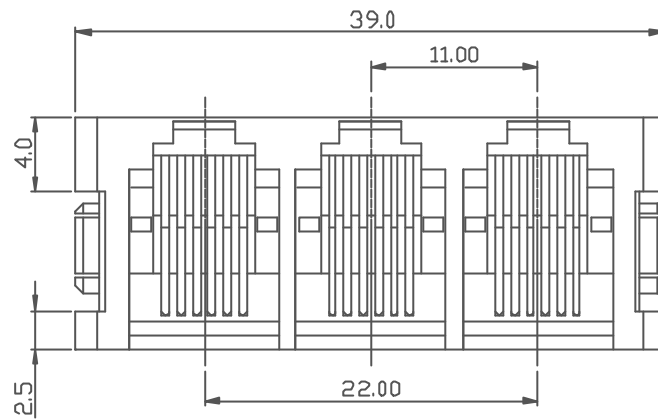

NOTES:

ELECTRICAL:

- VOLTAGE RATING : 125 VAC RMS,
- CURRENT RATING : 1.5 AMP,
- CONTACT RESISTANCE: 30 MINIOHMS MAX.
- INSULATION RESISTANCE: 500 MEGOHMS MIN @ 500 VDC.
- DIELECTRIC STRENGTH 1000 VAC RMS 60HZ, 1MIN.

MECHANICAL:

- HOUSING MATERIAL : GLASS FILLED POLYESTER UL94V-0.
- CONTACT MATERIAL : PHOSPHOR BRONZE φ0.46mm.
- PLATING : GOLD PLATING OVER NICKEL.
- OPERATING LIFE : 250 CYCLES MIN.
- PCB RETENTION PRE-SOLDER: 1 LB MIN.
- PCB RETENTION POST-SOLDER: 10 LBS MIN.

ENVIRONMENTAL:

- STORAGE: -40°C TO +85°C.
- OPERATION: 0°C TO 70°C.

MATES WITH MODULAR PLUG CONFORMING TO FCC PART 68, SUBPART F.

CUL FILE NO. E163191

△PART NUMBER: E5H6X-20BX1X

NO. OF CONTACT	1-3u"	2-6u"
2-2 CONTACTS	3-15u"	4-30u"
4-4 CONTACTS	5-50u"	6-Pd 20u"
6-6 CONTACTS		

- 1-Black
- 2-Gray

PC Board Layout Component Side Shown

ATTACHED LISTS	IN (CINCH)	DR TO SYZ	DATE 3/7/99	MAXTOP <NINGBO> TELECOM ELECTRONIC CO., LTD
	TOLERANCES EXCEPT AS NOTED	CHKD YJK	DATE 4/25/99	
	MH	MFD WLD	DATE 4/25/99	
	APPVLS STEVEN	DATE 4/23/99		
0 ± 0.2	++	MATERIAL :	TITLE	TOP ENTRY METAL FOOT PCB JACK
0.0 ± 0.05	++	QTY :	DRAWING NO. GESH3002	SIZE A3
0.01 ± 0.075	++	FINISH:	/PART NO. SEE NOTE	REV 4/25/99
ANGLES ± 0.5		SCALE : 3:1	DO NOT SALE DRAWING	SHEET OF