

RDM: Solder / Solder, Semi-Rigid Cable

Straight Receptacle

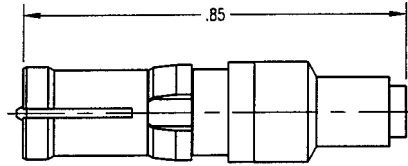

Part Number	Cable
201-510-0470G	.047 SR
201-510-0850G	.085 SR
201-510-1410G	.141 SR

- See page 81 for cable assembly procedures: CAP 5-09
- Part number shown is for standard gold plating.
- For military finish change suffix to "H".
- For commercial finish change suffix to "C".

Straight Plug

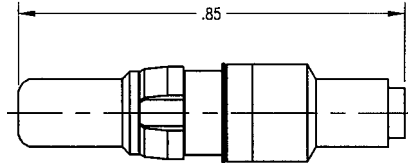

Part Number	Cable
200-510-0470G	.047 SR
200-510-0850G	.085 SR
200-510-1410G	.141 SR

- See page 81 for cable assembly procedures: CAP 5-09
- Part number shown is for standard gold plating.
- For military finish change suffix to "H".
- For commercial finish change suffix to "C".

Right Angle Receptacle

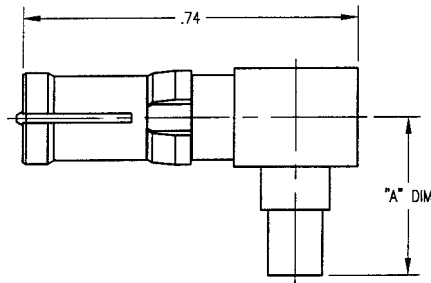

Part Number	Cable	"A" DIM
203-510-0470G	.047 SR	.29
203-510-0850G	.085 SR	.35
203-510-1410G	.141 SR	.35

- See page 82 for cable assembly procedures: CAP 5-10
- Part number shown is for standard gold plating.
- For military finish change suffix to "H".
- For commercial finish change suffix to "C".

Right Angle Plug

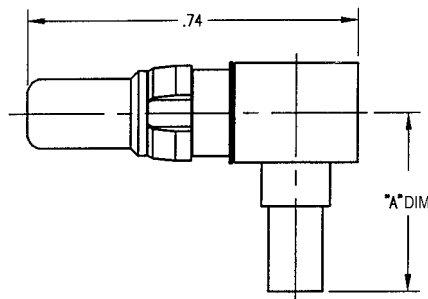

Part Number	Cable	"A" DIM
202-510-0470G	.047 SR	.29
202-510-0850G	.085 SR	.35
202-510-1410G	.141 SR	.35

- See page 82 for cable assembly procedures: CAP 5-10
- Part number shown is for standard gold plating.
- For military finish change suffix to "H".
- For commercial finish change suffix to "C".

RDM: Solder / Solder, Flexible Cable

Straight Receptacle

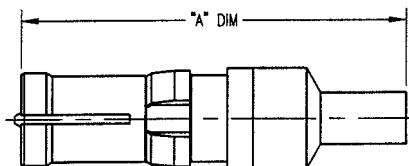

Part Number	Cable	"A" DIM
201-510-0360G	RG- 178, 196	.93
201-510-0630G	RG- 316, 188	.93
201-510-1070G	RG- 180, 195	1.03
201-510-1160G	RG- 141, 58	1.03
201-510-1161G	RG- 142, 223	1.03

- See page 79 for cable assembly procedures: CAP 5-07
- Part number shown is for standard gold plating.
- For military finish change suffix to "H".
- For commercial finish change suffix to "C".

Dimensions shown are in inches.

Winchester Electronics

RDM: Solder / Solder, Flexible Cable

Straight Plug

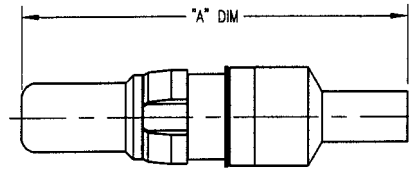

Part Number	Cable	"A" DIM
200-510-0360G	RG- 178, 196	.93
200-510-0630G	RG- 316, 188	.93
200-510-1070G	RG- 180, 195	1.03
200-510-1160G	RG- 141, 58	1.03
200-510-1161G	RG- 142, 223	1.03

- See page 79 for cable assembly procedures: CAP 5-07
- Part number shown is for standard gold plating.
- For military finish change suffix to "H".
- For commercial finish change suffix to "C".

Right Angle Receptacle

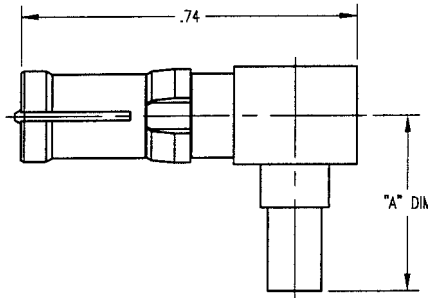

Part Number	Cable	"A" DIM
203-510-0360G	RG- 178, 196	.49
203-510-0630G	RG- 316, 188	.49
203-510-1070G	RG- 180, 195	.49
203-510-1160G	RG- 141, 58	.49
203-510-1161G	RG- 142, 223	.49

- See page 80 for cable assembly procedures: CAP 5-08
- Part number shown is for standard gold plating.
- For military finish change suffix to "H".
- For commercial finish change suffix to "C".

Right Angle Plug

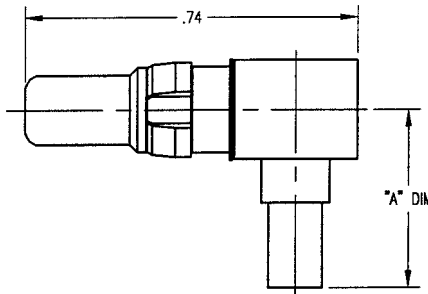

Part Number	Cable	"A" DIM
202-510-0360G	RG- 178, 196	.49
202-510-0630G	RG- 316, 188	.49
202-510-1070G	RG- 180, 195	.60
202-510-1160G	RG- 141, 58	.60
202-510-1161G	RG- 142, 223	.60

- See page 80 for cable assembly procedures: CAP 5-08
- Part number shown is for standard gold plating.
- For military finish change suffix to "H".
- For commercial finish change suffix to "C".

RDM: Solder / Crimp, Flexible Cable

Straight Receptacle

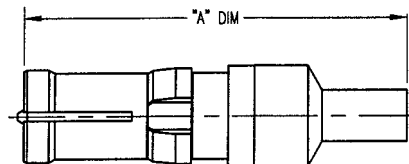

Part Number	Cable	"A" DIM
201-910-0360G	RG- 178, 196	.93
201-910-0630G	RG- 316, 188	.93
201-910-1070G	RG- 180, 195	1.03
201-910-1160G	RG- 141, 58	1.03
201-910-1161G	RG- 142, 223	1.03

- See page 85 for cable assembly procedures: CAP 9-01
- Part number shown is for standard gold plating.
- For military finish change suffix to "H".
- For commercial finish change suffix to "C".

Dimensions shown are in inches.

RDM: Solder / Crimp, Flexible Cable

Straight Plug

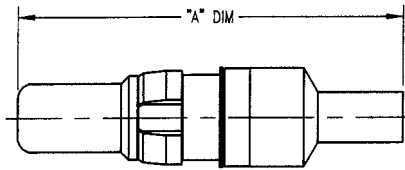

Part Number	Cable	"A" DIM
200-910-0360G	RG- 178, 196	.93
200-910-0630G	RG- 316, 188	.93
200-910-1070G	RG- 180, 195	1.03
200-910-1160G	RG- 141, 58	1.03
200-910-1161G	RG- 142, 223	1.03

- See page 85 for cable assembly procedures: CAP 9-01
- Part number shown is for standard gold plating.
- For military finish change suffix to "H".
- For commercial finish change suffix to "C".

Right Angle Receptacle

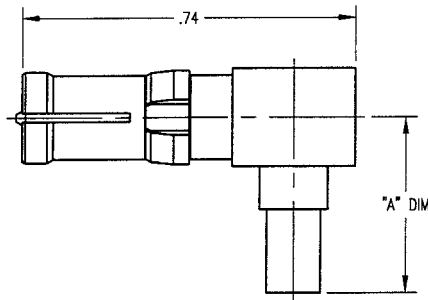

Part Number	Cable	"A" DIM
203-910-0360G	RG- 178, 196	.49
203-910-0630G	RG- 316, 188	.49
203-910-1070G	RG- 180, 195	.60
203-910-1160G	RG- 141, 58	.60
203-910-1161G	RG- 142, 223	.60

- See page 86 for cable assembly procedures: CAP 9-02
- Part number shown is for standard gold plating.
- For military finish change suffix to "H".
- For commercial finish change suffix to "C".

Right Angle Plug

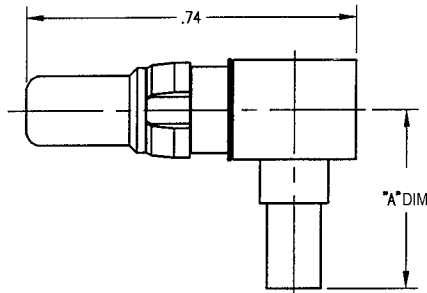

Part Number	Cable	"A" DIM
202-910-0360G	RG- 178, 196	.49
202-910-0630G	RG- 316, 188	.49
202-910-1070G	RG- 180, 195	.60
202-910-1160G	RG- 141, 58	.60
202-910-1161G	RG- 142, 223	.60

- See page 86 for cable assembly procedures: CAP 9-02
- Part number shown is for standard gold plating.
- For military finish change suffix to "H".
- For commercial finish change suffix to "C".

RDM: Crimp / Crimp, Flexible Cable

Straight Receptacle

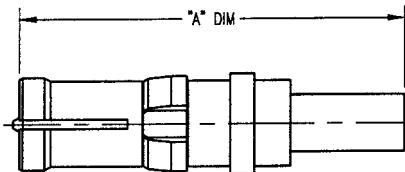

Part Number	Cable	"A" DIM
261-910-0630G	RG- 316, 188	.84
261-910-1070G	RG- 180, 195	1.00
261-910-1160G	RG- 141, 58	1.00
261-910-1161G	RG- 142, 223	1.00

- See page 87 for cable assembly procedures: CAP 9-07
- Part number shown is for standard gold plating.
- For military finish change suffix to "H".
- For commercial finish change suffix to "C".

Straight Plug

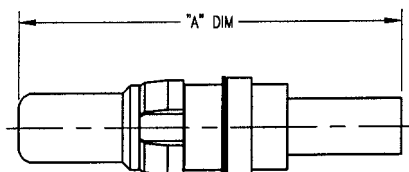

Part Number	Cable	"A" DIM
260-910-0630G	RG- 316, 188	.86
260-910-1070G	RG- 180, 195	1.01
260-910-1160G	RG- 141, 58	1.01
260-910-1161G	RG- 142, 223	1.01

- See page 87 for cable assembly procedures: CAP 9-07
- Part number shown is for standard gold plating.
- For military finish change suffix to "H".
- For commercial finish change suffix to "C".

Dimensions shown are in inches.

RDM: Printed Circuit Board Contacts

Straight Receptacle

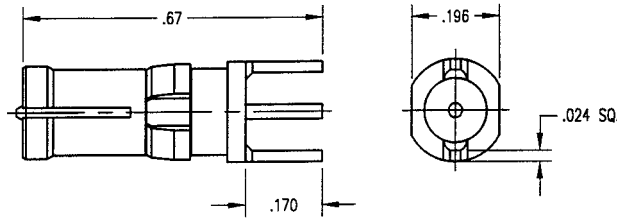

Part Number	Mounting Hole
201-010-6140G	NO. 061

- See page 78 for mounting hole layout.
- Part number shown is for standard gold plating.
- For military finish change suffix to "H".
- For commercial finish change suffix to "C".

Straight Plug

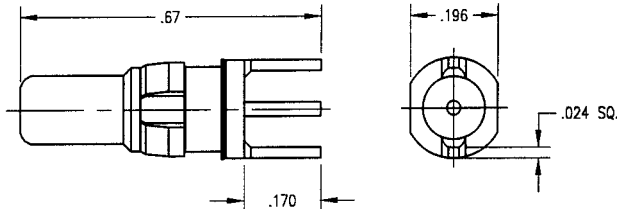

Part Number	Mounting Hole
200-010-6140G	NO. 061

- See page 78 for mounting hole layout.
- Part number shown is for standard gold plating.
- For military finish change suffix to "H".
- For commercial finish change suffix to "C".

Right Angle Receptacle

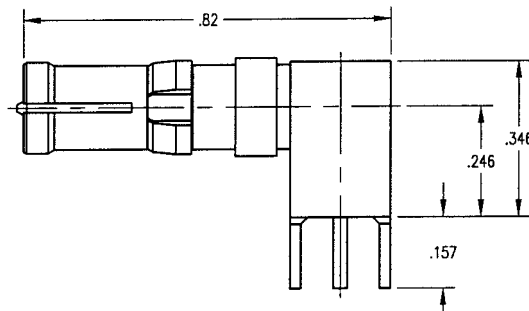

Part Number	Mounting Hole
203-010-6140G	NO. 061

- See page 78 for mounting hole layout.
- Part number shown is for standard gold plating.
- For military finish change suffix to "H".
- For commercial finish change suffix to "C".

Right Angle Plug

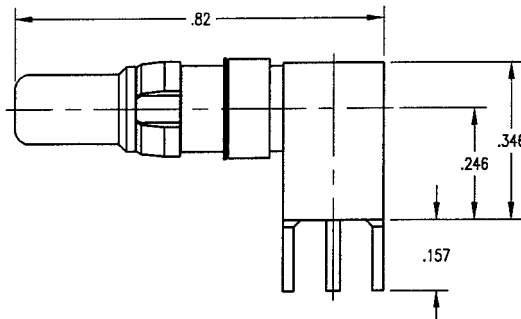

Part Number	Mounting Hole
202-010-6140G	NO. 061

- See page 78 for mounting hole layout.
- Part number shown is for standard gold plating.
- For military finish change suffix to "H".
- For commercial finish change suffix to "C".

RDM: Same - Series Adapters

Receptacle / Receptacle

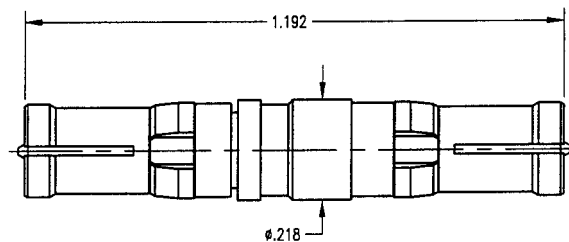

Part Number
201-201-0000G

- Part number shown is for standard gold plating.
- For military finish change suffix to "H".
- For commercial finish change suffix to "C".

Dimensions shown are in inches.

RDM: Same - Series Adapters

Plug / Plug

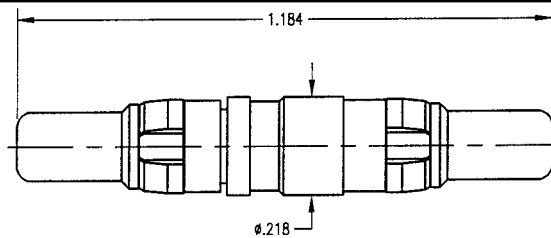

Part Number
200-200-0000G

- Part number shown is for standard gold plating.
- For military finish change suffix to "H".
- For commercial finish change suffix to "C".

Plug / Receptacle

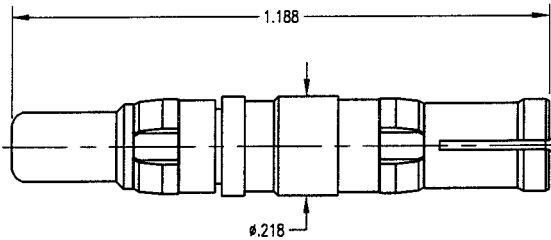

Part Number
200-201-0000G

- Part number shown is for standard gold plating.
- For military finish change suffix to "H".
- For commercial finish change suffix to "C".

RDM: Between Series Adapters

RDM Plug / SMA Plug

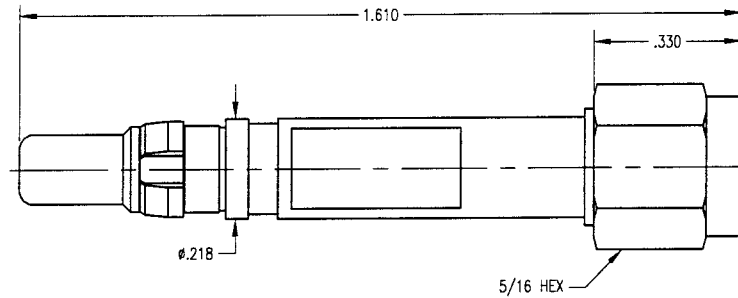

Part Number
200-350-0000H

- Part number shown is for gold plating.
- For nickel plate change suffix to "N"

RDM Receptacle SMA Jack

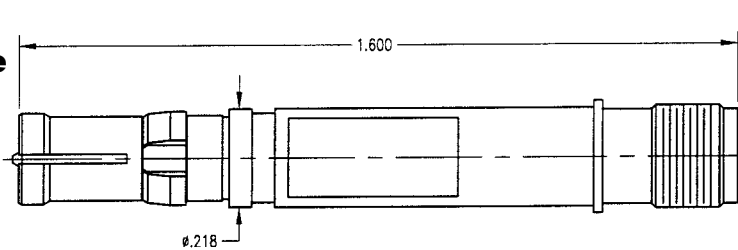

Part Number
200-351-0000H

- Part number shown is for gold plating.
- For nickel plate change suffix to "N"

RDM Receptacle SMA Plug

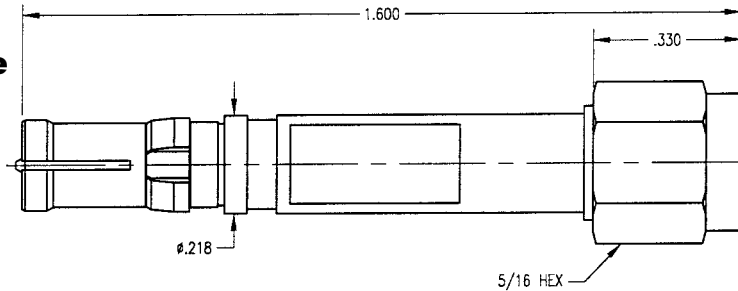

Part Number
201-350-0000H

- Part number shown is for gold plating.
- For nickel plate change suffix to "N"

RDM Plug / SMA Jack

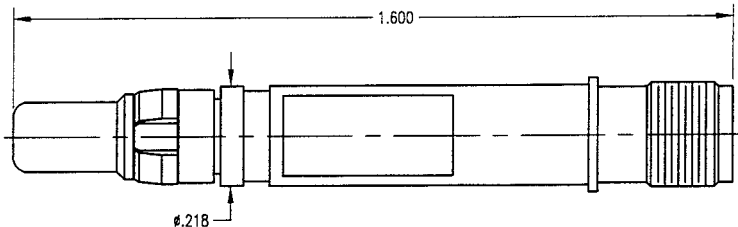

Part Number
200-351-0000H

- Part number shown is for gold plating.
- For nickel plate change suffix to "N"

Dimensions shown are in inches.

Winchester Electronics