

# SMD TYPE CDH Series

## OUTLINE

SMD type power inductors where by the electrode is attached to the ferrite core directly.

### CDH53



( 2.2μH - 220μH )

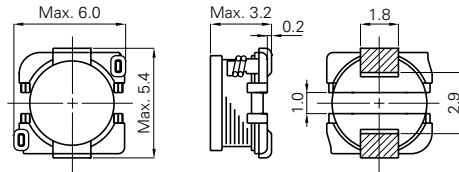
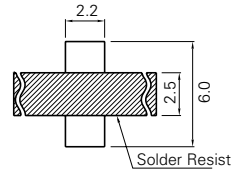

**LAND PATTERNS (mm)**

**CONSTRUCTION**

\* In order to prevent short-circuiting, a solder resist is recommended.

### CDH63

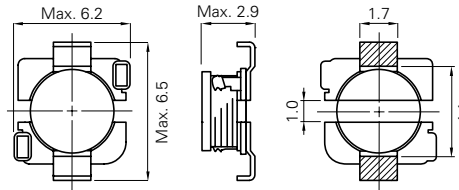
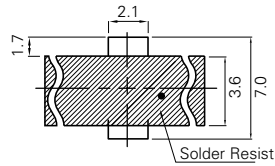

( 1.5μH - 180μH )



**LAND PATTERNS (mm)**

**CONSTRUCTION**

\* In order to prevent short-circuiting, a solder resist is recommended.

### CDH73

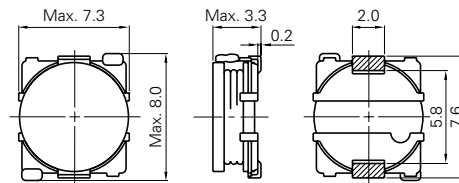
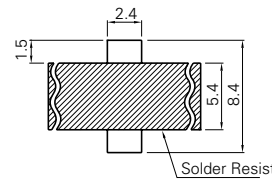

( 10μH - 220μH )

**LAND PATTERNS (mm)**

**CONSTRUCTION**

\* In order to prevent short-circuiting, a solder resist is recommended.



# CDH74



( 10 $\mu$ H - 470 $\mu$ H )

DIMENSIONS (mm)	LAND PATTERNS (mm)	CONSTRUCTION
	<p>* In order to prevent short-circuiting, a solder resist is recommended.</p>	<b>I</b>

# CDH113



( 10 $\mu$ H - 470 $\mu$ H )

DIMENSIONS (mm)	LAND PATTERNS (mm)	CONSTRUCTION
	<p>* In order to prevent short-circuiting, a solder resist is recommended.</p>	<b>I</b>

# CDH115



( 10 $\mu$ H - 470 $\mu$ H )

DIMENSIONS (mm)	LAND PATTERNS (mm)	CONSTRUCTION
	<p>* In order to prevent short-circuiting, a solder resist is recommended.</p>	<b>I</b>

