

# CE02-6A Series

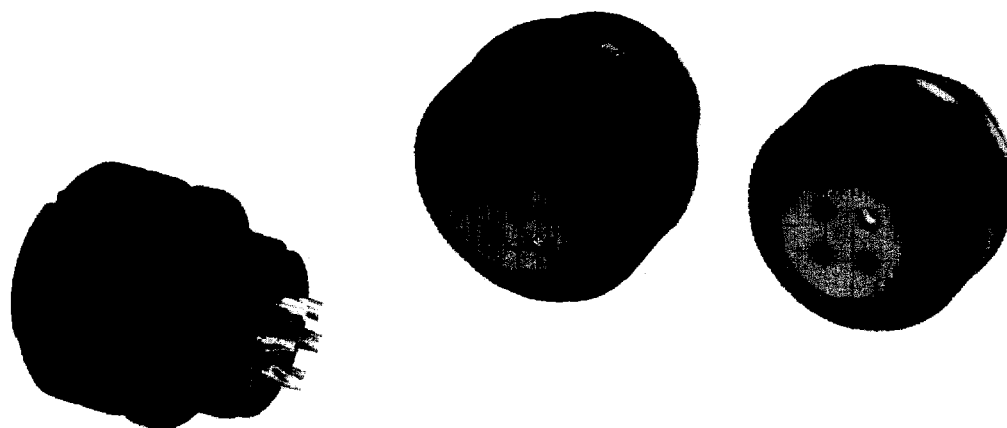

## Moistureproof Plug Type

Conforming to MIL-C-5015 and JIS-B-6015



The CE02 series circular connectors are designed to protect connections to electrical equipment from moisture, oil and surges in current which may damage electronic circuitry. The CE02 series is intermateable with MIL-C-5015 style connectors such as the DMS series available from DDK.

### APPLICATIONS

Factory automation equipment, machines, electrical equipment in industrial outside applications where :

- Electrical connection must be protected against exposure to moisture, oil, or dust.
- The equipment contains electronic circuits which need to be protected by a first-make, last break contact.

### FEATURES

- First-make, last-break contact to prevent damage to electronic circuitry.
- Intermateable with MIL-C-5015 style connectors commonly used on existing factory automation and other electrical equipment.
- Designed to offer protection against moisture and oil. A gasket located between the coupling ring and receptacle shell seals the connection. Available water resistant back shells and cable clamps complete the sealed connection. Plug connector is also designed to accept conduit fittings. When used in this method and mated to DDK's CE02-2A series connectors, the entire connection system from the cable to the inside of the equipment is sealed from moisture, oil, and dust.

# CE02-6A Series



## Material/Finish

Shell .....Aluminum alloy/Zinc plating,  
Olive drab chromate finish  
Coupling ring ...Aluminum alloy/Zinc plating,  
Olive drab chromate finish  
Insert .....Diallyl phthalate/Blue  
Contact .....Copper alloy/Silver plating  
Retaining ring ...Copper alloy/Zinc plating,  
Olive drab chromate finish  
Ground lug .....Copper alloy/Silver plating  
Gasket .....Nitrile butadiene rubber/Black

## Wire Size

Contact Size	Wire Size
#16	AWG#16-#22
#12	AWG#12-#14
#8	AWG#8-#10

## Specification

Current rating	Contact size	#16	#12	#8
	Max. value per contact	13A	23A	46A
Voltage rating	Service rating	A		D
	AC (r.m.s)	500V		900V
	DC	700V		1250V
Withstanding voltage	AC (r.m.s)	2000V		2800V
Insulation resistance	More than 5000MΩ at 500V DC			
Contact resistance	Contact size	#16	#12	#8
	less than            mΩ	6	3	2
	Test current	13A	23A	46A
Operating temperature	-55°C to +125°C			

## Ordering Information

**CE02-6A18-12DSW**

**SERIES**

**SHELL STYLE**

6A : Straight Plug

**SHELL SIZE**

10SL, 18, 20, 22, 24

**INSERT ARRANGEMENT**

See page 26

**ALTERNATE INSERT POSITION**

Omit : Standard position

W,X,Y,Z : Alternate position

**CONTACT STYLE**

S : Socket

**PREMATING CONTACT POSITION**

Refer to insert arrangements

# CE02-6A Series



## Insert Arrangements

Insert No.	10SL-3	18-10	18-12	20-15	20-29
Arrangements					
Contact Size	#16	#12	#16	#12	#16
No. of Contacts	3	4	6	7	17
Grounding Contact Position	C Terminal	D Terminal	D Terminal	D Terminal	N Terminal
Service Rating	A	A	A	A	A
Current Capacity	13A (29.4A)	23A (62.5A)	13A (43.6A)	23A (83.7A)	13A (81.7A)
Insert No.	22-14	22-22	22-23	24-10(D)	24-10(G)
Arrangements					
Contact Size	#16	#8	#12	#8	#8
No. of Contacts	19	4	8	7	7
Grounding Contact Position	N Terminal	D Terminal	D Terminal	D Terminal	G Terminal
Service Rating	A	A	D(H), A (Others)	A	A
Current Capacity	13A (88.9A)	46A (125.1A)	23A (90.1A)	46A (167.4A)	46A (167.4A)

- Note 1) The above figures show the views from solder cup side of CE02-6A plug connectors (socket insert).
- 2) Current capacities show the maximum permitted current values per contact. Values in parenthesis show the total current capacities in each one of respective connectors.

## Alternate Insert Positions

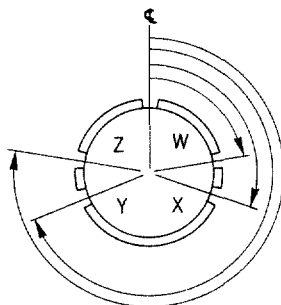

Front View of Socket Insert

Insert No.	Contact size/ Number	W	X	Y	Z
10SL-3	#16/3	—	—	—	—
18-10	#12/4	—	120°	240°	—
18-12	#16/6	80°	—	—	280°
20-15	#12/7	80°	—	—	280°
20-29	#16/17	80°	—	—	280°
22-14	#16/19	80°	—	—	280°
22-22	#8/4	—	110°	250°	—
22-23	#12/8	35°	—	250°	—
24-10	#8/7	80°	—	—	280°

# CE02-6A Series



## Dimensions

Unit : mm (inch)

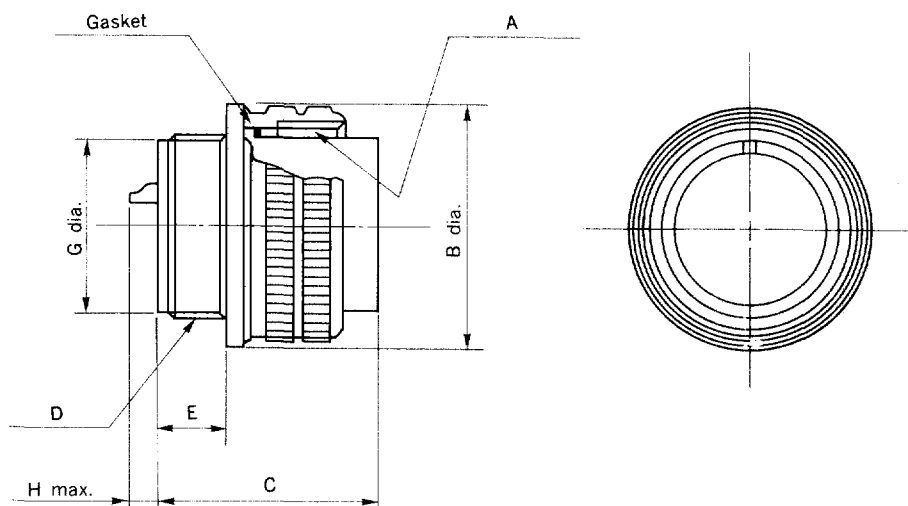

Shell Size	Coupling Threads A	B	C	Rear Threads D	E	G
10SL	5/8-24UNEF	22.22 (.875)	23.30 (.917)	5/16-24UNEF-2A	7.50 (.295)	12.5 (.492)
18	1 1/8-18UNEF	34.13 (1.344)	33.72 (1.328)	1-20UNEF-2A	11.74 (.462)	23.5 (.925)
20	1 1/4-18UNEF	37.28 (1.468)	34.11 (1.343)	1 1/8-18UNEF-2A	12.16 (.479)	26.8 (1.055)
22	1 3/8-18UNEF	40.48 (1.594)	34.11 (1.343)	1 1/4-18UNEF-2A	12.15 (.478)	29.9 (1.177)
24	1 1/2-18UNEF	43.63 (1.718)	36.58 (1.440)	1 3/8-18UNEF-2A	13.42 (.528)	32.9 (1.295)

	Contact Size			
	#16	#12	#8	#8(shell size 24)
H	7.0 (.276)	7.5 (.295)	10.0 (.394)	8.5 (.335)