

MODULAR CONNECTORS

CL 222 TM

Right Angle Dip Type

TM5RC-*(50)

CL No.	Part No.	RoHS
222-0270-9-50	TM5RC-44(50)	YES
222-0338-0-50	TM5RC-64(50)	
222-0337-8-50	TM5RC-66(50)	

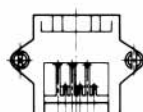
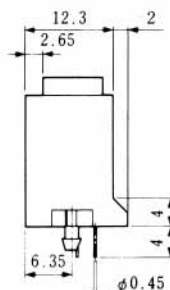
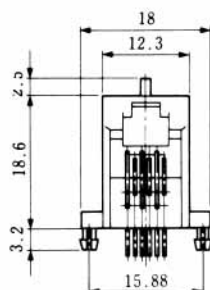

PCB mounting hole layout
(Connector mounting side)

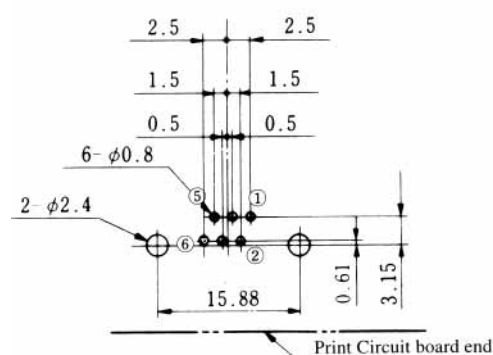

Note 1: Standard finish color is gray.

Note 2: The drawing is shown sample of TM5RC-66(50).

TM5RC-88(50)

CL No.	Part No.	RoHS
222-0339-3-50	TM5RC-88(50)	YES

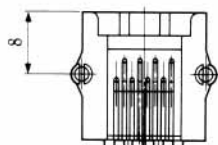
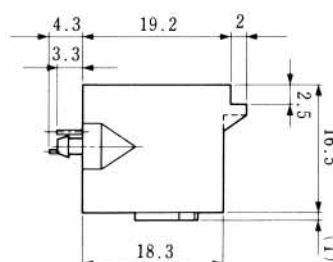
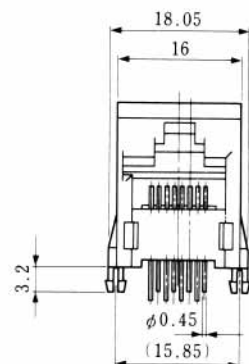
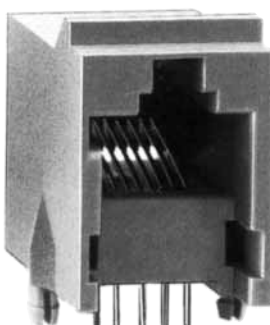

PCB mounting hole layout
(Connector mounting side)

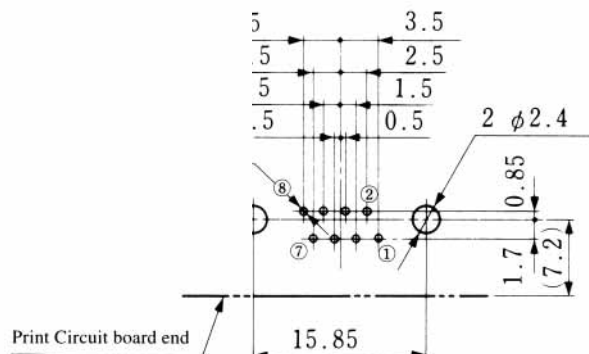

Note : Standard finish color is warm gray.