

PRODUCT NUMBER
SEE TABLE

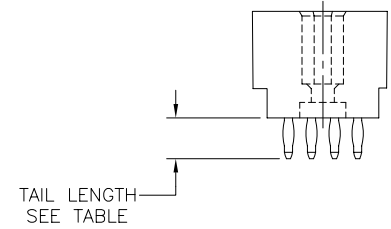
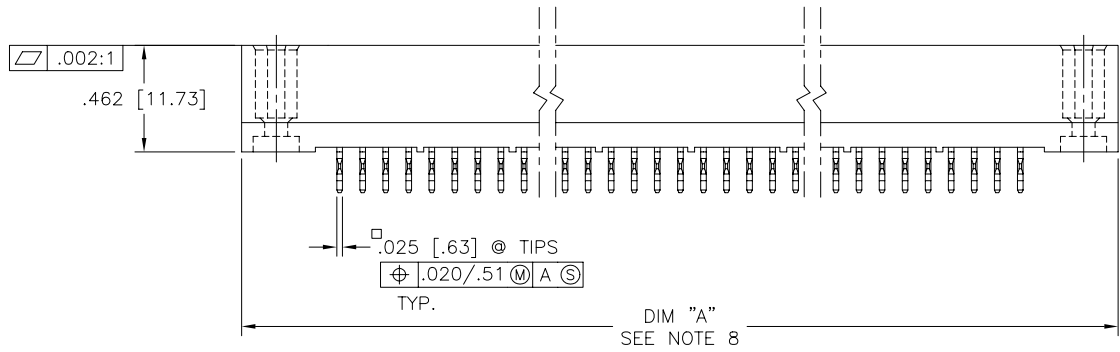
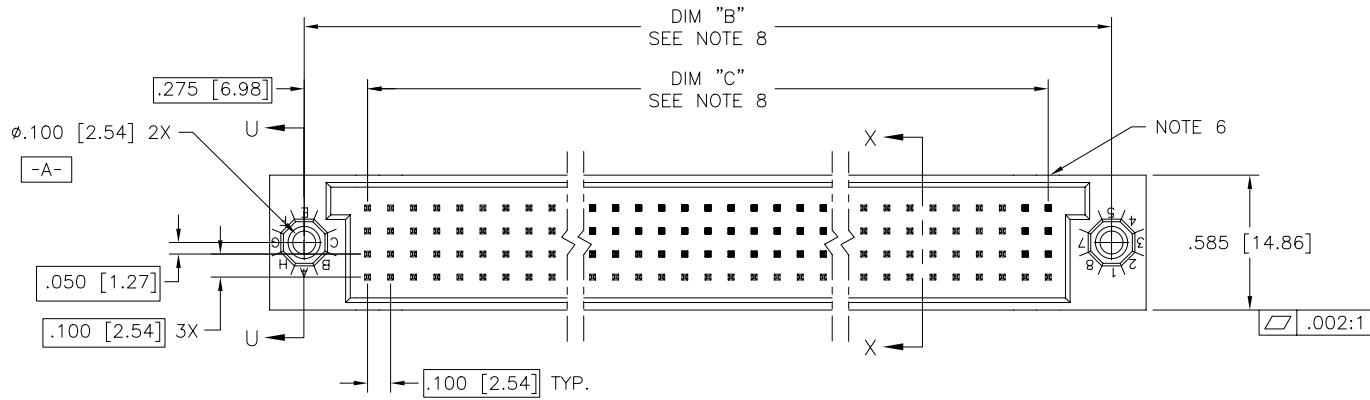

FCI
FCIconnect.com

Copyright FCI

mat'l. code		surface		tolerance		projection		product family	
-		ISO 1302 ✓		ISO 406		ISO 1101		HPC	
ltr	ecn	no	dr	date		tolerances unless otherwise specified		title	
B	v40941	PDP		6/01/94		angles	linear	4 ROW VERTICAL HEADER	
C	v50207	LSS		2/17/95				MULTI-PLATED P.F. PINS, 0 G.P.	
D	v90011	HTB		1/06/99		σ±2'		scale 1:1	
E	v00276	JWS	2/02/00	dr	P. PARSONS	4/12/94		dwg no	
F	v05-0776	DCH	8/15/05	enr	J. AFTON	4/11/95		sheet 1 of 4 size	
G	v05-1048	DAI	11/16/05	chr	G. PETERS	4/15/94		50760 A3	
H	M06-0261	AEA	7/10/06	appd	S. CLARK	4/18/94		type Product Customer Drawing	
sheet	revision	H	H	H	H				
index	sheet	1	2	3	4				

form: A3

PRODUCT NUMBER
SEE TABLE

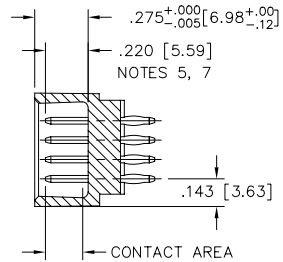
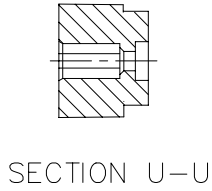

SECTION X-X

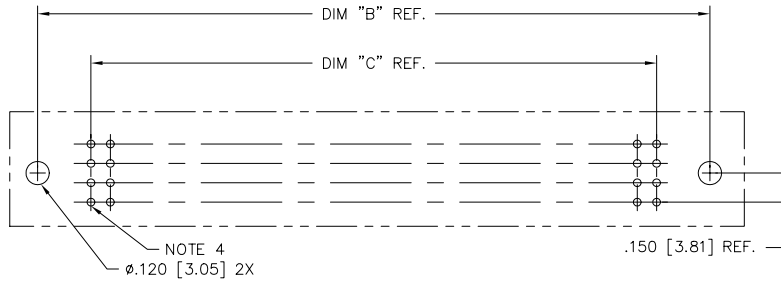

RECOMMENDED PCB LAYOUT
(ALL HOLES LOCATED ON .100/2.54 GRID
UNLESS OTHERWISE SPECIFIED)

NOTES:

① PRODUCT NUMBERING CODE:
50760 - X YYY Z LF
LEAD FREE (OPTIONAL)
TAIL LENGTH (SEE TABLE)
NO. OF POSITIONS (NOTE 2)
PLATING (SEE TABLE)
BASE NUMBER

PRODUCT NUMBERING CODE FOR
SELECT LOAD PART NUMBERS:
50760 - XXYYY LF
LEAD FREE (OPTIONAL)
SEQUENCE NUMBER
ALWAYS "XX"
BASE NUMBER

② THIS PRODUCT IS CONFIGURED IN SIZES OF 6 thru 80 COLUMNS IN INCREMENTS OF ONE. i.e.: 6,7,8,9,.....79,80.

③ HOUSING MATERIAL: GLASS AND MINERAL FILLED HIGH TEMP. THERMOPLASTIC, FLAME RETARDANT PER UL94V-0. COLOR: BLACK. PIN MATERIAL: PHOS BRONZE

④ ϕ .0453/1.151 DRILLED HOLE PLATED WITH .0003/.007 MIN. SnPb OVER .001/.03 to .003/.08 Cu. PLATING TO ACHIEVE A ϕ .040 \pm .003/1.02 \pm .08 HOLE.

⑤ TO ASSURE PROPER INSTALLATION: TOOLING, AS SPECIFIED IN INSTRUCTION MANUAL 155915-001 MUST BE USED. PIN MATING LENGTH WILL BE \pm .002/.05 AFTER INSTALLATION.

⑥ COMPANY NAME, PART NUMBER AND LOT CODE TO APPEAR ON THIS SURFACE PER BUS-22-108.

⑦ REFERENCE 50807 FOR F.M.L.B. AVAILABLE OPTIONS AND WORKSHEET.

⑧ LENGTH DIMENSION CALCULATIONS:
DIM A: $.100/2.54 \times \text{NO. OF COLUMNS} + .750/19.05$
DIM B: $.100/2.54 \times \text{NO. OF COLUMNS} + .450/11.43$
DIM C: $.100/2.54 \times \text{NO. OF COLUMNS} - .100/2.54$

9. THIS PRODUCT (WITH "LF" SUFFIX) MEETS EUROPEAN UNION DIRECTIVES AND OTHER COUNTRY REGULATIONS AS DESCRIBED IN GS-22-008.

10. THIS HOUSING WILL WITHSTAND EXPOSURE TO 260 °C PEAK TEMPERATURE FOR 10-30 SECONDS IN A CONVECTION, INFRA-RED OR VAPOR PHASE OVEN.



FCIconnect.com

Copyright FCI

mat'l. code		surface		tolerance		projection		product family	
-		ISO 1302 <input checked="" type="checkbox"/>		ISO 406				HPC	
ISO 1101		tolerances unless otherwise specified		INCH/MM		title		4 ROW VERTICAL HEADER	
H		angles		linear		scale 1:1		MULTI-PLATED P.F. PINS, 0 G.P.	
		$\phi \pm 2'$.xx \pm .01/.3				dwg no	
		dr		.xxx \pm .005/.13				sheet 2 of 4 size	
		P. PARSONS		.xxxx \pm .0020/.051				50760	
		4/12/94						A3	
		enr						type	
		J. AFTON						Product Customer Drawing	
		4/11/95							
		chr							
		G. PETERS							
		4/15/94							
		appd							
		S. CLARK							
		4/18/94							
sheet		revision							
index		sheet							

PRODUCT NO.	NUMBER OF POSITIONS	PLATING: CONTACT AREA	MIN PLATING: PRESS-FIT AREA	MIN PLATING: TAIL AREA	TAIL LENGTH REF
50760-AYYYYA	YYY	30u"/0.76u Au	40u"/1.02u SnPb	40u"/1.02u SnPb	.177 / 4.50
50760-AYYYYG	YYY	30u"/0.76u Au	40u"/1.02u SnPb	40u"/1.02u SnPb	.250 / 6.35
50760-BYYYYA	YYY	30u"/0.76u GXT	40u"/1.02u SnPb	40u"/1.02u SnPb	.177 / 4.50
50760-BYYYYALF	YYY	30u"/0.76u GXT	40u"/1.02u Sn	40u"/1.02u Sn	.177 / 4.50
50760-BYYYYG	YYY	30u"/0.76u GXT	40u"/1.02u SnPb	40u"/1.02u SnPb	.250 / 6.35
50760-BYYYYGLF	YYY	30u"/0.76u GXT	40u"/1.02u Sn	40u"/1.02u Sn	.250 / 6.35
50760-CYYYYC	YYY	30u"/0.76u Au	40u"/1.02u SnPb	30u"/0.76u Au	.533 / 13.54
50760-CYYYYD	YYY	30u"/0.76u Au	40u"/1.02u SnPb	30u"/0.76u Au	.733 / 18.62
50760-DYYYYC	YYY	30u"/0.76u GXT	40u"/1.02u SnPb	30u"/0.76u GXT	.533 / 13.54
50760-DYYYYCLF	YYY	30u"/0.76u GXT	40u"/1.02u Sn	30u"/0.76u GXT	.533 / 13.54
50760-DYYYYD	YYY	30u"/0.76u GXT	40u"/1.02u SnPb	30u"/0.76u GXT	.733 / 18.62
50760-DYYYYDLF	YYY	30u"/0.76u GXT	40u"/1.02u Sn	30u"/0.76u GXT	.733 / 18.62
50760-XX003	180	30u"/0.76u GXT	30u"/0.76u GXT	Au FLASH	SEE SHEET 4
50760-XX003LF	180	30u"/0.76u GXT	30u"/0.76u GXT	Au FLASH	SEE SHEET 4



FCIconnect.com

Copyright FCI

mat'l. code		surface		tolerance		projection		product family	
-		ISO 1302 ✓		ISO 406 ISO 1101				HPC	
ltr	ecn	no	dr	date		tolerances unless otherwise specified		title	
H						.xx ±.01/.3 .xxx ±.005/.13 .xxxx ±.0020/.051		INCH/MM scale 1:1	
		dr		P. PARSONS		4/12/94		dwg no	
		enr		J. AFTON		4/11/95		sheet 3 of 4 size	
		chr		G. PETERS		4/15/94		50760 A3	
		appd		S. CLARK		4/18/94		type Product Customer Drawing	
sheet index	revision sheet								



PRODUCT NUMBER
50760-XX003
50760-XX003LF

SPECIAL LOAD 50760-XX003 AND 50760-XX003LF SHOWN ON THIS SHEET

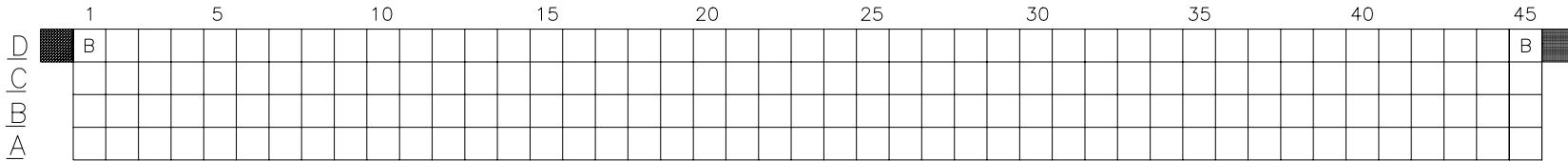

ITEM KEY	SIGNAL DATA			
	SIZE 4 x 45	TOTAL NO. OF POSITIONS -180	NO. OF POSITIONS LOADED - 180	
	PLATING - 30u"/.76u GXT	PRESS FIT STYLE		
	QTY.	MATING LENGTH	TAIL LENGTH	TOTAL PIN LENGTH
A	178	.180 / 4.57	.557 / 14.15	.924 / 23.47
B	2	.210 / 5.33	.587 / 14.91	.984 / 24.99

PLATING NOTE: POST-PLATED

- ALL POSITIONS ARE LOADED WITH "A", EXCEPT AS SHOWN.
- COLUMN 1, ROW A IS DESIGNATED AS SIGNAL PIN 1, AS VIEWED FROM THE MATING FACE.

mat'l. code		surface		tolerance		projection		product family		
-		ISO 1302 ✓		ISO 406 ISO 1101				HPC		
ltr	ecn	no	dr	date		tolerances unless otherwise specified		title		
H						angles linear .xx ±.01/.3 .xxx ±.005/.13 .xxx ±.0020/.051		INCH/MM scale 1:1		
		dr		P. PARSONS 4/12/94				title 4 ROW VERTICAL HEADER MULTI-PLATED P.F. PINS, 0 G.P.		
		enr		J. AFTON 4/11/95				dwg no 50760		
		chr		G. PETERS 4/15/94				sheet 4 of 4 size A3		
		appd		S. CLARK 4/18/94				type Product Customer Drawing		
sheet index	revision sheet									