

MS27505

Rear Panel Box Mount Environment Resisting Receptacle

MIL-DTL-38999

Series I Receptacles

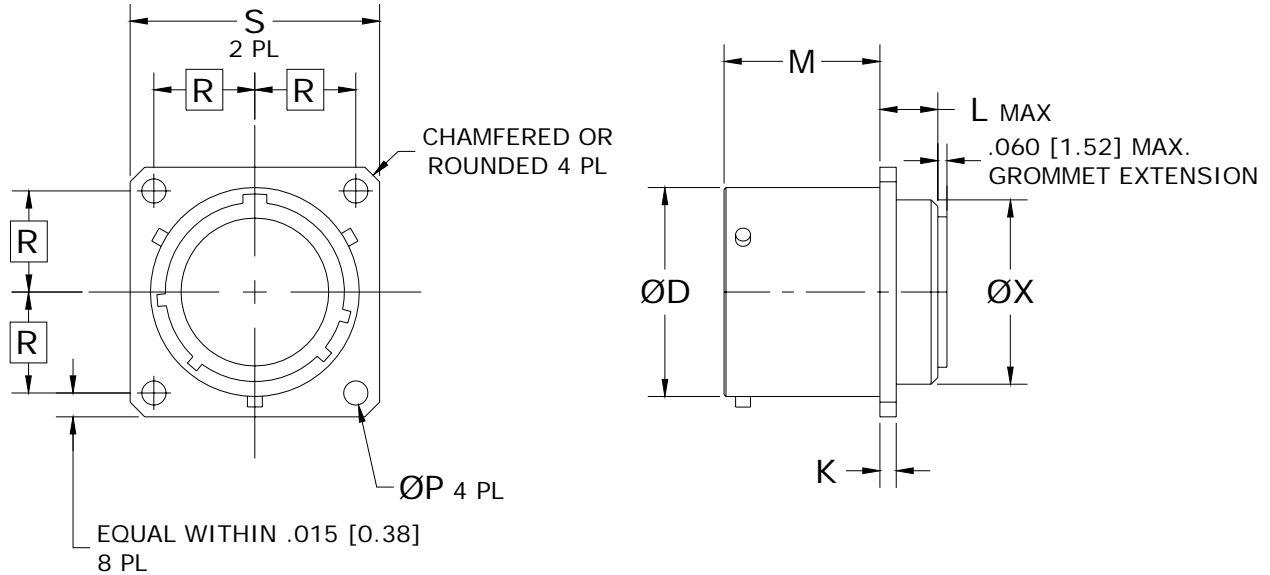

SHELL SIZE	ØD +.001/- .005 [+0.03/-0.13]	K +.015/- .000 [+0.38/-0.00]	L MAX	M +.000/- .005 [+0.00/-0.13]	ØP +.010/- .005 [+0.25/-0.13]	R	S ± .020 [±0.51]	ØX MAX
9	.572 [14.53]	.085 [2.16]	.219 [5.56]	.820 [20.83]	.128 [3.25]	.359 [9.13]	.938 [23.83]	.547 [13.89]
11	.700 [17.78]	.085 [2.16]	.219 [5.56]	.820 [20.83]	.128 [3.25]	.406 [10.31]	1.031 [26.19]	.656 [16.66]
13	.850 [21.59]	.085 [2.16]	.219 [5.56]	.820 [20.83]	.128 [3.25]	.453 [11.51]	1.125 [28.58]	.828 [21.03]
15	.975 [24.77]	.085 [2.16]	.219 [5.56]	.820 [20.83]	.128 [3.25]	.484 [12.31]	1.219 [30.96]	.953 [24.21]
17	1.100 [27.94]	.085 [2.16]	.219 [5.56]	.820 [20.83]	.128 [3.25]	.531 [13.49]	1.312 [33.32]	1.078 [26.38]
19	1.207 [30.66]	.085 [2.16]	.219 [5.56]	.820 [20.83]	.128 [3.25]	.578 [14.61]	1.438 [36.53]	1.203 [30.56]
21	1.332 [33.83]	.115 [2.92]	.250 [6.35]	.790 [20.07]	.128 [3.25]	.625 [15.88]	1.562 [39.67]	1.328 [33.73]
23	1.457 [37.01]	.115 [2.92]	.250 [6.35]	.790 [20.07]	.147 [3.73]	.687 [17.46]	1.688 [42.88]	1.453 [36.91]
25	1.582 [40.18]	.115 [2.92]	.250 [6.35]	.790 [20.07]	.147 [3.73]	.750 [19.05]	1.812 [46.02]	1.578 [40.08]

DIMENSIONS ARE IN INCHES [MILLIMETERS]