

VOLTAGE CONTROLLED OSCILLATORS

FREQUENCY RANGE (MHz)	NOMINAL TUNING VOLTAGE (Volts)	DC BIAS REQUIREMENTS		OUTPUT POWER		AVERAGE TUNING SENSITIVITY MHz/Volt	TYPICAL PHASE NOISE dBc/Hz Offset at 10 KHz/100 KHz	TYPICAL HARMONIC SUPPRESSION (dB)	VSWR (Typ)	MODULATION BANDWIDTH Nom. (MHz)	MODEL
		VOLTAGE (Volts)	CURRENT (mA)	dBm	Tolerance (dB)						
170 - 220	0 - 10	+7	13	+3	±3.0	5 - 10	-95/-115	10	1.5:1	10	VCO - S - A12
180 - 220	0 - 5	+7	35	0	±1.0	9 - 14	-95/-115	10	1.5:1	10	VCO - S - A17
200 - 400	0 - 17	+12	35	+14	±2.5	10 - 20	-95/-115	10	1.5:1	10	VCO - x - 200
210 - 270	1 - 12	+12	35	+10	±3.0	5 - 6	-95/-115	10	1.5:1	10	VCO - S - A19
225 - 450	1 - 17	+7.0	13	+4	±2.5	20 - 30	-95/-115	9	1.5:1	10	VCO - x - A08
250 - 500	2 - 22	+12	35	+14	±2.5	10 - 20	-95/-115	10	1.5:1	10	VCO - x - 250
350 - 410	1 - 10	+8	35	+7	±2.0	6.5 - 10	-95/-120	10	1.5:1	10	VCO - S - A23
400 - 450	1 - 10	+8	35	+7	±2.0	6.5 - 10	-100/123	10	1.5:1	10	VCO - S - A22
400 - 650	0.2 - 5	+5	20	+7.5	±2.5	50 - 70	-95/-115	10	1.5:1	10	VCO - S - A10
400 - 800	0.5 - 15	+12	35	+12	±2.5	20 - 30	-95/-115	10	1.5:1	10	VCO - x - 400
500 - 600	0 - 5	+7	35	0	±1	22 - 30	-90/-110	10	1.5:1	10	VCO - S - A18
500 - 1000	0.5 - 30	+12	35	+14	±2.5	25 - 50	-95/-115	10	1.5:1	10	VCO - x - 500
600 - 1200	0.5 - 20	+12	35	+15	±3.0	30 - 55	-95/-115	10	1.5:1	10	VCO - x - 600
700 - 1400	0.5 - 25	+12	35	+15	±3.0	35 - 60	-95/-115	10	1.5:1	10	VCO - x - 700
750 - 830	1 - 4	+12	30	+14.5	±1.5	35 - 45	-90/-117	10	1.5:1	10	VCO - S - A06
800 - 1600	0 - 25	+12	35	+14	±3.5	40 - 60	-95/-115	10	1.5:1	10	VCO - x - 800
844 - 919	1 - 4	+12	35	+14	±1.5	25 35	-85/-105	10	1.5:1	10	VCO - S - A08
900 - 1800	0.5 - 20	+12	35	+13	±3.0	40 - 60	-95/-115	10	1.5:1	10	VCO - x - 900
900 - 2200	0.5 - 25	+12	35	+10	±3.0	50 - 70	-85/-105	10	1.5:1	10	VCO - S - A20
950 - 1175	4 - 15	+12	35	+13	±3.0	21 - 27	-95/-118	10	1.5:1	10	VCO - S - A27
1000 - 2000	0.5 - 22	+12	35	+11	±3.0	40 - 60	-90/-110	10	1.5:1	10	VCO - x - 1000
1100 - 2200	0.5 - 22	+12	35	+13	±3.0	40 - 60	-90/-110	10	1.5:1	10	VCO - x - 1100
1200 - 2400	0 - 26	+5	35	+10	±3.0	40 - 60	-90/-110	10	1.5:1	10	VCO - S - A11
1500 - 2100	1 - 12	+12	35	+10	±3.0	60 - 80	-85/-105	10	1.5:1	10	VCO - S - A14
1600 - 2000	0 - 5	+5	35	+10	±3.0	80 - 100	-90/-110	10	1.5:1	10	VCO - S - A16
1600 - 2600	0 - 26	+5	35	+10	±3.0	40 - 60	-87/110	10	1.5:1	10	VCO - S - A24
1750 - 2000	1 - 9	+10	30	+10	±2.0	35 - 60	-87/-110	10	1.5:1	10	VCO - S - A13
2000 - 3000	0.5 - 25	+12	35	+10	±3.0	40 - 70	-85/-105	10	1.5:1	10	VCO - x - 2000

COMMON SPECIFICATIONS

Output Impedance: 50 ohms
 Operating Temperature: 0°C to +70°C
 Frequency Pulling: 15 MHz (Typ @ 1.75:1 VSWR)
 Frequency Pushing: <5 MHz/Volt

PIN-OUT TABLE

RF OUT	V _{cc}	V _{tune}	CASE GND
1	4	16	ALL OTHERS

Replace "X" as follows:

P - for outline # 124
 S - for outline # 124S

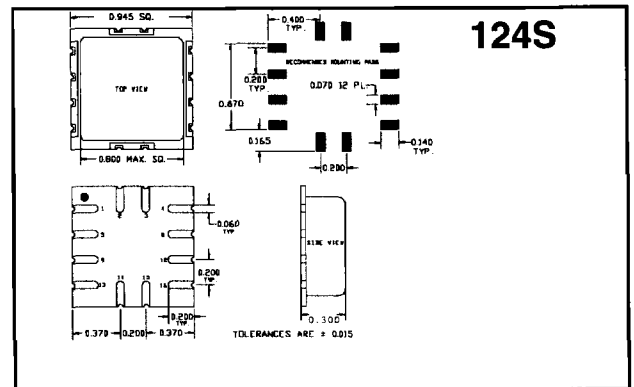
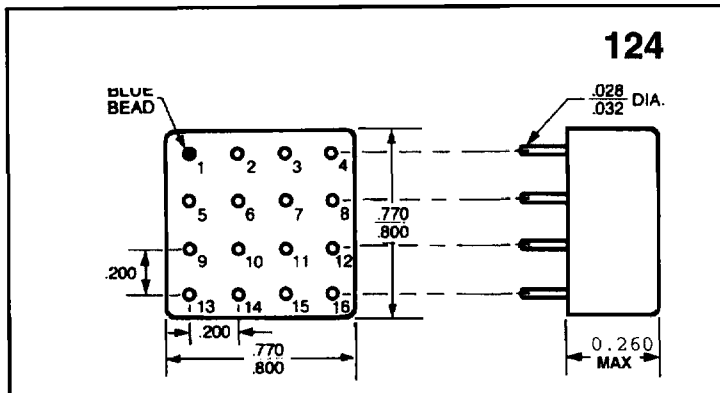

NOTE: SOME MODELS AVAILABLE IN SMA CONNECTORIZED PACKAGE. CONTACT SYNERGY FOR INFORMATION.

