

## Crimp Contact Type Connector

### D\*MA Type

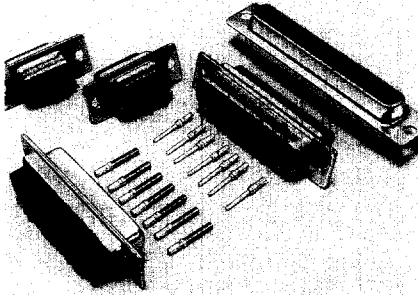

## FEATURES

### • Crimp Snap-In Contacts

Termination is by crimp contacts using standard crimp tools. Terminated contacts are inserted through the rear of the insulators. The inserted contacts are securely held by individual metal clips within each of the insulated cavities. If a circuit change occurs, or when correcting an incorrect wire, the contacts can be removed easily using simple plastic or metal tools.

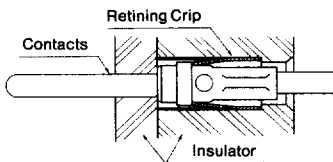

• **Stable, highly reliable socket contact**  
The spring part of the socket contact has a closed-entry construction covered by a stainless steel sleeve to enclose the tines and assure contact stability. The insulators are made of glass-impregnated diallyl phthalate which excels in resistance to heat and weather, dimensional stability, etc. Flame retardant per UL94V-0. Let us explain what is available.

## HOW TO ORDER

# DAMA -15P-FO DAMAF-15S-FO

- -FO: Connector less contacts (not stamped on connector)
- Contact type: P—Pin; S—Socket
- Contact arrangement: 9, 15, 25, 37, 50
- Mounting type: No designator—Standard; F—Float mount
- Connector type: Monoblock insert, crimp termination type
- Connector size: E, A, B, C, D
- Series prefix

- Place orders separately for connector bodies and necessary contacts (see page 16)
- Place orders for accessories (see page 52 to 61) separately from those for connector bodies.

### Example of combination of connector

Use a pair of connectors that has the same shell size and contact arrangement but different contact sex.

Example: Body DAMA-15P-FO (15 conductor pin side)—  
DAMA-15S-FO (15 conductor socket side)  
contact 330-5291-900 (pin contact)—  
031-5130-000 (socket contact)

## STANDARD DATA

### • Materials/Finishes

Component	Material	Finish
Contacts	Copper alloy (Sleeve of socket contact... stainless steel)	Gold plate
Insulator	Glass-filled diallylphthalate	Color: Dark green
Shell	Steel	Yellow chromate over zinc plate
Crimp	Beryllium copper	Ebonizing treatment

### • ELECTRICAL DATA

Current rating	5 amp
Dielectric rating	1,000 V AC r.m.s
Insulation resistance	5,000 megohms min.
Contact resistance	2.7 milliohms max.

- Details... See pages 6 to 9.
- How to terminate and assemble connectors... See pages 64 to 66.

## CONTACT ARRANGEMENT

Face view pin insert

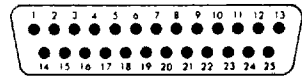
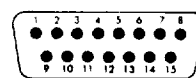
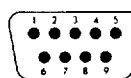

Shell size	E	A	B
Contact arrangements	9	15	25

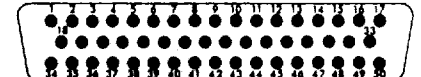
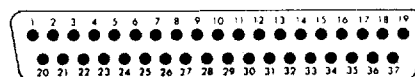

Shell size	C	D
Contact arrangements	37	50

# CRIMP CONTACT TYPE - D\*MA TYPE

## D\*MA Type - Crimp Contact Type

D\*MA - Standard Shell

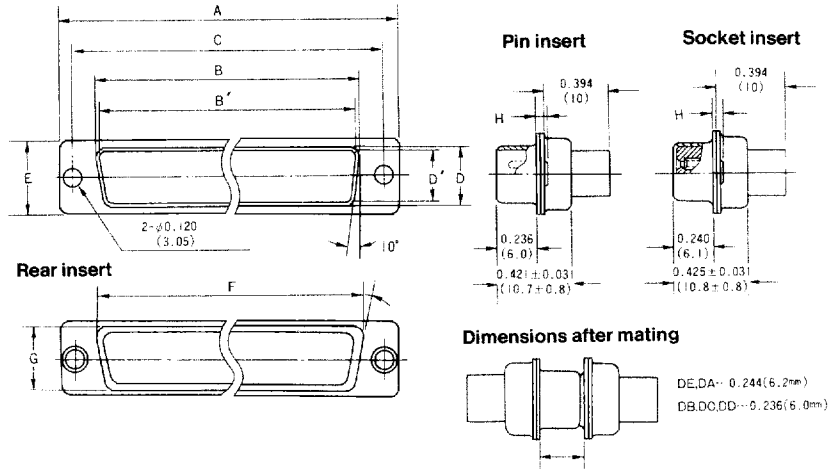
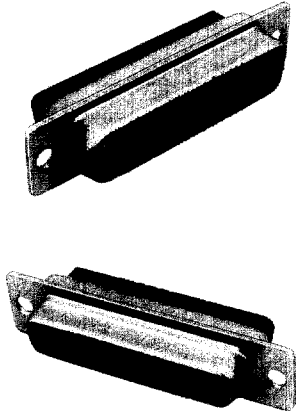

D\*MAF - Shell with Float Mounts

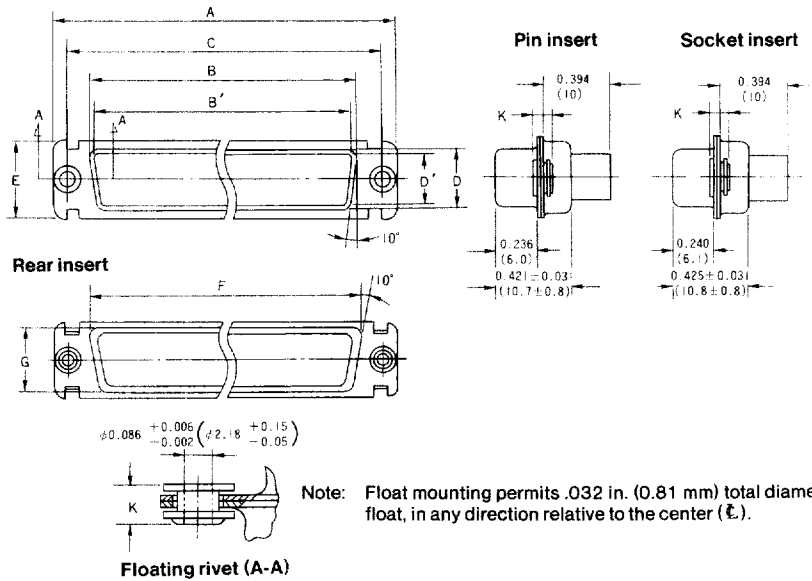
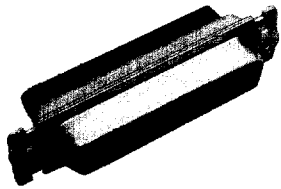

• Only one connector, either pin or socket should be float mounted.

Unit: inch (mm)

No. of Contact	Part Number	A ±.020 (±0.5)	B ±.010 (±0.25)	B' ±.010 (±0.25)	C ±.005 (±0.13)	D ±.010 (±0.25)	D' ±.010 (±0.25)	E ±.020 (±0.5)	F ±.016 (±0.4)	G ±.016 (±0.4)	H ±.016 (±0.4)	K ±.010 (±0.25)
9	Pin <b>DEMA-9P-FO</b>	1.213 (30.8)	—	.665 (16.90)	.984 (24.99)	—	.328 (8.34)	.496 (12.6)	.760 (19.3)	.421 (10.7)	.047 (1.2)	.120 (3.05)
	Socket <b>DEMA-9S-FO</b>	1.213 (30.8)	.640 (16.26)	—	.984 (24.99)	.308 (7.82)	—	.496 (12.6)	.760 (19.3)	.421 (10.7)	.047 (1.2)	.120 (3.05)
15	Pin <b>DAMA-15P-FO</b>	1.539 (39.1)	—	.994 (25.24)	1.312 (33.32)	—	.328 (8.34)	.496 (12.6)	1.083 (27.5)	.421 (10.7)	.047 (1.2)	.120 (3.05)
	Socket <b>DAMA-15S-FO</b>	1.539 (39.1)	.968 (24.59)	—	1.312 (33.32)	.308 (7.82)	—	.496 (12.6)	1.083 (27.5)	.421 (10.7)	.047 (1.2)	.120 (3.05)
25	Pin <b>DBMA-25P-FO</b>	2.087 (53.0)	—	1.536 (39.01)	1.852 (47.04)	—	.331 (8.4)	.496 (12.6)	1.626 (41.3)	.421 (10.7)	.059 (1.5)	.129 (3.28)
	Socket <b>DBMA-25S-FO</b>	2.087 (53.0)	1.508 (38.3)	—	1.852 (47.04)	.308 (7.82)	—	.496 (12.6)	1.626 (41.3)	.421 (10.7)	.047 (1.2)	.120 (3.05)
37	Pin <b>DCMA-37P-FO</b>	2.728 (69.3)	—	2.184 (55.47)	2.500 (63.50)	—	.331 (8.4)	.496 (12.6)	2.272 (57.7)	.421 (10.7)	.059 (1.5)	.129 (3.28)
	Socket <b>DCMA-37S-FO</b>	2.728 (69.3)	2.156 (54.76)	—	2.500 (63.50)	.308 (7.82)	—	.496 (12.6)	2.272 (57.7)	.421 (10.7)	.047 (1.2)	.120 (3.05)
50	Pin <b>DDMA-50P-FO</b>	2.634 (66.9)	—	2.081 (52.86)	2.406 (61.11)	—	.439 (11.16)	.606 (15.4)	2.177 (55.3)	.547 (13.9)	.059 (1.5)	.129 (3.28)
	Socket <b>DDMA-50S-FO</b>	2.634 (66.9)	2.061 (52.34)	—	2.406 (61.11)	.419 (10.65)	—	.606 (15.4)	2.177 (55.3)	.547 (13.9)	.047 (1.2)	.120 (3.05)

- To order float mount, add "F". For example: DAUF-15S-FO.
- To order glass-filled nylon insulator, part number becomes D\*C. For example: DAC-15S-FO

## ■ CRIMP TERMINATION CONTACTS FOR D\*MA

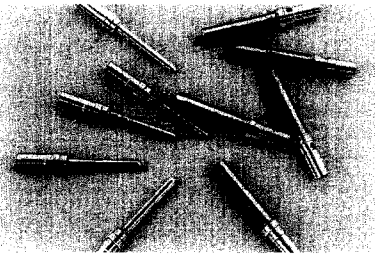

**Pin Contact**

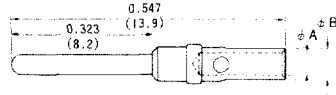

**Note: Contact size for 20-18**

**Pin**

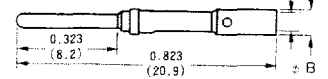

**Socket Contact**

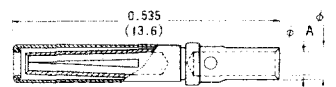

**Socket**

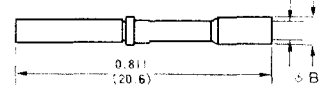

Contact Size	Part Number		φA	φB	Applicable Wire AWG No.
	Pin	Socket			
20	330-5291-900	031-5130-000	.044 (1.12)	.065 (1.65)	#20, 22, 24
20-18 (Note)	330-5291-001	031-1007-001	.067 (1.7)	.083 (2.1)	#18 or 2#22
20-26	330-50264	031-50287	.024 (0.6)	.065 (1.65)	#26, 28, 30

(Note) For contact size 20-18 only, shrink sleeving is suggested over the crimp point to prevent contacts from touching.

## ■ CRIMP AND INSERTION/EXTRACTION TOOLS FOR D\*MA CONNECTORS

The crimp tool and locator(s) are purchased separately.

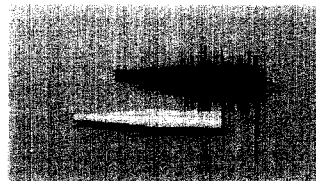
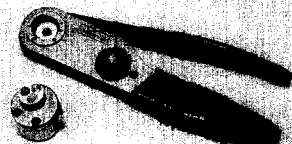
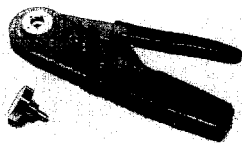

Contact Size	Part Number		Applicable Wire AWG No.	Crimping Tools		Extraction Tool
	Pin	Socket		Hand Crimp Tool	Locator	
20	330-5291-900	031-5130-000	#20 ~ #24	M2250/2-01	JP-D*MA-20-20	CET-20-11 (Plastic) ET-20D (Metal)
20-26	330-50264	031-50287	#26 ~ #30	M2250/1-01	TH25	CET-20-15 (Plastic)
20-18	330-5291-001	031-1007-001	#18 or 2#22			

### Contact insertion/extraction

① Starting to insert

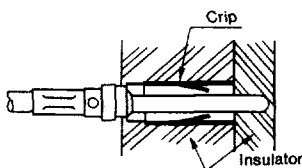

② Clip opened

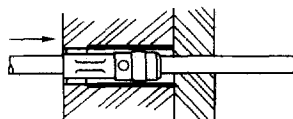

③ Clip tines in place (locked condition)

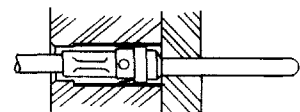

① Inserting extraction tool

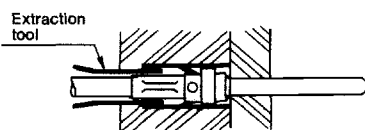

② Clip opened

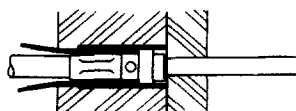

③ Extracting contact

