

SMH-1XX-XX-XX-X-XX

TABLE 1	
LEAD STYLE	CONTACT
-02	C-8-03-XXX
-22	C-17-03-XXX

FIG. 1
SMH-120-XX-XX-D SHOWN

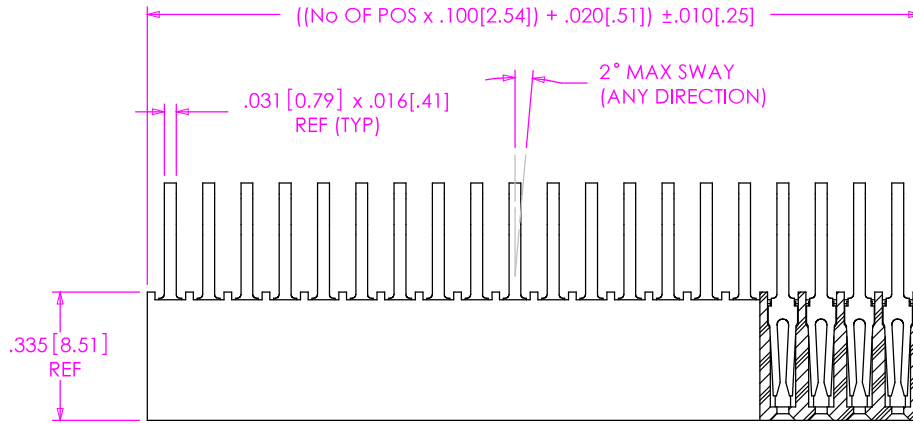

SECTION "A"- "A"

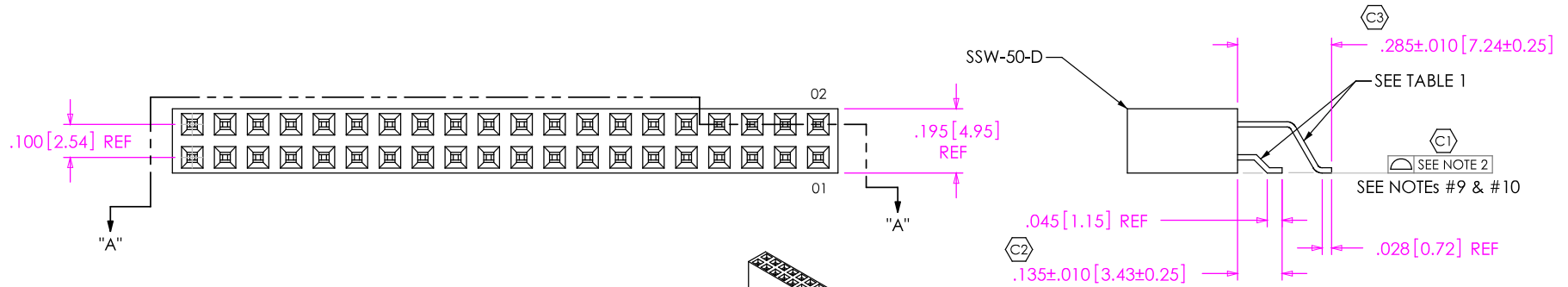

- NOTES:
- ① REPRESENTS A CRITICAL DIMENSION.
 - COPLANARITY: POSITIONS 02-24= .006[.15], POSITIONS 25-36= .008[.20].
 - BURR ALLOWANCE: .003[.08] MAX.
 - ONE POSITION WILL BE LOST FOR EVERY CUT MADE ON A SOCKET STRIP; CUT FLASH TO BE .010 [2.5] MAX WITH NO FLASH ALLOWED IN HOLES OR EXTENDING BELOW LEADS
 - MINIMUM PUSHOUT FORCE: 1.5 LB.
 - MAXIMUM ALLOWABLE BOW: .003[.08] INCH/INCH AFTER ASSEMBLY.
 - "END WALLS" AFTER CUTTING SHOULD BE .020 ± .003[.08].
 - SHEAR TAILS TO DIMENSION SHOWN.
 - CONTACT TAILS TO BE FLUSH TO .003[.08] ABOVE OR BELOW A DATUM LINE MADE BY THE INSULATOR.
 - SEE FIGURE 3, SHEET 3, TAILS MUST BE WITHIN +/- .003 WITH RESPECT TO EACH OTHER.

DO NOT SCALE FROM THIS PRINT

- NO. OF POSITIONS**
-02 THRU -36 (PER ROW)
- LEAD STYLE**
-02: SURFACE MOUNT (USE C-8-03-X)
-22: LOW INSERTION FORCE (USE C-17-03-X)
- PLATING**
-G: GOLD (FOR -02: USE C-8-03-G) (FOR -22: USE C-17-03-G)
-T: TIN (FOR -02: USE C-8-03-T) (NOT AVAILABLE ON -22 LEAD STYLE)
-S: HEAVY SELECTIVE GOLD (FOR -02: USE C-8-03-S) (FOR -22: USE C-17-03-S)
-F: FLASH SELECTIVE GOLD (FOR -02: USE C-8-03-F) (FOR -22: USE C-17-03-F)
-H: HEAVY GOLD (FOR -02: USE C-8-03-H) (FOR -22: USE C-17-03-H)
-TM: MATTE TIN (FOR -02: USE C-8-03-T) (NOT AVAILABLE ON -22 LEAD STYLE)
-SM: HEAVY SELECTIVE GOLD (FOR -02: USE C-8-03-S) (FOR -22: USE C-17-03-S)
-FM: FLASH SELECTIVE GOLD (FOR -02: USE C-8-03-F) (FOR -22: USE C-17-03-F)
- OPTIONS**
-XX: INDICATES POSITION POLARIZED (USE PK-06)
-TR: TAPE & REEL PACKAGING (2 - 29 POSITIONS ONLY)
- ROW SPECIFICATION**
-D: DOUBLE ROW (USE SSW-50-D) (SEE FIG. 1)
-S: SINGLE ROW (USE SSW-50-S) (SEE FIG. 2, SHT. 2)

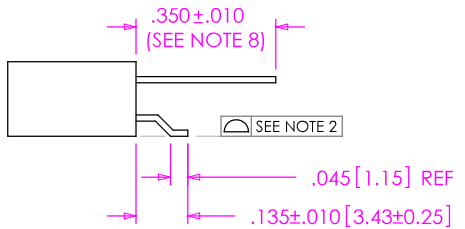
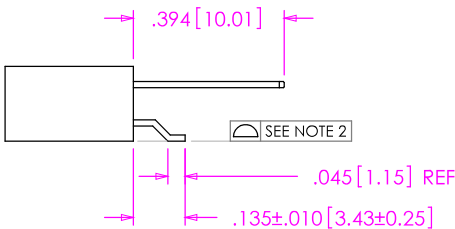
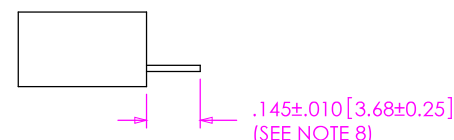
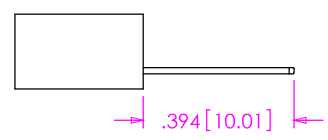

UNLESS OTHERWISE SPECIFIED, DIMENSIONS ARE IN INCHES.
TOLERANCES ARE:
DECIMALS .XX: $\pm .01[.3]$
.XXX: $\pm .005[.13]$
.XXXX: $\pm .0020[.051]$

ANGLES 2°

PROPRIETARY NOTE
THIS DOCUMENT CONTAINS INFORMATION CONFIDENTIAL AND PROPRIETARY TO SAMTEC, INC. AND SHALL NOT BE REPRODUCED OR TRANSFERRED TO OTHER DOCUMENTS OR DISCLOSED TO OTHERS OR USED FOR ANY PURPOSE OTHER THAN THAT WHICH IT WAS OBTAINED WITHOUT THE EXPRESSED WRITTEN CONSENT OF SAMTEC, INC.

SAMTEC

520 PARK EAST BLVD, NEW ALBANY, IN 47150
* PHONE: 812.944.6733 FAX: 812.948.5047
e-Mail: INFO@SAMTEC.COM CODE: 55322

MATERIAL: DO NOT SCALE DRAWING SHEET SCALE: 2:1
INSULATOR: VECTRA E130
CONTACT: PHOSPHOR BRONZE

DESCRIPTION:
.100 [2.54] HORIZONTAL SMT SOCKET ASSEMBLY
DWG. NO. **SMH-1XX-XX-XX-X-XX**

FIG. 2
SMH-120-XX-XX-S SHOWN
(SAME AS FIG. 1, UNLESS OTHERWISE STATED)

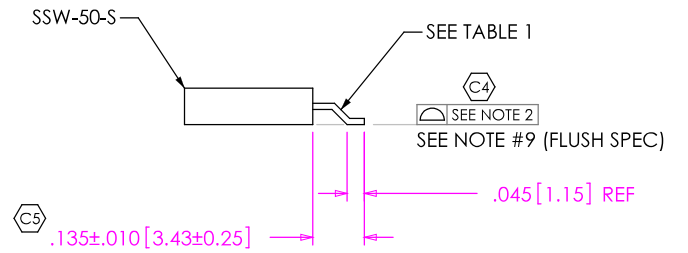
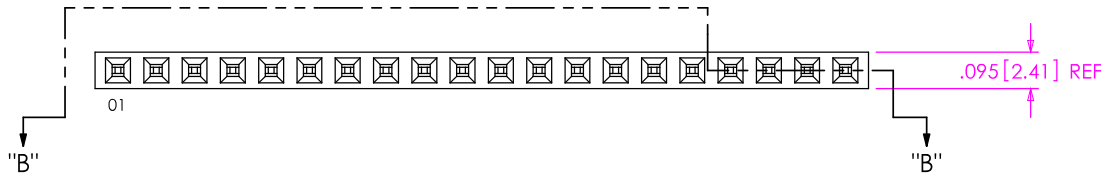
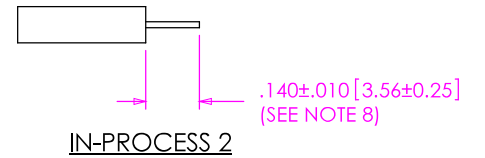
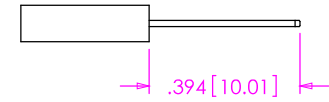
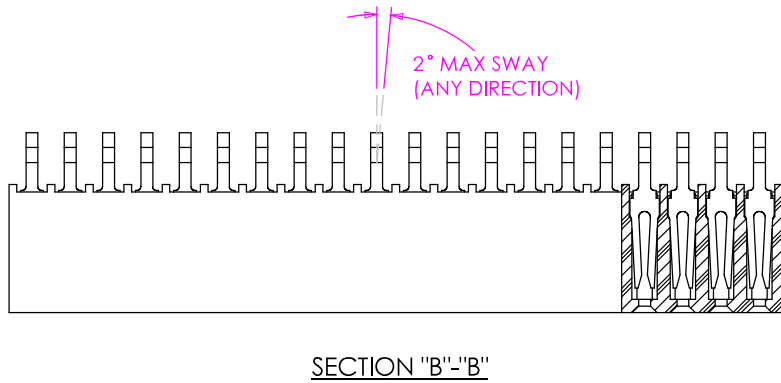

PACKAGING

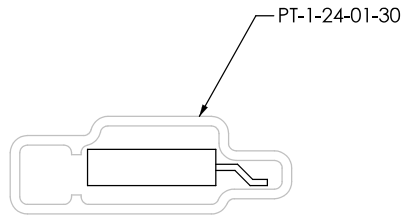
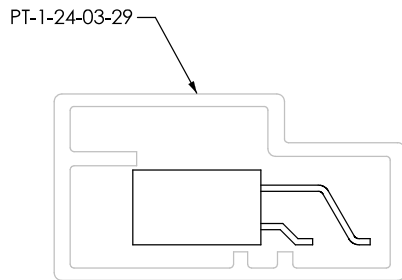

TABLE 2

ROW	TUBE	PLUG
-S	PT-1-24-01-30	TP-07
-D	PT-1-24-03-29	TP-07

PROPRIETARY NOTE
THIS DOCUMENT CONTAINS INFORMATION CONFIDENTIAL AND PROPRIETARY TO SAMTEC, INC. AND SHALL NOT BE REPRODUCED OR TRANSFERRED TO OTHER DOCUMENTS OR DISCLOSED TO OTHERS OR USED FOR ANY PURPOSE OTHER THAN THAT WHICH IT WAS OBTAINED WITHOUT THE EXPRESSED WRITTEN CONSENT OF SAMTEC, INC.

DO NOT SCALE DRAWING

SHEET SCALE: 2:1

SAMTEC

520 PARK EAST BLVD, NEW ALBANY, IN 47150
* PHONE: 812.944.6733 FAX: 812.948.5047
e-Mail: INFO@SAMTEC.COM CODE: 55322

DESCRIPTION:
.100 [2.54] HORIZONTAL SMT SOCKET ASSEMBLY

DWG. NO. **SMH-1XX-XX-XX-X-XX**

BY: BRATCHER 2/5/99 SHEET 2 OF 3

FIG. 3
(SMH-120-XX-XX-D SHOWN)

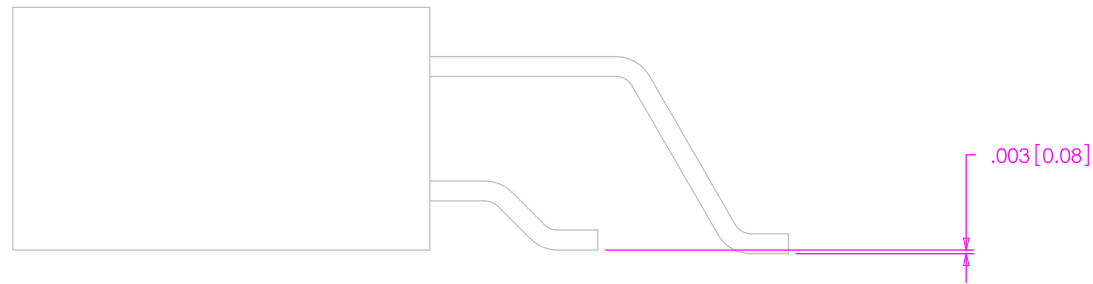
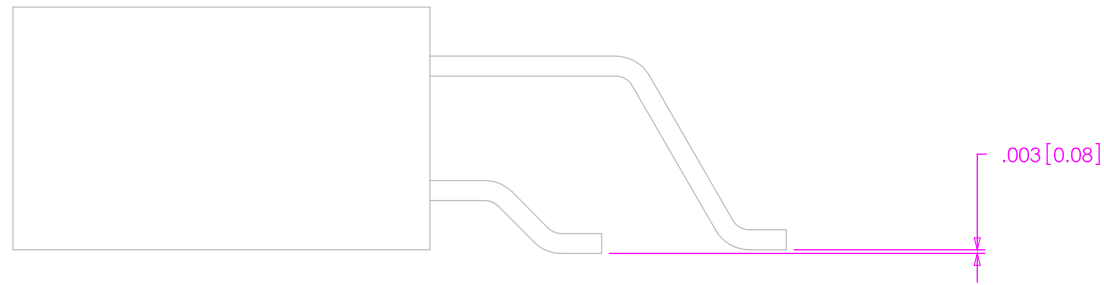

PROPRIETARY NOTE
THIS DOCUMENT CONTAINS INFORMATION
CONFIDENTIAL AND PROPRIETARY TO
SAMTEC, INC. AND SHALL NOT BE REPRODUCED
OR TRANSFERRED TO OTHER DOCUMENTS OR
DISCLOSED TO OTHERS OR USED FOR ANY
PURPOSE OTHER THAN THAT WHICH IT WAS
OBTAINED WITHOUT THE EXPRESSED WRITTEN
CONSENT OF SAMTEC, INC.

DO NOT SCALE DRAWING

SHEET SCALE: 2:1

SAMTEC

520 Park East Blvd. New Albany, IN 47151
Phone (812) 944-6733 Fax (812) 948-5047
e-Mail: INFO@SAMTEC.COM CODE: 55322

DESCRIPTION:
.100 [2.54] HORIZONTAL SMT SOCKET ASSEMBLY

DWG. NO. **SMH-1XX-XX-XX-X-XX**

BY: BRATCHER 2/5/99 SHEET 3 OF 3