

Coaxial Plugs

ADC standard and midsize plugs are available in a variety of configurations and are fully compatible with ADC's standard and midsize coaxial jacks (unless otherwise noted).

Standard size plugs are available with .090" (2.29 mm) or .070" (1.78 mm) center conductors. Standard size single plugs are made with standard wrench fittings for easy assembly and include a unique cable strain relief clamp.

Single plugs, terminating plugs with built-in resistor and capacitor and a selection of looping plugs with or without monitoring are available. Plugs will accommodate a variety of cable sizes and may be ordered in gold or nickel plating finishes.

See page 94 for detailed specifications. Reference page 95 for specific cable dimensions and crimp tool information.

Single Plugs Standard Size

CP1051X

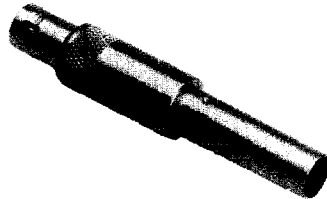

Single plug for accessing via a BNC type connector.

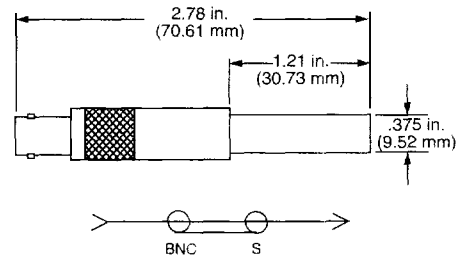

CP1051MX

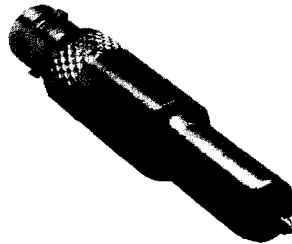

Single plug for monitoring via BNC type connector. Center pin extends beyond the front barrel of the connector.

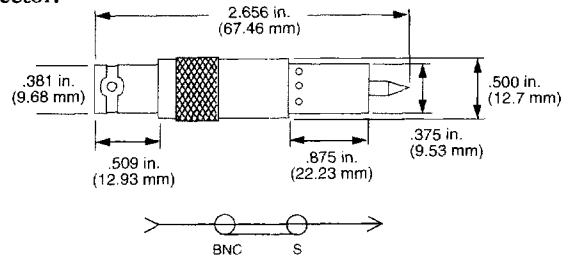

Ordering Information

Pin	Catalog Number*
.090" (2.29 mm)	CP1051X
.090" (2.29 mm)	CP1051MX

*When ordering, replace X with G (gold plating on all contact surfaces), or N (gold plating only on the center conductor).

Coaxial Plugs

Single Plugs

Standard Size

CP2600
CP2601
CP2602

Plug with BNC hex crimp connector.

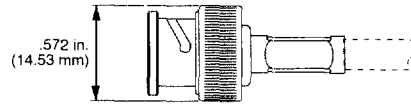

CP2800
CP2801
CP2802
CP2806

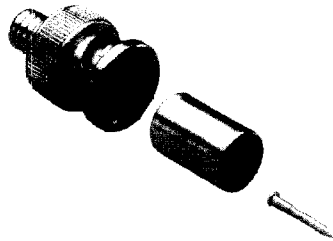

Plug with BNC round crimp connector.

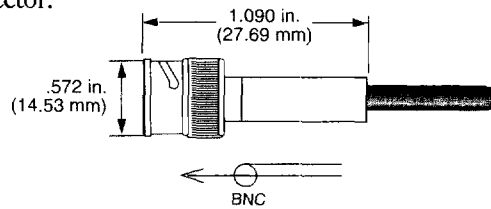

CP2700
CP2701
CP2702
CP2807

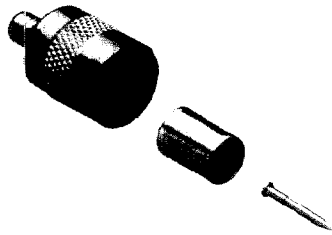

Plug with TNC round crimp connector.

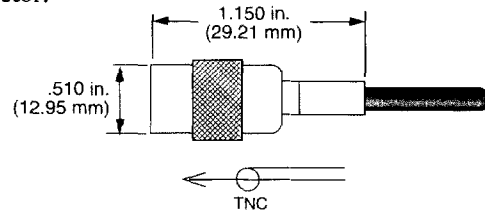

Ordering Information		
Description	Representative Cable Type	Catalog Number
BNC plug; hex crimp	RG59, straight RG59, right angle 728, straight 728, right angle 734, straight 734, right angle	CP2600 CP2600RA CP2601 CP2601RA CP2602 CP2602RA
BNC plug; round crimp	RG59, straight RG59, right angle 728, straight 728, right angle 734, straight 734, right angle 735A, straight 735A, right angle	CP2800 CP2800RA CP2801 CP2801RA CP2802 CP2802RA CP2806 CP2806RA
TNC plug; round crimp	RG59 728 734 735A	CP2700 CP2701 CP2702 CP2807

Coaxial Plugs

Single Plugs

Standard Size

CP1047X
CP1147X

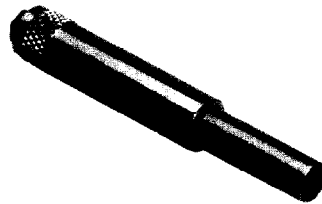

Single terminating plug containing a 75 ohm resistor between outer and center conductor. This plug also features a monitor pin bypassing the resistor to the center conductor.

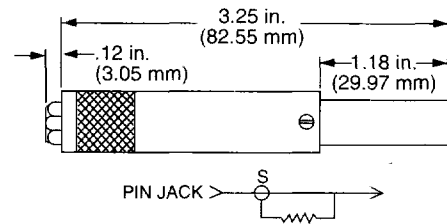

CP1900

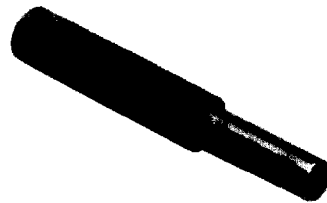

Terminating plug with 75 ohm resistor between the outer and center conductor.

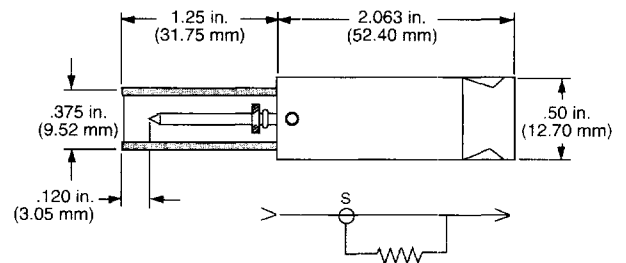

Ordering Information		
Description	Pin	Catalog Number*
Single terminating plug; 75 ohm resistor; monitor pin bypassing resistor	.090" (2.29 mm) .070" (1.78 mm)	CP1047X CP1147X
Single terminating plug; 75 ohm resistor	.090" (2.29 mm)	CP1900

*When ordering, replace X with G (gold plating on all contact surfaces) or G (gold plating only on the center conductor).

Coaxial Plugs
Single Plugs
Standard Size

PGS-100016

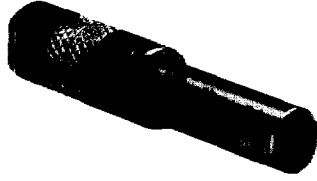

Single plug compatible with
 734 cable.

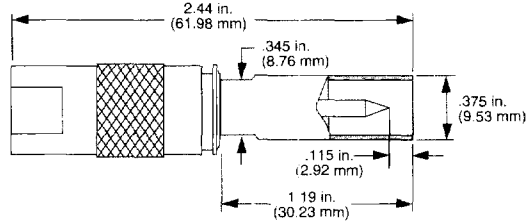

PGS-100017

Single plug compatible with
 735A cable.

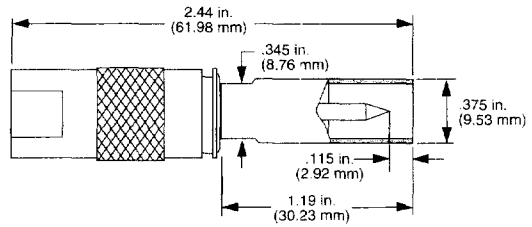

Ordering Information		
Description	Pin	Catalog Number
Single plug; 734 cable compatible	.090" (2.29 mm)	PGS-100016
Single plug; 735A cable compatible	.090" (2.29 mm)	PGS-100017

Coaxial Plugs

Single Plugs

Standard Size

CP1040X
CP1140X

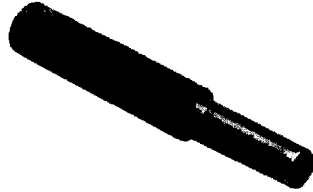

Single plug containing a 30 mm capacitor and a 75 ohm resistor between the outer and center conductor. Similar to WECO 340C plug.

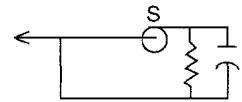
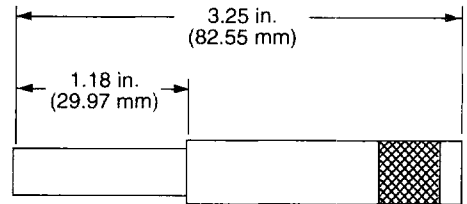

CP1041X
CP1048X
CP1141X

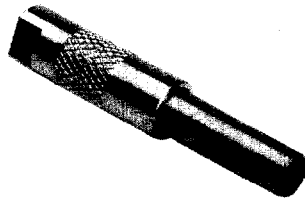

Single plug with a cable jack strain relief and crimp solderless connections. Nickel plated plug jacket has two flats for wrench fitting to attach to the outer conductor. Similar to WECO 358A plug.

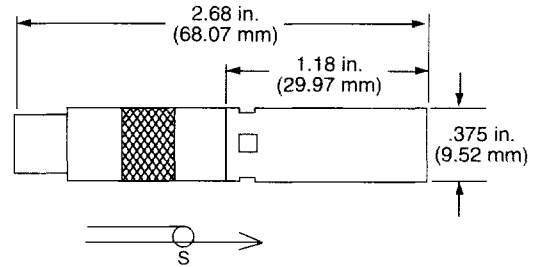

Ordering Information		
Representative Cable Type	Pin	Catalog Number*
----	.090" (2.29 mm)	CP1040X
----	.070" (1.78 mm)	CP1140X
RG59	.090" (2.29 mm)	CP1041X
8281 (Belden) and 728 (WECO)	.090" (2.29 mm)	CP1048X
RG59	.070" (1.78 mm)	CP1141X

*When ordering, replace X with G (gold plating on all contact surfaces) or N (gold plating only on the center conductor).