

**SAW Filter 942.50MHz**  
**Part No: MA06342**

**Model: TA0179A**  
**REV. NO.: 2**

**A. MAXIMUM RATING:**

1. Input Power Level: 15 dBm
2. DC voltage: 0 V
3. Operating Temperature: -30°C to +80°C
4. Storage Temperature: -40°C to +85°C

**B. ELECTRICAL CHARACTERISTICS:**

Characteristics	Specification			Note
	Min.	Typ.	Max	
Center frequency Fc MHz	-	942.5	-	-
Insertion loss 925~960 MHz I.L. dB	-	3.0	4.0	-
Ripple 925~960 MHz dB	-	1.3	2.3	-
V.S.W.R 925~960 MHz	-	2.0	2.6	-
Attenuation: ( Reference level from 0 dB )				
0 ~ 750 MHz dB	50	60	-	-
750 ~ 880 MHz dB	43	50	-	-
880 ~ 905 MHz dB	31	42	-	-
980 ~ 1005 MHz dB	21	28	-	-
1005 ~ 1025 MHz dB	28	33	-	-
1025 ~ 1035 MHz dB	35	49	-	-
1035 ~ 1760 MHz dB	40	50	-	-
1760 ~ 3000 MHz dB	25	31	-	-
Impedance at F <sub>C</sub> Input Z <sub>IN</sub> =R <sub>IN</sub> //C <sub>IN</sub>	50Ω // 0 PF			1
Output Z <sub>OUT</sub> =R <sub>OUT</sub> //C <sub>OUT</sub>	50Ω // 0 PF			1

Note1. No matching network required for operation at 50 Ω

**SAW Filter 942.50MHz**  
**Part No: MA06342**

**Model: TA0179A**  
**REV. NO.: 2**

**C. TRANSFER FUNCTION:**

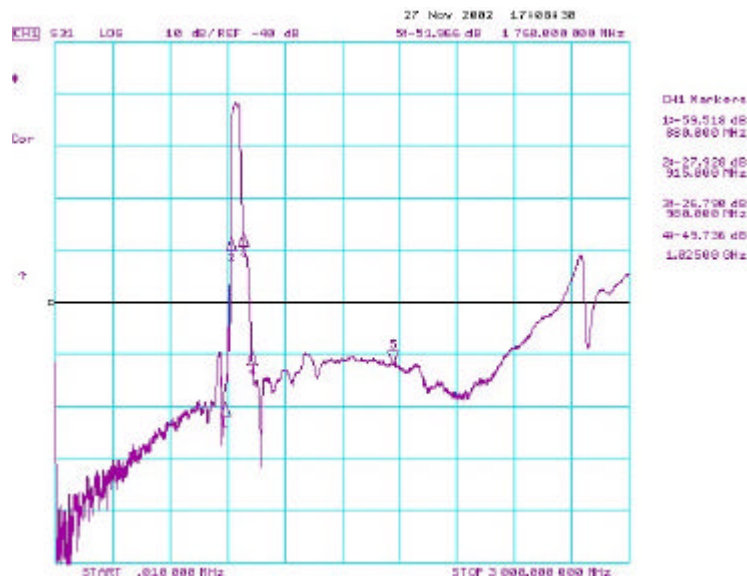
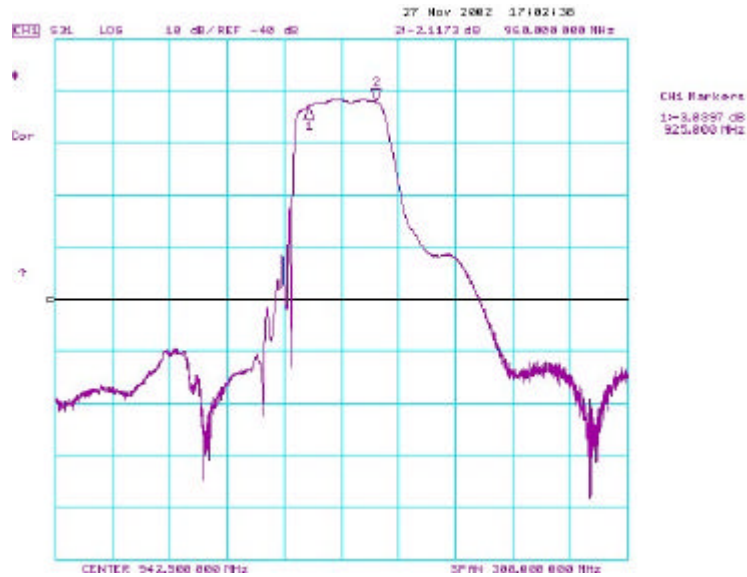

**SAW Filter 942.50MHz**  
**Part No: MA06342**

**Model: TA0179A**  
**REV. NO.: 2**

**D. REFLECTION FUNCTIONS:**

S11

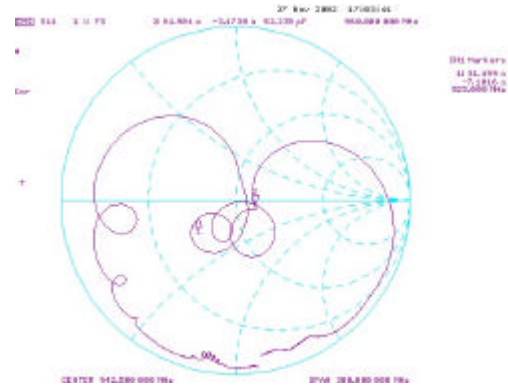
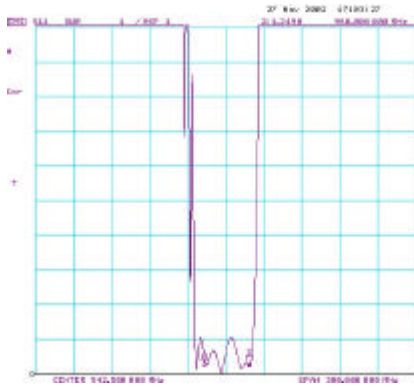

S22

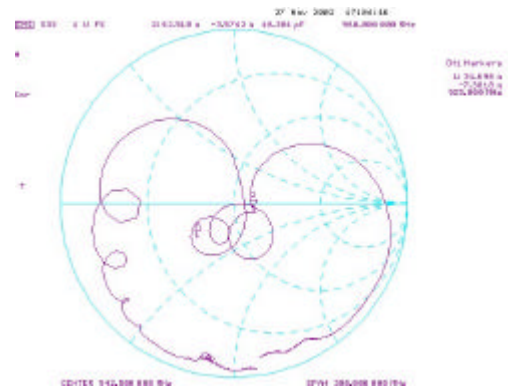
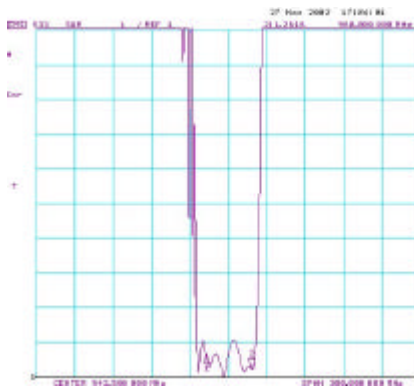



**SAW Filter 942.50MHz**  
**Part No: MA06342**

**Model: TA0179A**  
**REV. NO.: 2**

**G. PACKING:**

**1. REEL DIMENSION**

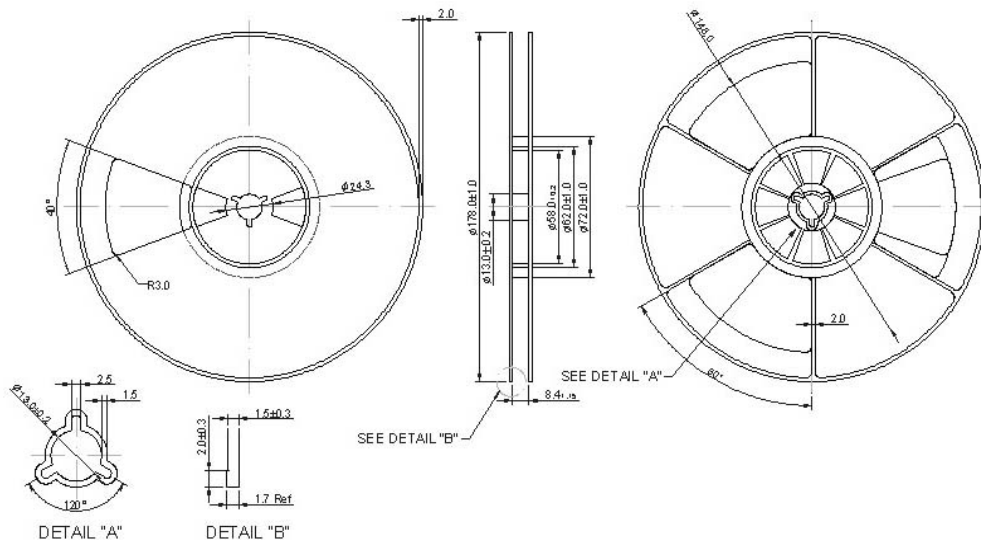

**2. TAPE DIMENSION**

