

## Adapter Terminals

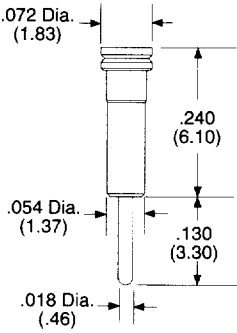

Type	Part Number
-147	1582

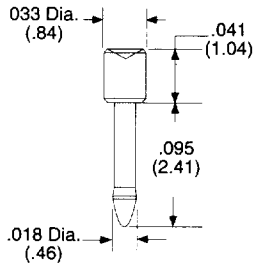

Type	Part Number
-608	4975

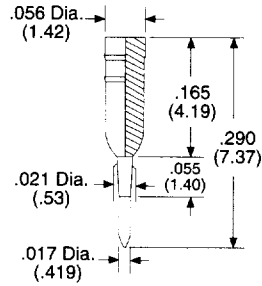

Type	Part Number
-409	4269

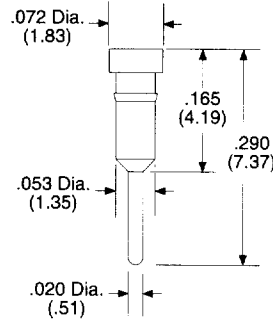

Type	Part Number
-394	4212

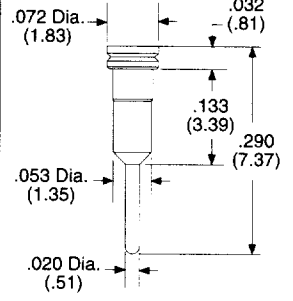

Type	Part Number
-376	4148

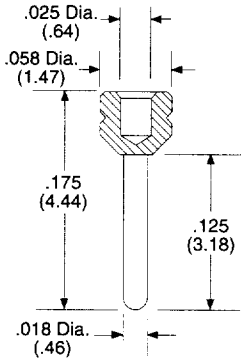

Type	Part Number
-772	6332

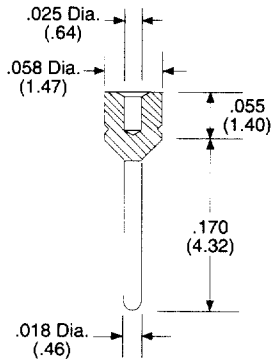

Type	Part Number
-291	3757

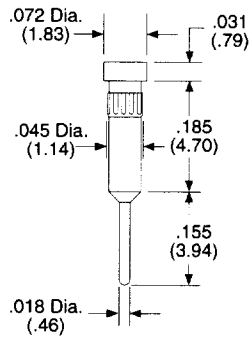

Type	Part Number
-65	1067-2

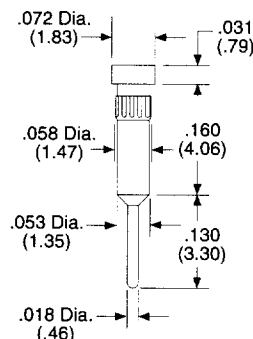

Type	Part Number
-140	1743

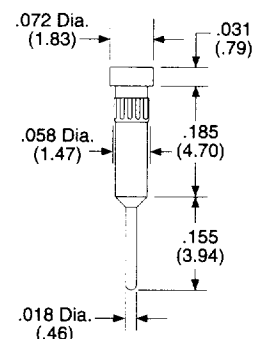

Type	Part Number
-44	1067-1

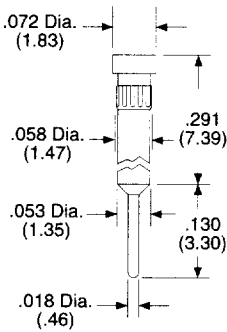

Type	Part Number
-99	1677

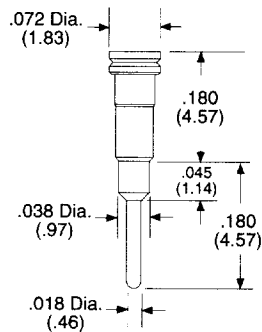

Type	Part Number
-145	1709

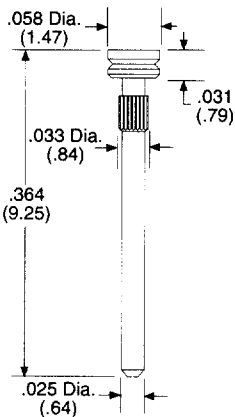

Type	Part Number
-773	6635

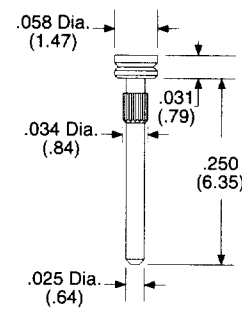

Type	Part Number
-101	1404

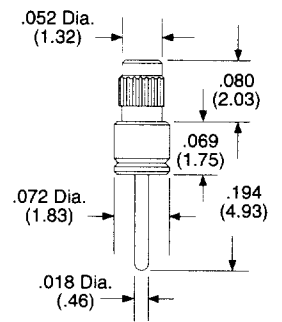

Type	Part Number
-100	1352

Material:  
Terminal: Brass - Copper Alloy (C36000), ASTM-B-16  
Contact: Beryllium Copper - Copper Alloy (C17200), ASTM-B-194

Plating:  
Contact: G = Gold/Nickel  
T = Tin-Lead/Nickel

Gold: per MIL-G-45204  
Tin-Lead: per MIL-P-81728  
Nickel: per QQ-N-290

Note: Pins with "V" groove in head may be supplied in Peel-A-Way®

Terminals not drawn to scale.

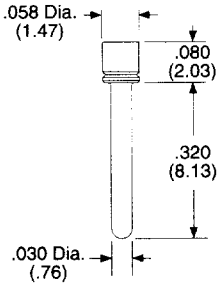
**Adapter Terminals**

Type	Part Number
-146	1790

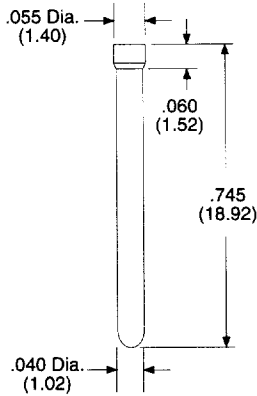

Type	Part Number
-337	3973

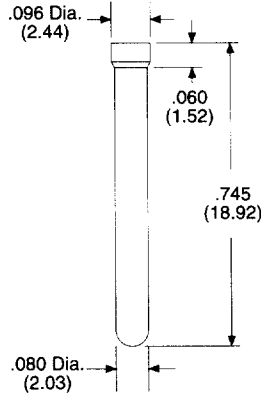

Type	Part Number
-336	3972

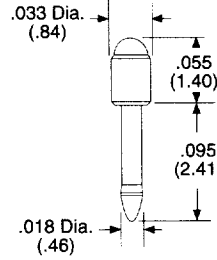

Type	Part Number
-603	4863

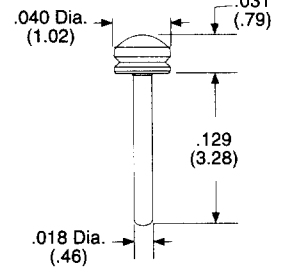

Type	Part Number
-525	4543-1

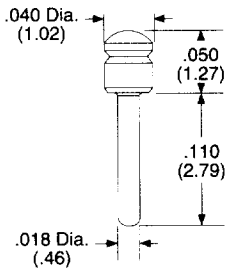

Type	Part Number
-526	4545-1

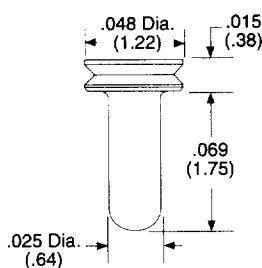

Type	Part Number
-583	4735-1

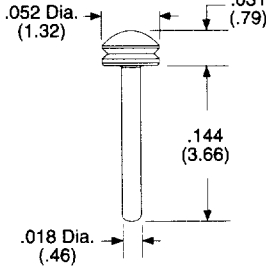

Type	Part Number
-574	4737-1

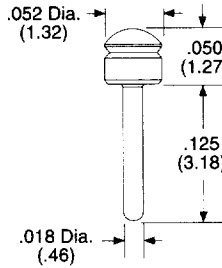

Type	Part Number
-575	4738-1

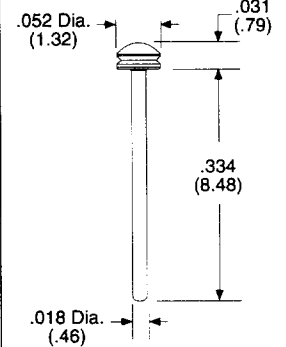

Type	Part Number
-593	4835

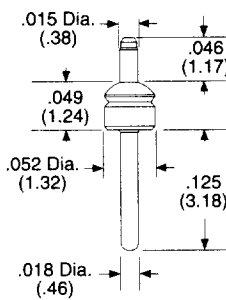

Type	Part Number
-576	4747-1

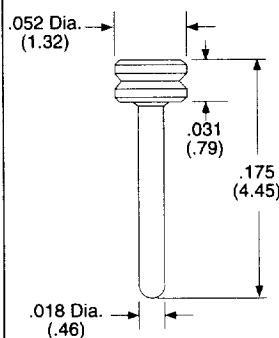

Type	Part Number
-558	4298-1

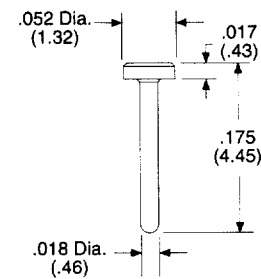

Type	Part Number
-420	4298

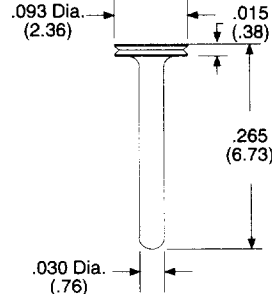

Type	Part Number
-349	4054

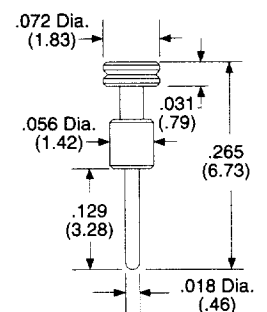

Type	Part Number
-137	1820

Material: Terminal: Brass - Copper Alloy (C36000), ASTM-B-16  
Contact: Beryllium Copper - Copper Alloy (C17200), ASTM-B-194

Plating: Contact: G = Gold/Nickel  
T = Tin-Lead/Nickel

Gold: per MIL-G-45204  
Tin-Lead: per MIL-P-81728  
Nickel: per QQ-N-290

Note: Pins with "V" groove in head may be supplied in Peel-A-Way®  
Terminals not drawn to scale.

## Adapter Terminals

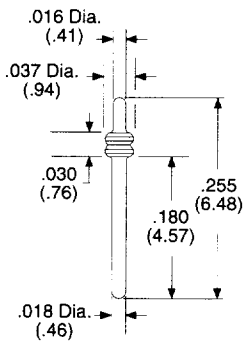

Type	Part Number
-355	4062

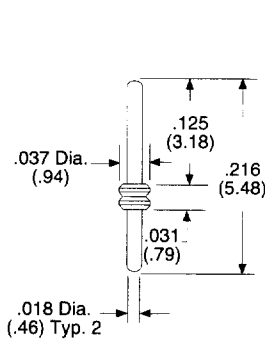

Type	Part Number
-571	4714

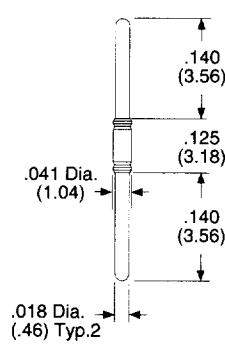

Type	Part Number
-260	3382

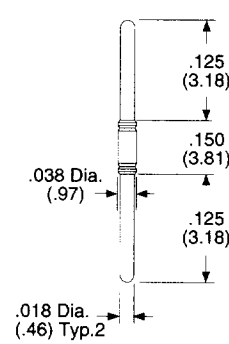

Type	Part Number
-167	2084

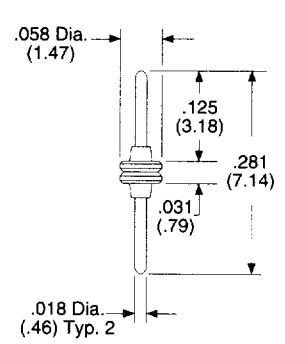

Type	Part Number
-238	3221

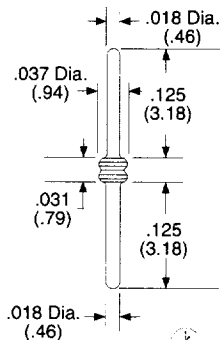

Type	Part Number
-131	2527-1

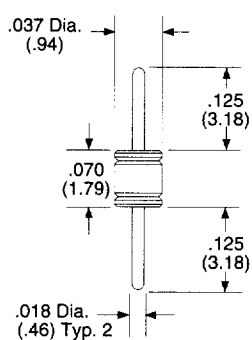

Type	Part Number
-321	2527-2

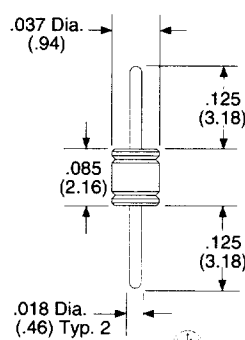

Type	Part Number
-322	2527-3

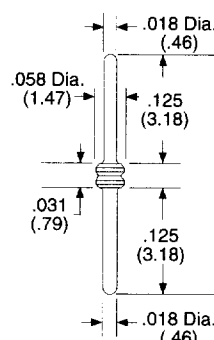

Type	Part Number
-165	2184

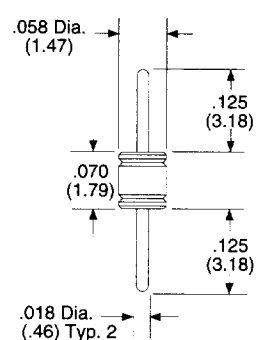

Type	Part Number
-339	2184-2

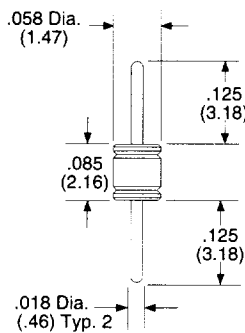

Type	Part Number
-340	2184-3

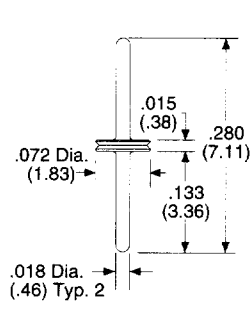

Type	Part Number
-378	1364-6

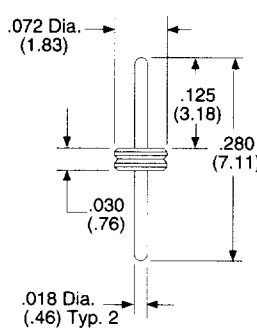

Type	Part Number
-79	1364-1

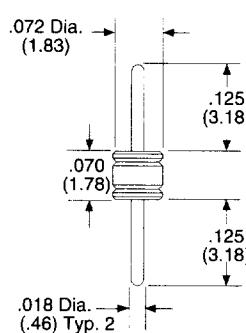

Type	Part Number
-80	1364-2

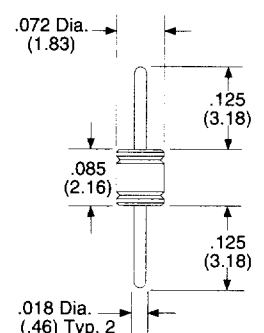

Type	Part Number
-81	1364-3

Material:  
Terminal: Brass - Copper Alloy (C36000), ASTM-B-16  
Contact: Beryllium Copper - Copper Alloy (C17200), ASTM-B-194

Plating:  
Contact: G = Gold/Nickel  
T = Tin-Lead/Nickel

Gold: per MIL-G-45204  
Tin-Lead: per MIL-P-81728  
Nickel: per QQ-N-290

Note: Pins with "V" groove in head may be supplied in Peel-A-Way®  
Terminals not drawn to scale.

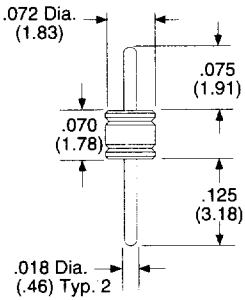
**Adapter Terminals**

Type	Part Number
-186	1364-4

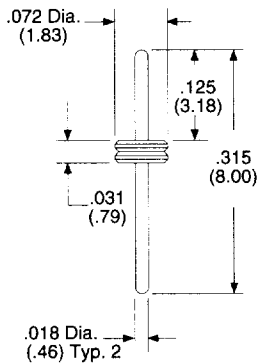

Type	Part Number
-393	4227-1

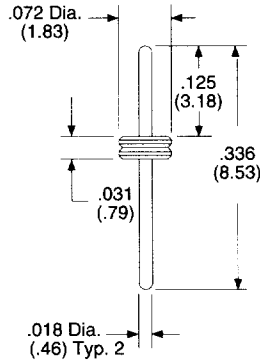

Type	Part Number
-338	3997

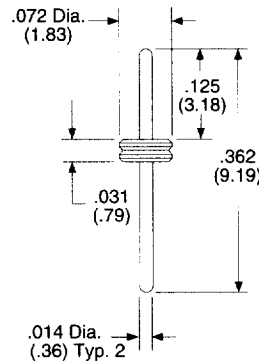

Type	Part Number
-341	4020

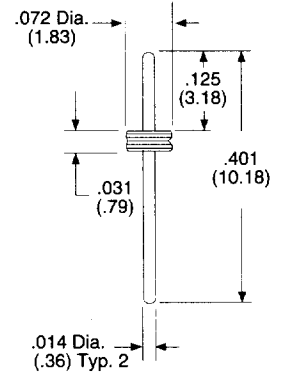

Type	Part Number
-606	4953

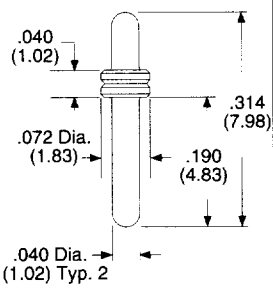

Type	Part Number
-413	4279

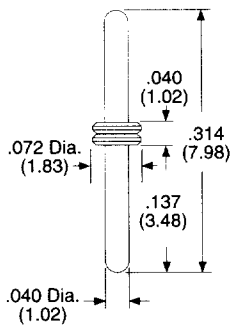

Type	Part Number
-169	2155

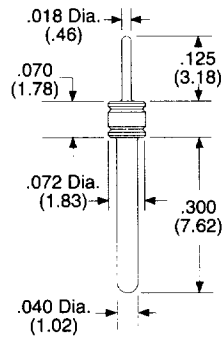

Type	Part Number
-295	3795

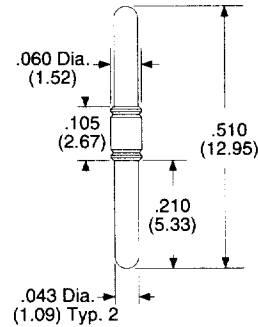

Type	Part Number
-377	4143

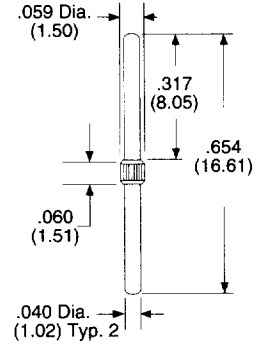

Type	Part Number
-484	4418-1

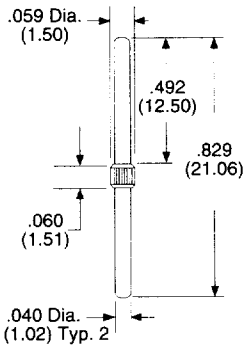

Type	Part Number
-485	4418-2

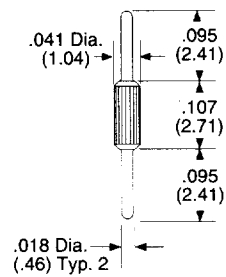

Type	Part Number
-233	3096-1

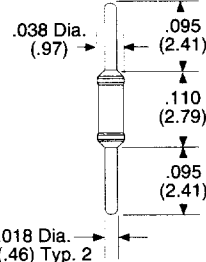

Type	Part Number
-559	4670

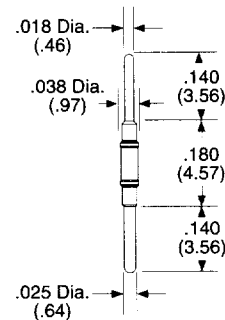

Type	Part Number
-711	5705

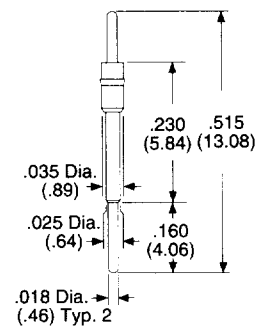

Type	Part Number
-423	4306

Material:  
Terminal: Brass - Copper Alloy (C36000), ASTM-B-16  
Contact: Beryllium Copper - Copper Alloy (C17200), ASTM-B-194

Plating  
Contact: G = Gold/Nickel  
T = Tin-Lead/Nickel

Gold: per MIL-G-45204  
Tin-Lead: per MIL-P-81728  
Nickel: per QQ-N-290

Note: Pins with "V" groove in head may be supplied in Peel-A-Way®  
Terminals not drawn to scale.

## Adapter Terminals

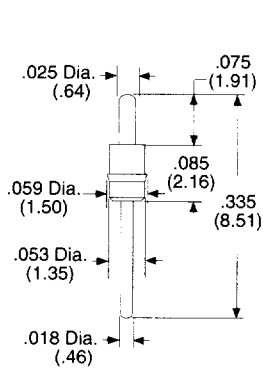

Type	Part Number
-490	4425

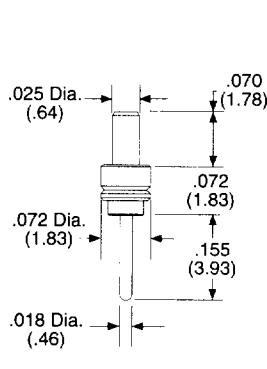

Type	Part Number
-138	1769

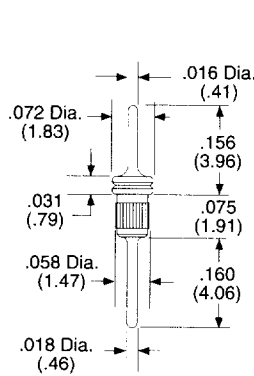

Type	Part Number
-202	2452

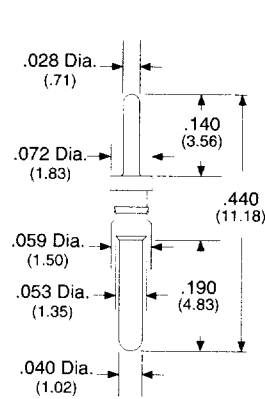

Type	Part Number
-426	4308

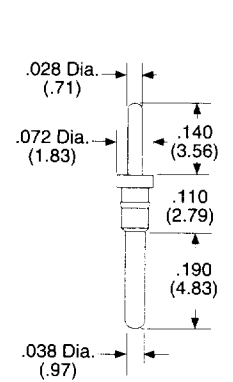

Type	Part Number
-569	4696

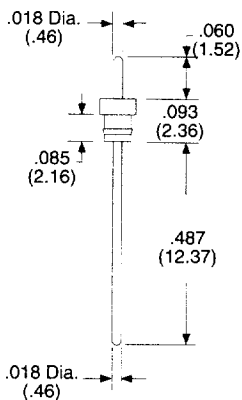

Type	Part Number
-319	3957

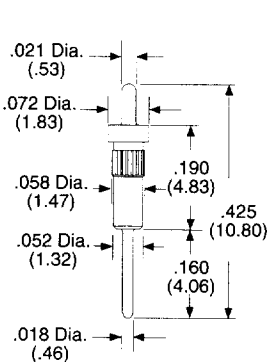

Type	Part Number
-142	1863

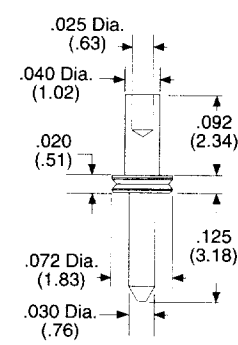

Hole Depth .040/(1.01)

Type	Part Number
-544	4616

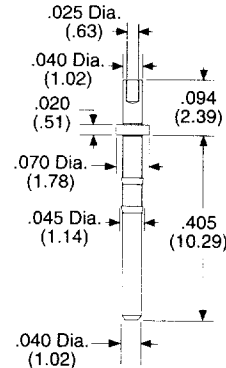

Hole Depth .045/(1.14)

Type	Part Number
-599	4875

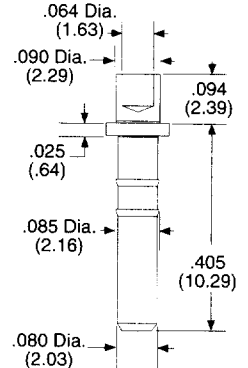

Hole Depth .062/(1.57)

Type	Part Number
-600	4876

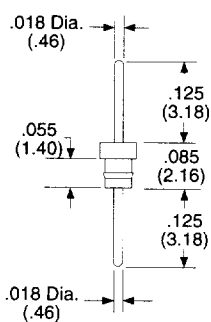

Type	Part Number
-188	2342

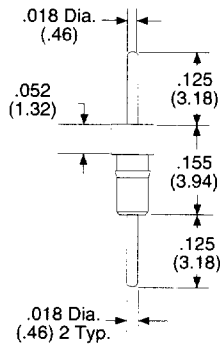

Type	Part Number
-444	4375

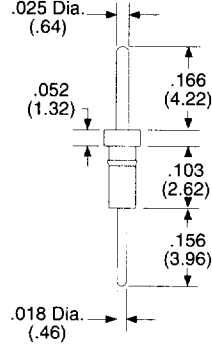

Type	Part Number
-08	1077

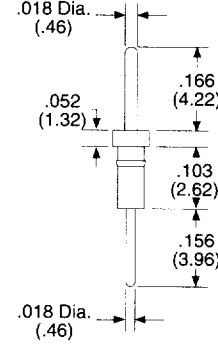

Type	Part Number
-09	1078

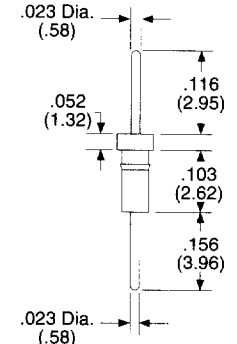

Type	Part Number
-286	3626

Material:  
Terminal: Brass - Copper Alloy (C36000), ASTM-B-16  
Contact: Beryllium Copper - Copper Alloy (C17200), ASTM-B-194

Plating:  
Contact: G = Gold/Nickel  
T = Tin-Lead/Nickel

Gold: per MIL-G-45204  
Tin-Lead: per MIL-P-81728  
Nickel: per QQ-N-290

Note: Pins with "V" groove in head may be supplied in Peel-A-Way®

Terminals not drawn to scale.

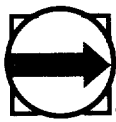

## Adapter Terminals

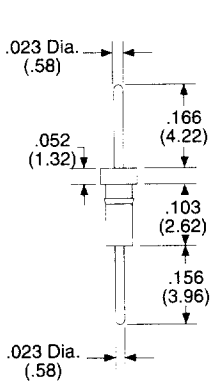

Type	Part Number
-277	3359

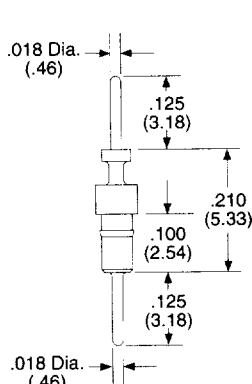

Type	Part Number
-68	1216-1

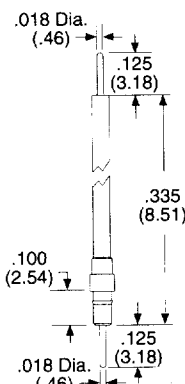

Type	Part Number
-43	1216-2

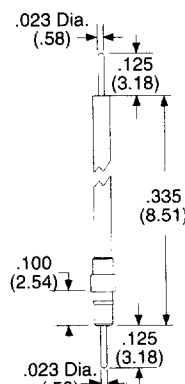

Type	Part Number
-278	3366

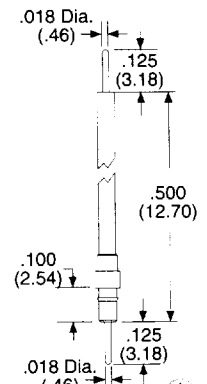

Type	Part Number
-185	1216-5

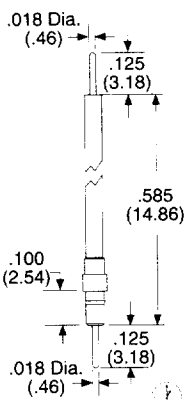

Type	Part Number
-42	1216-3

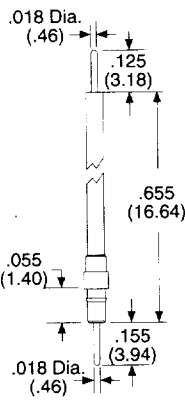

Type	Part Number
-360	1216-6

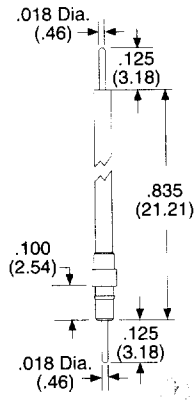

Type	Part Number
-71	1216-4

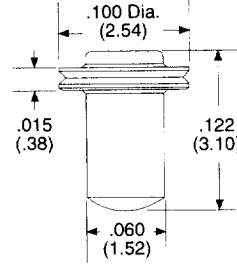

Type	Part Number
-506	4522

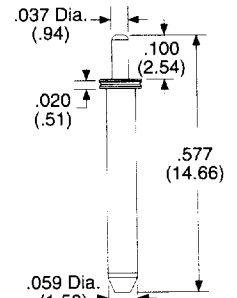

Type	Part Number
-539	4621

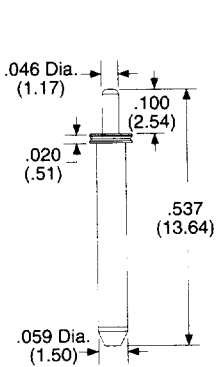

Type	Part Number
-540	4622

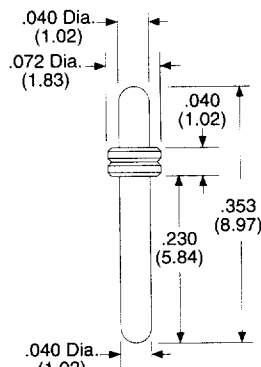

Type	Part Number
-771	6041

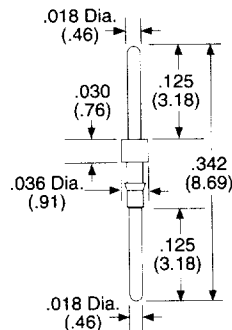

Type	Part Number
-721	5843-1

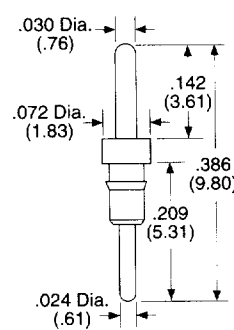

Type	Part Number
-727	5926

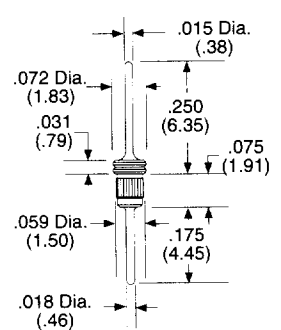

Type	Part Number
-626	5030

Material: Terminal: Brass - Copper Alloy (C36000), ASTM-B-16  
Contact: Beryllium Copper - Copper Alloy (C17200), ASTM-B-194

Plating: Contact: G = Gold/Nickel  
T = Tin-Lead/Nickel

Gold: per MIL-G-45204  
Tin-Lead: per MIL-P-81728  
Nickel: per QQ-N-290

Note: Pins with "V" groove in head may be supplied in Peel-A-Way®

Terminals not drawn to scale.