

Non-Isolated Point-of-Load DC-DC Converters

Features

- Compact design and high output voltage (Space-saving)
- High electric power efficiency up to 95%
(used our original power inductors)
- Highly accurate output voltage (0.75V to 5.0V : Max 20A)
- Low output noise
- No heat sink required
- Ample product lineup (2 types and 80 models)

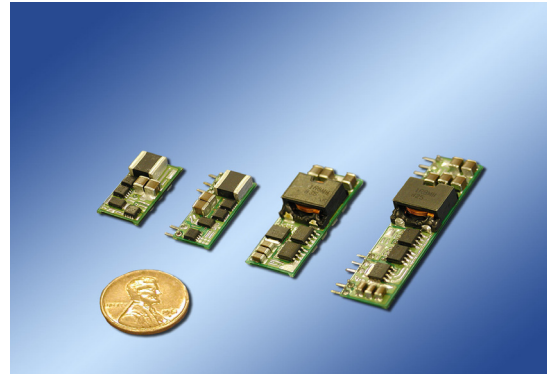

Applications

- Servers and high-performance desktop computers
- Communication devices

Specifications

Product Name		DC-DC Converter "WV series"		DC-DC Converter "WW series"	
Input voltage (Vin)		10V ~ 14V			
Output voltage (Vout)		0.75V, 0.9V, 1.0V, 1.2V, 1.5V, 1.8V, 2.0V, 2.5V, 3.3V, 5.0V			
Output current (Iout)		5.0A	10.0A	15.0A	20.0A
Efficiency (η)		95% max (5 Vout Half Load at 25°C)			
Dimensions (L x W x H)	SIP type	22.9mm×10.2mm×5.8mm		50.8mm×12.7mm×8.13mm	
	SMD type	20.3mm×11.4mm×6.2mm		33.0mm×13.4mm×8.28mm	
Temperature range		-10°C ~ +85°C			
Remarks		With an output voltage external variable function terminal			

Product identification

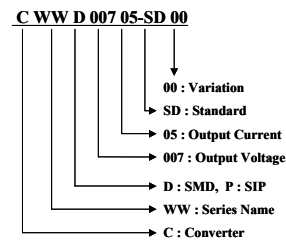
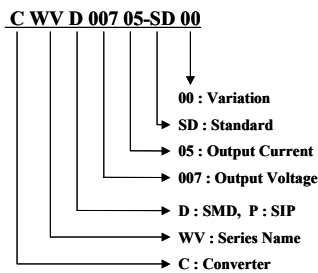

SMD type	Vout	Iout	SIP type	Vout	Iout
CWVD00710-SD00	0.75V	10.0A	CWVP00710-SD00	0.75V	10.0A
CWVD00910-SD00	0.90V	10.0A	CWVP00910-SD00	0.90V	10.0A
CWVD01010-SD00	1.0V	10.0A	CWVP01010-SD00	1.0V	10.0A
CWVD01210-SD00	1.2V	10.0A	CWVP01210-SD00	1.2V	10.0A
CWVD01510-SD00	1.5V	10.0A	CWVP01510-SD00	1.5V	10.0A
CWVD01810-SD00	1.8V	10.0A	CWVP01810-SD00	1.8V	10.0A
CWVD02010-SD00	2.0V	10.0A	CWVP02010-SD00	2.0V	10.0A
CWVD02510-SD00	2.5V	10.0A	CWVP02510-SD00	2.5V	10.0A
CWVD03310-SD00	3.3V	10.0A	CWVP03310-SD00	3.3V	10.0A
CWVD05010-SD00	5.0V	10.0A	CWVP05010-SD00	5.0V	10.0A

SMD type	Vout	Iout	SIP type	Vout	Iout
CWWD00720-SD00	0.75V	20.0A	CWWP00720-SD00	0.75V	20.0A
CWWD00920-SD00	0.90V	20.0A	CWWP00920-SD00	0.90V	20.0A
CWWD01020-SD00	1.0V	20.0A	CWWP01020-SD00	1.0V	20.0A
CWWD01220-SD00	1.2V	20.0A	CWWP01220-SD00	1.2V	20.0A
CWWD01520-SD00	1.5V	20.0A	CWWP01520-SD00	1.5V	20.0A
CWWD01820-SD00	1.8V	20.0A	CWWP01820-SD00	1.8V	20.0A
CWWD02020-SD00	2.0V	20.0A	CWWP02020-SD00	2.0V	20.0A
CWWD02520-SD00	2.5V	20.0A	CWWP02520-SD00	2.5V	20.0A
CWWD03320-SD00	3.3V	20.0A	CWWP03320-SD00	3.3V	20.0A
CWWD05020-SD00	5.0V	20.0A	CWWP05020-SD00	5.0V	20.0A

The SMD type : for variable input voltage (Corresponding to 6Vin)

CWWD01520-SD01	1.5V	20.0A	CWWP01520-SD01	1.5V	20.0A	It outputs by the external resistance. It is usable in DC1.0V – 1.9V range
CWWD03320-SD01	3.3V	20.0A	CWWP03320-SD01	3.3V	20.0A	It outputs by the external resistance. It is usable in DC1.5V – 5.0V range

Non-isolated load DC-DC Converter "WV/WW series"

1. SHAPES AND DIMENSIONS / Layout of pins.

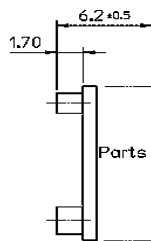
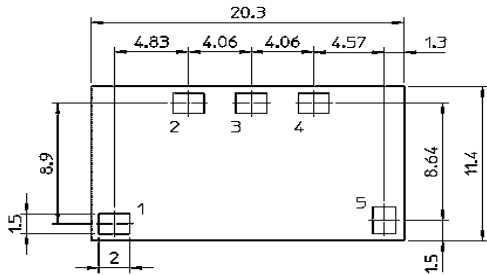

WV series, SMD Type

Pin No.	Function
1	Input (+)
2	Return
3	Output (+)
4	Trim
5	Remote on/off

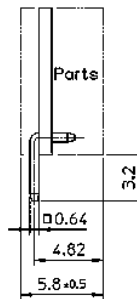
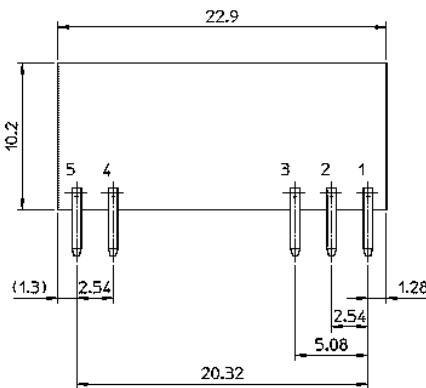

WV series, SIP Type

Pin No.	Function
1	Output (+)
2	Trim
3	Return
4	Input (+)
5	Remote on/off

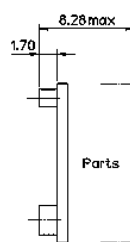
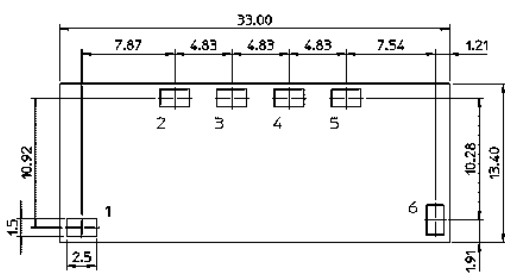

WV series, SMD Type

Pin No.	Function
1	Input (+)
2	Return
3	Output (+)
4	Trim
5	Remote sense
6	Remote on/off

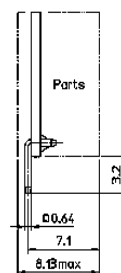
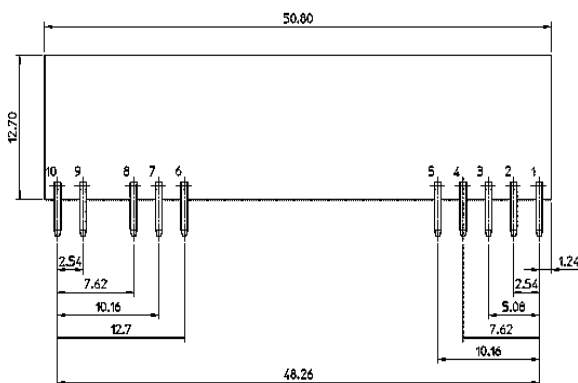

WV series, SIP Type

Pin No.	Function
1, 2, 4	Output (+)
3	Remote sense
5, 6	Return
7, 8	Input (+)
9	Trim
10	Remote on/off