

F9J GCB 7

No. OF PAIRS	No. OF POS	N	N/2
-08,-12	36	36	18
-16	50	50	25
-24	68	68	34

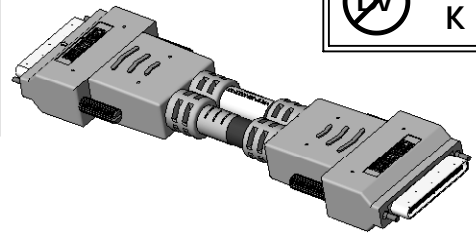

NO H-GDFC 8I 7HA 5BI : 57H F98
K H 058! : F99DFC 7 9CG-B;

J D@DILL!LLLL!LL
Bc C : D5 F#G
I\$, Z!%&Z!% Z!& (FG99 G-99H' L
7 C BB 97 HC F C DHC B
I\$% D-B %HC D-B %
FC99 : % ZG<99H%
/ H 6@ (L
I\$& D-B %HC D-B B#&Z%
FG99 H 6@ (/
..... : % ZG<99H&L
I !%\$\$\$Z&\$\$\$Z' \$\$\$Z5B8) \$\$\$B 'GHC 7?"

89G B 98 / 8-A 9BGC B 98
B A @A 9HFG B 7 < 9GQ

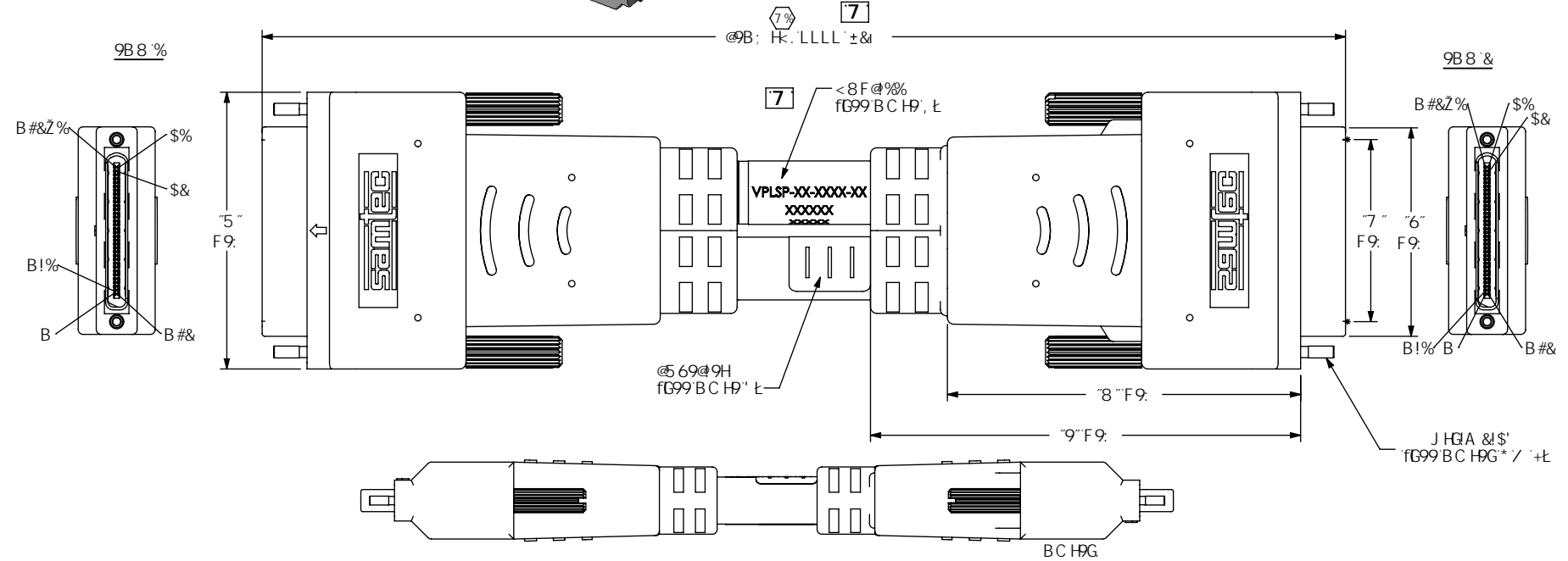

8C BCH
G7 5@ : FCA
H-GDF-BH

No. OF PAIRS	"A"		"B"		"C"		"D"		"E"		CABLE	SUB ASSEMBLY
-08	30.20	[1.189]	19.80	[0.780]	24.90	[0.980]	44.80	[1.764]	56.80	[1.764]	LSPC-26100-08	SUB-VPLSP-08-XXXX-XX
-12	30.20	[1.189]	19.80	[0.780]	24.90	[0.980]	44.80	[1.764]	56.80	[1.764]	LSPC-26100-12	SUB-VPLSP-12-XXXX-XX
-16	35.80	[1.409]	25.40	[1.000]	30.50	[1.201]	49.10	[1.933]	61.10	[1.933]	LSPC-26100-08 (x2)	SUB-VPLSP-16-XXXX-XX
-24	43.20	[1.701]	32.60	[1.283]	37.80	[1.488]	55.10	[2.169]	67.10	[2.169]	LSPC-26100-12 (x2)	SUB-VPLSP-24-XXXX-XX

ITEM #	PART #	QTY	DESCRIPTION
IH ROUTING (NOT RELEASED)			
1	SUB-VPLSP-XX-XXX-XX	1	SUB ASSEMBLY
2	VTS-M2-03	4	THUMB SCREW
3	OVERMOLD	2	RITE FLEX 640
4	CUT-1.000	2	CU TAPE
OC ROUTING			
5	SUB-VPSTP-T-XX-03-01	2	SUB ASSEMBLY
6	LSPC-26100-XX	(SEE TABLE 1)	CABLE
7	LABEL-ET	1	LABEL
8	HDRL-11	1	LABEL

J D@D!&(!LLLL!\$%G<CK B
"%" 7 "F9DF9G9BHG5 7FH7 5@8A 9BGC B"
7 & "5 @5 G9A 6@9GHC 69%\$S! 9@97 HF 7 5@MHG98
" "CF G<CFHG5B8 CD9B G"
7 "5 @5 G9A 6@9GHC 69%\$S! < #DC HHG98 5H' \$\$\$ "5: HF
" "B 5 @9@97 HF 7 5@HGZ@69@5 G9A 6@MK H: %@699H'
" ("D5 7? 5: 95 G9A 6@9G B 7 @95F DC @M65; GC F K F5D 9B 8G
" "B 6! 66@9K F5D CF : C 5 A "
" "G99 H 6@ (: CF G B 5 @# FC I B 8 7 CB : I F 5 HC B "
" "A 5 > CF 8 5 A 9HF : CF A & I (! * ; 9LHF B 5 @H F 95 8
" "K H : [HC @F 5 B 7 9 G % , * A B HC % - , % A 5 L 5 7 7 C F 8 B ;
" "HC 5 BG 4 5 A 9 6 % % A ! % , ; fF %) -) L "
" "A B CF 8 5 A 9HF : CF A & I (! * ; 9LHF B 5 @H F 95 8 K H :
" " [HC @F 5 B 7 9 G % (\$, A B HC %) (, A 5 L 5 7 7 C F 8 B ; HC
" " 5 BG 4 5 A 9 6 % % A ! % , ; fF % -) L "
7 " < 8 F @ % % - 6 HC 6 9 7 9 B HF 98 C B 7 5 6 @ 5 G G < C K B "
" < 8 F @ % % - 6 HC 7 C B H 5 B . D5 FH B I A 6 9 F Z G C D C F 8 9 F Z
/ 8 5 H 7 7 C 8 9 "

I B @9G C H 9FK 69 GD97 = 982
8 A 9B GC BG 5 F 9 B A @A 9HFG
HC @F 5 B 7 9 G 5 F 9
897 A 5 @G
" L ± % OSQ) & "
" LL ± % OSQ) Q
" LL ± % OSQ) S & Q
D F C D F 9 H 5 F M B C H P
H-GBC 71A 9B H7 C B H 8 B C : F A 5 H C B
7 C B : 8 9 B H 5 @ 5 B 8 D F C D F 9 H 5 F M C
G A H 7 2 B 7 * 5 B 8 G 5 @ B C H 6 9 F 9 D C B I 7 9 B
C F H 5 B G 9 F 9 8 H C C H 9 F B C 7 I A 9 B H G C F
8 4 7 @ 9 8 H C C H 9 F C F I 9 8 : C F 5 B M
D I F D C H 9 F H 5 B H 5 H K < 7 < H K 5 G
C 6 5 8 9 8 K H C I H H 9 9 L D F 9 G 9 8 K F H 9 8
7 C B 9 8 H C : G A H 7 2 B 7
A 5 H F 5 @
8 C B C H G 7 5 @ 8 F 5 K B :
D F 9 A C @ . @ D 9
C J 9 F A @ . D J 7
G : 9 H G 7 5 @ 9 % % * * * *
8 9 7 F D H C B .
D @ : G < 9 @ 9 8 @ C K G 7 9 K 7 5 6 @ 5 G 9 A 6 @ M
8 K : " B C "
J D @ D ! L L ! L L L L ! L L
6 M @ 9 B B M ? * # # \$ + G < 9 9 H % C : '

santec
& S D 5 F ? 9 5 G H @ 8 2 B 9 K 5 @ 5 B M Z B (+) \$
D < C B 9 , % & L (! + * ; : 5 L , % & L - ()) \$ (+
Y I A U J . j o z 4 G 5 A H 7 W c a W C Y .)) & &
8 9 7 F D H C B .
D @ : G < 9 @ 9 8 @ C K G 7 9 K 7 5 6 @ 5 G 9 A 6 @ M
8 K : " B C "
J D @ D ! L L ! L L L L ! L L
6 M @ 9 B B M ? * # # \$ + G < 9 9 H % C : '

7

..PBK : PA 67 PA 7H PJ D@DILL!LLLL!LLIIA 7HG88FK

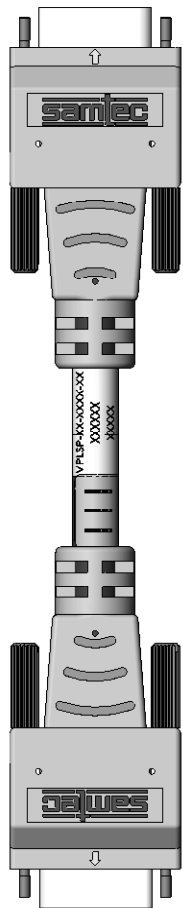

J D@G!\$% !LLLL!

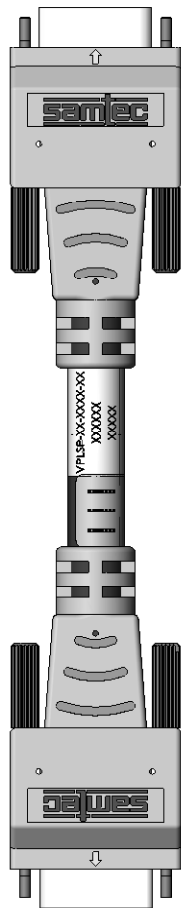

J D@G!\$% !LLLL!

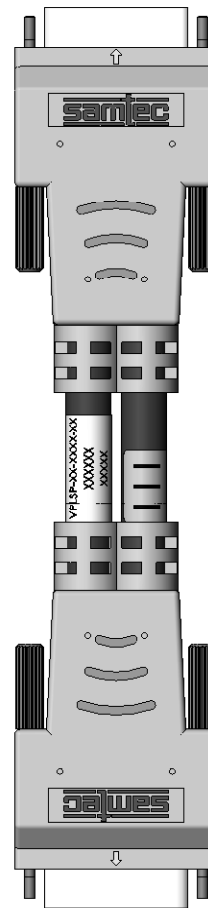

J D@G!\$% !LLLL!

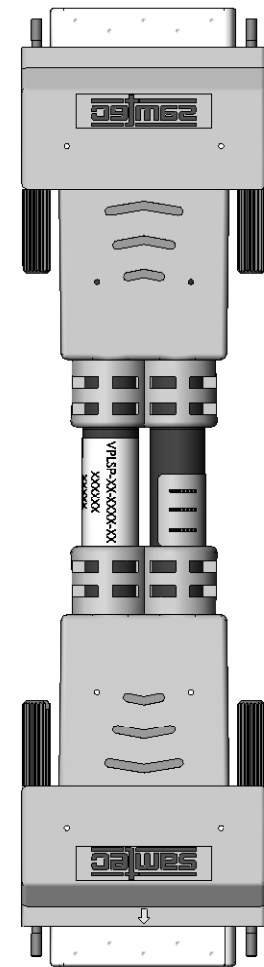

J D@G!\$% !LLLL!

TABLE 4

CONNECTOR OPTION	FIRST END PIN #	SECOND END PIN #
-01	1	1
-02	1	N/2 + 1

DFC DF 915 FMBC H9

H: 6BC 71A 98H7 C B16 BG B: CFA 5HC B
 7 C B: 898H5 95B8 DFC DF 945 F1MC
 GSA H97 2 87 588 G: 588BC H69 F90FC 81 798
 CF HF5BG 9F98 HC CH: 9F 8C 71A 98HG CF
 8 47 @G98 HC CH: 9FGCF 1 098 : CF 5BM
 DI FDC @9 CH: 9F H: 5B H: 5HK < 7 < #HK 5G
 C 615 B 98 K #C I H: 9 9L DF 9098 K F #H8
 7 C B 98HC : GSA H97 2 87 *

8C 'BCH G7 5 @9 8F5K B:

G: 99HG7 5 @9 S*+).%

: .PBK : PA 67 PA 7H PJ D@G!LLLLLLLLLLIA ?HG88FK



) & \$ D5F? 95GH6@ 8ZB9K '5 @5BM B (+) \$
 D < C B 9 ; %&L - ((! * + : SL ; %&L - () \$ (+
 YIA UJ ;) & z 4 GSA H97 'Wc a 'Wc XY.) ' &&

8 9G7 F @HC B:

D @ ; 'G < 9 @ 98 ' @ K 'G? 9K '7 5 6 @ 9 5 GG9A 6 @M

8K : "BC"

J D@G!LLLL!LLLL!LL

6M @9BBM? *# # \$ +

G < 99H ' ' C : '