

DO NOT SCALE DRAWING DIMENSION IN METRIC

PROJECT NO. SIMILAR ITEM EDP NO. 35210-\*\*\* ENG. NO. SDA 35210-\*\*\*

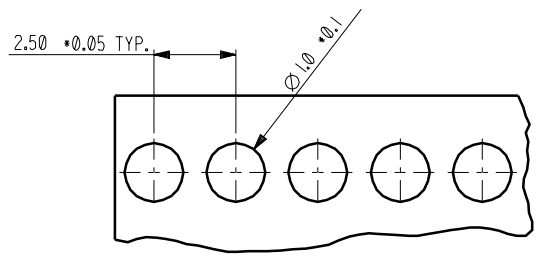
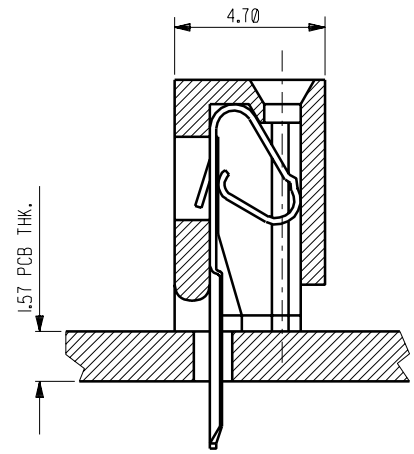
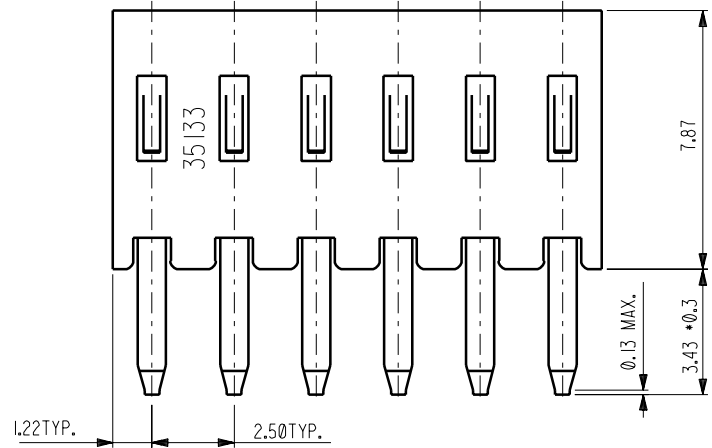
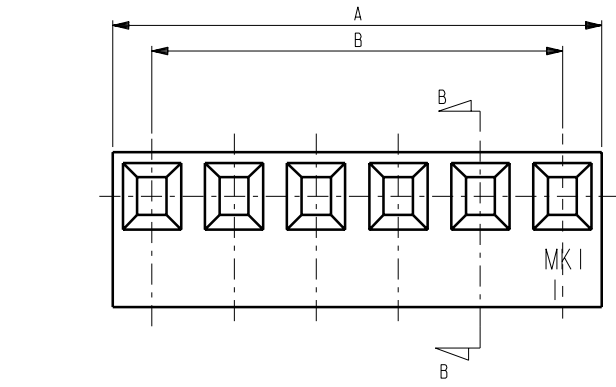

NOTE

MATERIAL  
 HOUSING --- NYLON 66 UL94V-0  
 TERMINAL --- PHOSPHOR BRONZE

LEGEND  
 35210- \*\* | \*  
 | \* 0° : NATURAL  
 | \* 6° : BROWN  
 | \* CIRCUIT

ENG.NO.	△	CKT.SIZE	DIM.A	DIM.B
35210 - 021*		2	4.94	2.50
- 031*		3	7.44	5.00
- 041*		4	9.94	7.50
- 051*		5	12.44	10.00
- 061*		6	14.94	12.50
- 071*		7	17.44	15.00
- 081*		8	19.94	17.50
- 091*		9	22.44	20.00
- 101*		10	24.94	22.50
- 111*		11	27.44	25.00
- 121*		12	29.94	27.50
- 131*		13	32.44	30.00
- 141*		14	34.94	32.50
- 151*		15	37.44	35.00
- 161*		16	39.94	37.50
- 171*		17	42.44	40.00
- 181*		18	44.94	42.50
- 191*		19	47.44	45.00
35210 - 201*		20	49.94	47.50

ASS'Y PART		QTY/REEL OR PACK	SURFACE AREA	MATERIAL	SEE NOTE	WIRE RANGE	GENERAL TOLERANCES	MOLEX MOLEX-KOREA CO.,LTD.
DESCRIPTION	ENG.NO.		MM <sup>2</sup>	DIMENSION CLASSIFICATION		AWG: / MM <sup>2</sup> :	DIM. : 0.20 ANGLE : 2°	
C	REVISED	92-025	92-1/06	DIE NO.	LAYOUT NO.			REVISE ONLY ON CAD SYSTEM
B	RELEASED	92-008	92-2/24	WIRE CRIMP WIDTH	INS. CRIMP WIDTH			
A	NEW RELEASED	91-0014	91-9.16	WBDW	IBDW	DRAWN BY H.S.SHIN	CHK'D BY	
I	TEMPORARY RELEASED			APP'D BY	SCALE			
LTR	REVISION RECORD	ECN	DR./CHK	DATE	DIE FEED	APPL FEED		
								ENG.NO. SDA-35210-***
								REV C